

CORNDITIONER STOVE ASSEMBLY

BEGINNING SERIAL NO. 07010000

DOC: CSA3001

CSA-A/E-3.0-B

2/08

1190 CORNDITIONER STOVE BOX
1255 3/8" CONNECTOR
7621 1/4" INTERNAL TOOTH LOCKWASHER
7630 1/4-20 x 1/2 HEX BOLT (3)
7640 1/4-20 HEX NUT (3)
7653 8-32 HEX NUT (5)
7656 6-32 x 3/8 BINDING HEAD
7776 8-32 STEEL WING NUT
7789 #8 STARLOCKWASHER (5)
7554 CORNDITIONER STOVE ASSY - 240V (COMPLETE)
7555 CORNDITIONER STOVE ASSY - 120V (COMPLETE)

INCLUDES:

1190-5 ELEMENT CLAMP
1191 CORND. STOVE BOX COVER
1194 BLOWER - 240V (EXPORT)
1195 SET OF WIRES
1207 ELEMENT 1250 WATT, 240V
1220-1 BLOWER - 120V (DOMESTIC)
1656 THERMOSTAT - 180°F
1727-A ELEMENT 1100 WATT, 120V
2404-3 SS FLEXIBLE CONDUIT CUT TO LENGTH
12167 HIGH LIMIT 200F-3 POLE DISCONNECT

MOUNTING HARDWARE

7653 8-32 HEX NUT (5)
7776 8-32 STEEL WING NUT
7789 #8 STAR LOCKWASHER (5)

C. CRETORS AND COMPANY

176 MITTEL DRIVE

WOOD DALE, IL 60191

PHONE: (847)616-6900, (800)228-1885, FAX: (847)616-6970

WEB SITE: <http://www.cretors.com>

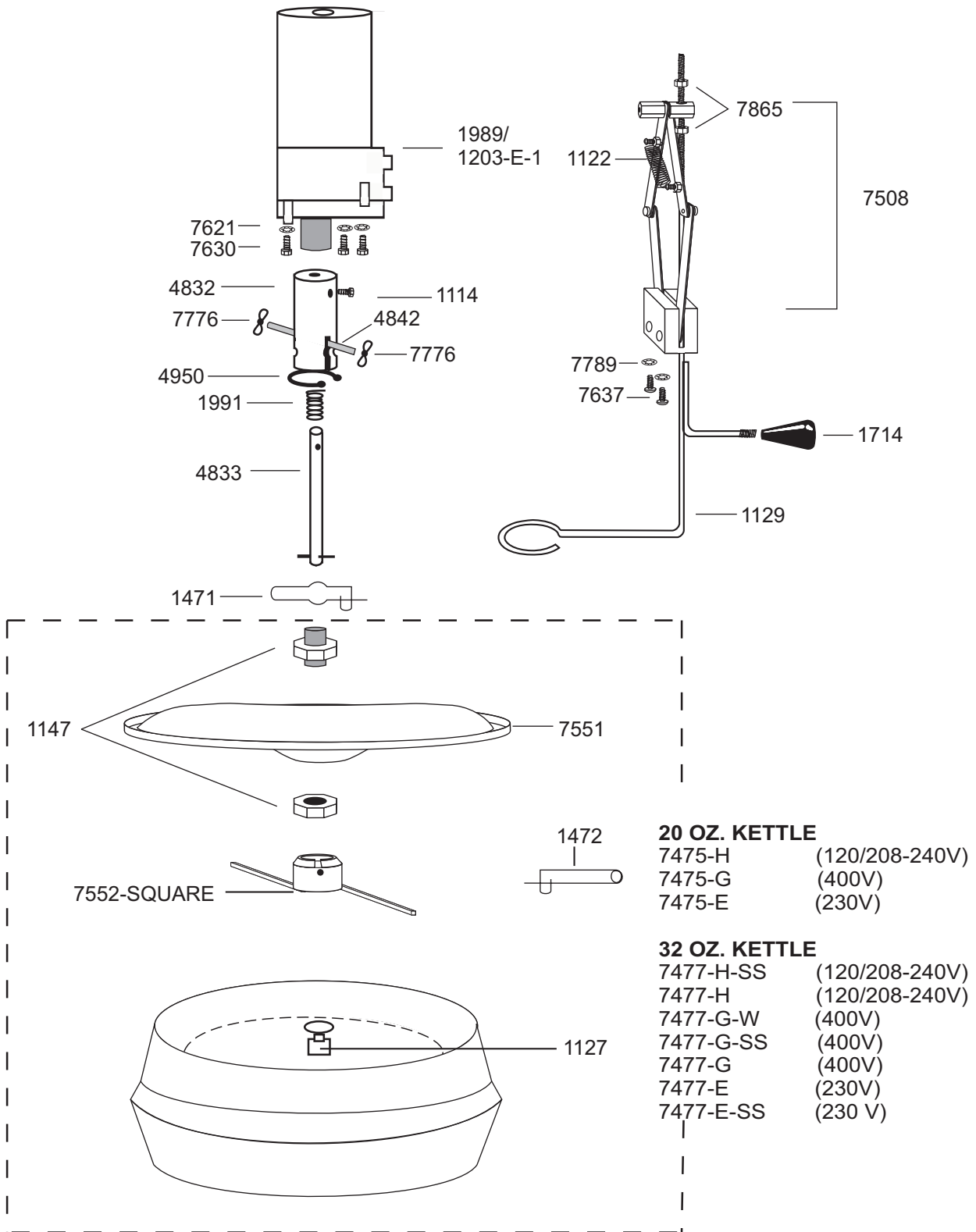

1114 HEX CONNECTOR SET SCREW
1122 TRIP ARM SPRING
1127 PAN CENTER-NSF
1129 NSF-COVER LIFT ROD
1147 NSF-COVER CENTER AND NUT
1203-E-1 MOTOR - 230/400V
1471 COVER RETAINING SPRING
1472 STIRRER BLADE RETAINING SPRING
1714 KNOB
1989 MOTOR - 120/240V
1991 SPRING
4832 DRIVE SHAFT CONNECTOR
4833 DRIVE SHAFT AND PIN SPRING DUMP
4842 SHAFT/CONNECTOR BOLT W/ WING NUT
4950 RETAINING RING
7508 AUTOMATIC COVER LIFT
7551 KETTLE COVER NSF
7552-SQUARE STIRRER BLADE DIP-SQUARE
7621 1/4" INTERNAL TOOTH LOCKWASHER
7630 1/4 x 20 x 1/2" HEX BOLT
7637 8-32 x 1/2 SS TRUSS HEAD
7776 8-32 STEEL WING NUT
7789 #8 STAR LOCKWASHER
7865 10-32 ELASTIC STOP NUT

**DIPLOMAT/HEADLINER 32 OZ. -
3-ELEMENT KETTLE PARTS**
120-208/240V & 400V
EXPLODED VIEW "UPSIDE DOWN"
BEGINNING SERIAL: 0606

DOC: DI200018

DI/HDL32-H/G-2.0-C
06/06

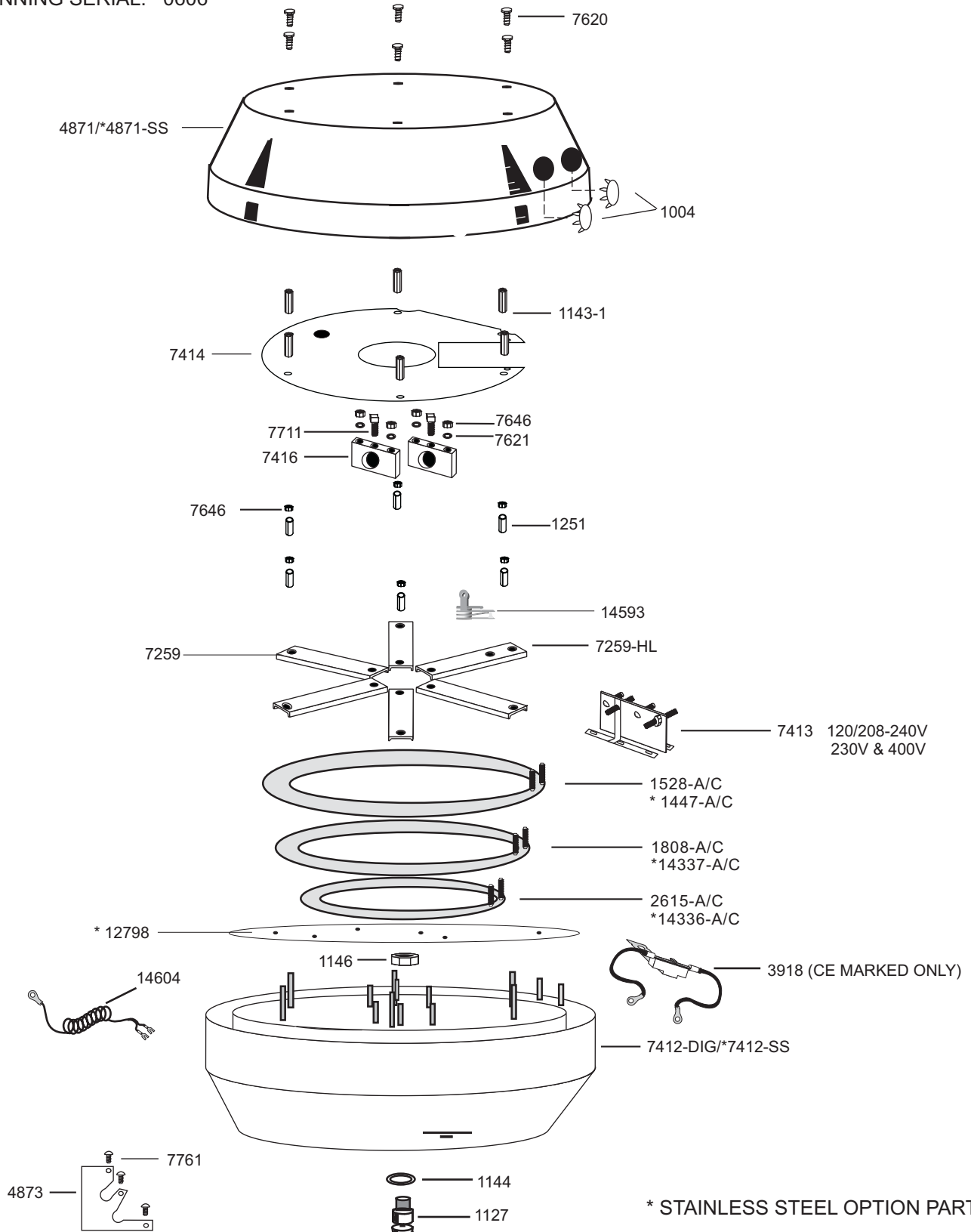

**DIPLOMAT/HEADLINER 32 OZ. -
3-ELEMENT KETTLE PARTS**

DOC: DI200018

DI/HDL32-H/G-2.0-C
06/06**120-208/240V & 400V**

EXPLODED VIEW "UPSIDE DOWN"

BEGINNING SERIAL: 0606

1004	7/16" THERMOSTAT HOLE COVER	14336-A	ELEMENT 1250 WATT, RING TYPE 120V
1127	PAN CENTER - NSF	14336-C	ELEMENT 1250 WATT, RING TYPE 230V
1143-1	HEX SPACER	14337-A	ELEMENT 1500 WATT, RING TYPE 120V
1144	PAN CENTER WASHER	14337-C	ELEMENT 1500 WATT, RING TYPE 230V
1146	1/2-20 PAN CENTER NUT	14593	HIGH LIMIT - (LIMIT CONTROL)
1251	5/8" SPACER	14604	THERMOCOUPLE - RING TYPE - DIP
1447-A	ELEMENT 1800 WATT, 120 VOLT		
1447-C	ELEMENT 1800 WATT, 240 VOLT		
1528-A	1500 WATT, 120 VOLT ELEMENT		
1528-C	1500 WATT, 240 VOLT ELEMENT		
1808-A	1250 WATT, 120 VOLT ELEMENT		
1808-C	1250 WATT, 240 VOLT ELEMENT		
2155	THERMOCOUPLE		
2615-A	1000 WATT, 120 VOLT ELEMENT		
2615-C	1000 WATT, 240 VOLT ELEMENT		
3918	HIGH LIMIT W/ WIRES		
4871	RETAINER - DI 32/SD		
4873	RETAINER PATCH - SD		
7259	ELEMENT CLAMP 5-1/4"		
7259-HL	ELEMENT CLAMP 5-1/4" - HIGH LIMIT		
7412-DIG	PAN-DIPLOMAT 32 OZ-DIG		
7413	MICA TERMINAL PLATE - (DI32/HDL32)		
7414	BAFFLE PLATE		
7416	PAN MOUNTING BLOCK		
7620	1/4-28 x 3/8 HEX HEAD		
7621	1/4" INTERNAL TOOTH LOCKWASHER		
7646	1/4-28 HEX NUT		
7711	5/16-18 x 1/2 SQUARE HEAD SCREW		
7761	6 x 1/4 PHILTYPE A - N.P.		
12798	DIFFUSER PLATE-32 OZ DIP SS PAN		

C. CRETORS AND COMPANY
3243 N. CALIFORNIA AVENUE
CHICAGO, IL 60618

PHONE: (773)588-1690, (800)228-1885, FAX: (773)588-2171
WEB SITE: [Http://www.cretors.com](http://www.cretors.com) Email: postmaster@cretors.com

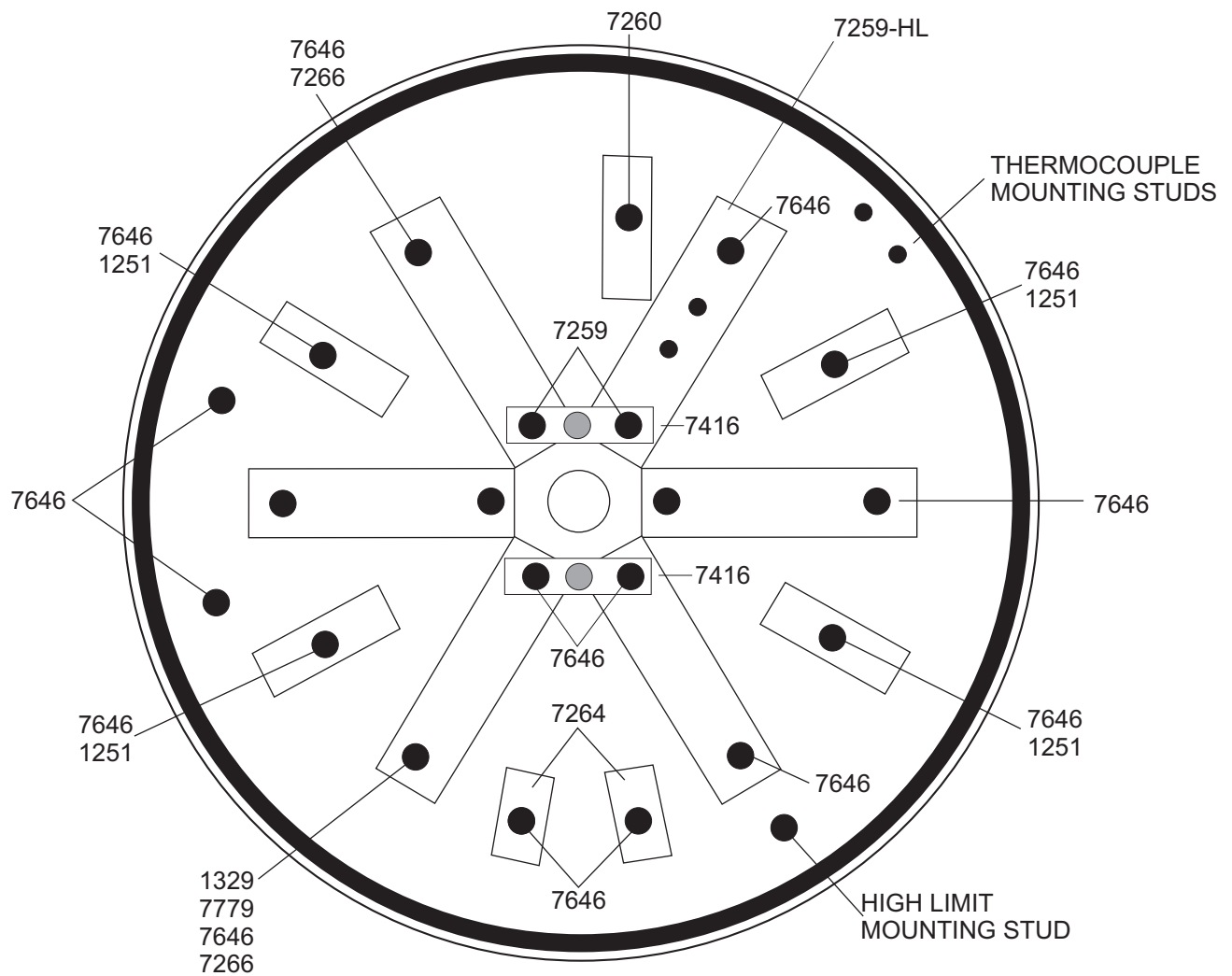

1251	SPACER - 1/4" x 5/8"	7264	ELEMENT CLAMP - 1-5/8"
1329	RETAINER HEX SPACER	7266	SPACER - 1/4" x 3/4"
7259	ELEMENT CLAMP - 5-1/4"	7646	1/4-28 HEX NUT
7259-HL	ELEMENT CLAMP - 5-1/4" HIGH LIMIT	7779	1/4" SAE FLAT WASHER
7260	ELEMENT CLAMP - 3-1/4"		

DIPLOMAT/HEADLINER 32 OZ. 3-ELEMENT KETTLE

DOC: DI200021

DI/DIL/HDL 32-E/G/H-2.1-B

BOTTOM VIEW - LOOKING DOWN ON PAN

03/06

BEGINNING SERIAL: 0606

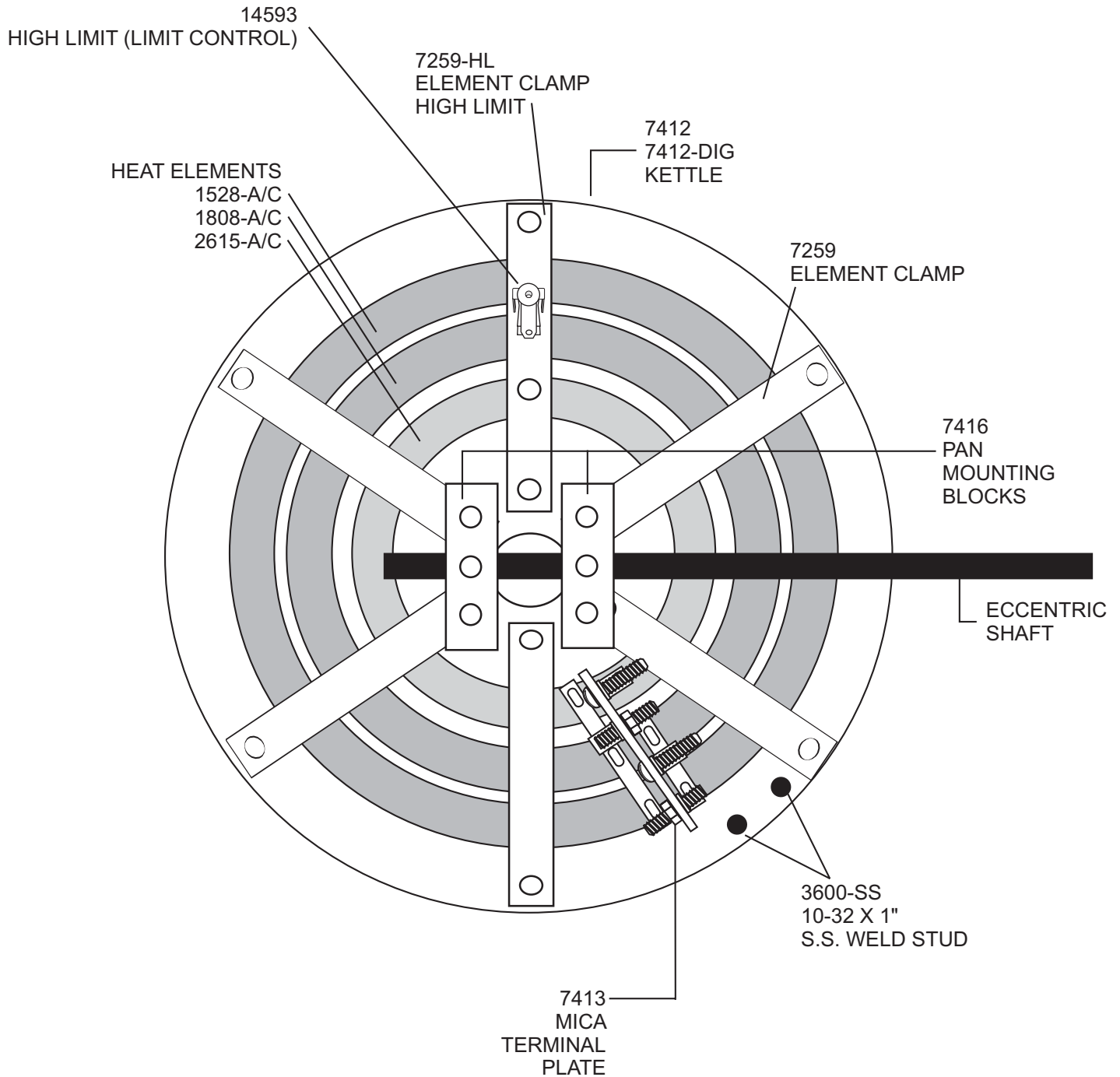

C. CRETORS AND COMPANY
3243 N. CALIFORNIA AVENUE
CHICAGO, IL 60618

PHONE: (773)588-1690, (800)228-1885, FAX: (773)588-2171

WEB SITE: [Http://wwwcretor.com](http://wwwcretor.com) Email: postmaster@cretors.com

DIP/M5/MA KETTLE SUPPORT COLUMN
20/32/48/60 OZ.

DOC: Di200022

DI-20/32-E/H-2.0-C
06/06

BEGINNING SERIAL: 0606

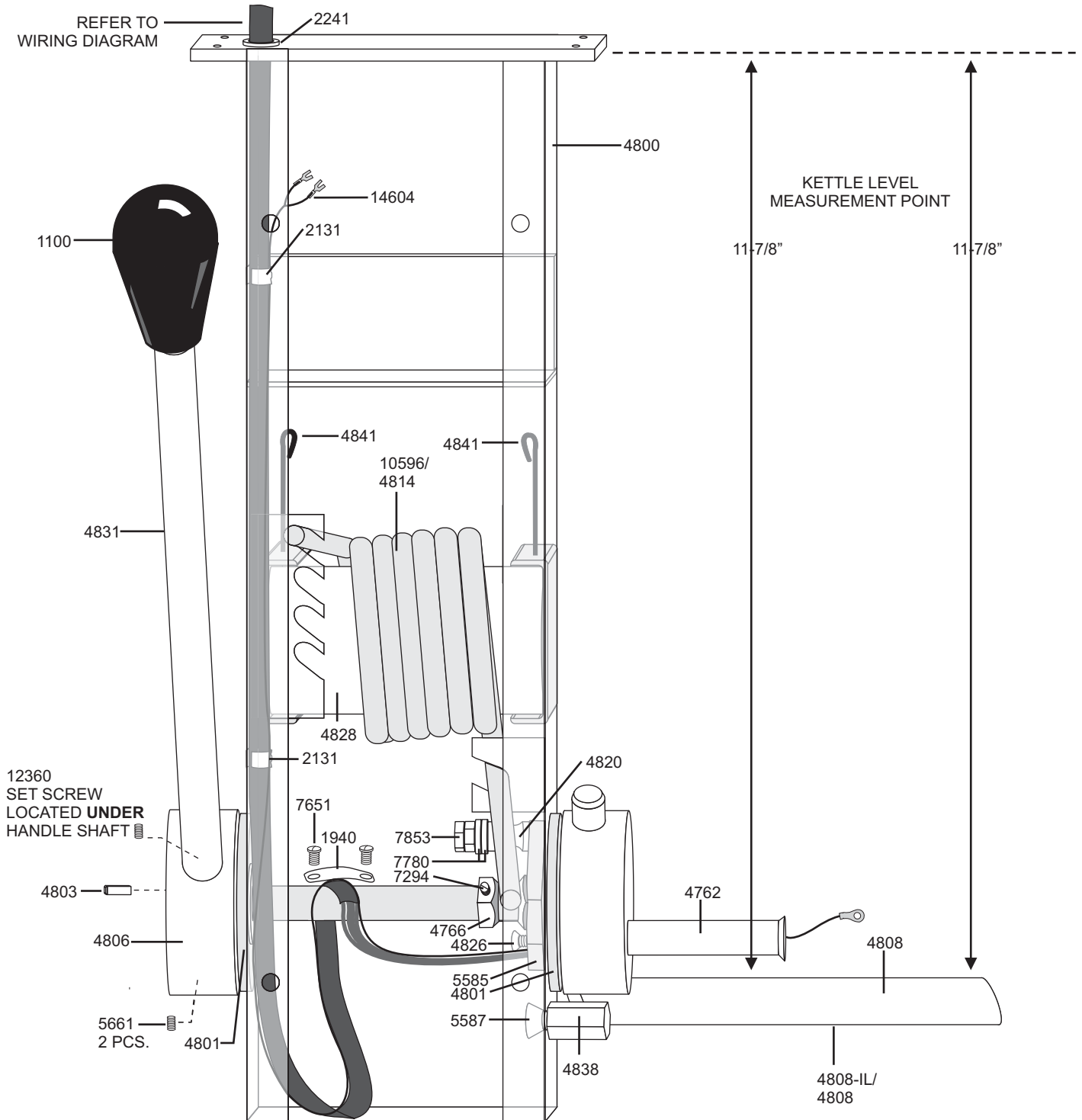

**DIP/M5/MA KETTLE SUPPORT COLUMN
20/32/48/60 OZ.**

DOC: Di200022

DI-20/32-E/H-2.0-C
06/06

BEGINNING SERIAL: 0606

1100	KNOB
1940	WIRE CLAMP FOR DIPLOMAT
2131	PIPE CLAMP #125
2241	1/2" INSULINER SLEEVE
4762	WIRE GUIDE TUBE
4766	KETTLE LEVEL NUT
4800	SUPPORT COLUMN - SPRING DUMP
4801	BEARING - COLUMN SUPPORT
4803	KEY - DIPLOMAT SPRING DUMP
4806	HANDLE HUB
4807	SUPPORT COLUMN COVER PLATE (NOT SHOWN)
4808	ECCENTRIC - DIP SPRING RETURN
4808-IL	ECCENTRIC - M5 SPRING RETURN
4814	RETURN SPRING (DI 20/32 OZ)
4820	ROLLER AND BEARING
4826	ARM BOLT 5/16-18 X 1
4828	SPRING HOLDER TUBE
4831	DUMP HANDLE - SPRING DUMP
4838	STOP BLOCK
4841	COTTER PIN 1/8 X 2
5585	SPRING ADJUSTMENT ARM
5587	3/8-16 X 3/4 FH SOCKET CAP
5661	5/16-18 X 1/2 SET SCREW
7294	10-32 X 3/16 SET SCREW, BRASS TIP
7651	10-24 X 1/2 B.H
7780	5/16 FLAT WASHER
7853	5/16-24 HEX NUT
10596	RETURN SPRING (DI48/60 OZ) M5 32/48/60
12360	1/2-20 X 3/8" SOCKET SET SCREW - UNDER 4831
14604	THERMOCOUPLE-RING TYPE-DIPLMAT

**48/60 OZ. DIP
KETTLE AND OPTIONAL SS KETTLE**

(Shown "Upside-Down")
Beginning Serial number 1005

Di200027

DI48/60-C/D/E/G-2.0-B
05/10

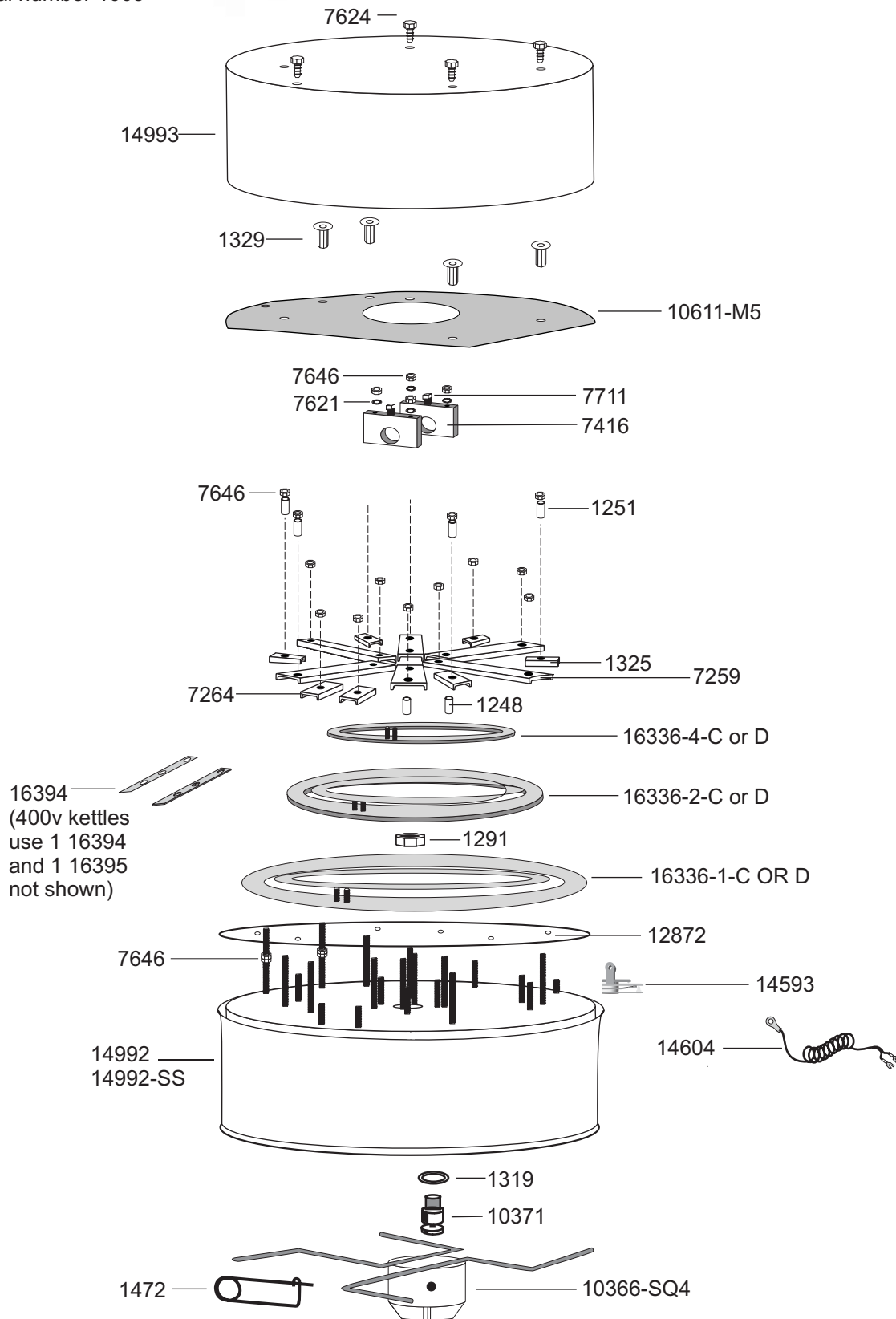

**48/60 OZ. DIPLOMAT
KETTLE AND OPTIONAL SS KETTLE**

DI200027

Di48/60-C/D/E/G-2.0-B
05/10

(Shown "Upside-Down") Beginning Serial No. 1005

1248	SPACER-1/4 x 1/2 (BAFFLE PLATE)
1251	5/8 " SPACER
1291	CENTER STUD LOCKNUT
1319	PAN CENTER WASHER
1329	RETAINER HEX SPACER
1325	ELEMENT CLAMP 3-1/4" (5 used)
1472	STIRRER BLADE RETAINING SPRING
7259	ELEMENT CLAMP 5-1/4" (6 used)
7264	ELEMENT CLAMP 5-1/4" (2 used)
7416	PAN MOUNTING BLOCK
7621	1/4" INTERNAL TOOTH LOCKWASHER
7624	1/4-28 x 1/2" HEX CAP
7646	1/4-28 HEX NUT
7711	5/16-18 x 1/2" SQUARE HEAD SCREW
10366-SQ4	STIRRER BLADE ASSEMBLY
10371	PAN CENTER
10611-M5	BAFFLE PLATE
12872	DIFFUSER PLATE
14593	HIGH LIMIT (LIMIT CONTROL)
14604	THERMOCOUPLE - RING TYPE - DIP
14992	POPPER PAN WITH STUD ASSY
14992-SS	POPPER PAN WITH STUD ASSY-STAINLESS STEEL
14993	RETAINER
16336-1-C	2000 WATT, 240 VOLT ELEMENT
16336-1-D	2000 WATT, 208 VOLT ELEMENT
16336-2-C	3050 WATT, 240 VOLT ELEMENT
16336-2-D	3050 WATT, 208 VOLT ELEMENT
16336-4-C	750 WATT, 240 VOLT ELEMENT
16336-4-D	750 WATT, 208 VOLT ELEMENT
16394	NICKEL STRAP--M5
16395	KETTLE ELEMENT JUMPER - 400V ONLY

* STAINLESS STEEL OPTION PARTS

DIPLOMAT 48/60 OZ CORNDITIONER VIEW
MODEL SHOWN WITH SALT/SUGAR AND ONE POP OPTION
 BEGINNING SERIAL 03030355

DOC: DI300023

DI48/60-A-3.3-B
 06/04

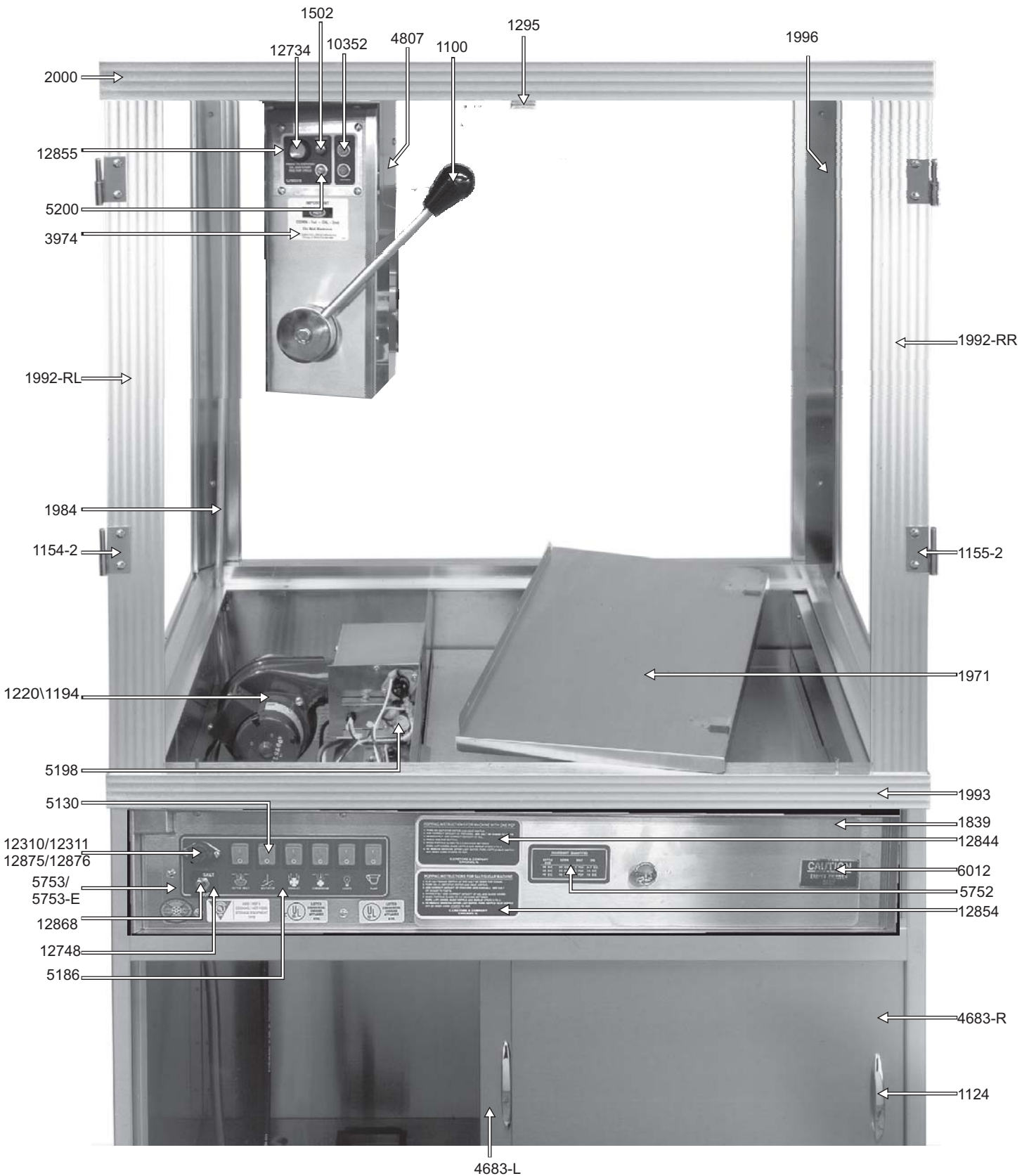

C. CRETORS AND COMPANY
 3243 N. CALIFORNIA AVENUE
 CHICAGO, IL 60618
 PHONE: (773)588-1690, (800)228-1885, FAX: (773)588-2171
 WEB SITE: <http://www.cretors.com> Email: postmaster@cretors.com

DIPLOMAT 48/60 OZ CORNDITIONER VIEW
MODEL SHOWN WITH SALT/SUGAR AND ONE POP OPTION
 BEGINNING SERIAL 03030355

DOC: DI300023

DI48/60-A-3.3-B
 06/04

1066	SWITCH PUSH- BUTTON	10352	INDICATOR LIGHT W/TABS-DUAL
1100	KNOB	12310	FUSE HOLDER UL- 15A
1124	HANDLE	12311	FUSE - 15A-UL
1153	DOOR HINGE STRAP ONLY	12734	SWITCH-DOUBLE POLE PUSH BUTTON
1154-2	HINGE - LEFT	12748	DECAL-SALT/SUGAR
1155-2	HINGE - RIGHT	12844	ONE-POP INSTRUCTION DECAL
1194	BLOWER- 240V (2C914A)	12854	DECAL-POPPING INSTRUCTION SALT/SUGAR
1220	BLOWER - CORNDITIONER	12855	DECAL-DIPLOMAT DUMP COLUMN-ONE POP
1295	MAGNETIC CATCH	12856	DECAL-DIPLOMAT DUMP COLUMN
1502	INDICATOR LIGHT-GREEN	12868	TOGGLE SWITCH-3PDT- ON/OFF
1839	WASTE CORN DRAWER	12875	SWITCH 4-POLE ROTARY
1971	WIRING COMPARTMENT COVER	12876	SWITCH HANDLE AND ON/OFF LABEL
1984	RISER TUBE		
1992-RL	EXTRUSION - DIP. CORNER REAR LEFT	IF EQUIPPED WITH SALT/SUGAR OPTION	
1992-RR	EXTRUSION - DIP. CORNER REAR RIGHT	12178	TIMER
1993	EXTRUSION - DIPLOMAT BOTTOM		
1996	FRONT INSIDE CORNER	STANDARD SWITCH PLATE	
2000	EXTRUSION - DIPLOMAT TOP		
3830	SWITCH-PUSH BUTTON-230 V		
3974	DECAL - CORN 1ST / OIL - 2ND LARGE		
4683-R	DOOR - RIGHT - SS DIP BASE		
4683-L	DOOR LEFT - SS DIP BASE		
4780	DECAL - INSTRUCTIONS		
4807	SUPPORT COLUMN COVER PLATE		
5130	SWITCH - LIGHTED		
5186	DECAL - SWITCHPLATE		
5200	INDICATOR LIGHT		
5752	DECAL-INGREDIENTS		
5753	SWITCH PLATE - DIP ROCKER SW- N/S		
5753-E	SWITCH PLATE-DIP ROCKER N/S-230 V		
5894-A	ELEMENT - CORNDITIONER 500W		
6012	DECAL - CAUTION - EMPTY DRAWER		

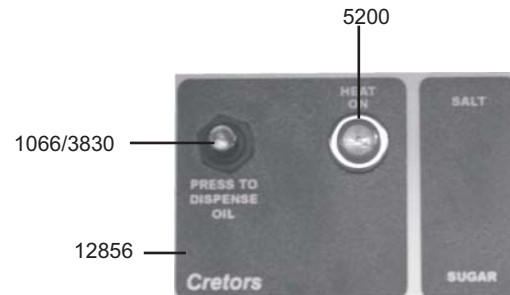

DIPLOMAT 48/60 OZ - TOP VIEW
ONE POP- SALT SUGAR OPTION (NOT SHOWN)
 BEGINNING SERIAL 00050000

DOC: DI300024

DI48/60-A/E-3.2-B
 07/04

ONE POP-SALT SUGAR- OPTION- NOT SHOWN

- 3036 RELAY BASE-8 PIN
- 3037 RELAY
- 10074 RELAY-240V
- 12718 TIMER 120V/230V DUAL

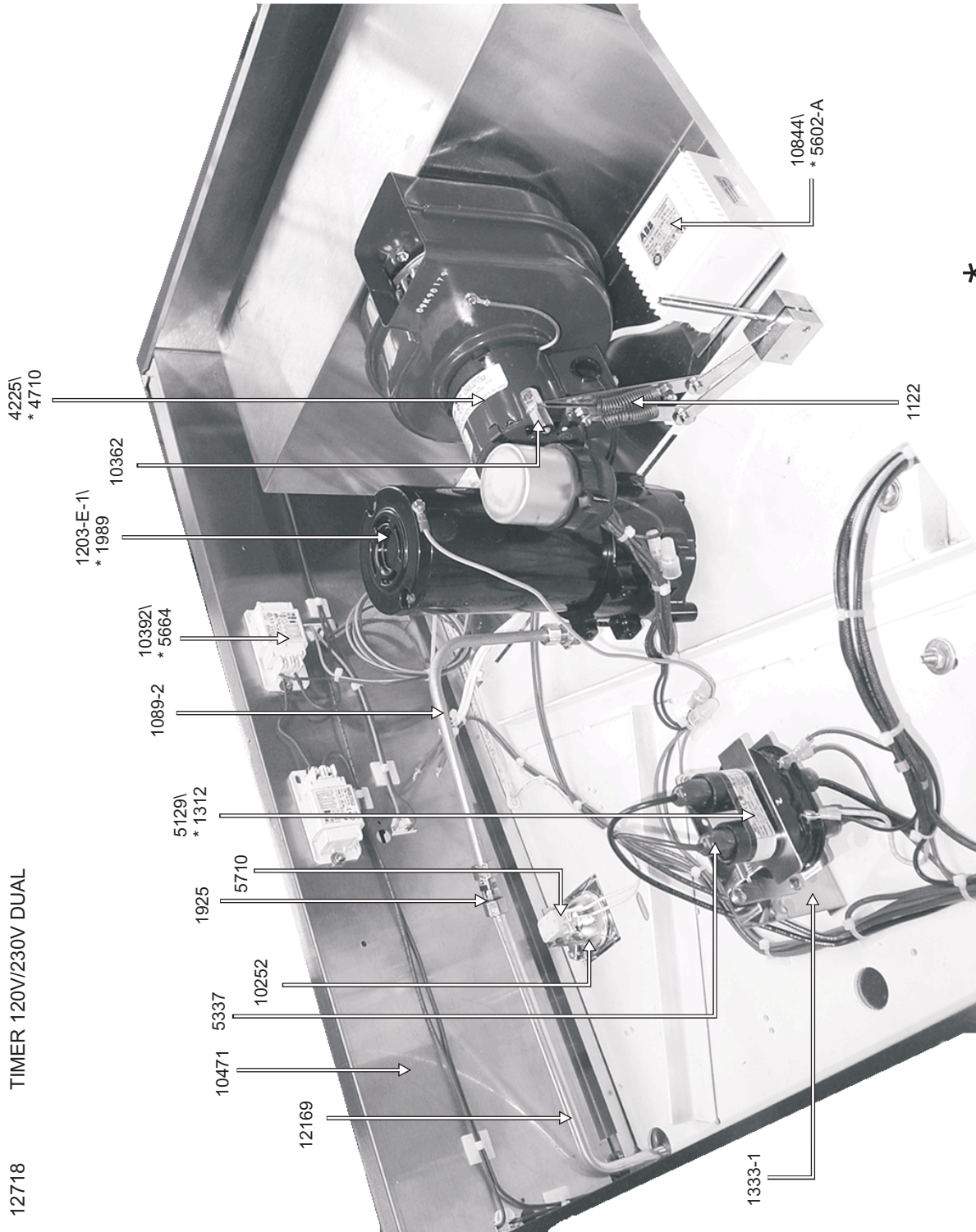

* DOMESTIC

DIPLOMAT 48/60 OZ - TOP VIEW
ONE POP- SALT SUGAR OPTION (NOT SHOWN)

DOC: DI300024

DI48/60-A/E-3.2-B
07/04

BEGINNING SERIAL 00050000

1089-2 DISCHARGE TUBE TOP
1122 SPRING TRIP ARM (2)
1203-E-1 MOTOR-EXPORT
1312 RELAY-120V
1333-1 BRACKET - RELAY MOUNTING
1925 DISCHARGE TUBE COUPLING
1989 MOTOR
4225 BLOWER (230V)
4710 BLOWER(120V)
5129 RELAY- 240 V
5337 VINYL CAP (2)
5664 BALLAST
5710 SOCKET HALOGEN
10252 LAMP HALOGEN (4)
10362 AUTOMATIC COVER LIFT - 48OZ DIPLOMAT
10392 BALLAST-230V (2)
10471 TOP SHELL - SSTS PANEL - DIPLOMAT
10844 TRANSFORMER
12169 RISER TUBE - DI48

NOT SHOWN

5103 SOCKET 450 W - 1 -A (4)
5104 LAMP FLOURESCENT F13T5/CW (2)
10487 SIGN - POPCORN - RED AND YELLOW (1)
10632 SIGN BACKING FOR PN 10487

* DOMESTIC

DIPLOMAT 48/60 OZ - REAR VIEW

BEGINNING SERIAL 99054639 / 99110000

DOC: DI300025

DI48/60-A/E-3.0-B

07/04

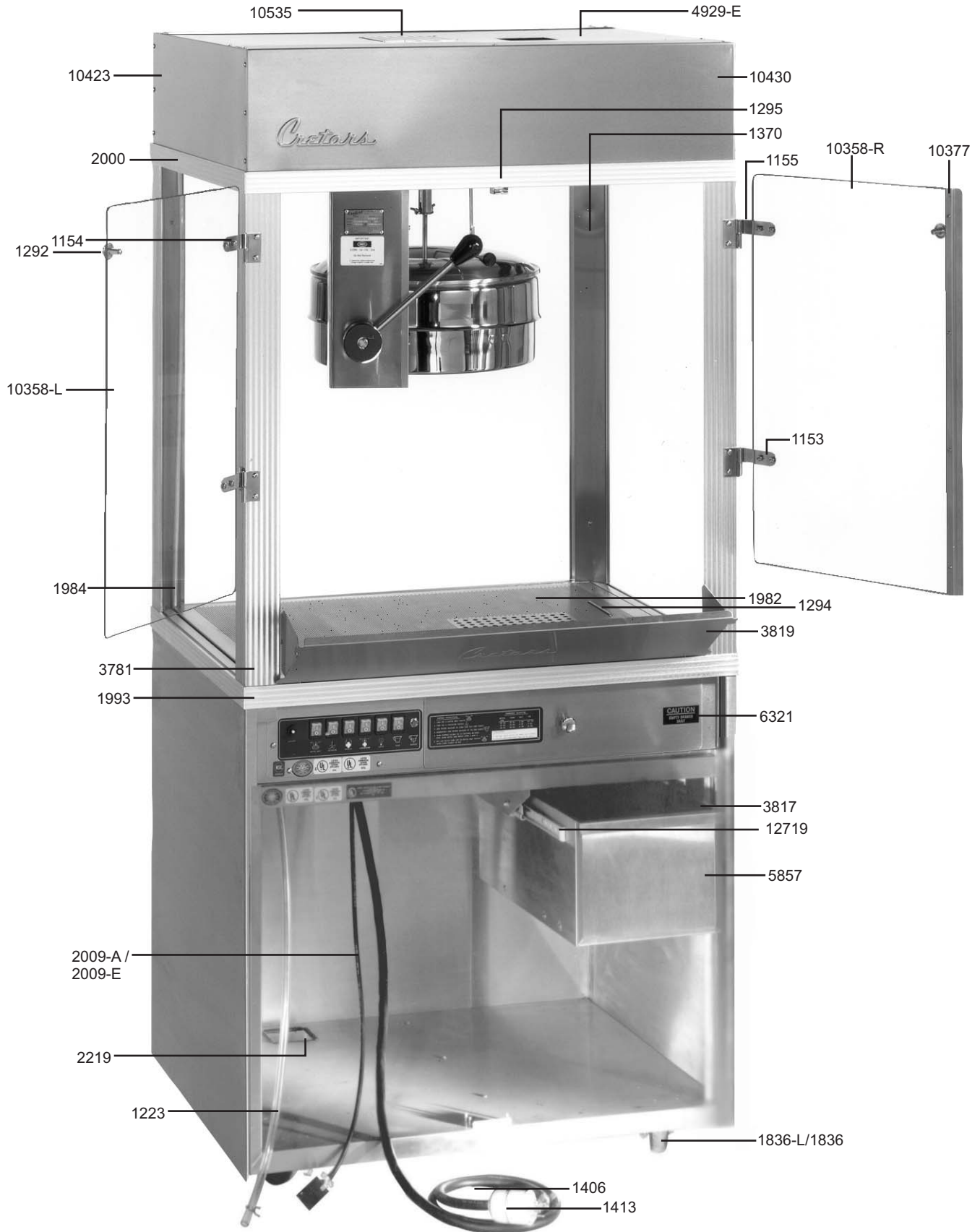

C. CRETORS AND COMPANY
3243 N. CALIFORNIA AVENUE
CHICAGO, IL 60618

PHONE: (773)588-1690, (800)228-1885, FAX: (773)588-2171

WEB SITE: <http://www.cretors.com> Email: postmaster@cretors.com

DIPLOMAT 48/60 OZ - REAR VIEW

BEGINNING SERIAL 99054639 / 99110000

DOC: DI300025

DI48/60-A/E-3.0-B

07/04

1153	DOOR HINGE STRAP ONLY	6321	DECAL - CAUTION 120/208 - 240/60 HZ
1154	DOOR HINGE & STRAP - LEFT	10358-R	PLEXI DOOR - DI48E - RIGHT
1155	DOOR HINGE & STRAP - RIGHT	10358-L	PLEXI DOOR - DI48E - LEFT
1223	TUBING - NALGENE - CLEAR - PER FOOT	10377	DOOR LAP STRIP
1292	KNOB - CONCAVE W/ SCREW	10535	TOP PANEL PATCH
1294	HANDLE - LIFT	12719	DRAWER SLIDES
1295	MAGNETIC CATCH		<u>SIGN OPTION</u>
1370	INSIDE CORNER - REAR	5121	SIGN - POPCORN - RED & WHITE FRONT/REAR
1406	PLUG 50 AMP, 125/250V - 4 WIRE	10487	SIGN - POPCORN - RED & YELLOW - LONG
1413	CORD 30 AMP - PER FOOT		<u>HARDWARE FOR TOP ASSY</u>
1836	CASTER - WITHOUT BRAKE	7642	8-32 x 3/8 SS TRUSS HEAD (12)
1836-L	CASTER - WITH BRAKE	7756	RIVETS (4)
1982	POPPER CASE BOTTOM W/ HANDLE	7789	# 8 STAR LOCKWASHER (12)
1984	RISER TUBE	10539	#6 x 3/8 PHIL TRUSS (14)
1993	EXTRUSION DIPLOMAT BOTTOM		<u>NOT SHOWN</u>
2000	EXTRUSION - DIPLOMAT TOP	1124	HANDLE (FOR BASE DOORS)
2009-A	PUMP CORD & PLUG -1200V	1407	RECEPTACLE - 50A 4 WIRE NEMA 14
2009-E	PUMP CORD & PLUG 230V (EXPORT)	1757	CHANNEL GLASS SOLD PER SIZE OF MACHINE (FOOT)
2219	TRIM PROTECTIVE - POWER CABLE	4683-L	DOOR - LEFT - SS DIP BASE
3781	EXTRUSION-EPR - CORNER	4683-R	DOOR - RIGHT - SS DIP BASE
3819	DROP SHELF - PIVOT STYLE		<u>SWITCH OPTIONS</u>
4830	TOP ASSY - DIP - SSTS - 120V	5653	LOGIC BOARD
4929-E	TOP PANEL - SSTS - SD	5653-1	LOGIC TOUCH PANEL ONLY
10423	TOP SHELL - SIDE - 28" WIDTH (2)	5653-2	LOGIC CONTROL PANEL ONLY
10430	TOP SHELL - BLANK PANEL	10094	INSULATION BOARD ONLY
10471	TOP SHELL - SSTS PANEL-DIPLOMAT		
5851	50# CORN DRAWER REPLACEMENT KIT		
5857	50# CORN DRAWER		
5853	DRAWER SLIDE - PAIR		
5856	CORN DRAWER SLIDE - PAIR		
3817	50# CORN DRAWER COVER		

C. CRETORS AND COMPANY
3243 N. CALIFORNIA AVENUE
CHICAGO, IL 60618

PHONE: (773)588-1690, (800)228-1885, FAX: (773)588-2171

WEB SITE: <http://www.cretors.com> Email: postmaster@cretors.com

DIPLOMAT 48/60 OZ (230/400V) - REAR VIEW

BEGINNING SERIAL: 0409

DOC: DI300028

DI48/60-E/G-3.0-A

03/06

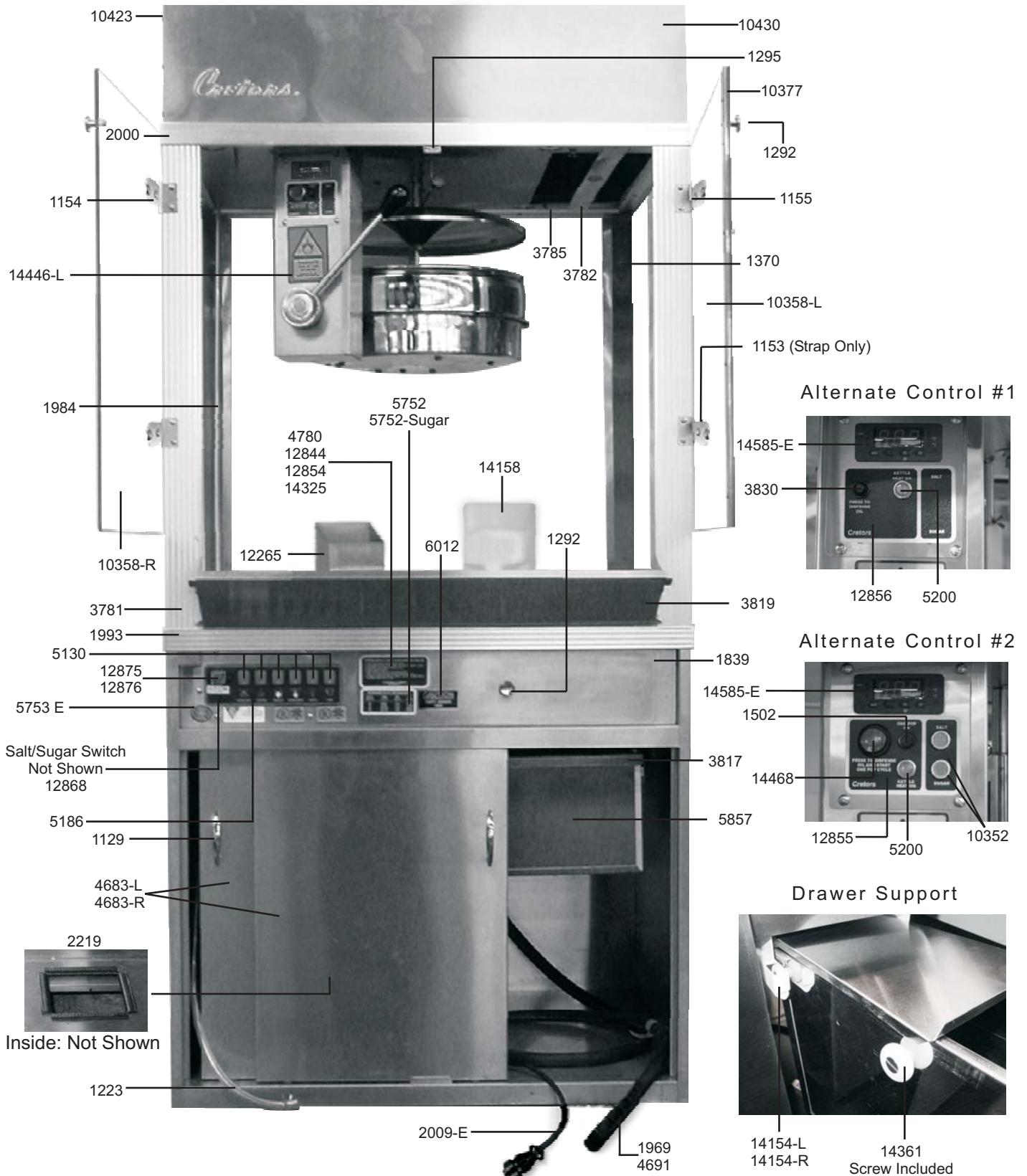

C. CRETORS AND COMPANY
 3243 N. CALIFORNIA AVENUE
 CHICAGO, IL 60618
 PHONE: (773)588-1690, (800)228-1885, FAX: (773)588-2171
 WEB SITE: <http://www.cretors.com> Email: postmaster@cretors.com

DIPLOMAT 48/60 OZ (230/400V) - REAR VIEW

DOC: DI300028

DI48/60-E/G-3.0-A

BEGINNING SERIAL: 0409

03/06

1129	COVER LIFT ROD	10358-L	PLEXI DOOR - DI48E - LEFT
1153	DOOR HINGE (STRAP ONLY)	10377	DOOR LAP STRIP
1154	DOOR HINGE & STRAP - LEFT	12265	MEASURE-CORN-48 OZ
1155	DOOR HINGE & STRAP - RIGHT	12875	SWITCH - 4 POLE ROTARY
1223	TUBING - NALGENE - CLEAR - PER FOOT	12876	SWITCH HANDLE WITH ON/OFF LABEL
1292	KNOB - CONCAVE W/ SCREW	14158	MEASURE-CORN-60 OZ
1295	MAGNETIC CATCH	14361	ROLLER

1370 INSIDE CORNER - REAR

1839 WASTE CORN DRAWER

CONTROL OPTIONS

1969 CORD - 45 AMP - 230V

1066 SWITCH PUSH-BUTTON

1984 RISER TUBE

1502 INDICATOR LIGHT - GREEN

1993 EXTRUSION DIPLOMAT BOTTOM

5200 INDICATOR LIGHT

2000 EXTRUSION - DIPLOMAT TOP

10352 INDICATOR LIGHT WITH TABS

2009-E PUMP CORD & PLUG 230V (EXPORT)

12868 ON/OFF TOGGLE SWITCH

3781 EXTRUSION-EPR - CORNER

14154-L CORN DRAWER SUPPORT - LEFT

3782 GREASE FILTER

14154-R CORN DRAWER SUPPORT - RIGHT

3785 CHARCOAL FILTER

10352 INDICATOR LIGHT WITH TABS

3817 50# CORN DRAWER COVER

14468 SWITCH-DOUBLE POLE-PUSH BUTTON

3819 DROP SHELF - PIVOT STYLE

14585-E DIGITAL CONTROLLER - 230V

4683-L DOOR - LEFT - SS DIP BASE

(Specify: Salt, Sugar, Salt/Sugar Machines)

4683-R DOOR - RIGHT - SS DIP BASE

4691 CORD - 25 AMP - 400V

DECAL OPTIONS

4830 TOP ASSY - DIP - SSTS - 120V

4780 INSTRUCTION

4929-E TOP PANEL - SSTS - SD

5186 SWITCHPLATE

10423 TOP SHELL - SIDE - 28" WIDTH (2)

5752 INGREDIENTS

10430 TOP SHELL - BLANK PANEL

5752-sugar INGREDIENTS - SUGAR

10471 TOP SHELL - SSTS PANEL-DIPLOMAT

6012 CAUTION - EMPTY DRAWER DAILY

5130 SWITCH - LIGHTED - 230V

12844 ONE-POP INSTRUCTION

5753-E SWITCHPLATE

12854 POPPING INSTRUCTIONS - SALT/SUGAR

5857 50# CORN DRAWER

12855 DECAL-DIPLOMAT DUMP COLUMN - ONE POP

10358-R PLEXI DOOR - DI48E - RIGHT

12856 DECAL-DIPLOMAT DUMP COLUMN

C. CRETORS AND COMPANY
3243 N. CALIFORNIA AVENUE
CHICAGO, IL 60618

PHONE: (773)588-1690, (800)228-1885, FAX: (773)588-2171

WEB SITE: <http://www.cretors.com> Email: postmaster@cretors.com

DIPLOMAT 48/60 OZ (230/400V) - REAR VIEW

DOC: DI300028

D148/60-E/G-3.0-A

BEGINNING SERIAL: 0409

03/06

14325 SALT/SUGAR ONE-POP

14446-L CORN FIRST WARNING

NOT SHOWN

1124 HANDLE (FOR BASE DOORS)

1294 HANDLE-LIFT

1369 INSIDE CORNER - FRONT

1407 RECEPTACLE - 50A 4 WIRE NEMA 14

1757 CHANNEL GLASS
SOLD PER SIZE OF MACHINE (FOOT)

1836 CASTER - WITHOUT BRAKE

1836-L CASTER - WITH BRAKE

1982 POPPER CASE BOTTOM W/HANDLE

2219 TRIM PROTECTIVE - POWER CABLE

10535 TOP PANEL PATCH

C. CRETORS AND COMPANY
3243 N. CALIFORNIA AVENUE
CHICAGO, IL 60618

PHONE: (773)588-1690, (800)228-1885, FAX: (773)588-2171

WEB SITE: <http://www.cretors.com> Email: postmaster@cretors.com

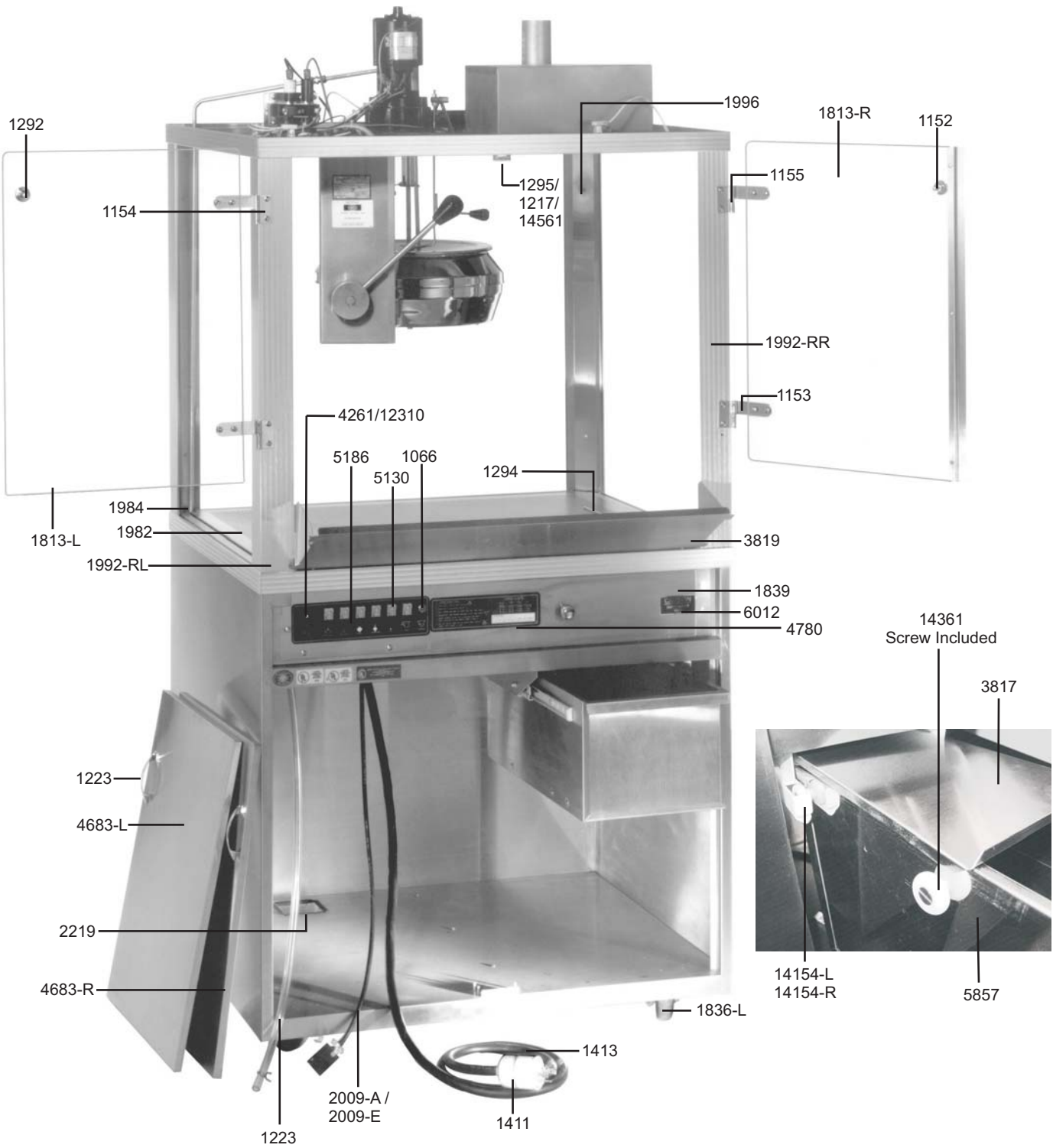

DIPLOMAT 32OZ. - BACK VIEW

BEGINNING SERIAL: 0606

DOC: DI300029

DI32-A/E-3.0-E
06/06

1066	SWITCH - PUSH BUTTON	5857	50# CORN DRAWER
1124	HANDLE (FOR BASE DOORS)	6012	DECAL - CAUTION 120/208 - 240/60 HZ
1152	DOOR LAP STRIP	12310	FUSE HOLDER
1153	DOOR HINGE STRAP ONLY	14154-L	CORN DRAWER SUPPORT - LEFT
1154	DOOR HINGE & STRAP - LEFT(2)	14154-R	CORN DRAWER SUPPORT - RIGHT
1155	DOOR HINGE & STRAP - RIGHT (2)	14361	ROLLER-DRAWER RUNNER
1217	MAGNETIC CATCH-RECTANGULAR	14561	CLIP-MAGNET-DIPLOMAT
1223	TUBING - NALGENE - CLEAR - PER FOOT		
1292	KNOB - CONCAVE W/ SCREW (2)		
1294	HANDLE - LIFT		
1295	MAGNETIC CATCH		
1411	PLUG 30 AMP, 125/250V - 4 WIRE		
1413	CORD 30 AMP - PER FOOT		
1813-L/R	PLEXI-DOOR - LEFT/RIGHT (DRILLED)		
1836	CASTER - WITHOUT BRAKE		
1836-L	CASTER - WITH BRAKE		
1839	WASTE CORN DRAWER		
1982	POPPER CASE BOTTOM W/ HANDLE		
1984	RISER TUBE		
1992-RL	EXTRUSION DIP. CORNER - REAR LEFT		
1992-RR	EXTRUSION DIP. CORNER - REAR RIGHT		
1996	INSIDE CORNER - REAR		
2009-A	PUMP CORD & PLUG -1200V		
2009-E	PUMP CORD & PLUG 230V (EXPORT)		
2219	TRIM PROTECTIVE - POWER CABLE		
3817	50# CORN DRAWER COVER		
3819	DROP SHELF - PIVOT STYLE		
4261	CIRCUIT BREAKER - 120V/15A PUSH BUTTON		
4683-L	DOOR - LEFT - SS DIP BASE		
4683-R	DOOR - RIGHT - SS DIP BASE		
4780	DECAL - INSTRUCTION 20/32/48 OZ		
5130	SWITCH-LIGHTED		
5186	DECAL - SWITCHPLATE - DIP - ROCKER SWITCH		
5851	50# CORN DRAWER REPLACEMENT KIT		

C. CRETORS AND COMPANY
3243 N. CALIFORNIA AVENUE
CHICAGO, IL 60618

PHONE: (773)588-1690, (800)228-1885, FAX: (773)588-2171
WEB SITE: <http://www.cretors.com> Email: postmaster@cretors.com

DIPLOMAT 20/32 OZ CORNDITIONER VIEW
MODEL SHOWN WITH SALT/SUGAR AND ONE POP OPTION
 BEGINNING SERIAL : 0606

DOC: DI300030

DI20/32-A-3.3-C
 06/06

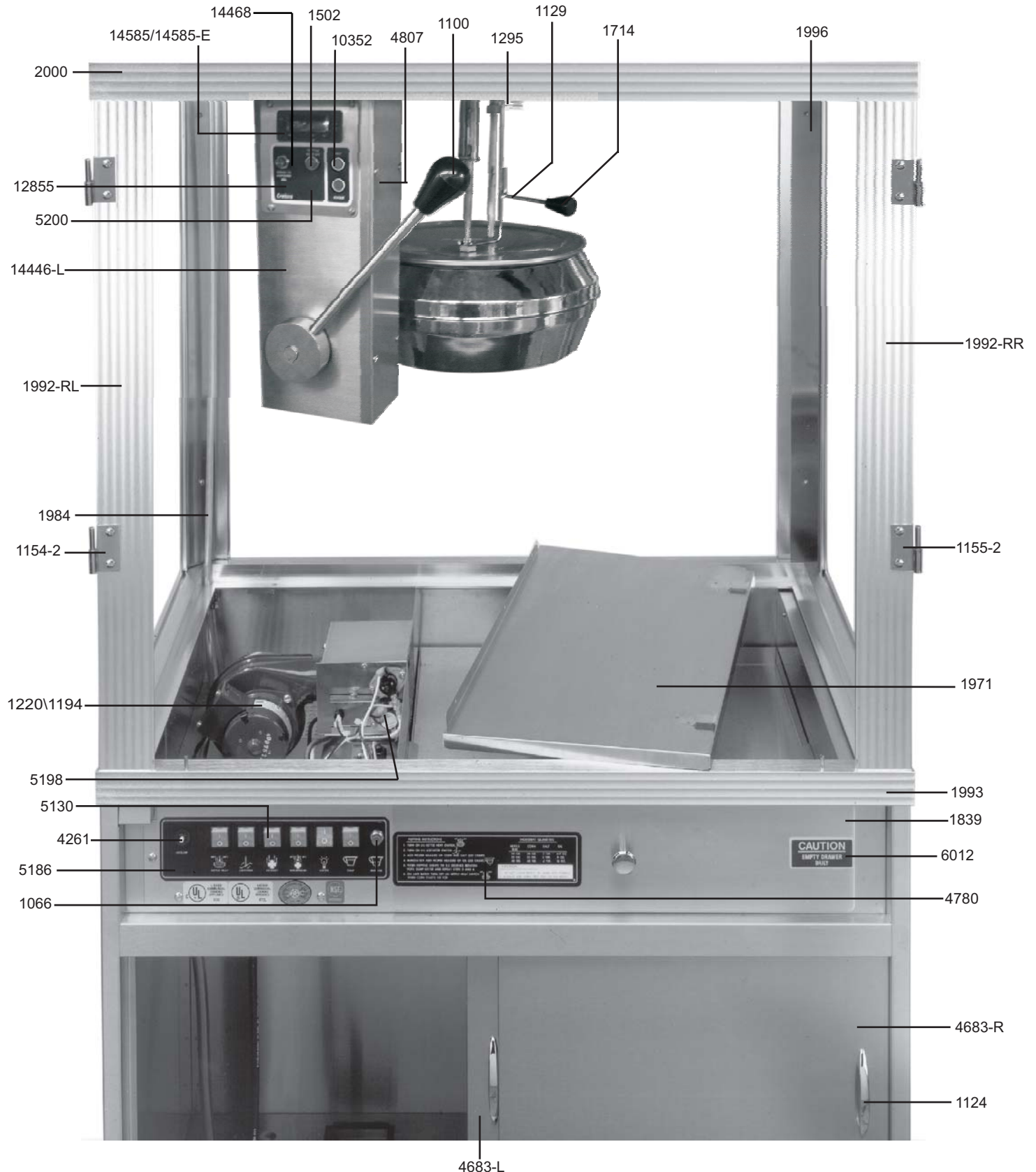

C. CRETORS AND COMPANY
 3243 N. CALIFORNIA AVENUE
 CHICAGO, IL 60618
 PHONE: (773)588-1690, (800)228-1885, FAX: (773)588-2171
 WEB SITE: <http://www.cretors.com> Email: postmaster@cretors.com

DIPLOMAT 20/32 OZ CORNDITIONER VIEW
MODEL SHOWN WITH SALT/SUGAR AND ONE POP OPTION

DOC: DI300030

DI20/32-A-3.3-C
 06/06

BEGINNING SERIAL : 0606

1066	SWITCH PUSH- BUTTON	6012	DECAL - CAUTION - EMPTY DRAWER
1100	KNOB	10352	INDICATOR LIGHT W/TABS-DUAL
1124	HANDLE	12854	DECAL-POPPING INSTRUCTION SALT/SUGAR
1129	COVER LIFT ROD	12855	DECAL-DIPLOMAT DUMP COLUMN-ONE POP
1153	DOOR HINGE STRAP ONLY	12856	DECAL-DIPLOMAT DUMP COLUMN
1154-2	HINGE - LEFT	14446-L	DECAL-CORN FIRST WARNING - LARGE
1155-2	HINGE - RIGHT	14468	SWITCH-DOUBLE POLE-PUSH BUTTON-ONE POP
1194	BLOWER- 240V (2C914A)	14585	DIGITAL CONTROLLER - 120V
1220	BLOWER - CORNDITIONER	14585-E	DIGITAL CONTROLLER - 230V
1295	MAGNETIC CATCH		
1502	INDICATOR LIGHT-GREEN		IF EQUIPPED WITH SALT/SUGAR OPTION
1714	KNOB	12178	TIMER
1839	WASTE CORN DRAWER		
1971	WIRING COMPARTMENT COVER		STANDARD SWITCH PLATE
1984	RISER TUBE		
1992-RL	EXTRUSION - DIP. CORNER REAR LEFT		
1992-RR	EXTRUSION - DIP. CORNER REAR RIGHT		
1993	EXTRUSION - DIPLOMAT BOTTOM		
1996	FRONT INSIDE CORNER		
2000	EXTRUSION - DIPLOMAT TOP		
3830	SWITCH-PUSH BUTTON-230 V		
4261	CIRCUIT BREAKER - 120V/12A-PUSH		
4683-R	DOOR - RIGHT - SS DIP BASE		
4683-L	DOOR LEFT - SS DIP BASE		
4780	DECAL - INSTRUCTIONS		
4807	SUPPORT COLUMN COVER PLATE		
5130	SWITCH - LIGHTED		
5186	DECAL - SWITCHPLATE		
5200	INDICATOR LIGHT		
5753	SWITCH PLATE - DIP ROCKER SW- N/S		
5753-E	SWITCH PLATE-DIP ROCKER N/S-230 V		
5894-A	ELEMENT - CORNDITIONER 500W		

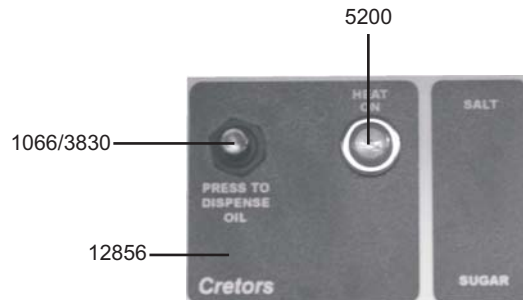

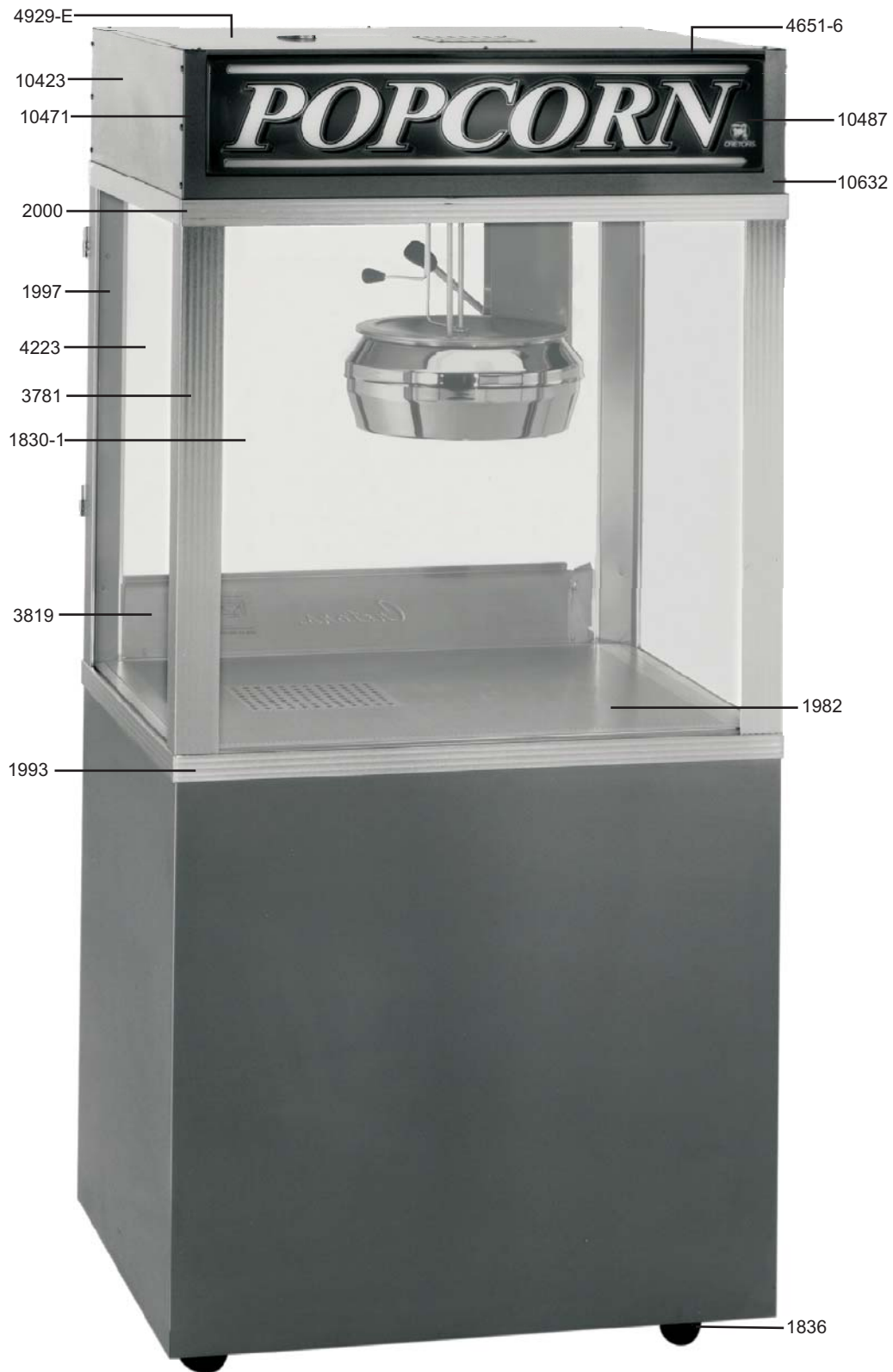

DIPLOMAT 20/32 OZ - FRONT VIEW

BEGINNING SERIAL: 0606

DOC: DI300031

DI20/32-A/E-3.1-D
06/06

- 1829-1 GLASS (SIDE) DIPLOMAT TEMPERED
23-5/16" x 29-11/16" x 1/8"(NOT SOLD AT FACTORY)
- 1830-1 GLASS (FRONT) DIPLOMAT TEMPERED
29-3/4" x 31-1/4" x 1/8" (NOT SOLD AT FACTORY)
- 1836 CASTER WITHOUT BRAKE
- 1982 POPPER CASE BOTTOM W/ HANDLE
- 1993 EXTRUSION - DIPLOMAT BOTTOM
- 1997 INSIDE CORNER (REAR)
- 2000 EXTRUSION - DIPLOMAT TOP
- 3781 EXTRUSION - CORNER
- 3819 DROP SHELF

SIGN OPTION

- 5121 SIGN - POPCORN - RED & WHITE (NOT SHOWN)
- 10487 SIGN - POPCORN - RED & YELLOW
- 10632 SIGN BACKING

TOP ASSEMBLY

- 4651-6 TOP SIGN BRACKET
- 4929-E TOP PANEL SSTS-SD
- 10423 TOP SHELL - SIDE 28" WIDTH
- 10471 TOP SHELL - SSTS PANEL

HARDWARE FOR TOP ASSEMBLY

- 12848 # 8 SHEETMETAL SCREW-SS-3/8 LONG (12)
- 10539 6 x 3/8 PHIL HEAD-SHT MTL (6)

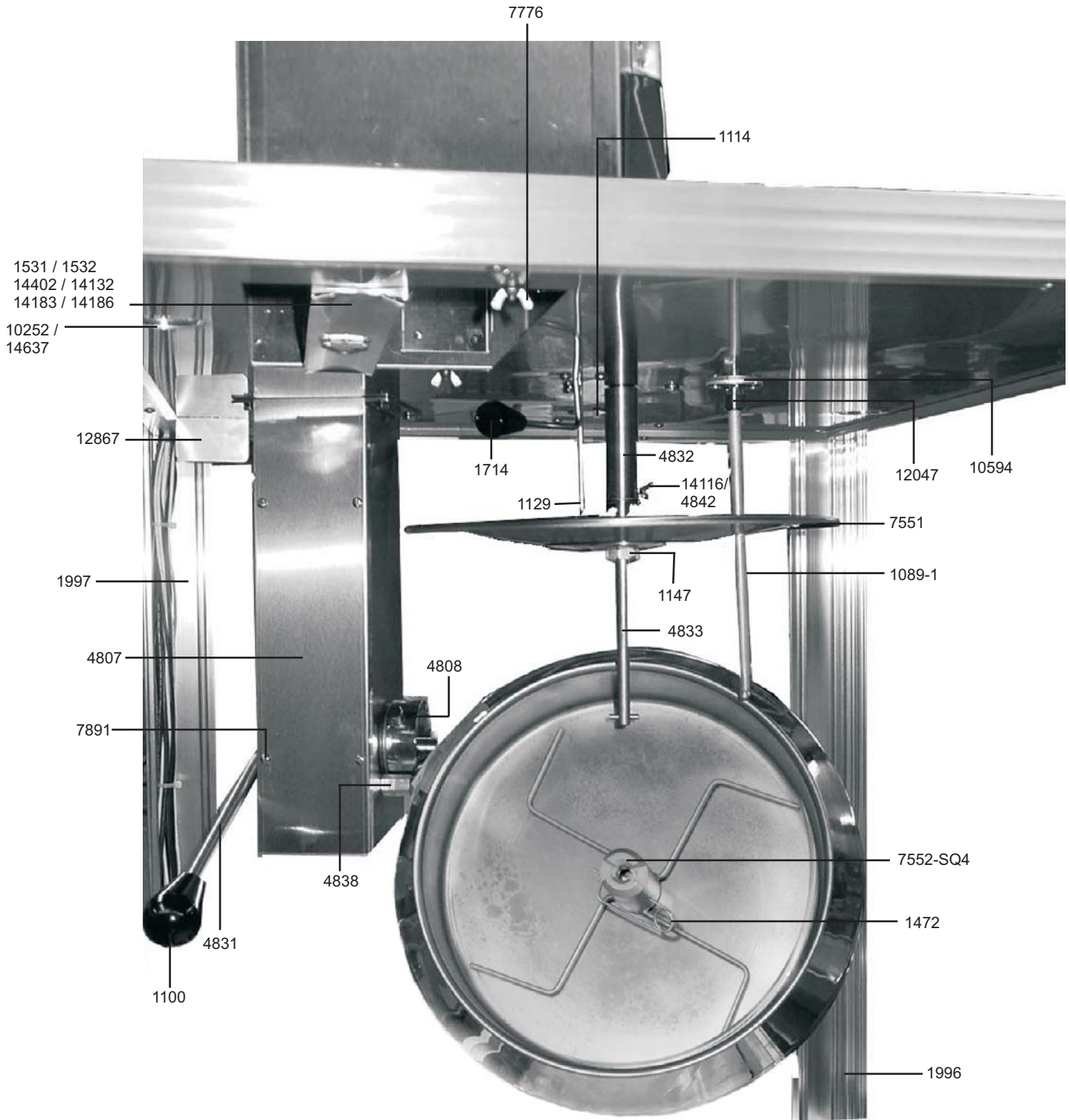

DIPLOMAT - INSIDE VIEW

BEGINNING SERIAL: 0702

DOC: Di300041

DI32-A/E-3.1-E

10/07

1089-1	BOTTOM DISCHARGE TUBE
1100	KNOB
1114	HEX CONNECTOR SET SCREW
1129	COVER LIFT ROD
1147	COVER CENTER AND NUT
1472	STIRRER BLADE RETAINING SPRING
1531	FILTER - GREASE
1714	KNOB
1996	FRONT INSIDE CORNER - DIP
1997	REAR INSIDE CORNER - DIP
4807	SUPPORT COLUMN COVER PLATE
4808	ECCENTRIC DIP SPRING RETURN
4831	DUMP HANDLE - SPRING DUMP
4832	DRIVE SHAFT CONNECTOR
4833	DRIVE SHAFT & PIN - SPRING DUMP
4838	STOP BLOCK
4842	SHAFT/CONNECTOR BOLT W/ WING NUT
7551	KETTLE COVER
7552-SQ4	STIRRER BLADE-DIP-4 SQUARE BLADES
7776	8-32 STEEL WING NUT
7891	8-32 x 3/16 SS PAN HEAD SCREW
10594	OIL TUBE NUT W/ SCREW
10252	LAMP-HALOGEN
12047	BULK HEAD UNION
12867	LIGHT BAFFLE
14116	KETTLE SHAFT PIN

NOT SHOWN

1532	CHARCOAL FILTER-W/CHARCOAL
14132	REPLACEABLE 9" x 12" FILTER (NEW DESIGN)
14183	FILTER HOUSING FOR 6" x 12" (SECURED WITH WING NUTS)
14186	REPLACEABLE 9" x 12" FILTER (OLD STYLE)
14402	FILTER HOUSING FOR 9" x 12" LIFT OUT
14637	HALOGEN LIGHT COVER

C. CRETORS AND COMPANY
3243 N. CALIFORNIA AVENUE
CHICAGO, IL 60618

PHONE: (773)588-1690, (800)228-1885, FAX: (773)588-2171
WEB SITE: <http://www.cretors.com> Email: postmaster@cretors.com

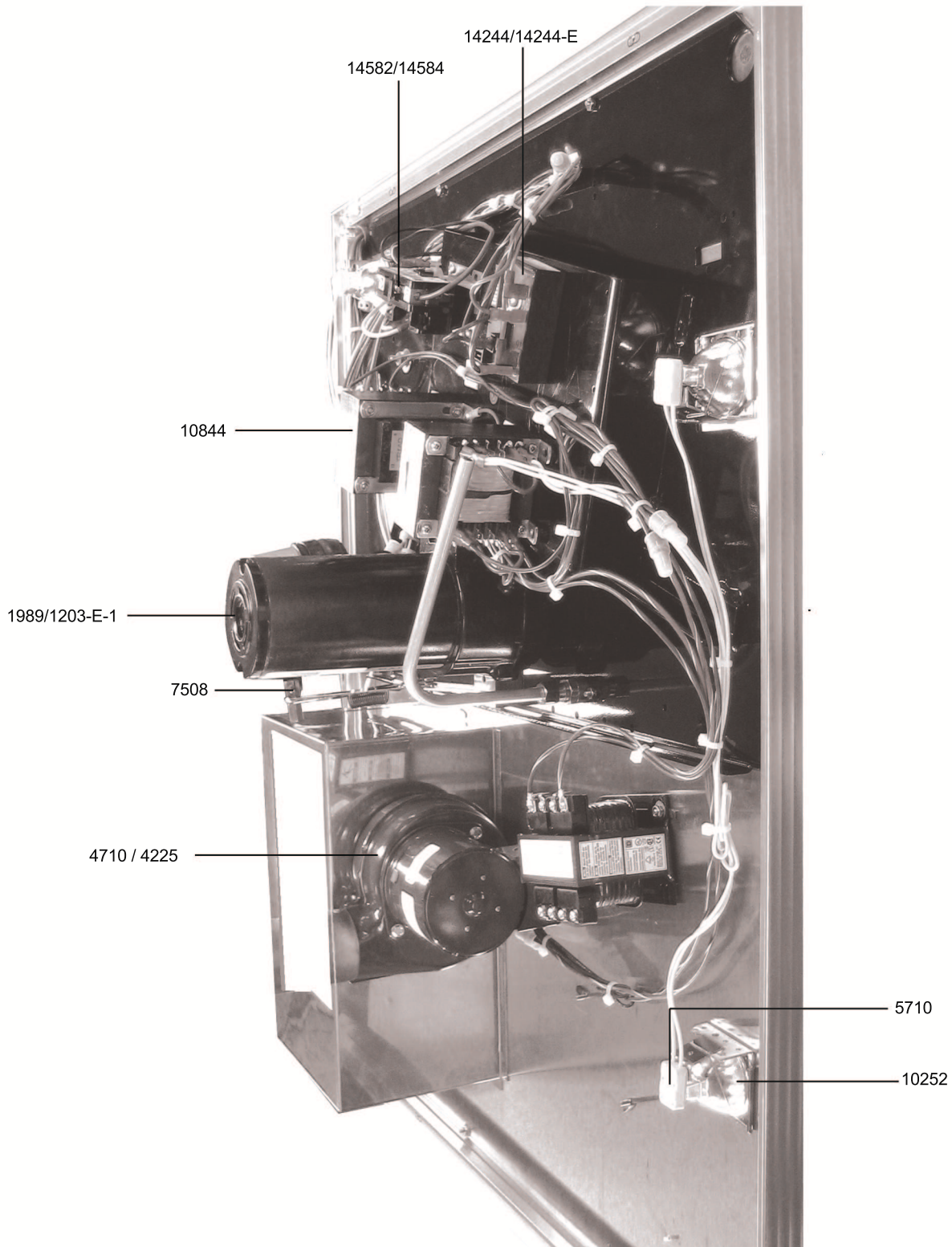

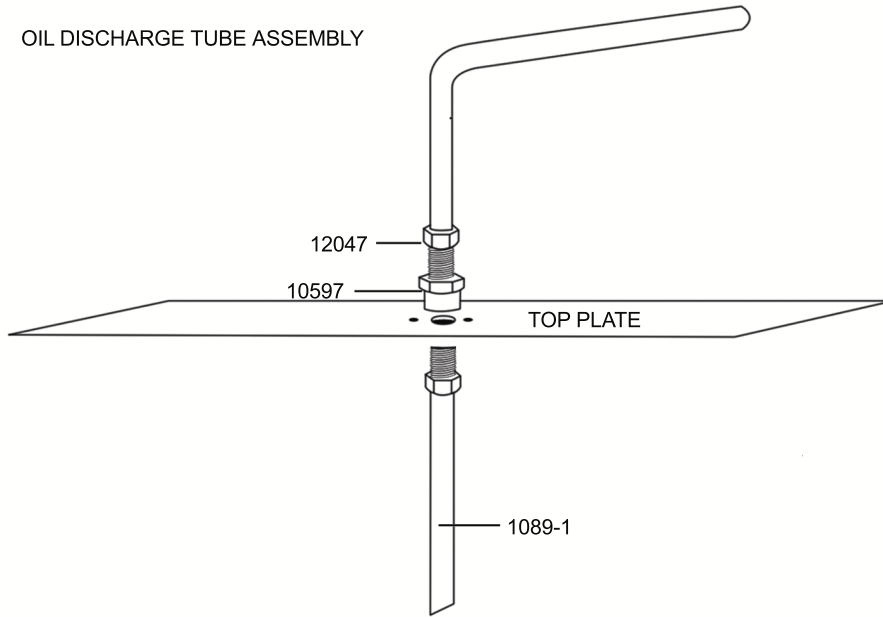

1089-1	DISCHARGE TUBE BOTTOM	10597	OIL TUBE SPACER
1203-E-1	MOTOR-EXPORT	10844	TRANSFORMER-100W,120V/230V-12V/24V
1989	MOTOR	12047	BULK HEAD UNION
4225	BLOWER-EXHAUST 230V	14244	TIMER/RELAY- 1 POP- 120V
4710	BLOWER-EXHAUST 120V	14244-E	TIMER/RELAY- 1 POP- 230V
5710	SOCKET-HALOGEN-QCX-34	14582	RELAY-120V.-DOUBLE POLE
7508	AUTOMATIC COVER LIFT	14584	RELAY-230V.-DOUBLE POLE
10252	LAMP-HALOGEN-Q50MR16C/CG55		

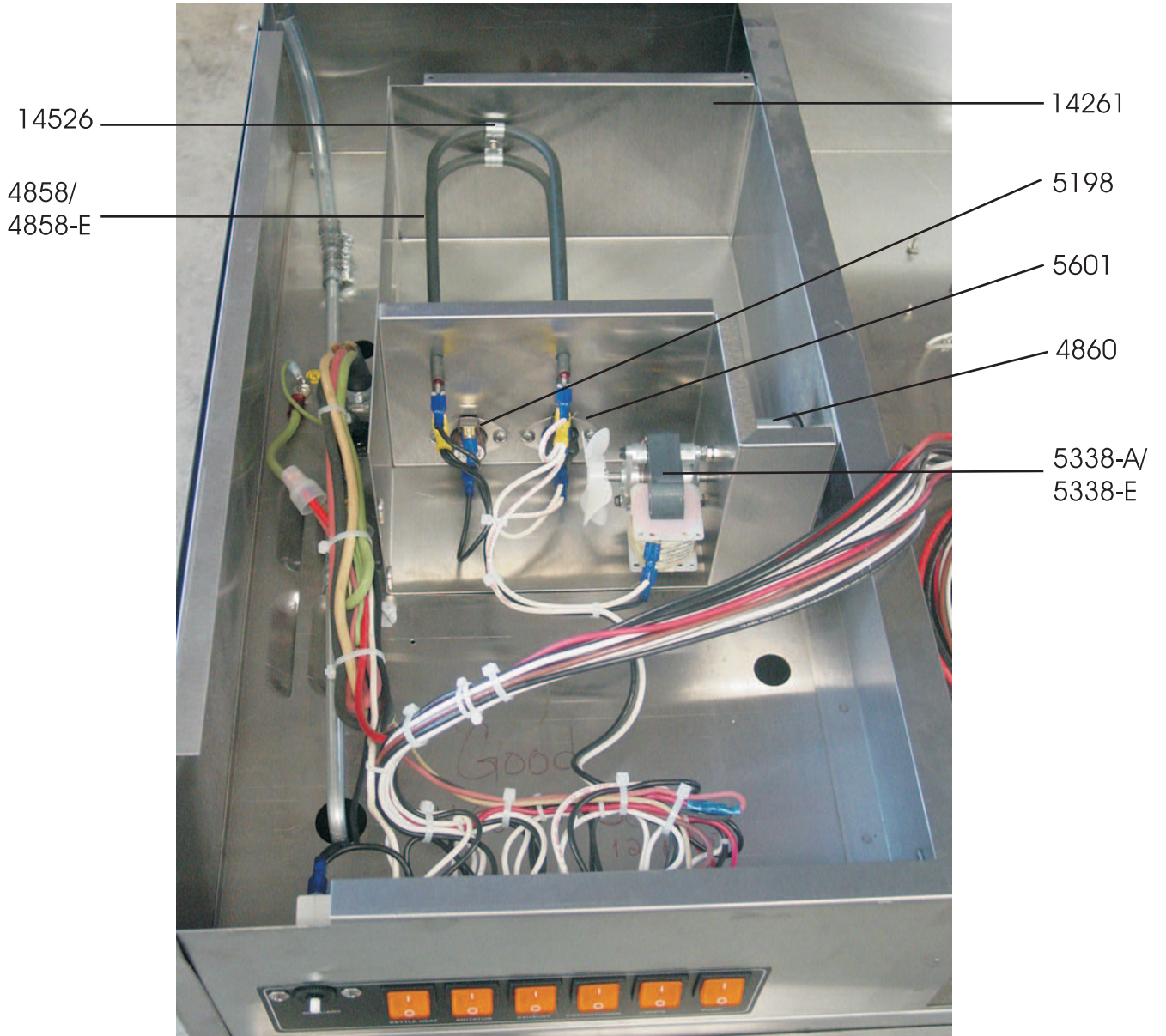

- | | | |
|--------|-------------------------------------|--------------------|
| 5198 | THERMOSTAT | 5201-2-A |
| 5601 | HIGH LIMIT - 200 DEGREES FAHRENHEIT | CORNDITIONER ASSY- |
| 5338-A | MOTOR BLOWER - 120V | REMOVABLE - 120V |
| 5338-E | MOTOR BLOWER - 230V | |
| 4858 | ELEMENT CORNDITIONER - 400W - 120V | 5201-2-E |
| 4858-E | ELEMENT CORNDITIONER - 400W - 230V | CORNDITIONER ASSY- |
| 4860 | BLOWER WHEEL | REMOVABLE - 230V |
| 14261 | CORNDITIONER BOX | |
| 14526 | CLAMP - DUAL 3/8 BX | |

**DIPLOMAT 48/60 OZ.
MOTOR AND KETTLE ASSEMBLY**

DOC: Di300048e

DI48/60-C/D/E/G-2.3-E

07/11

BEGINNING SERIAL: 11070000

ANY OF THESE "PIN" OPTIONS
WILL WORK WITH ALL DIPLOMATS,
BUT 14947 IS RECOMMENDED
FOR ALL REPLACEMENT ORDERS.

OLD STYLES

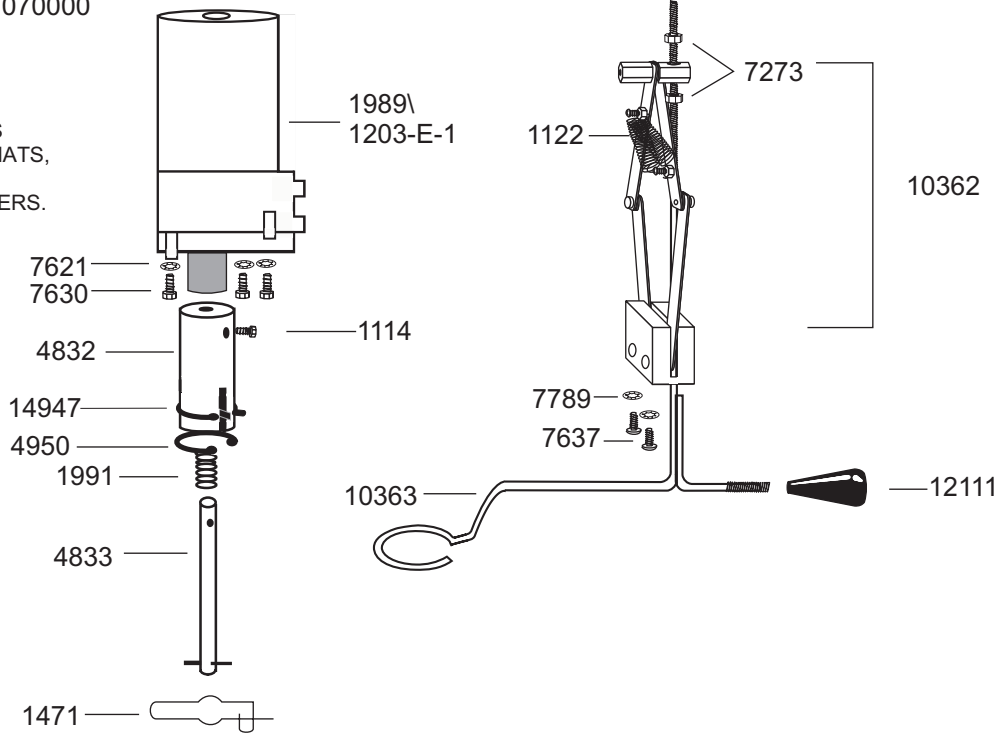
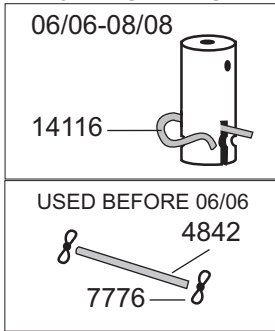

BEFORE 2/17/11
USED 14602
BETWEEN 2/17/11
AND 6/13/11
USED 16550
AFTER 6/13/11
16613

BEFORE 6/13/11
USED 14601
AFTER 6/13/11
16614

NOTE:
If replacing 10365 cover with 14601,
14601-KIT needs to be ordered to
install correctly.

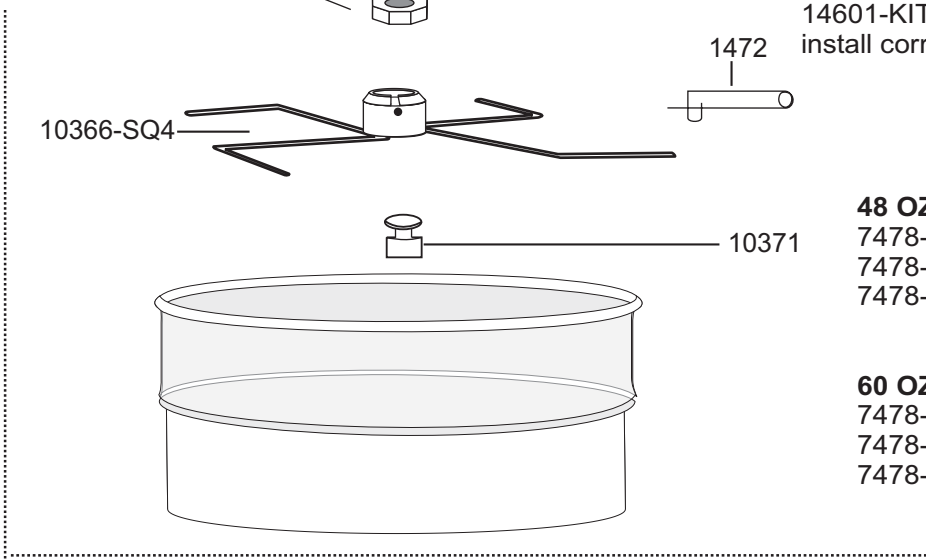

48 OZ. KETTLE

- 7478-48-C 120/240V (230V)
- 7478-48-D 120/208V
- 7478-48-G 400V

60 OZ. KETTLE

- 7478-60-C 120/240V (230V)
- 7478-60-D 120/208V
- 7478-60-G 400V

DIPLOMAT 48/60 OZ.
MOTOR AND KETTLE ASSEMBLY

DOC: Di300048e

DI48/60-C/D/E/G-2.3-E
07/11

BEGINNING SERIAL: 11070000

1114 HEX CONNECTOR SET SCREW
1122 TRIP ARM SPRING
1147 NSF-COVER CENTER AND NUT
1203-E-1 MOTOR-PINNED EXPORT
1471 COVER RETAINING SPRING
1472 STIRRER BLADE RETAINING SPRING
1989 MOTOR DOMESTIC
1991 SPRING
4832 DRIVE SHAFT CONNECTOR
4833 DRIVE SHAFT AND PIN SPRING DUMP
4842 SHAFT/CONNECTOR BOLT W/ WING NUT-
REPLACED BY 14116
4950 RETAINING RING
7273 ¼ x 20 HEX STOP NUT
7621 1/4" INTERNAL TOOTH LOCKWASHER
7630 1/4 x 20 x 1/2" HEX BOLT
7637 8-32 x 1/2 SS TRUSS HEAD
7776 8-32 STEEL WING NUT
7789 #8 STAR LOCKWASHER
7865 10-32 ELASTIC STOP NUT
10362 AUTOMATIC COVER LIFT
10363 COVER LIFT ROD
10365 KETTLE COVER (OLD STYLE)
10366-SQ4 STIRRER BLADE-SQUARE
10371 PAN CENTER
12111 KNOB
14116 KETTLE SHAFT PIN
14601 KETTLE COVER (NEW STYLE)
14602 COVER CENTER & NUT
14947 CLIP - MOTOR DRIVE
16550 COVER CENTER & NUT-FIXED
16613 COVER CENTER & NUT-16 DIA PAN-7/8" HEX
16614 KETTLE COVER-DI 48/60 OZ.-9/16" HOLE

C. CRETORS AND COMPANY
3243 N. CALIFORNIA AVENUE
CHICAGO, IL 60618
PHONE: (773)588-1690, (800)228-1885, FAX: (773)588-2171
WEB SITE: [Http://www.cretor.com](http://www.cretor.com) Email: postmaster@cretors.com

MACH 5 & DIPLOMAT 48/60 OZ

AGITATOR DRIVE SYSTEM

BEGINNING SERIAL: 1807

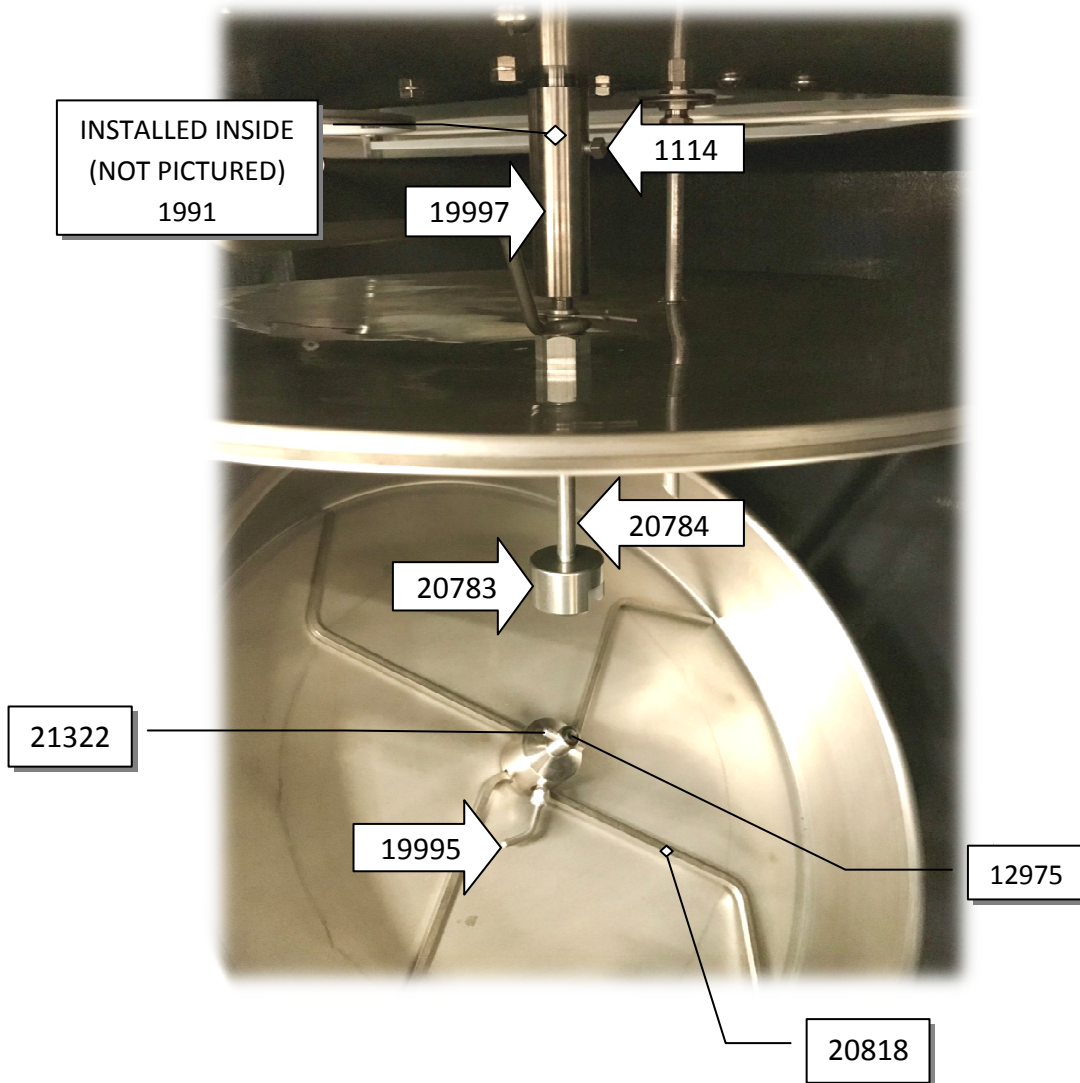

PART NUMBER	DESCRIPTION	QUANTITY
1991	SPRING, 0.125" PITCH, 0.036" WIRE DIAMETER	1
1114	1/4-20 X 3/8"LG, SQ HD SET SCREW, CUP POINT, 18-8 S.S.	1
19997	SHAFT CONNECTOR	1
20784	DRIVE SHAFT, M5/DI, 16" KETTLE	1
20783	CLUTCH DOG, M5/DI, 16" KETTLE	1
21322	3/16"DIA X 1"LG, GROOVED PIN, 18-8 S.S.	1
12975	1/4-28 X 3/16"LG, SOCKET SET SCREW, CUP POINT, ALLOY PLAIN	1
20818	STIRRER BLADE WELDMENT, M5/DI, 16" KETTLE	1
19995	RETAINING PIN, STIRRER BLADE	1

C. CRETORS AND COMPANY
 176 MITTEL DRIVE
 WOOD DALE, IL 60191
 PHONE: (847) 616-6900, (800) 228-1885
 FAX: (847) 616-6970
 WEBSITE: WWW.CRETORS.COM
 EMAIL: POSTMASTER@CRETORS.COM



POP N' ROLL

BEGINNING SERIAL: 00094725

DOC: PNR30001

PNR-3.1-A

02/01

1202 RECEPTACLE 15A SNAP IN OUTLET
1370 INSIDE CORNER REAR ENCL PRES
3781 EXTRUSION-EPR-CORNER-NEW STYLE
4230 EXTRUSION -TEPR TOP
4231 EXTRUSION -TEPR BOTTOM
4780 DECAL INSTRUCTION20/32/48 OZ
5130 SWITCH LIGHTED 230V
5186 DECAL SWITCHPLATE-DIP-ROCKER
5340 CORN GUARD TDI & TEPR W/O BF
10423 TOP SHELL-SIDE-28" WIDTH
10452 TOP SHELL-SSTS PANEL-TDI W/S
10487 SIGN-POPCORN-RED & YELLOW
10542 TOP PANEL TDI48E
10806 CASTER W/OUT BRAKE
10806-L CASTER W/ BRAKE - TDI - R&R
10808 BASE PANEL RT AND CORNER - TDI/P-N-R
10809 BASE PANEL LEFT AND CORNER TDI/P-N-R
10810 REAR TOP TRIM TDI/ P-N-R
11033 25 AMP DISCONNECT 3 POLE + NUETRAL
12113 DECAL ROCK N ROLL
12089 100# CORN DRAWER
12090 CLEAN OUT DRAWER
12091-L SLIDING DRAWER LEFT
12091-R SLIDING DRAWER RIGHT

C. CRETORS AND COMPANY

176 MITTEL DRIVE

WOOD DALE, IL 60191

PHONE: (847)616-6900, (800)228-1885, FAX: (847)616-6970

WEB SITE: <http://www.cretors.com>

POP N' ROLL- TOP INSIDE VIEW

BEGINNING SERIAL: 00094725

DOC: PNR30002

PNR-3.1-A

10/2000

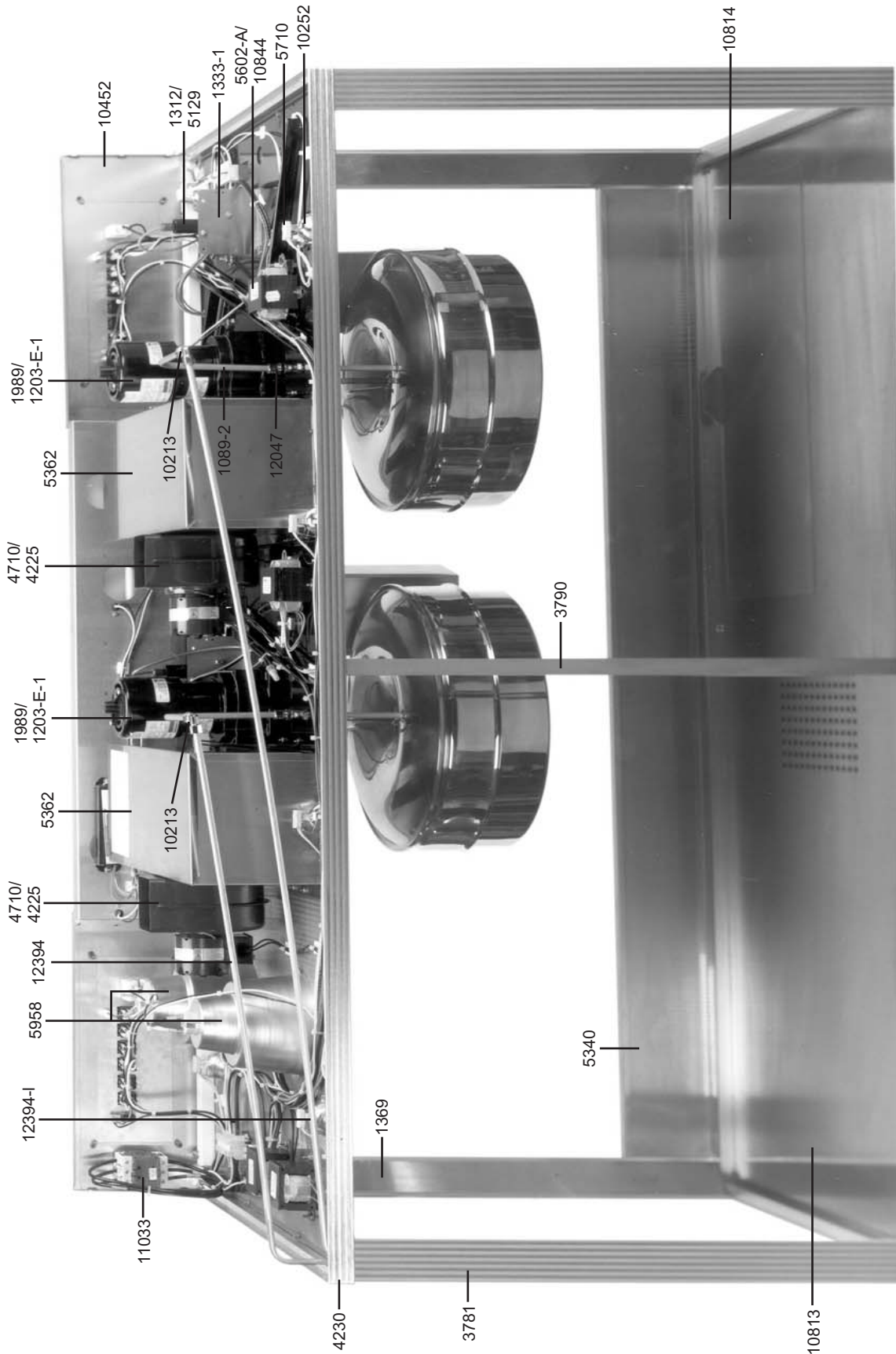

C. CRETORS AND COMPANY

176 MITTEL DRIVE

WOOD DALE, IL 60191

PHONE: (847)616-6900, (800)228-1885, FAX: (847)616-6970

WEB SITE: <http://www.cretors.com>

POP N' ROLL- TOP INSIDE VIEW

BEGINNING SERIAL: 00094725

DOC: PNR30002

PNR-3.1-A

10/2000

1089-2	DISCHARGE TUBE TOP
1203-E-1	MOTOR BISON MODEL EP-5280
1312	RELAY 115 VOLT
1333-1	BRACKET-RELAY MOUNTING
1369	INSIDE CORNER (FRONT)-ENCL PRES
1989	MOTOR IS THE SAME AS 1203-E-1
3790	CENTER GLASS HOLDER EPR
4225	BLOWER-230V(2C916)
4230	EXTRUSION TEPR TOP
4710	BLOWER-120V (1C982B)
5129	RELAY 2-POLE, 240V COIL
5340	CORN GUARD-TDI & TEPR W/O BF
5362	FILTER HOUSING TDI/5"DIP
5710	SOCKET-HALOGEN
5958	LAMP GUARD- SPUN
10213	COUPLING-RIGHT ANGLE
10252	LAMP-HALOGEN
10452	TOP SHELL-SSTS PANEL-TDI W/S
10813	POPPER CASE BTTM-TDI/POP-N-ROLL
10814	POPPER CASE SLIDING COVER
10844	TRANSFORMER 100W, 230V-12V, VDE
11033	25 AMP DISCONNECT-3 POLE NEUTRA
12047	BULK HEAD UNION
12394	OIL TUBE POP-N-ROLL 53 "
12394-L	OIL TUBE LONG POP-N-ROLL 74"

C. CRETORS AND COMPANY

176 MITTEL DRIVE

WOOD DALE, IL 60191

PHONE: (847)616-6900, (800)228-1885, FAX: (847)616-6970

WEB SITE: <http://www.cretors.com>

TWIN DIPLOMAT 48/60 OZ - BACK VIEW
BEGINNING SERIAL No. 99064786

DOC: TDI30004

TDI48/60-A/E-3.0-A

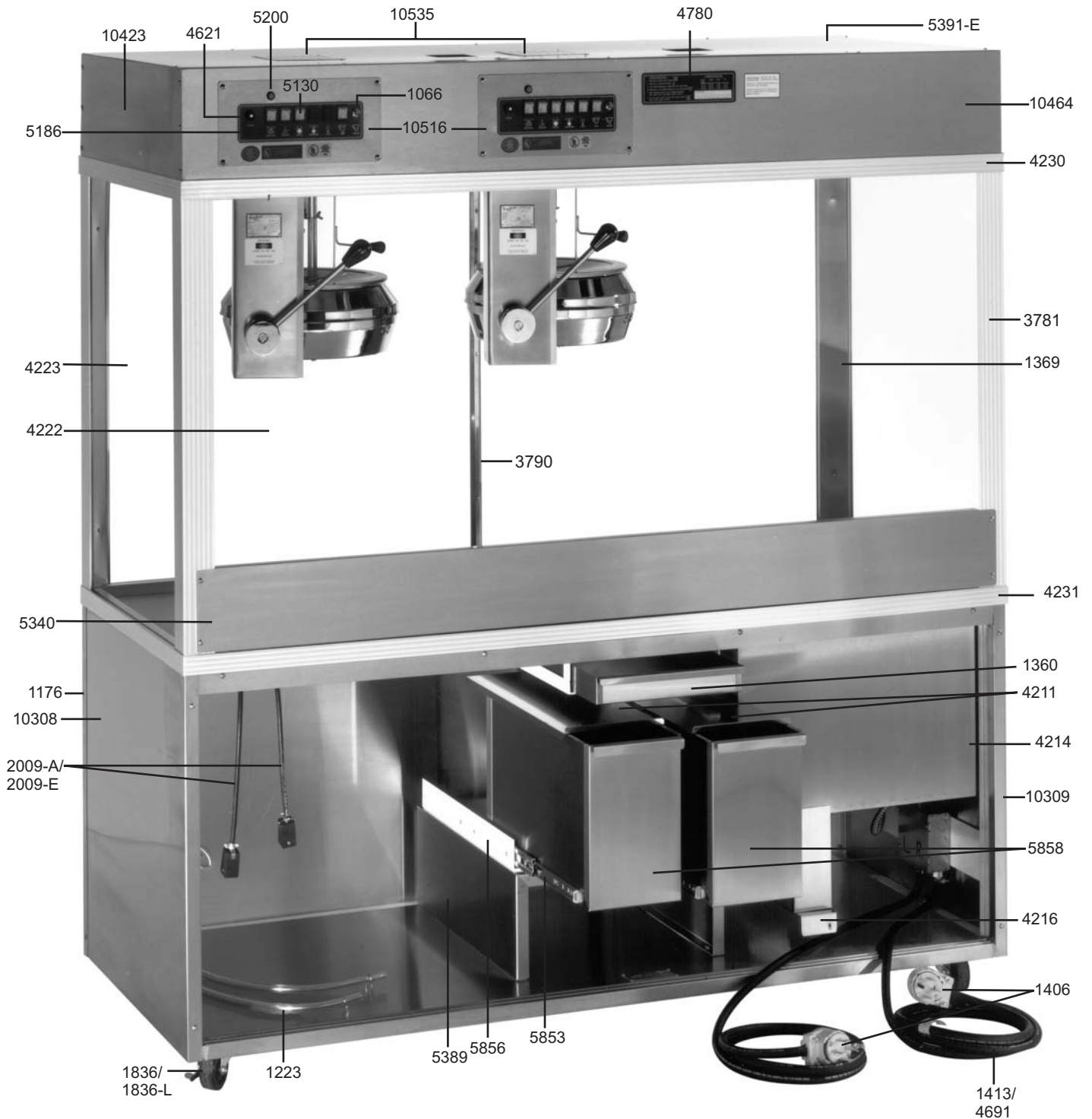

C. CRETORS AND COMPANY

176 MITTEL DRIVE

WOOD DALE, IL 60191

PHONE: (847)616-6900, (800)228-1885, FAX: (847)616-6970

WEB SITE: <http://www.cretors.com>

TWIN DIPLOMAT 48/60 OZ - BACK VIEW

DOC: TDI30004

TDI48/60-A/E-3.0-A

BEGINNING SERIAL No. 99064786

1066	SWITCH-PUSH BUTTON	5393-L	SLIDING DOOR-LEFT-TDI
1176	CORNER BASE TRIM-FRONT-PR/EPR/T	5393-R	SLIDING DOOR-RIGHT-TDI
1223	TUBING-NALGENE-CLEAR PER FOOT	5853	DRAWER SLIDE - PAIR
1360	CLEAN OUT DRAWER	5856	CORN DRAWER SLIDE
1369	INSIDE CORNER (FRONT) -ENCL PRES	5858	50# CORN DRAWER-NARROW
1370	INSIDE CORNER (REAR) -ENCL PRES	10491	RISER TUBE - TDI
1406	PLUG-50AMP, 125/ 250V, R, 4-WIRE	10516	SWITCHPLATE - 5' /6' DIPLOMAT120
1407	RECEPTACLE-50A 4-WIRE,NEMA 14	10552	DISCHARGE TUBE - TID
1413	CORN-30AMP, 1-4, SO		<u>TOP ASSEMBLY</u>
1757	CHANNEL-GLASS "U" SOLD PER FOOT	10423	TOP SHELL - SIDE-28" WIDTH
1836	CASTER -WITHOUT BRAKE	10464	TOP SHELL - BLANK PANEL - TDI W/S
1836-1	CASTER WITH BRAKE	10535	TOP PANEL
2009-A	PUMP CORD & PLUG 120V		<u>HARDWARE FOR TOP ASSEMBLY</u>
2009-E	PUMP CORD & PLUG 230V	7642	8-32 x 3/8 SS TRUSS HEAD (12)
3781	EXTRUSION-EPR-CORNER-NEW STYLE	7756	RIVETS (4)
3790	CENTER GLASS HOLDER - EPR	7789	# 8 STAR LOCKWASHER (12)
4211	50# CORN DRAWER COVER-NARROW	10539	#6 x 3/8 PHIL TRUSS (14)
4214	CORN BIN-TEPR / TDI/ EPR48		<u>NOT SHOWN</u>
4216	FIN CLEAN OUT SLIDE-TEPR/ TDI/ 4	10816	100# CORN DRAWER COVER
4222	GLASS (FRONT) - TEPR/ TDI	12089	100# CORN DRAWER
4223	GLASS (SIDE) - TEPR/ TDI	12310	FUSE HOLDER-15A
4230	EXTRUSION-TEPR TOP	12311	FUSE 15 AMP
4231	EXTRUSION-TEPR BOTTOM		
4261	CIRCUIT BREAKER-120/ 15A-PUSH		
4691	CORD - 25 AMP-EXPORT - SOLD PER FOOT		
4780	DECAL-INSTRUCTION-20/ 32/ 48/60 OZ		
5130	SWITCH-LIGHTED-230V		
5186	DECAL-SWITCHPLATE-KIP-ROCKER S		
5200	INDICATOR LIGHT		
5340	CORN GUARD-TDI TEPR W/ O BF		
5389	DRAWER MOUNT-TDI		
5392	SLIDING DOOR-CENTER-TDI		

C. CRETORS AND COMPANY

176 MITTEL DRIVE

WOOD DALE, IL 60191

PHONE: (847)616-6900, (800)228-1885, FAX: (847)616-6970

WEB SITE: <http://www.cretors.com>

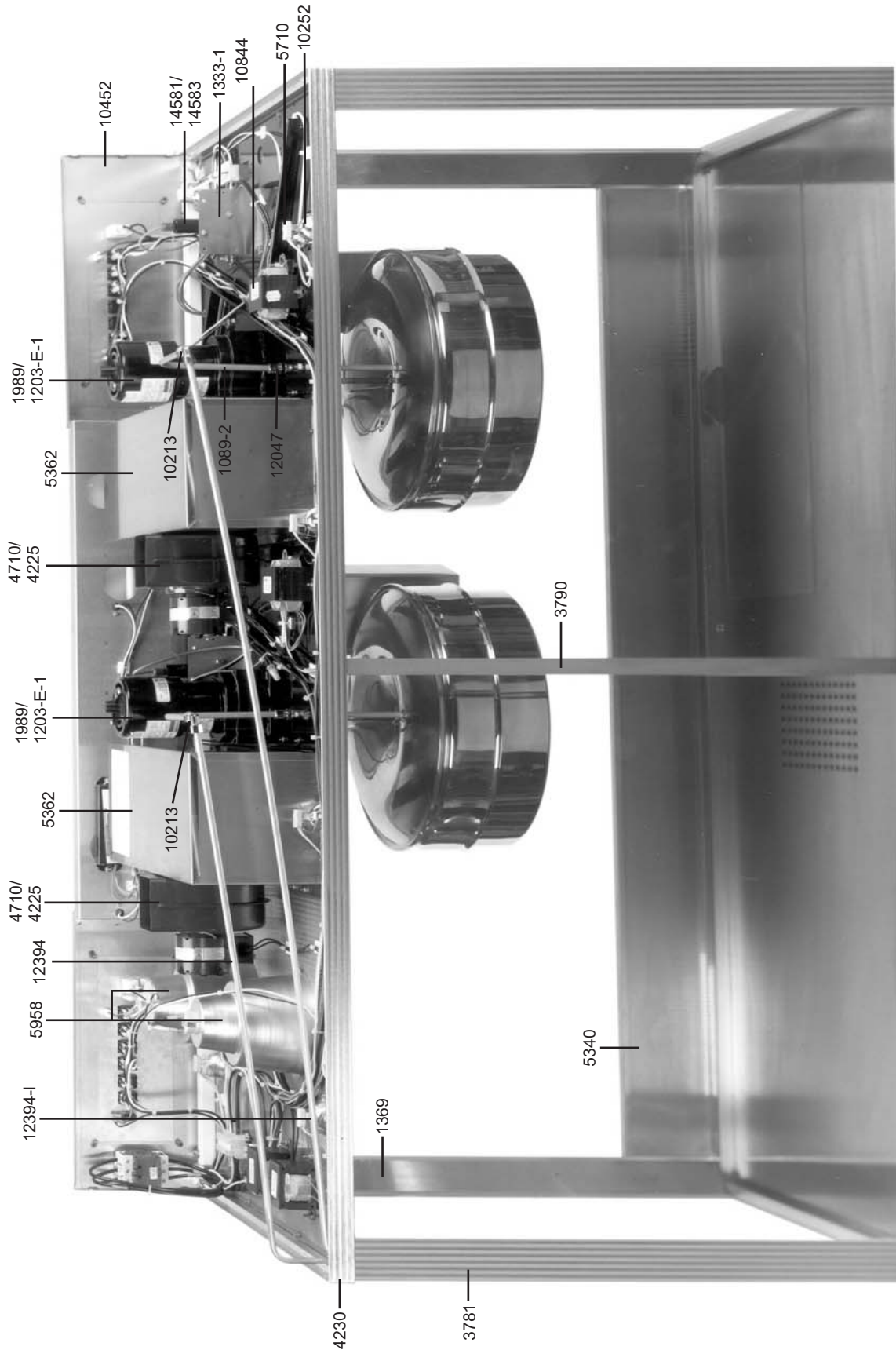

1089-2	DISCHARGE TUBE TOP
1203-E-1	MOTOR 230V
1369	INSIDE CORNER (FRONT)-ENCL PRES
1989	MOTOR 120V
3790	CENTER GLASS HOLDER EPR
4225	BLOWER-230V(2C916)
4230	EXTRUSION TEPR TOP
4710	BLOWER-120V (1C982B)
5340	CORN GUARD-TDI & TEPR W/O BF
5362	FILTER HOUSING TDI/5"DIP
5710	SOCKET-HALOGEN
5958	LAMP GUARD- SPUN
10213	COUPLING-RIGHT ANGLE
10252	LAMP-HALOGEN
10452	TOP SHELL-SSTS PANEL-TDI W/S
10844	TRANSFORMER 100W, 120/230V-12V, VDE
14581	RELAY-120V.-SINGLE POLE
14583	RELAY-230V.-SINGLE POLE