



We invented the popcorn machine  
THEN JUST KEPT GOING!

DWE OS MANUAL

---

176 MITTEL DRIVE, WOOD DALE, IL 60191

---

# Display Warmer Operation & Service Manual

230 Volt  
Single Phase, 50 Cycle

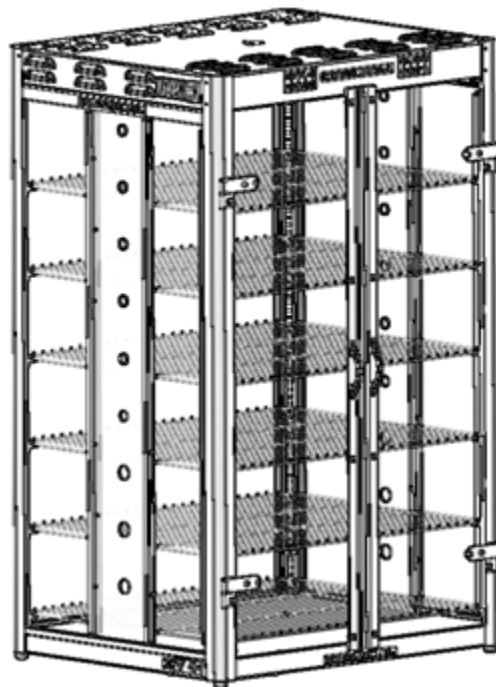

**READ and UNDERSTAND these servicing, and safety instructions before servicing this food warmer.**

**TABLE OF CONTENTS**

I. Safety Alert Symbol.....3

II. Safety First..... 3

III. Introduction.....3

IV. Product Specifications.....4

V. Installation Instructions.....5

VI. Operating Instructions.....6

VII. Service Instructions.....7

VIII. Troubleshooting.....7

IX. Wiring Diagram.....8

---

## I. SAFETY ALERT SYMBOL

The symbol shown below is used to call your attention to instructions concerning your personal safety and the safety of others. Watch for this symbol. It points out important safety precautions. It means **ATTENTION! Become Alert! Your personal safety is involved!** Read the message that follows and be alert to the risk of personal injury or death.



---

## II. SAFETY FIRST

This manual is filled with time-saving and money-saving information regarding your Cretors snack warmer machine. There is nothing more important than the safety aids and warnings that are throughout this document. The Safety Alert Symbol is used to identify topics of primary safety concern wherever they appear.

If, after reviewing this manual, anything is unclear or technical problems are encountered, contact the distributor from whom you purchased your machine for assistance. If there are any additional questions, feel free to contact our Customer Service Department at the address and/or phone number listed on back cover of this manual. Always have the model and serial number of your machine available to assist in obtaining the correct information.



The information in this manual is essential for the safe installation and maintenance of your Cretors snack warmer machine. The manual must be read and understood before installing and operating the equipment, or equivalent training must be provided.



"The employer shall instruct each employee in the recognition and avoidance of unsafe conditions, as well as, regulations applicable to his work environment, to control or eliminate any hazards, or other exposure to illness or injury". Ref.: 29 CFR 1926.20 (b)(4)(a)(2)



It is understood that safety rules within individual companies vary. If a conflict exists between the safety procedures contained in this manual and the rules of a using company, the more stringent rule should take precedence.

**III. INTRODUCTION**

The Display Warmer is designed to warm and display food products. The unit is designed with a dual heating blower circuits to circulate warmed air throughout the cabinet. All around corner LED lighting illuminates the storage cabinet.

The warmer is also equipped with six adjustable shelves. All machines are tested, and are mechanically and electrically sound when they leave the factory.

The warmer is also proved a digital temperature control to allow for various temperature control of stored products.

**IV. PRODUCT SPECIFICATIONS**

CRETORS DISPLAY WARMER: MODEL: DWE

ELECTRICAL SPECIFICATIONS:

230 Volt, Single Phase, 50/60 Cycle 750 Watts

MECHANICAL SPECIFICATIONS:

Net Weight: 100 lbs (46 kgs)

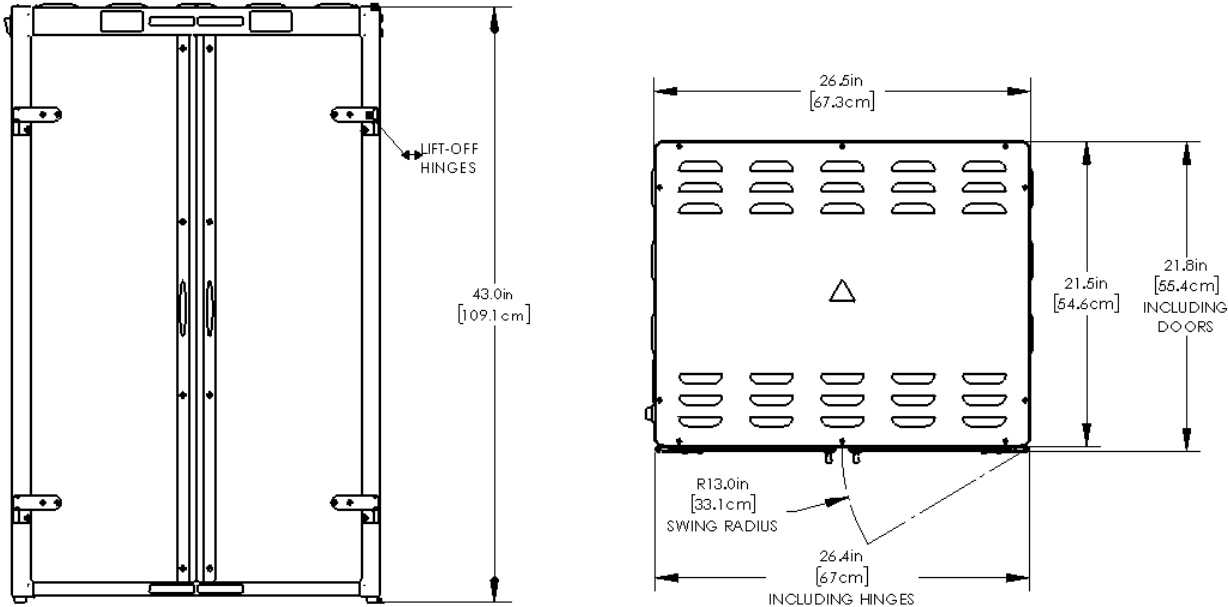

---

## V. INSTALLATION INSTRUCTIONS

### 1. Location

Choose a location for your Cretors machine to maximize the ease of operation and maintenance procedures. Check your local building and fire codes for location restrictions.

### 2. Power Supply

Check the nameplate to determine the required power supply.



Connect your warmer only to the correct power source. Failure to do so may result in personal injury or death and may damage your warmer.



Make certain the Rocker Switch on the warmer is in the 'OFF' position when plugging into power source. Failure to do so may result in personal injury or death and may damage your warmer.

### 3. After Connecting Warmer to Power Supply

The unit's operation can be controlled by the backlit rocker switch located above the pass thru door on the rear of the cabinet.

## VI OPERATING INSTRUCTIONS



Do not attempt to operate your Cretors warmer until you have read and understood this manual. Failure to do so may result in serious injury or death.



Do not attempt to operate your Cretors warmer unless the installation instructions have been strictly adhered to. Failure to do so may result in serious injury or death.



Operate your warmer only if it is in sanitary condition (SANITATION INSTRUCTIONS). Failure to do so may result in illness to your customers.

1. Turn Rocker Switch "ON" to light cabinet and turn on heating system.
2. To adjust temperature, press the "SET" button, then the up or down arrow keys to adjust the set point up or down. The controller is set for 150F (66C) and factory set with a range from 65F - 180F (18C - 83C). The unit will not cool so range is actually cabinet ambient to 180F (83C). There is a manual reset high limit set at 200F (93C).

DEPRESS  
HERE TO  
TOGGLE  
POWER  
"OFF"

DEPRESS  
HERE TO  
TOGGLE  
POWER  
"ON"

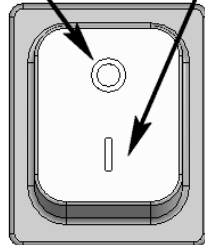

ROCKER SWITCH

PRESS TO  
DECREASE  
TEMPERATURE  
SET POINT  
TEMPERATURE

PRESS TO  
INCREASE  
TEMPERATURE  
SET POINT  
TEMPERATURE

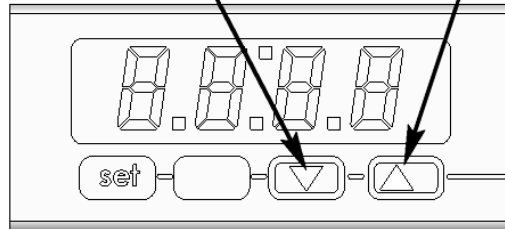

TEMPERATURE CONTROLLER

## VII. SERVICE INSTRUCTIONS



In the case of improper operation, qualified personnel only should perform the following diagnostic checks, and, if necessary, corresponding adjustments and repairs. Many of the following procedures present an electrical shock hazard and can cause serious injury or death.

### Parts

When ordering parts, refer to the attached parts diagram. Always supply the serial number, model number, and voltage of your warmer.

## VIII. TROUBLESHOOTING

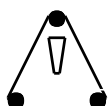

Do not attempt electrical repairs on the power supply circuit unless you are qualified to do so. The electrical shock associated with line voltages can cause serious injury or death.

PROBLEM	POSSIBLE CAUSE	ACTION
Warmer will not power up.	Check Power supply.	Is it plugged in?
		Is the receptacle live?
		Is the machine plugged into the proper voltage? Measure with voltmeter and compare to specification on machine.
		Is there power to the rocker switch? If yes, check for loose wiring. Replace rocker switch if cycling of switch does not power up the warmer.
Warmer powers up but supply air is cold.	Bad heating element or high limit safety switch.	Unplug machine. Using a multi-meter, check the resistance of each heat element. Remove the wire from one terminal. The meter should read approximately 32 $\Omega$ . If bad, replace the heat element.
	Digital temperature controller has incorrect set point or is malfunctioning.	Plug in machine. Make sure the set point is correct. Then make sure that the temperature controller output light is lit. Check the coil voltage at the heater temperature control contactor and make sure it is receiving 240 volts when the output is lit. If not it can be a defective temperature controller or a loose wire. Check wiring to schematic and replace replace.
	High limit is tripped or stuck open.	Unplug machine. Using a multi-meter, check the continuity of each high limit safety switch. Remove the wire from one terminal. The meter should show continuity. If there is no continuity, replace the high limit safety switch.

IX. WIRING DIAGRAM

Display Warmer Digital Control  
Wiring Diagram - 230V 50/60 Hz  
Beginning Serial Number #1803

DOC: DWEr1

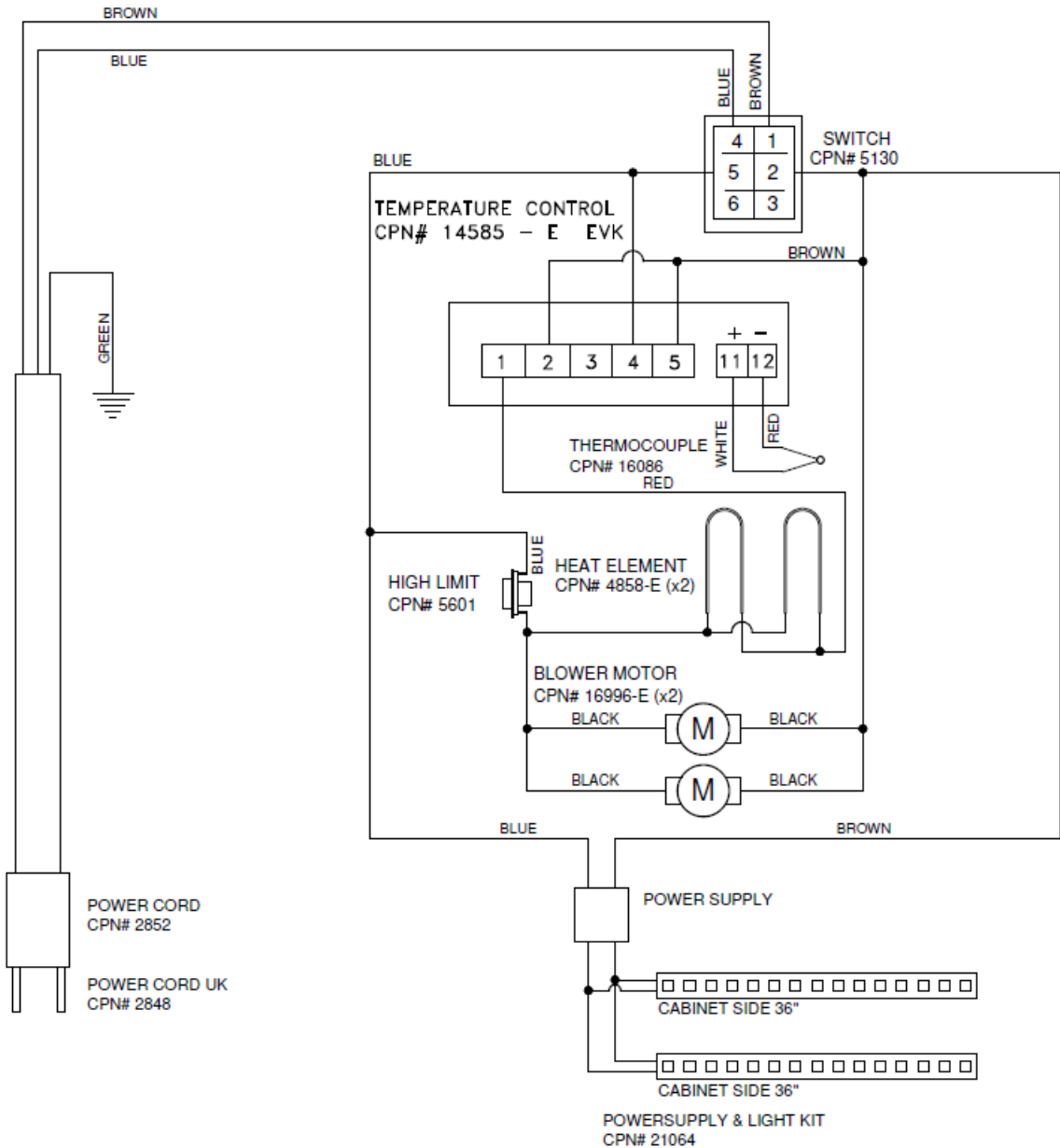



This manual is filled with time-saving and money-saving information regarding your Cretors snack warmer machine. There is nothing, however, more important than the safety aids and warnings found throughout this document.

If you have any questions regarding the operation or cleaning of your Cretors snack warmer machine, contact your local distributor. Should you have any difficulties or are unable to reach them, feel free to contact the Customer Service Department at C. Cretors and Company.

Additional copies of this manual can be obtained from C. Cretors and Company at the address listed below. Please provide model and serial number when requesting additional copies of this manual. There will be a nominal charge for additional copies.

Cretors guarantees this machine to be free of defects in parts, materials and workmanship for two years. Please take this time to fill out the factory registration card and return it to the factory to activate your warranty. If you have any questions concerning the Cretors' warranty, please contact your local distributor or the Customer Service Department at C. Cretors and Company.



**C. CRETORS AND COMPANY**  
176 MITTEL DRIVE  
WOOD DALE, IL 60191

PHONE (773) 588-1690, (800) 228-1885, FAX (847) 616-6970

WEB SITE: <http://www.cretors.com> Email: [postmaster@cretors.com](mailto:postmaster@cretors.com)

**Cretors joins the information age! Check out our links <http://www.twitter.com>  
<http://www.facebook.com/pages/Chicago-IL/C-Cretors-Co/90143449620>**

BILL OF MATERIALS			
ITEM #	Default/ QTY	P/N	DESCRIPTION
1	1	21880	FRAME WELDMENT, DISPLAY WARMER, ROUNDED
2	2	1217	MAGNETIC CATCH-RECTANGULAR
3	4	1605-1	FOOT, RUBBER, 7/8"DIA X 0.531"HIGH
4	12	7790	#10, INTERNAL TOOTH LOCKWASHER, STEEL NICKEL
5	4	16747	#10-24 X 1/2"LG, SLOT ROUND HEAD MACHINE SCREW, STEEL
6	2	16996-A	BLOWER, AXIAL, 120V
7	8	14615	#10-32 X 1/2"LG PHIL PAN HEAD T.C.S. TYPE "F" 18-8 S.S.
8	1	21055	HEAT ELEMENT ENCLOSURE
9	2	4858	HEAT ELEMENT, 400W, 120V, 36 OHMS
10	2	5691	CLAMP, PIPE #110
11	2	7683	#10, SAE FLAT WASHER, 18-8 S.S.
12	2	14646	#8-32, KEPS NUT, STEEL NICKEL
13	7	2123	BUSHING, HEYCO #2030, 1/4"
14	17	7789	#8, INTERNAL TOOTH LOCKWASHER, STEEL NICKEL
15	15	7641	#8-32 X 1/4"LG FULLY THD, PHIL TRUSS HEAD MACHINE SCREW, 18-8 S.S.
16	1	21057	BLOWER COVER, DISPLAY WARMER
17	1	14585	TEMPERATURE CONTROLLER, DIGITAL, 120V
18	1	5130	SWITCH, LIGHTED, 230V
19	1	5601	HIGH LIMIT, 200 DEG
20	2	7642	#8-32 X 3/8"LG FULLY THD, PHIL TRUSS HEAD MACHINE SCREW, 18-8 S.S.
21	1	16086	THERMOCOUPLE, RING TYPE, HOT DOG
22	1	4709	SPACER, 0.21"ID X 0.3"OD X 5/8"LG, STEEL
23	1	5505	#8-32, SERRATED HEX FLANGE NUT, STEEL ZINC
24	2	21069	EXTRUSION CHANNEL, 18.4375"
25	4	21071	CHANNEL, GLASS, 19"LG
26	2	21062	GLASS, SIDE, DISPLAY WARMER
27	6	21073	CHANNEL, GLASS, 37"
28	1	21070	EXTRUSION CHANNEL, FRONT GLASS
29	2	21072	CHANNEL, GLASS, 24"
30	1	21063	GLASS, FRONT, DISPLAY WARMER
31	2	21888	INSIDE CORNER, W/ TRACK, OPER SIDE
32	12	16857	#8-32 X 5/8"LG FULLY THD, PHIL ROUND HEAD MACHINE SCREW, 18-8 S.S.
33	2	21116	INSIDE CORNER, W/ TRACK, CUST SIDE
34	12	14979	#8-32, U-NUT
35	2	21964	AIR DUCT, DISPLAY WARMER
36	4	22043	STIFFENER, AIR DUCT, DISPLAY WARMER
37	24	7803	#6-32 X 3/8"LG PHIL PAN HEAD T.C.S. TYPE "1" STEEL NICKEL
38	2	21064	LED STRIP, 36"LG, W/LEADS & POWER SUPPLY
39	2	2121	BUSHING, HEYCO, #2053, 1/2"
40	6	21065	WIRE RACK, DISPLAY WARMER
41	24	1968-1	CLIP, PILASTER SHELF, #305
42	2	1154-2	HINGE, LEFT SIDE
43	8	7654	#10-24 X 3/8"LG FULLY THD, PHIL TRUSS HEAD MACHINE SCREW W/NYLOK PATCH, STEEL NICKEL
44	2	1155-2	HINGE, RIGHT SIDE
45	2	21066	DOOR ASSEMBLY, DISPLAY WARMER
46	1	21058	BOTTOM COVER, DISPLAY WARMER
47	14	12848	#8 X 3/8"LG, PHIL PAN HEAD TYPE "AB" SMS, STEEL ZINC
48	1	2168	CORD GRIP, HEYCO, SR 7K-2, 7/8"
49	1	1788	CORD, 10AMP, 16-3, NEMA 5-15P
50	1	21059	TOP COVER, DISPLAY WARMER
51	1	1517	NAMEPLATE, SERIAL NO, BLANK
52	4	7756	1/8" RIVET, DOME HEAD, 0.063-0.125 GR, Q STYLE AL/AL
53	1	3920	DECAL, GROUND, YELLOW/BLACK
54	1	2446	DECAL, CAUTION 120V/60HZ
55	1	12863	DECAL, EPH/UL SANITATION MARK
56	1	19100	DECAL, HIGH VOLTAGE WARNING
57	4	6018	DECAL, CAUTION CONSIDER ALL SURFACES HOT
58	4	21670	DECAL, CAUTION ALL SURFACES HOT, FRENCH
59	1	14594	DECAL, UL/CUL LISTED, CRETORS
60	2	21748	DECAL, NON HAZARDOUS FOOD STORAGE

FOR WIRING: REFER TO CURRENT REVISION OF WIRING DIAGRAM: DWE

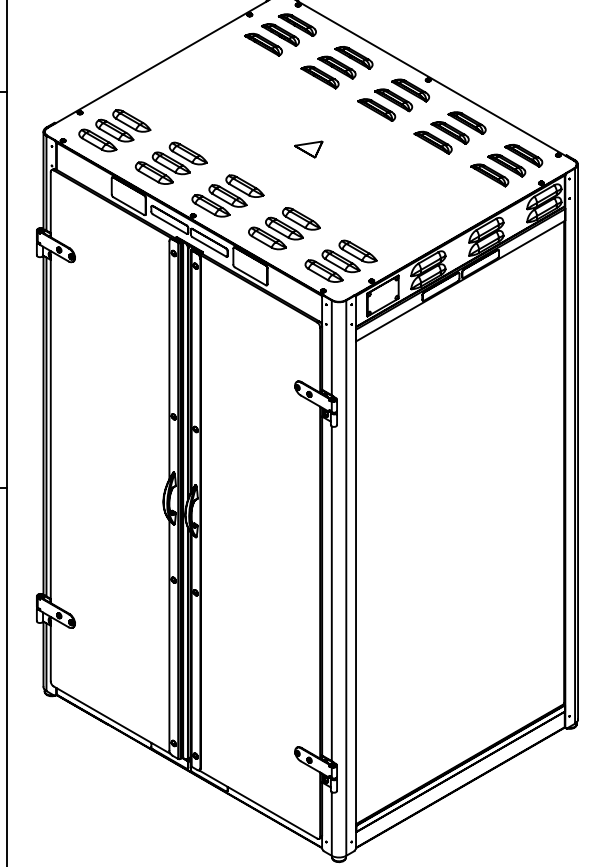

REVISIONS			
REV	DC #	APPROVED BY	APPROVED ON
-	-	-	-
-	-	-	-
-	-	-	-

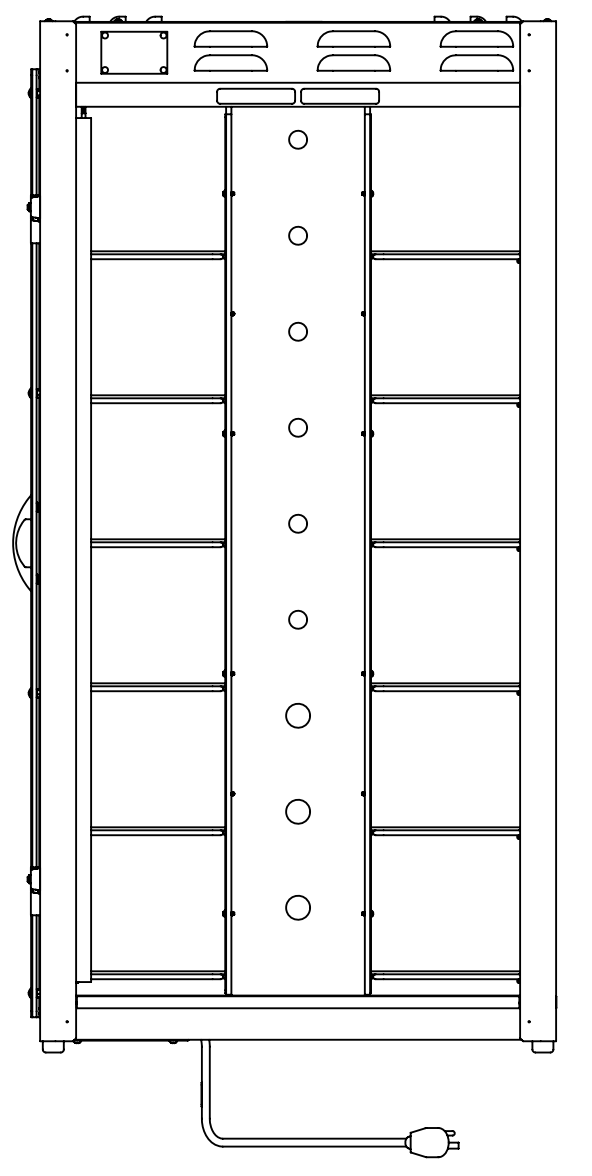
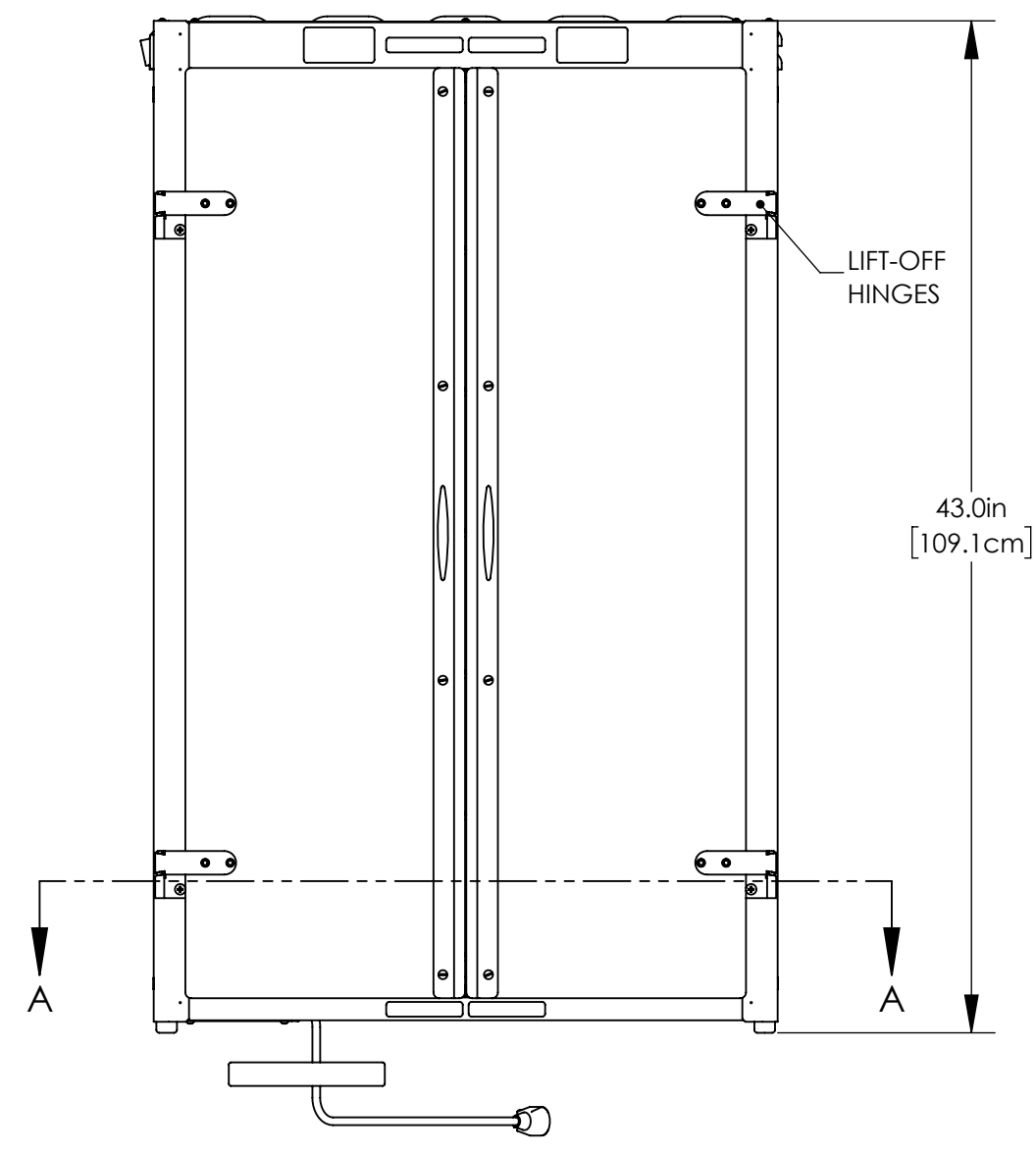
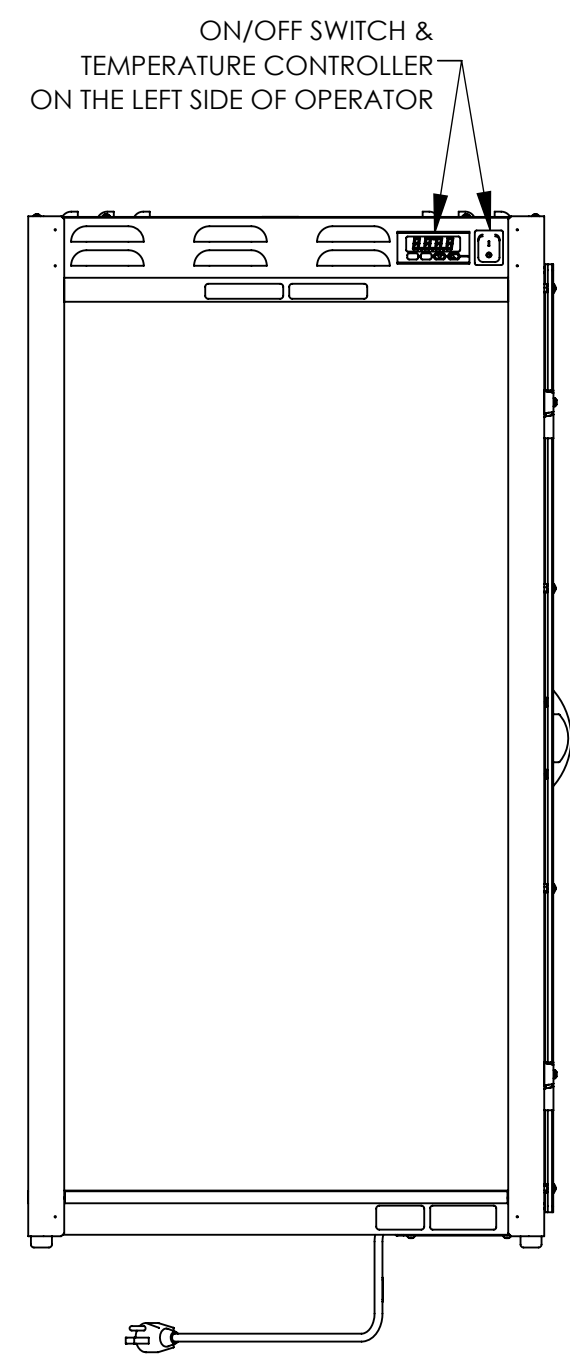
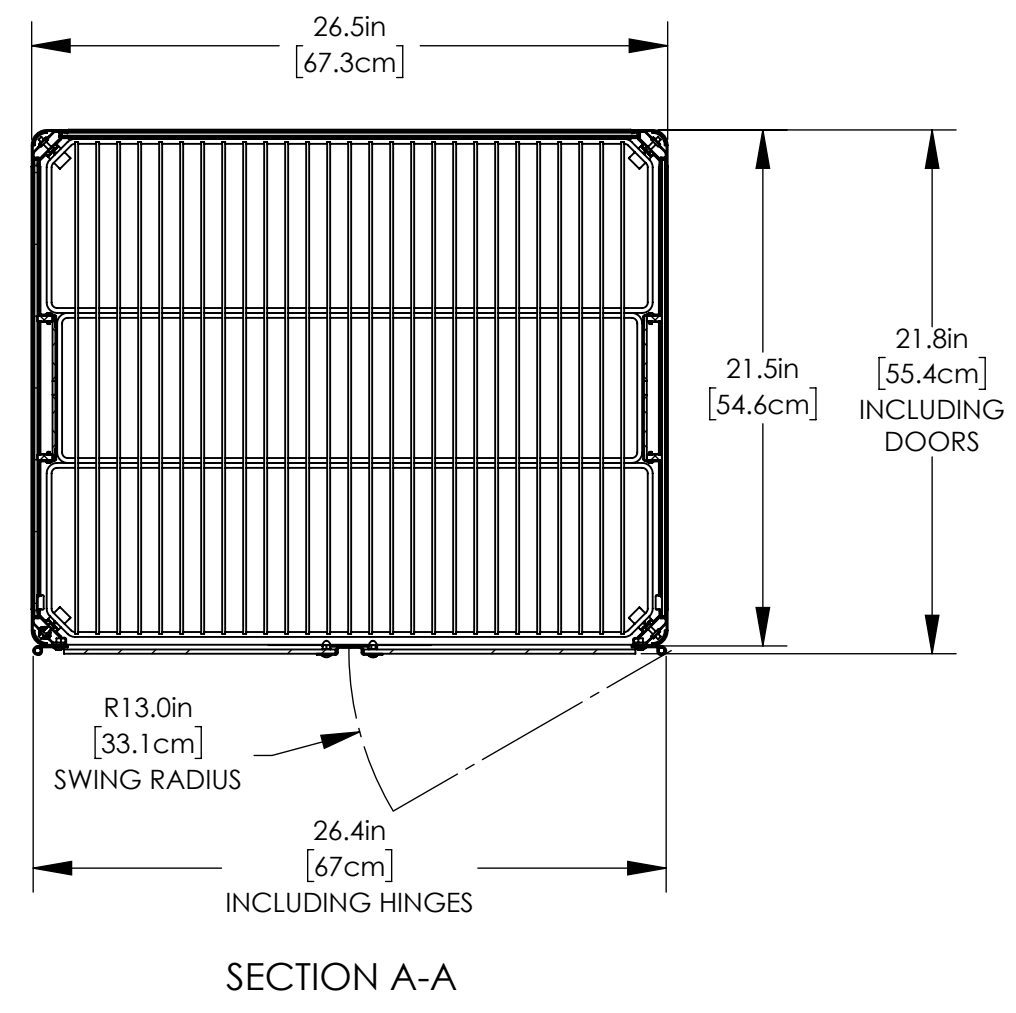

- NOTES:**
- ALL SHELVES ARE ADJUSTIBLE IN THE INCREMENTS OF 1/2".

- STANDARD NOTES:**
- REMOVE SHARP EDGES AND BURRS.
  - UNLESS SPECIFIED ALL DIMENSIONS ARE IN INCHES.
  - REFERENCE DIMENSIONS ARE INDICATED IN PARENTHESIS.
  - CRITICAL DIMENSIONS THAT NEED INSPECTION ARE INDICATED IN OBOUND BOX.
  - T.S.C. STAND FOR THEORITICAL SHARP CORNER & INS STAND FOR INSIDE.
  - FOR SHEET METAL, UNLESS SPECIFIED ALL DIMENSIONS ARE OUTSIDE.
  - FOR SHEET METAL, FLAT PATTERNS ARE FOR REFERENCE ONLY.
  - MINOR SCRATCHES ARE ALLOWED ON OPPOSITE SIDE OF MILL FINISH & #4 FINISH.

		<b>THIRD ANGLE PROJECTION</b>				176 MITTEL DRIVE, WOOD DALE, IL 60191 www.cretors.com   www.ilo-llru.com	
TOLERANCES x.xx = ± 0.02 x.xxx = ± 0.01 ANGLES = ± 1° HOLES = +0.005 / -0 FINISH = 125Ra		DESCRIPTION <b>DISPLAY WARMER, 120V/1/60Hz</b>		MATERIAL REFER INDIVIDUAL SUB-PARTS		APPROX WEIGHT 99.6 LBS	
C SIZE DRAWING		DRAWN BY ndarji		DRAWN DATE 03/19/2019		DRAWING NUMBER DWAXX-X	
APPROVED BY ndarji		APPROVED DATE 03/19/2019		SHEET 1 OF 10		THIS DRAWING CONTAINS INFORMATION PROPRIETARY TO C. CRETORS & CO. AND IS FURNISHED IN CONFIDENCE FOR SOLE PURPOSE OF SUPPLYING THE RECIPIENT WITH NEEDED ENGINEERING DATA. THE CONTENTS SHOULD NOT BE DISCLOSED OR REPRODUCED IN ANY MANNER WITHOUT WRITTEN CONSENT OF C. CRETORS & CO. ALL RIGHTS RESERVED.	

**STEP # 1**

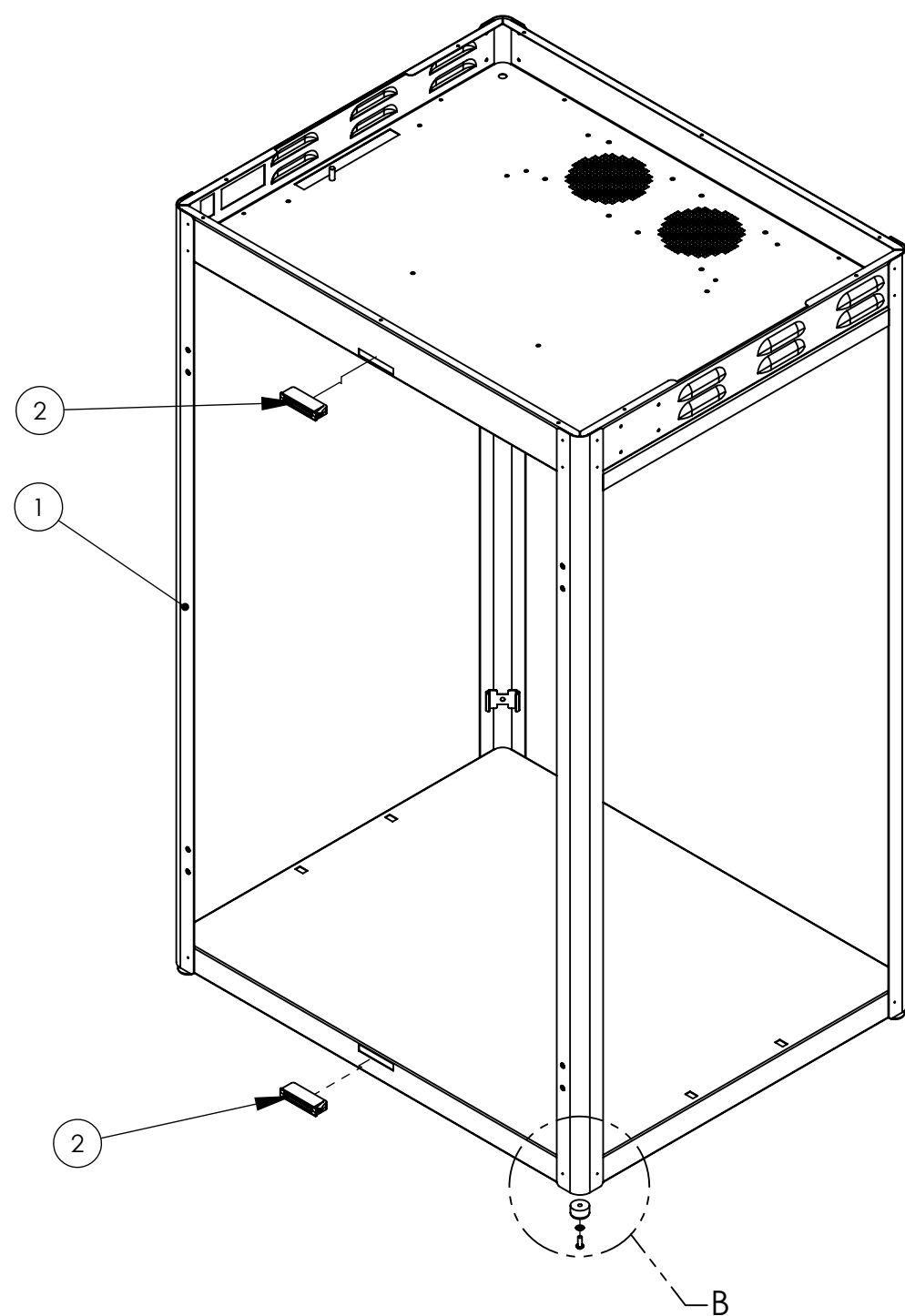

**STEP # 2**

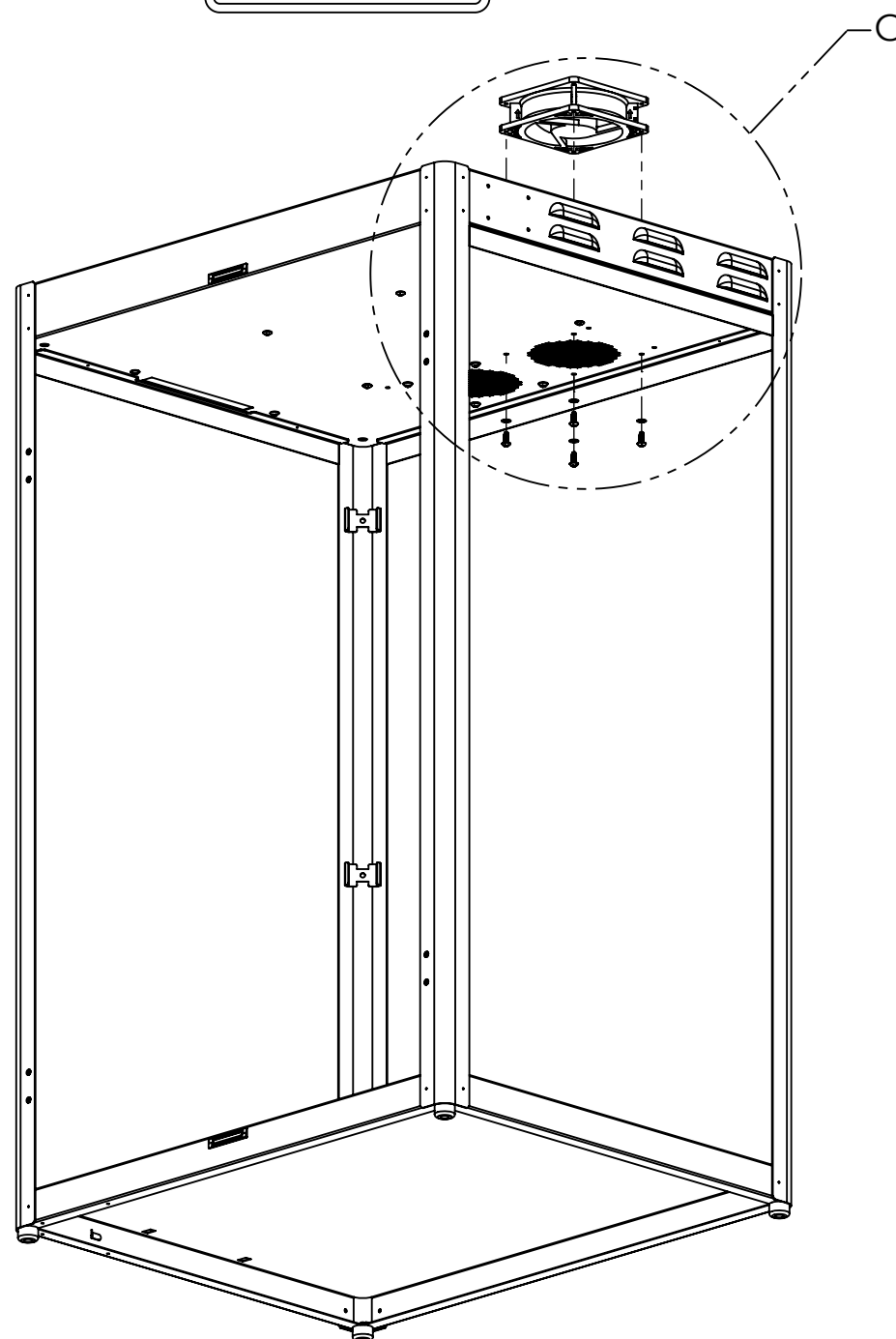

**STEP # 3**

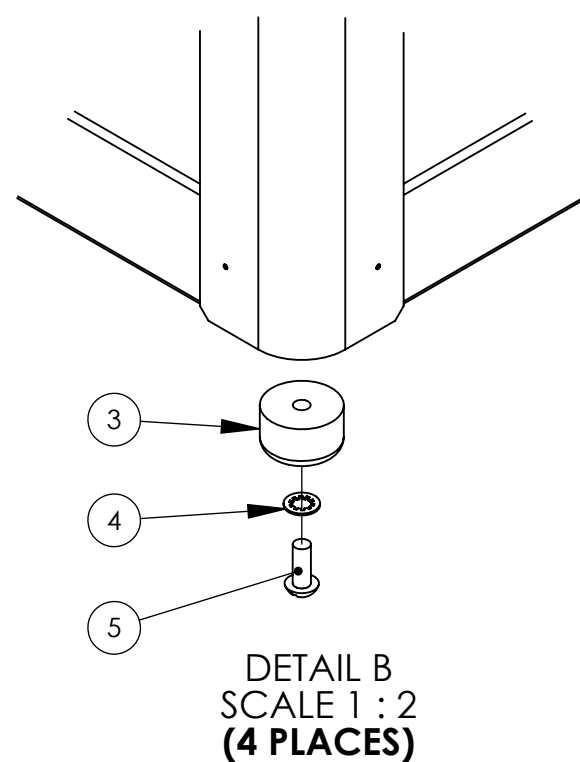
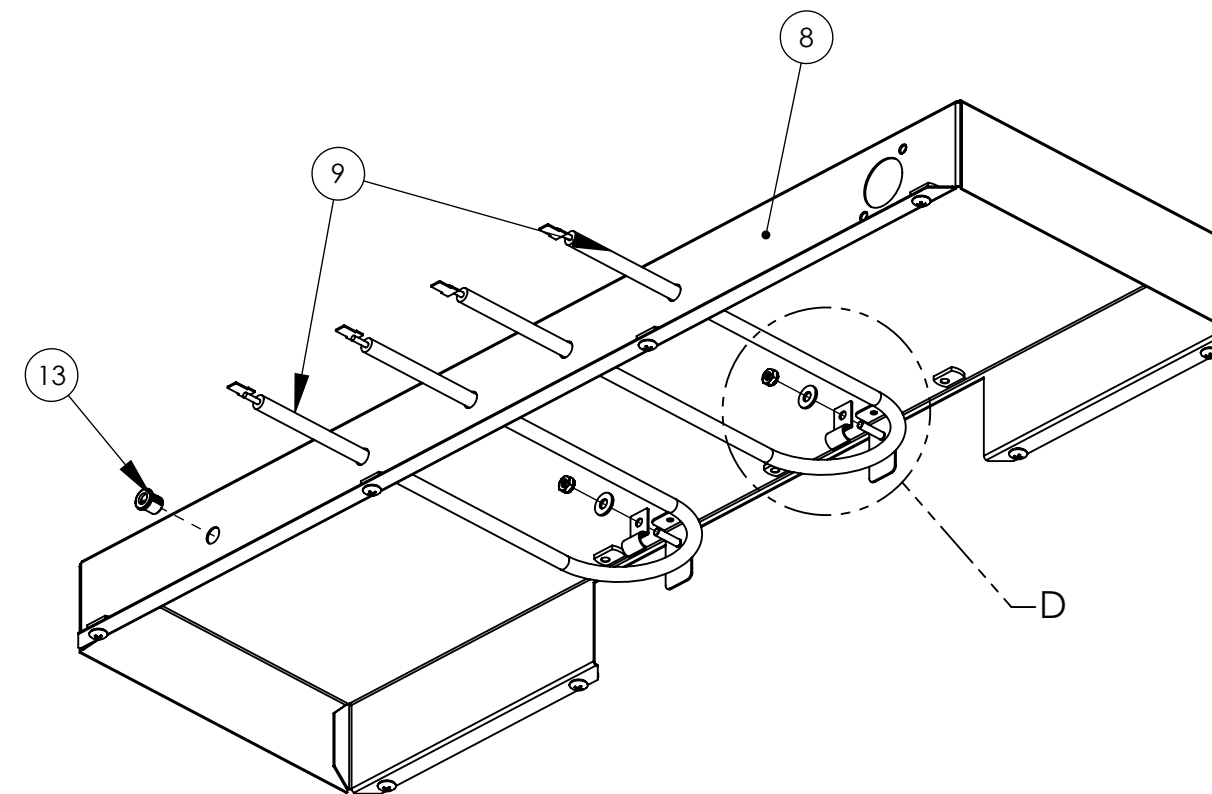

**DETAIL B  
SCALE 1 : 2  
(4 PLACES)**

ENSURE THE AIR FLOW  
DIRECTION ARROW IS  
POINTING UPWARDS

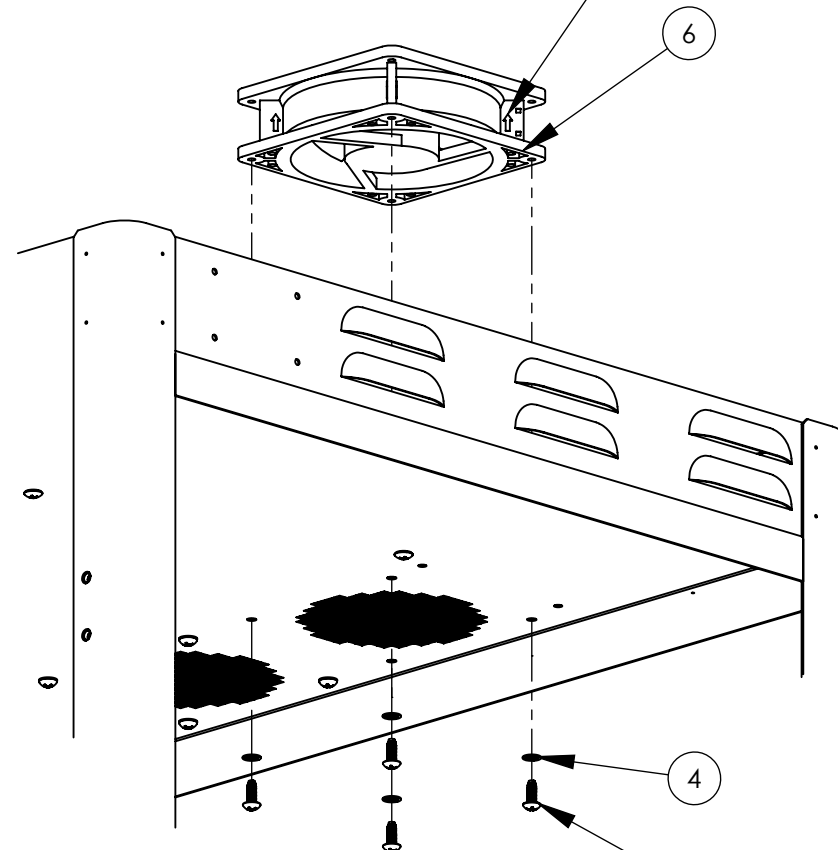

**DETAIL C  
SCALE 1 : 4  
(2 PLACES)**

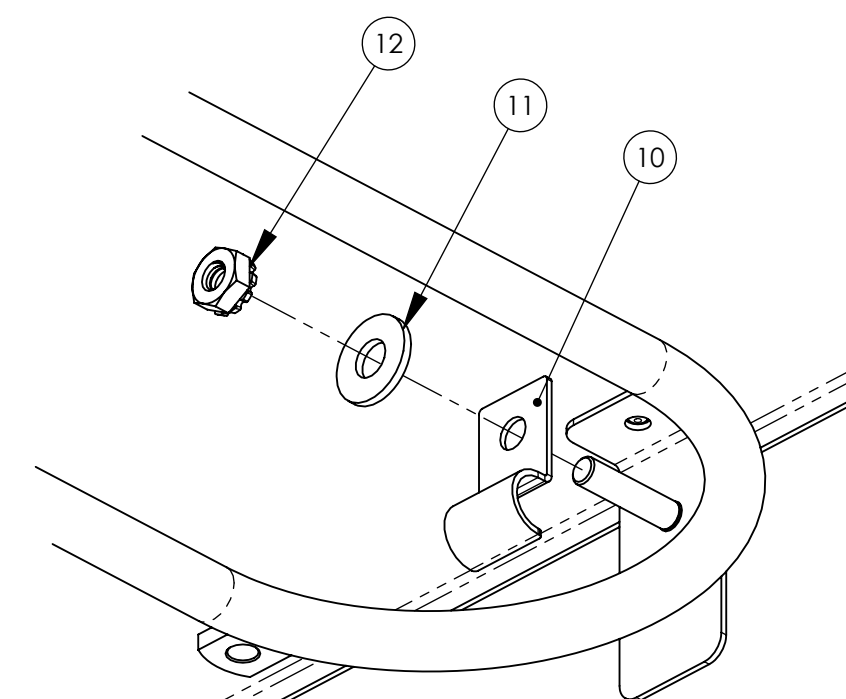

**DETAIL D  
SCALE 1 : 1  
(2 PLACES)**

- STANDARD NOTES:**
1. REMOVE SHARP EDGES AND BURRS.
  2. UNLESS SPECIFIED ALL DIMENSIONS ARE IN INCHES.
  3. REFERENCE DIMENSIONS ARE INDICATED IN PARENTHESIS.
  4. CRITICAL DIMENSIONS THAT NEED INSPECTION ARE INDICATED IN OBOUND BOX.
  5. T.S.C. STAND FOR THEORITICAL SHARP CORNER & INS STAND FOR INSIDE.
  6. FOR SHEET METAL, UNLESS SPECIFIED ALL DIMENSIONS ARE OUTSIDE.
  7. FOR SHEET METAL, FLAT PATTERNS ARE FOR REFERENCE ONLY.
  8. MINOR SCRATCHES ARE ALLOWED ON OPPOSITE SIDE OF MILL FINISH & #4 FINISH.

<p>THIRD ANGLE PROJECTION</p>		<p>176 MITTEL DRIVE, WOOD DALE, IL 60191 www.cretors.com   www.ilo-thru.com</p>	
<p>TOLERANCES</p> <p>x.xx = ± 0.02 x.xxx = ± 0.01 ANGLES = ± 1° HOLES = +0.005 / -0 FINISH = 125Ra</p>		<p>DESCRIPTION</p> <p><b>DISPLAY WARMER, 120V/1/60Hz</b></p>	
<p>C SIZE DRAWING</p>		<p>MATERIAL</p> <p>REFER INDIVIDUAL SUB-PARTS</p>	
<p>DRAWN BY</p> <p>ndarji</p>	<p>DRAWN DATE</p> <p>03/19/2019</p>	<p>DRAWING NUMBER</p> <p>DWAXX-X</p>	<p>APPROX. WEIGHT</p> <p>99.6 LBS</p>
<p>APPROVED BY</p>	<p>APPROVED DATE</p>	<p>REVISION</p> <p>-</p>	<p>SHEET</p> <p>2 OF 10</p>
<p>THIS DRAWING CONTAINS INFORMATION PROPRIETARY TO C. CRETORS &amp; CO. AND IS FURNISHED IN CONFIDENCE FOR SOLE PURPOSE OF SUPPLYING THE RECIPIENT WITH NEEDED ENGINEERING DATA. THE CONTENTS SHOULD NOT BE DISCLOSED OR REPRODUCED IN ANY MANNER WITHOUT WRITTEN CONSENT OF C. CRETORS &amp; CO. ALL RIGHTS RESERVED.</p>			

**STEP # 4**

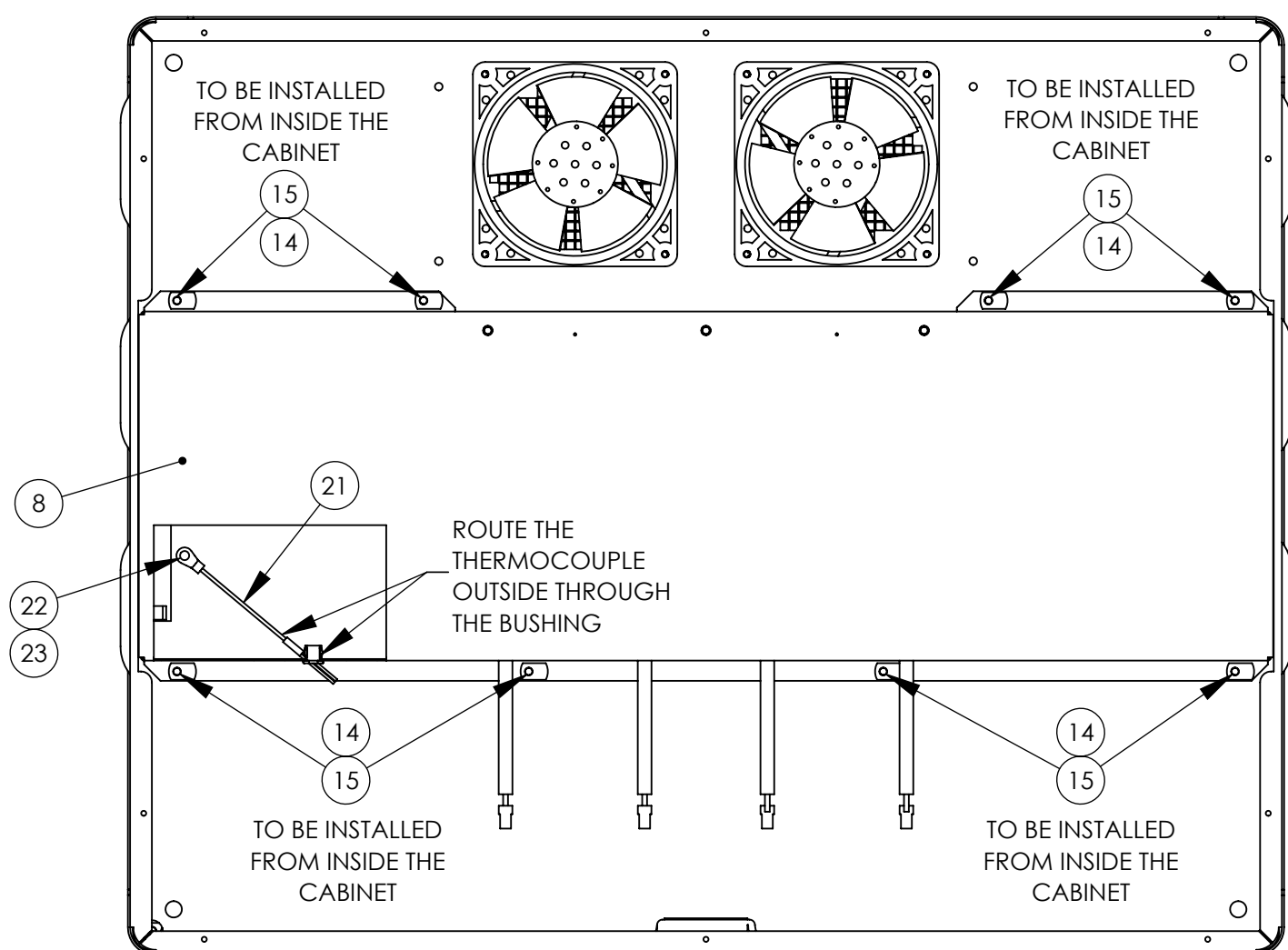

**STEP # 5**

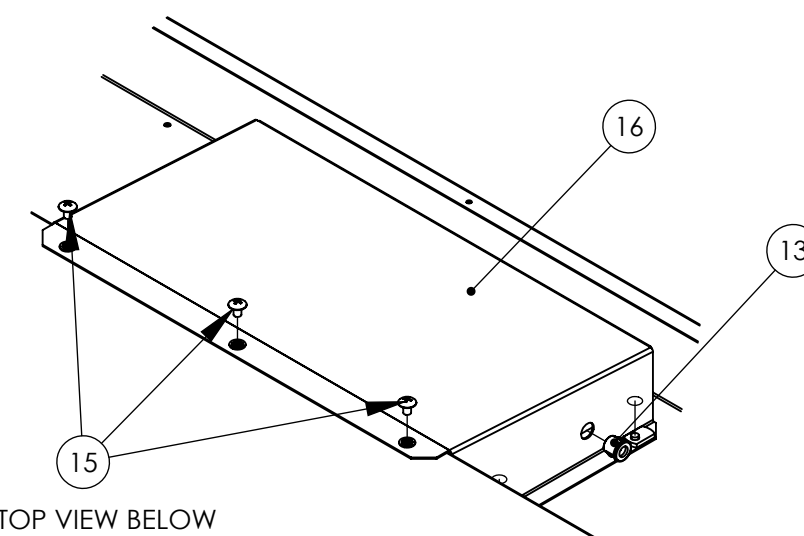
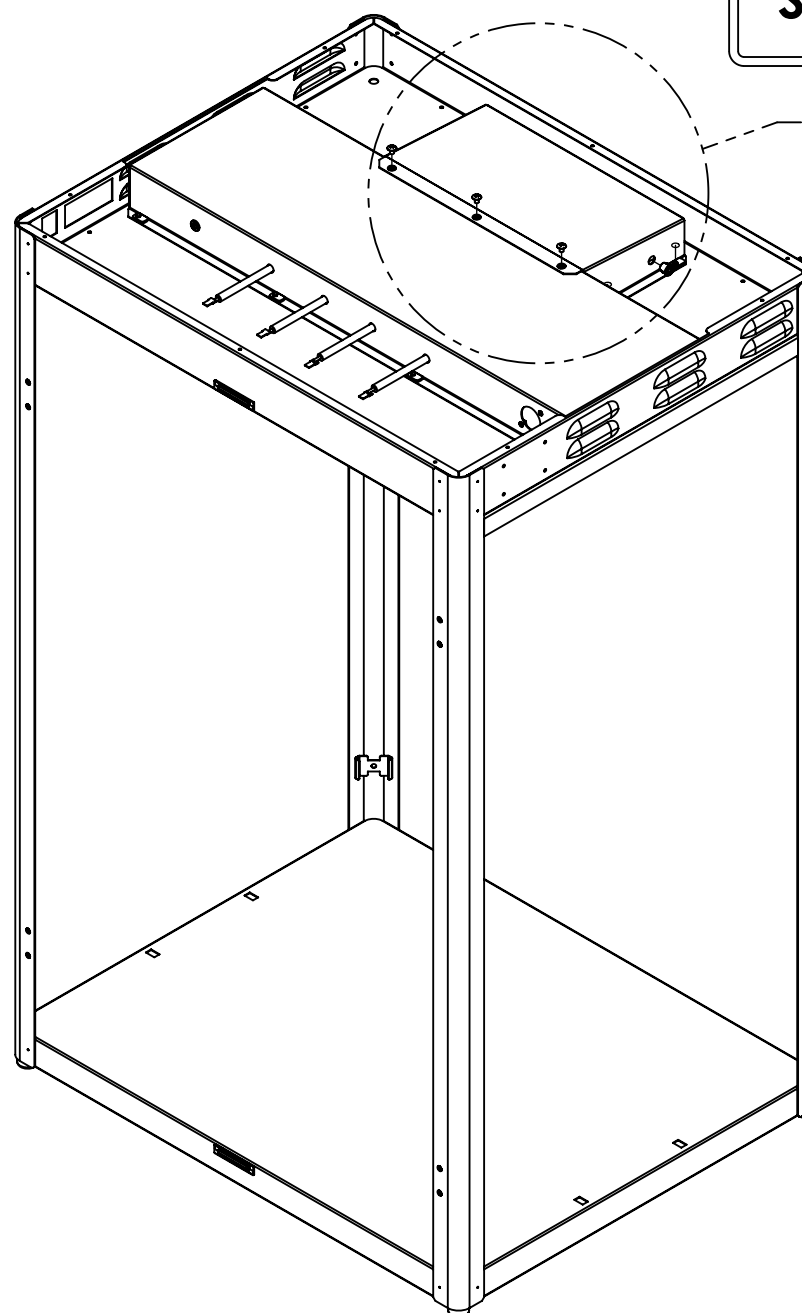

SEE TOP VIEW BELOW BEFORE ASSEMBLING THE BLOWER COVER

DETAIL E  
SCALE 1 : 4

ROUTE WIRES FOR BLOWERS THROUGH THESE BUSHINGS

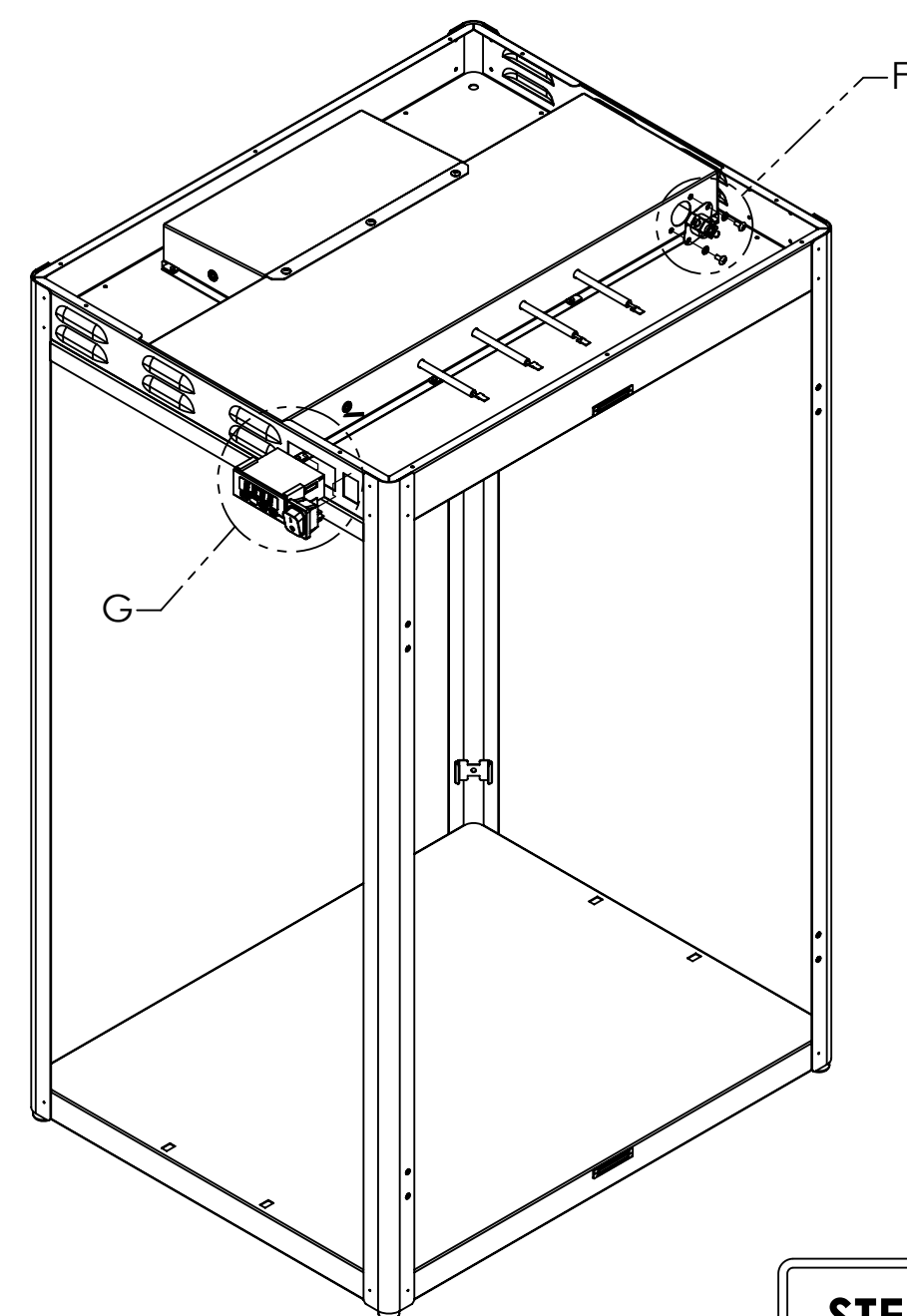
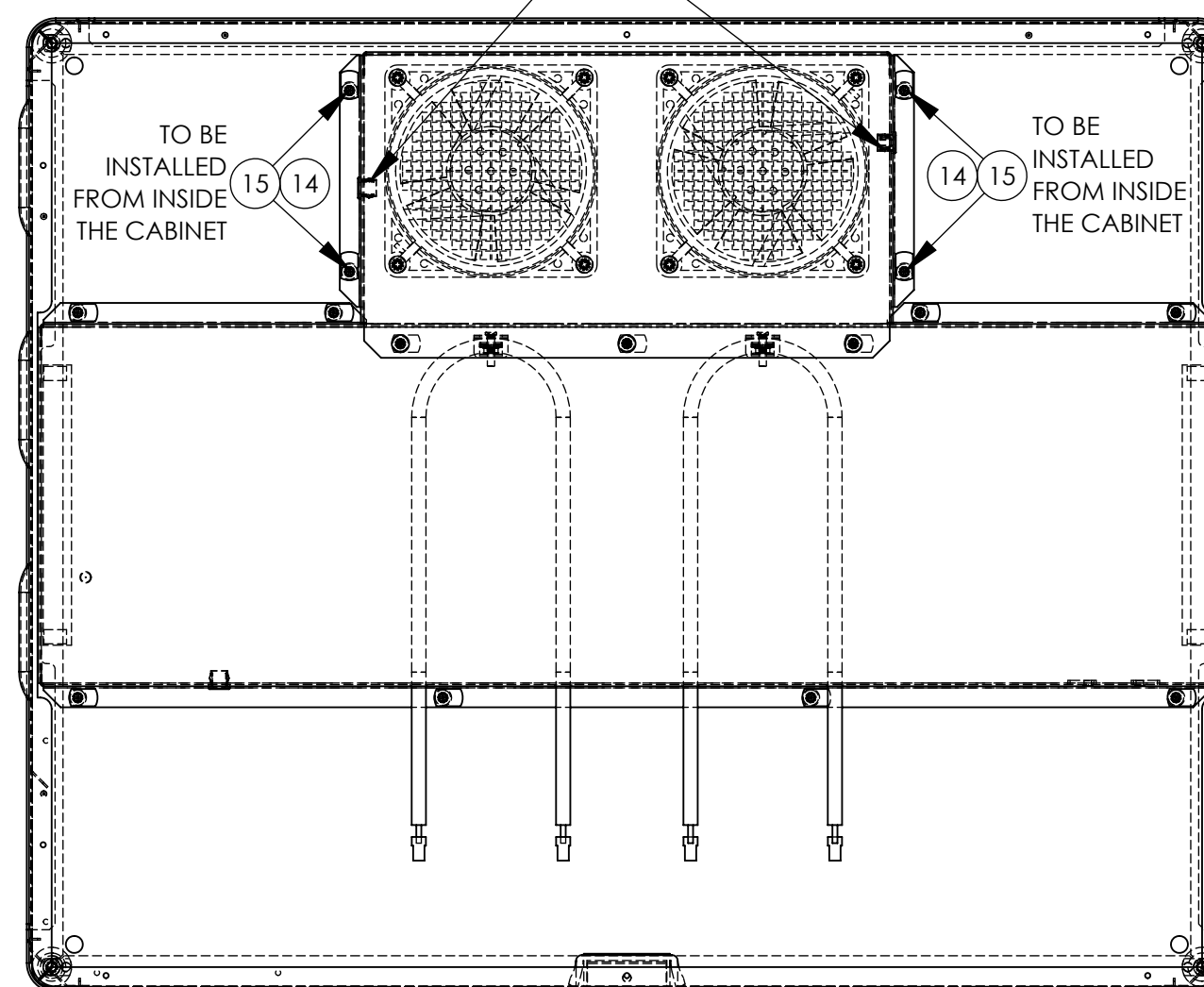

**STEP # 6**

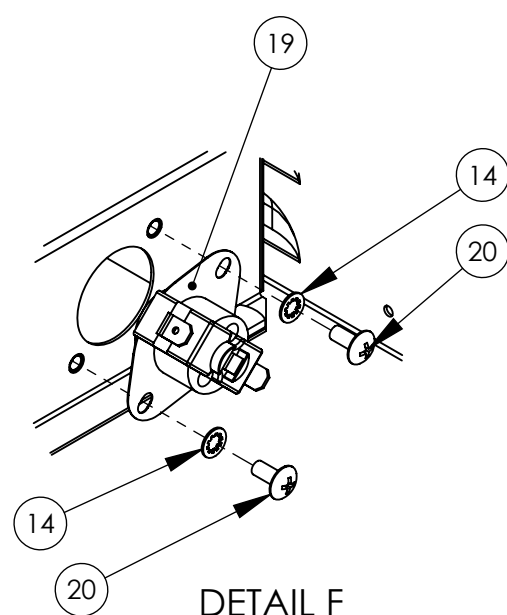

DETAIL F  
SCALE 1 : 2

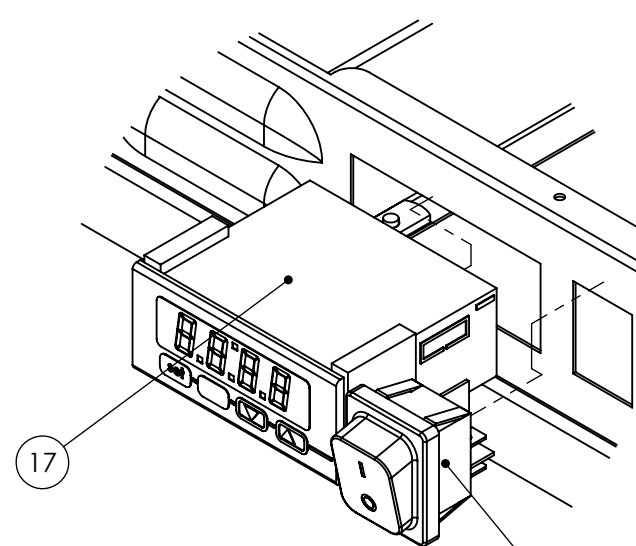

DETAIL G  
SCALE 1 : 2

- STANDARD NOTES:**
1. REMOVE SHARP EDGES AND BURRS.
  2. UNLESS SPECIFIED ALL DIMENSIONS ARE IN INCHES.
  3. REFERENCE DIMENSIONS ARE INDICATED IN PARENTHESIS.
  4. CRITICAL DIMENSIONS THAT NEED INSPECTION ARE INDICATED IN OBOUND BOX.
  5. T.S.C. STAND FOR THEORITICAL SHARP CORNER & INS STAND FOR INSIDE.
  6. FOR SHEET METAL, UNLESS SPECIFIED ALL DIMENSIONS ARE OUTSIDE.
  7. FOR SHEET METAL, FLAT PATTERNS ARE FOR REFERENCE ONLY.
  8. MINOR SCRATCHES ARE ALLOWED ON OPPOSITE SIDE OF MILL FINISH & #4 FINISH.

THIRD ANGLE PROJECTION		176 MITTEL DRIVE, WOOD DALE, IL 60191 www.cretors.com   www.flo-thru.com	
TOLERANCES		DESCRIPTION	
x.xx = ± 0.02 x.xxx = ± 0.01 ANGLES = ± 1° HOLES = +0.005 / -0 FINISH = 125Ra		DISPLAY WARMER, 120V/1/60Hz	
C SIZE DRAWING		MATERIAL	
DRAWN BY: ndarji		REFER INDIVIDUAL SUB-PARTS	
DRAWN DATE: 03/19/2019		APPROX WEIGHT: 99.6 LBS	
APPROVED BY:		DRAWING NUMBER: DWAXX-X	
APPROVED DATE:		REVISION: -	
THIS DRAWING CONTAINS INFORMATION PROPRIETARY TO C. CRETORS & CO. AND IS FURNISHED IN CONFIDENCE FOR SOLE PURPOSE OF SUPPLYING THE RECIPIENT WITH NEEDED ENGINEERING DATA. THE CONTENTS SHOULD NOT BE DISCLOSED OR REPRODUCED IN ANY MANNER WITHOUT WRITTEN CONSENT OF C. CRETORS & CO. ALL RIGHTS RESERVED.			
			SHEET 3 OF 10

8 7 6 5 4 3 2 1

H  
G  
F  
E  
D  
C  
B  
A

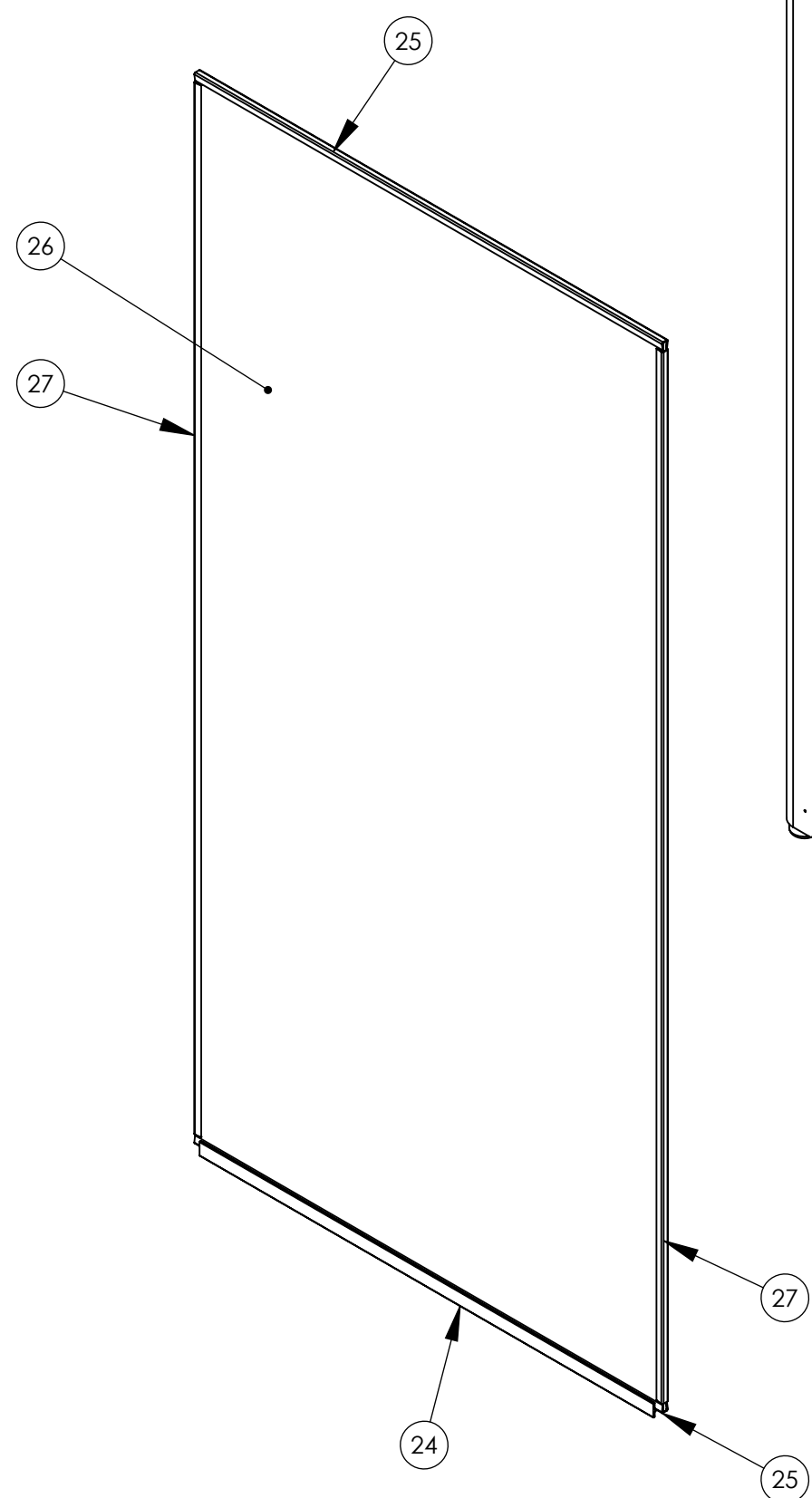

TYPICAL SIDE GLASS & CHANNEL ASSEMBLY ON THE OPPOSITE SIDE

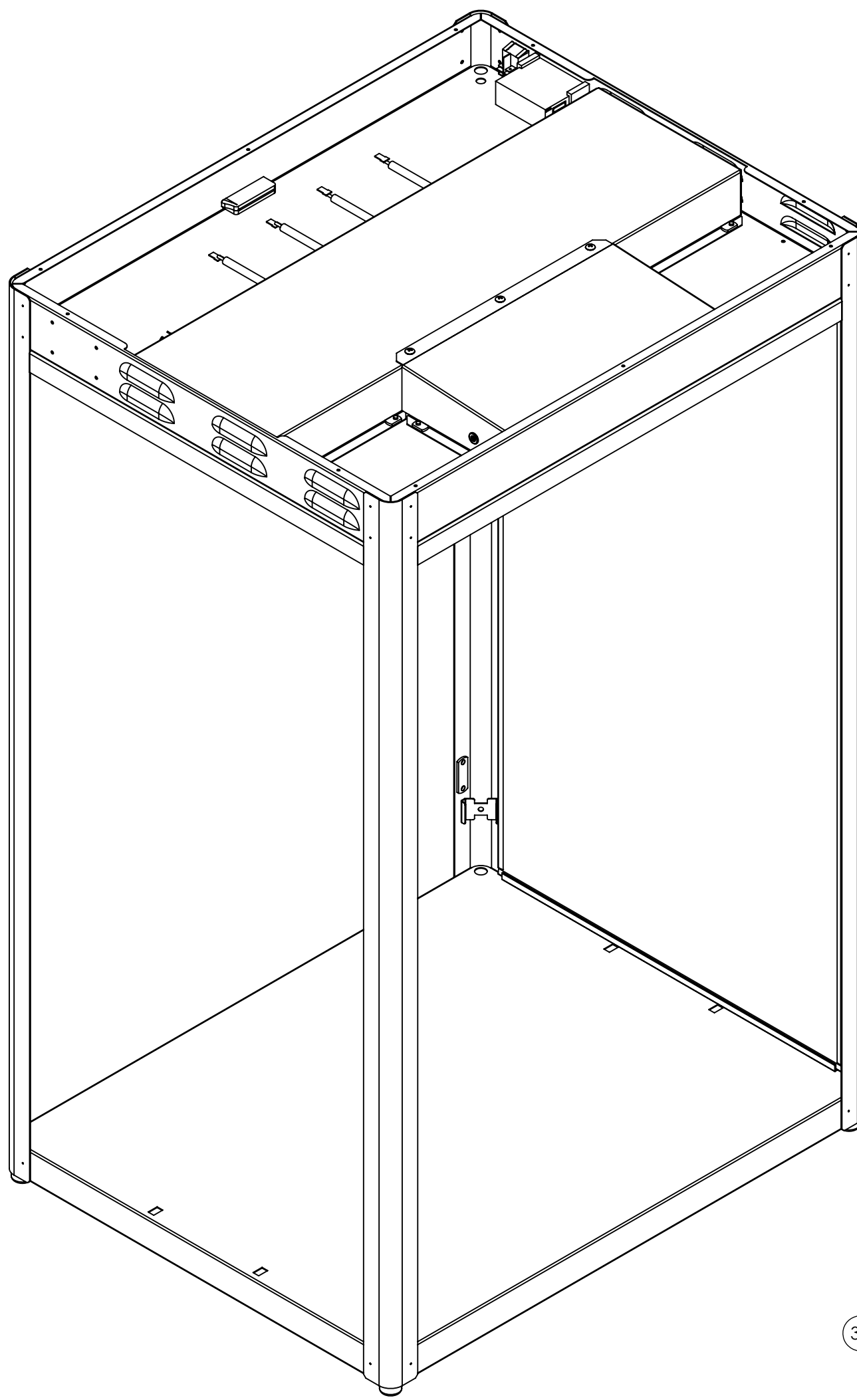

**STEP # 7**

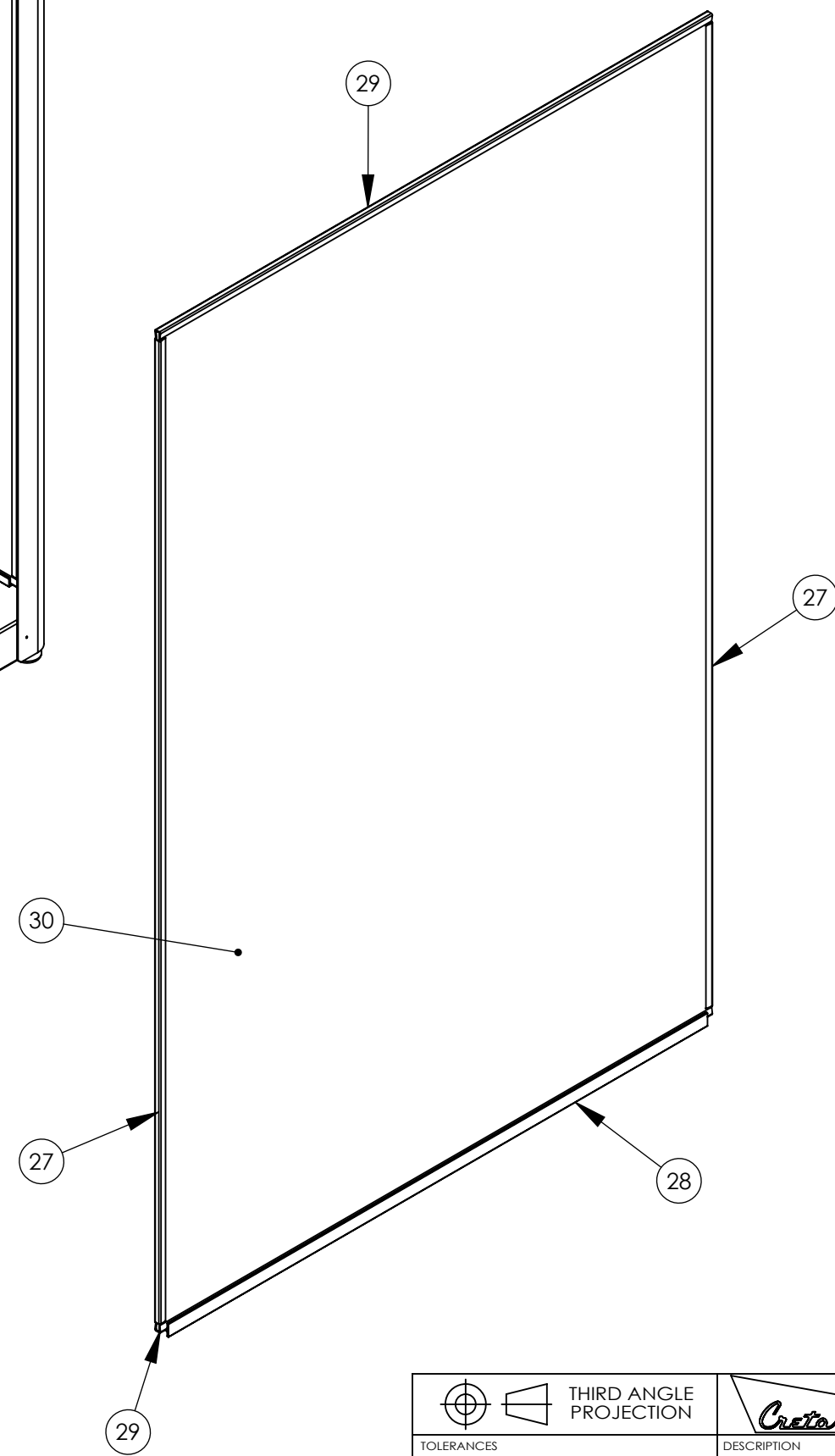

- STANDARD NOTES:**
1. REMOVE SHARP EDGES AND BURRS.
  2. UNLESS SPECIFIED ALL DIMENSIONS ARE IN INCHES.
  3. REFERENCE DIMENSIONS ARE INDICATED IN PARENTHESIS.
  4. CRITICAL DIMENSIONS THAT NEED INSPECTION ARE INDICATED IN OBROUND BOX.
  5. T.S.C. STAND FOR THEORITICAL SHARP CORNER & INS STAND FOR INSIDE.
  6. FOR SHEET METAL, UNLESS SPECIFIED ALL DIMENSIONS ARE OUTSIDE.
  7. FOR SHEET METAL, FLAT PATTERNS ARE FOR REFERENCE ONLY.
  8. MINOR SCRATCHES ARE ALLOWED ON OPPOSITE SIDE OF MILL FINISH & #4 FINISH.

THIRD ANGLE PROJECTION		176 MITTEL DRIVE, WOOD DALE, IL 60191 www.cretors.com   www.ilo-thru.com	
TOLERANCES x.xx = ± 0.02 x.xxx = ± 0.01 ANGLES = ± 1° HOLES = +0.005 / -0 FINISH = 125Ra		DESCRIPTION <b>DISPLAY WARMER, 120V/1/60Hz</b>	
C SIZE DRAWING		MATERIAL REFER INDIVIDUAL SUB-PARTS	
DRAWN BY ndarji	DRAWN DATE 03/19/2019	DRAWING NUMBER <b>DWAXX-X</b>	APPROX. WEIGHT 99.6 LBS
APPROVED BY	APPROVED DATE	REVISION	SHEET 4 OF 10
<small>THIS DRAWING CONTAINS INFORMATION PROPRIETARY TO C. CRETORS &amp; CO. AND IS FURNISHED IN CONFIDENCE FOR SOLE PURPOSE OF SUPPLYING THE RECIPIENT WITH NEEDED ENGINEERING DATA. THE CONTENTS SHOULD NOT BE DISCLOSED OR REPRODUCED IN ANY MANNER WITHOUT WRITTEN CONSENT OF C. CRETORS &amp; CO. ALL RIGHTS RESERVED.</small>			

**STEP # 8**

HOOK THE U-NUT ON THE CORNER BRACKET WITH SPLIT THREAD TAB BEHIND THE BRACKET

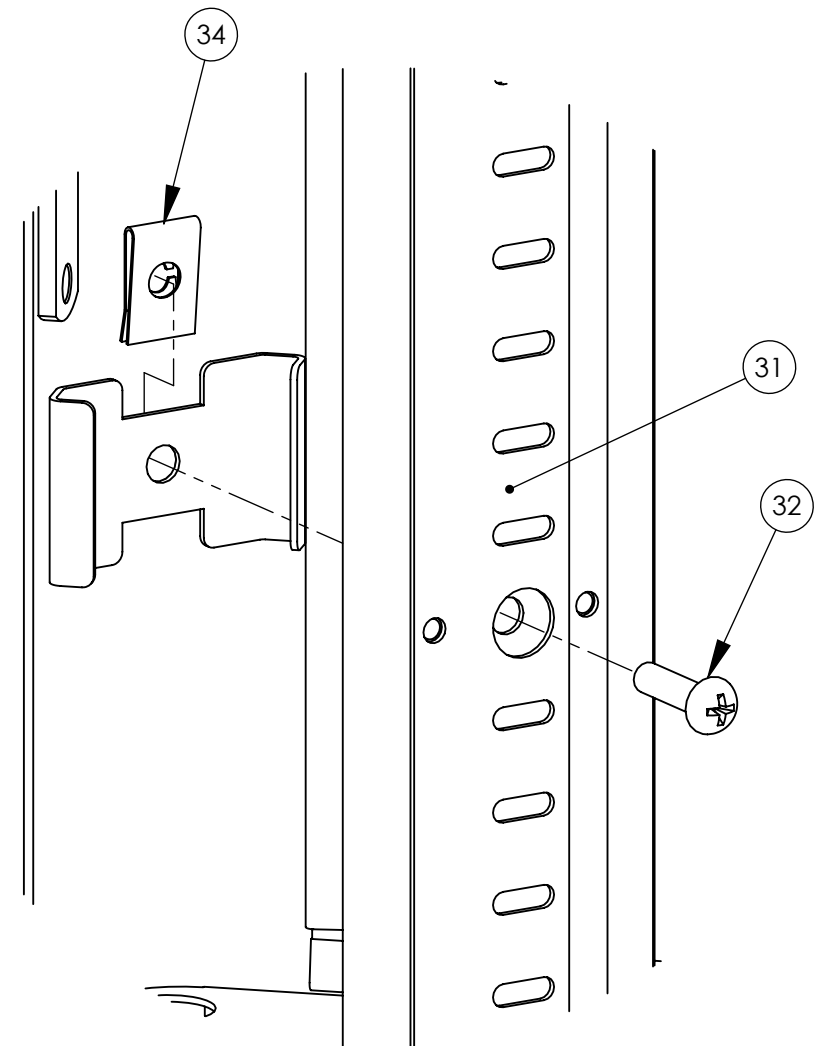

DETAIL H  
SCALE 1 : 1

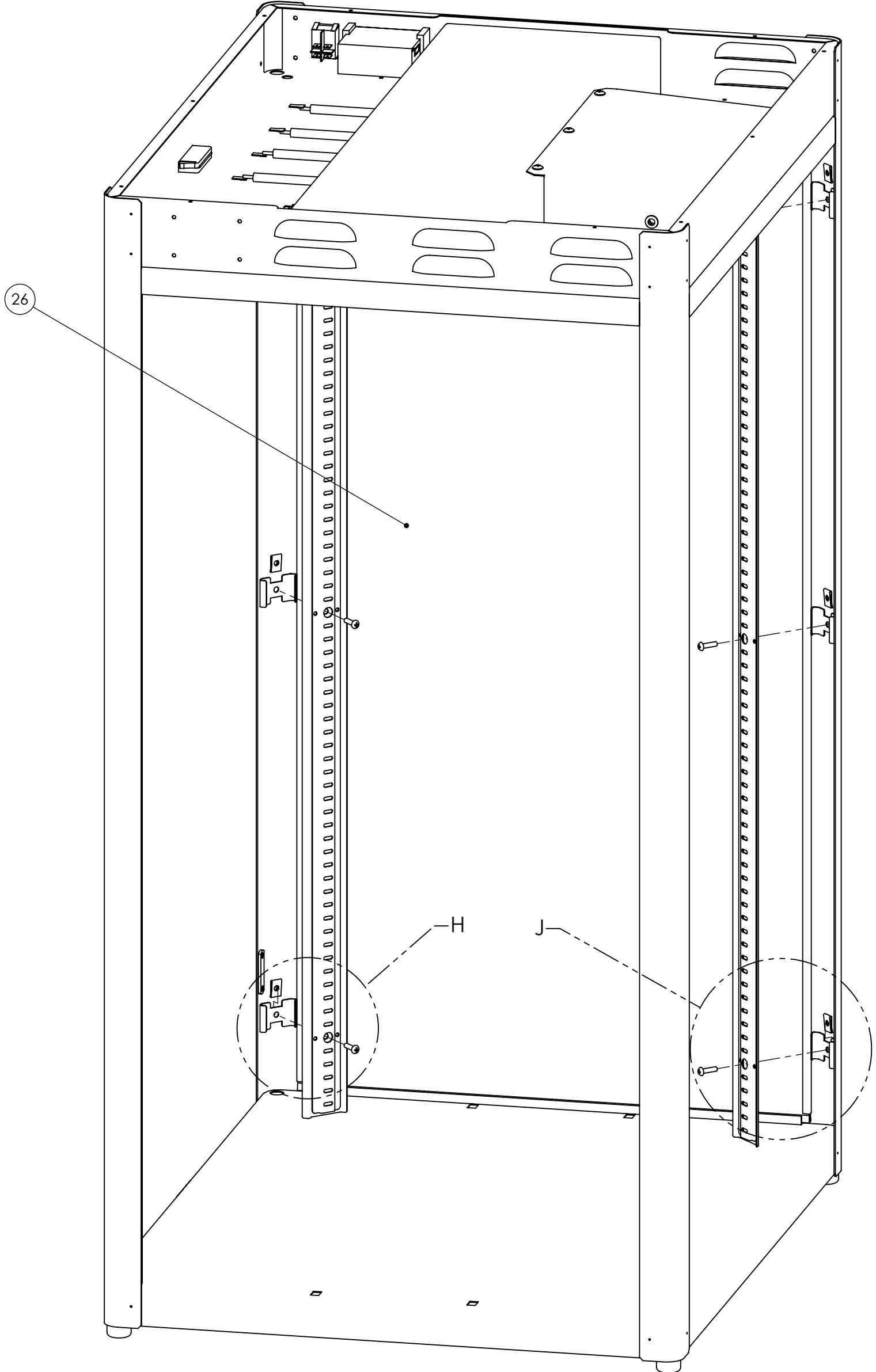

HOOK THE U-NUT ON THE CORNER BRACKET WITH SPLIT THREAD TAB BEHIND THE BRACKET

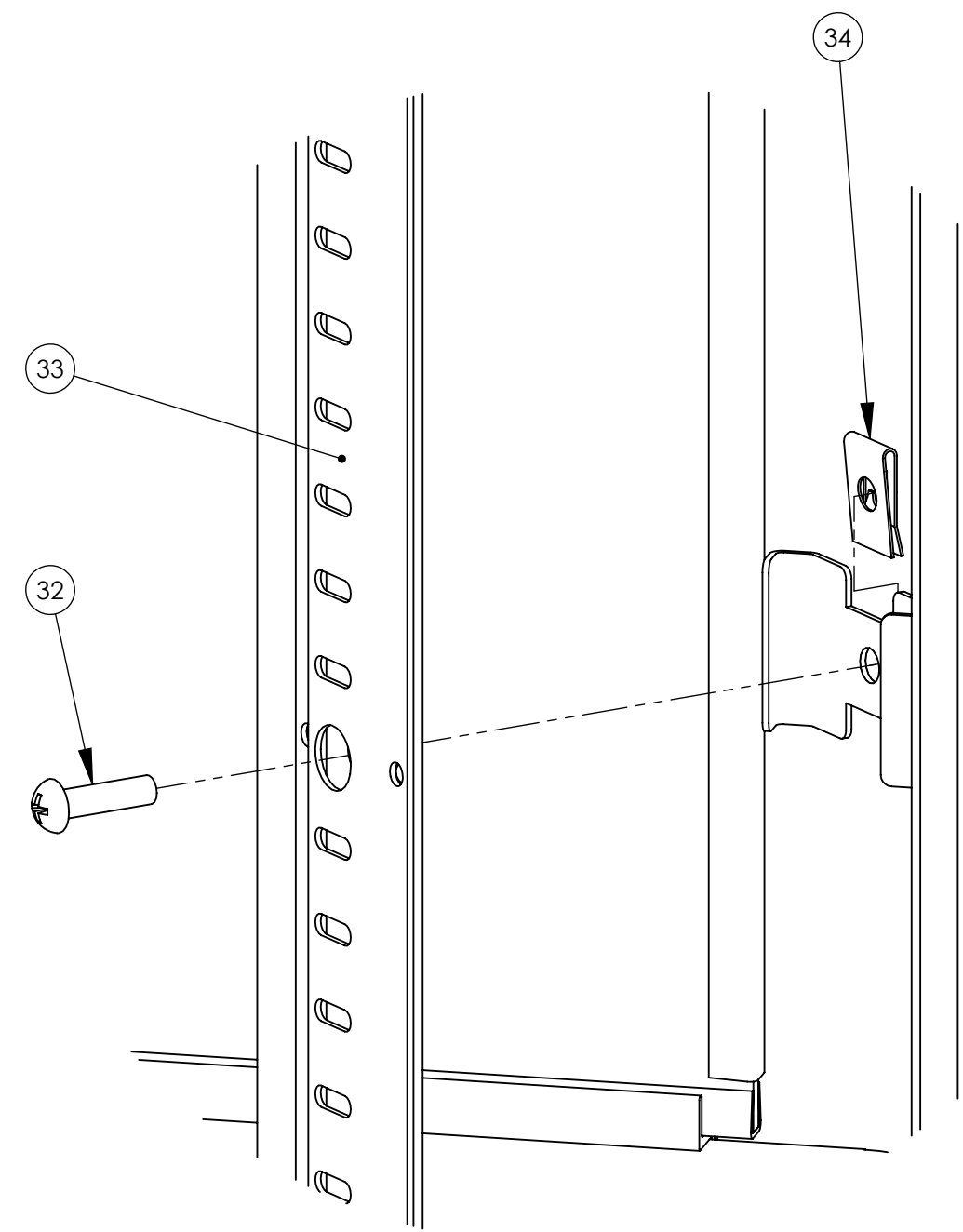

DETAIL J  
SCALE 1 : 1

**WITH FRONT AND SIDE GLASSES IN PLACE WITH THEIR RESPECTIVE CHANNELS, AS PER PREVIOUS STEP, ASSEMBLE GLASS IN PLACE USING THE CORNER BRACKETS WITH TRACKS AS SHOWN. FRONT GLASS MADE HIDDEN FOR CLARITY. TYPICAL INSTALLATION FOR ALL THREE GLASSES ON THREE SIDES OF THE WARMER**

- STANDARD NOTES:**
1. REMOVE SHARP EDGES AND BURRS.
  2. UNLESS SPECIFIED ALL DIMENSIONS ARE IN INCHES.
  3. REFERENCE DIMENSIONS ARE INDICATED IN PARENTHESIS.
  4. CRITICAL DIMENSIONS THAT NEED INSPECTION ARE INDICATED IN OBOUND BOX.
  5. T.S.C. STAND FOR THEORITICAL SHARP CORNER & INS STAND FOR INSIDE.
  6. FOR SHEET METAL, UNLESS SPECIFIED ALL DIMENSIONS ARE OUTSIDE.
  7. FOR SHEET METAL, FLAT PATTERNS ARE FOR REFERENCE ONLY.
  8. MINOR SCRATCHES ARE ALLOWED ON OPPOSITE SIDE OF MILL FINISH & #4 FINISH.

THIRD ANGLE PROJECTION		176 MITTEL DRIVE, WOOD DALE, IL 60191 www.cretors.com   www.ilo-thru.com	
TOLERANCES x.xx = ± 0.02 x.xxx = ± 0.01 ANGLES = ± 1° HOLES = +0.005 / -0 FINISH = 125Ra		DESCRIPTION DISPLAY WARMER, 120V/1/60Hz	
C SIZE DRAWING		MATERIAL	APPROX. WEIGHT
DRAWN BY: ndarji		REFER INDIVIDUAL SUB-PARTS	99.6 LBS
DRAWN DATE: 03/19/2019		DRAWING NUMBER	REVISION
APPROVED BY:		DWAXX-X	-
APPROVED DATE:		THIS DRAWING CONTAINS INFORMATION PROPRIETARY TO C. CRETORS & CO. AND IS FURNISHED IN CONFIDENCE FOR SOLE PURPOSE OF SUPPLYING THE RECIPIENT WITH NEEDED ENGINEERING DATA. THE CONTENTS SHOULD NOT BE DISCLOSED OR REPRODUCED IN ANY MANNER WITHOUT WRITTEN CONSENT OF C. CRETORS & CO. ALL RIGHTS RESERVED.	
		SHEET 5 OF 10	

**STEP # 9**

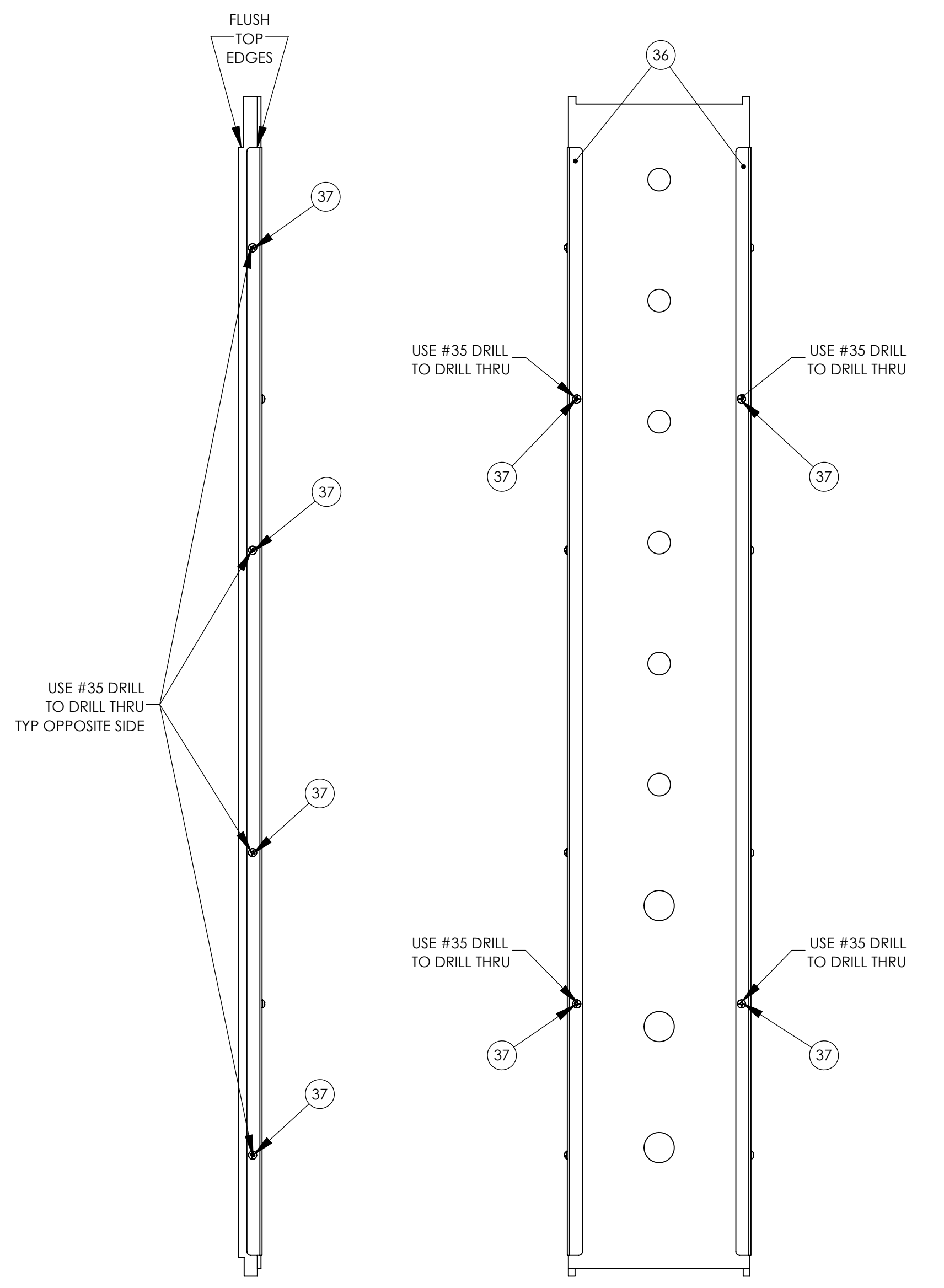
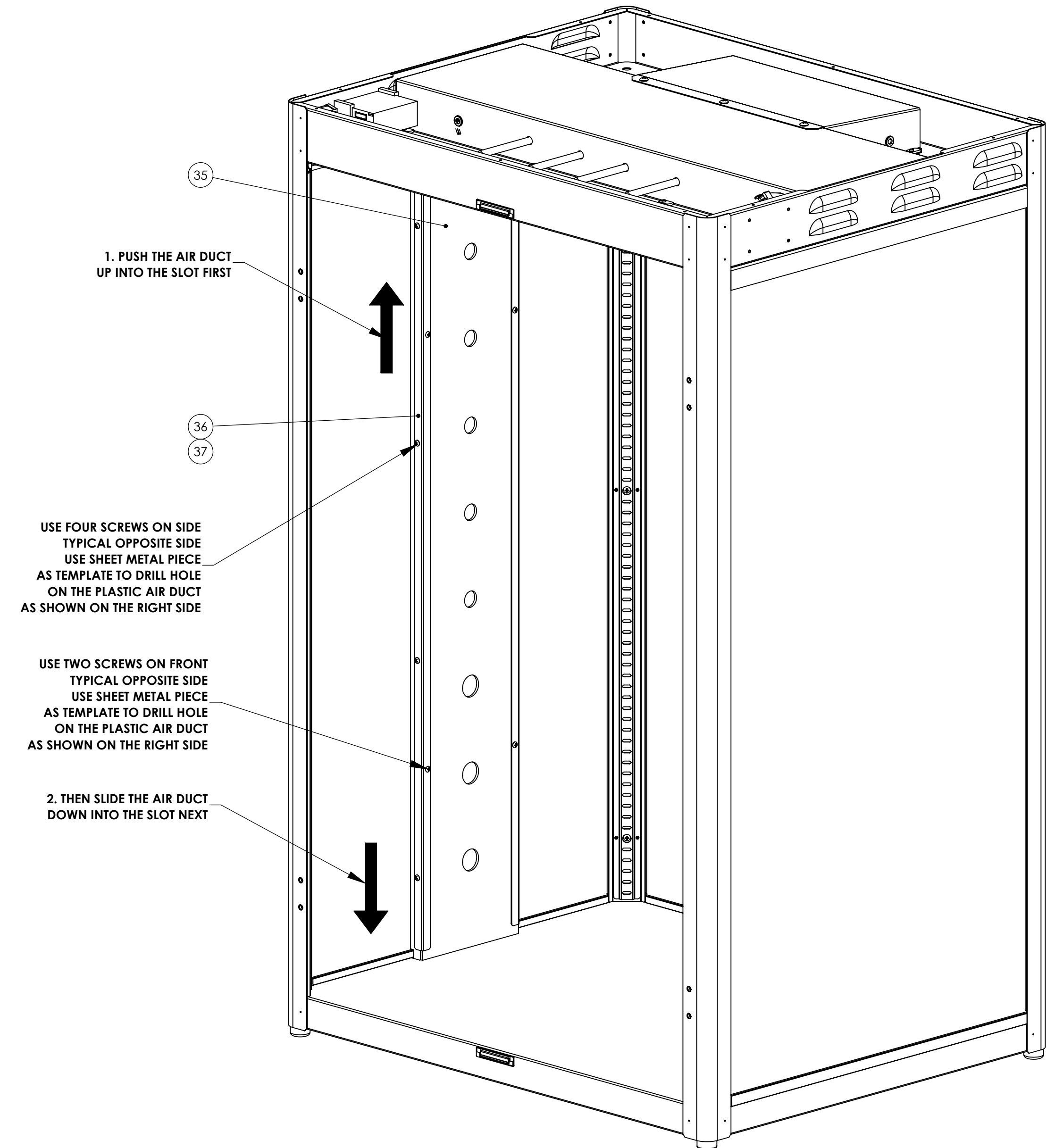

**USE #35 DRILL BIT TO DRILL 12 HOLES PER AIR DUCT  
USE HOLES ON STIFFENER AS A TEMPLATE TO LOCATE  
HOLES ON THE AIR DUCT.**

- STANDARD NOTES:**
1. REMOVE SHARP EDGES AND BURRS.
  2. UNLESS SPECIFIED ALL DIMENSIONS ARE IN INCHES.
  3. REFERENCE DIMENSIONS ARE INDICATED IN PARENTHESIS.
  4. CRITICAL DIMENSIONS THAT NEED INSPECTION ARE INDICATED IN OBOUND BOX.
  5. T.S.C. STAND FOR THEORITICAL SHARP CORNER & INS STAND FOR INSIDE.
  6. FOR SHEET METAL, UNLESS SPECIFIED ALL DIMENSIONS ARE OUTSIDE.
  7. FOR SHEET METAL, FLAT PATTERNS ARE FOR REFERENCE ONLY.
  8. MINOR SCRATCHES ARE ALLOWED ON OPPOSITE SIDE OF MILL FINISH & #4 FINISH.

		THIRD ANGLE PROJECTION 176 MITTEL DRIVE, WOOD DALE, IL 60191 www.cretors.com   www.flo-thru.com	
TOLERANCES x.xx = ± 0.02 x.xxx = ± 0.01 ANGLES = ± 1° HOLES = +0.005 / -0 FINISH = 125Ra		DESCRIPTION <b>DISPLAY WARMER, 120V/1/60Hz</b>	
C SIZE DRAWING		MATERIAL REFER INDIVIDUAL SUB-PARTS	
DRAWN BY ndarji	DRAWN DATE 03/19/2019	APPROX WEIGHT 99.6 LBS	REVISION -
APPROVED BY [Signature]		DRAWING NUMBER <b>DWAXX-X</b>	
THIS DRAWING CONTAINS INFORMATION PROPRIETARY TO C. CRETORS & CO. AND IS FURNISHED IN CONFIDENCE FOR SOLE PURPOSE OF SUPPLYING THE RECIPIENT WITH NEEDED ENGINEERING DATA. THE CONTENTS SHOULD NOT BE DISCLOSED OR REPRODUCED IN ANY MANNER WITHOUT WRITTEN CONSENT OF C. CRETORS & CO. ALL RIGHTS RESERVED.			

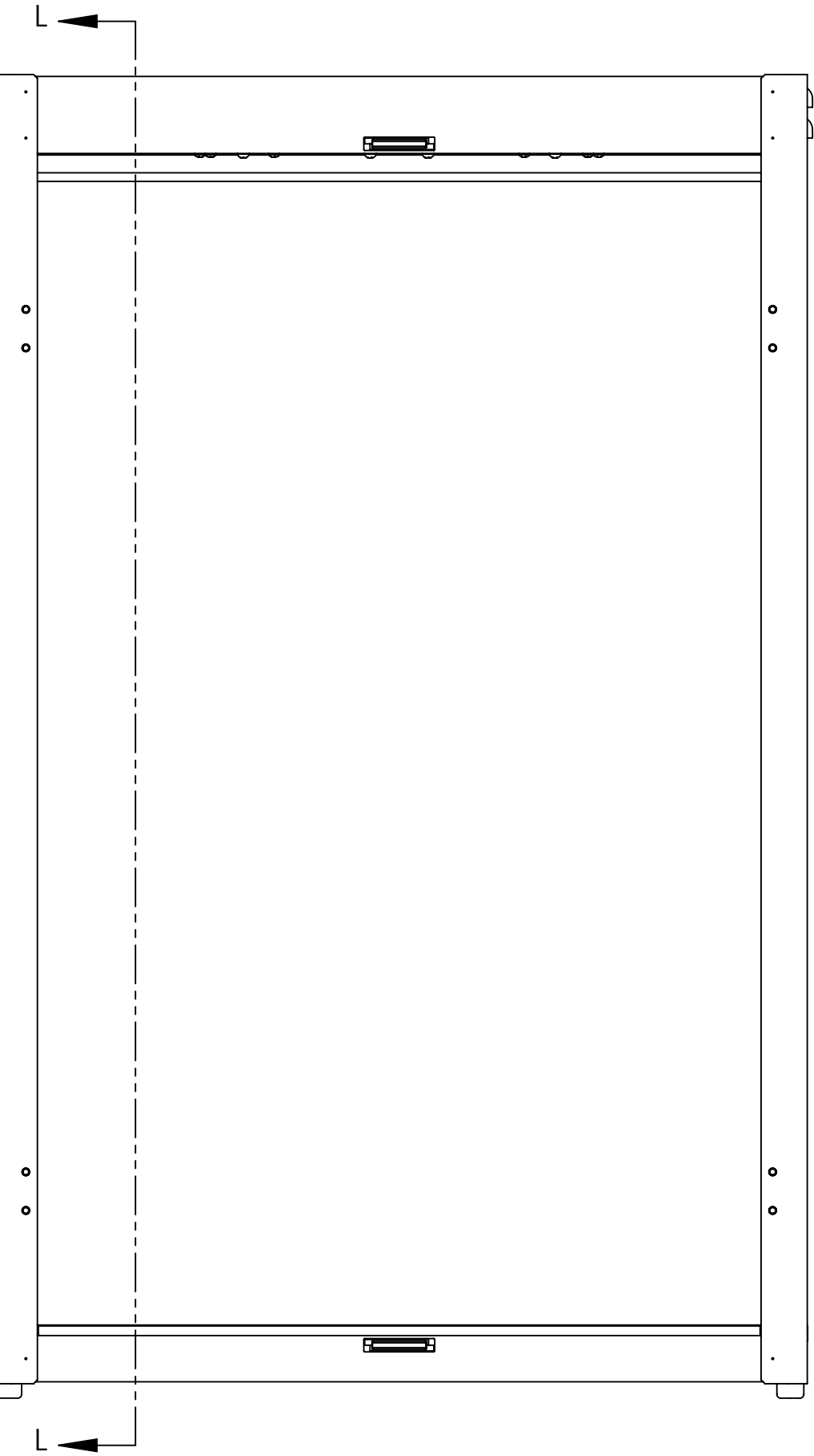

**STEP # 10**

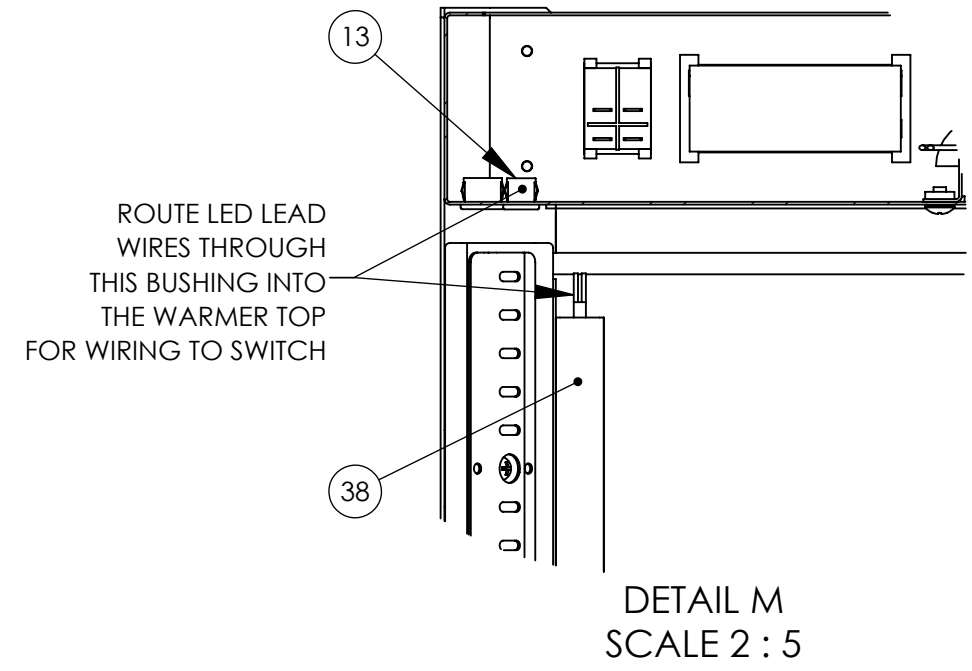
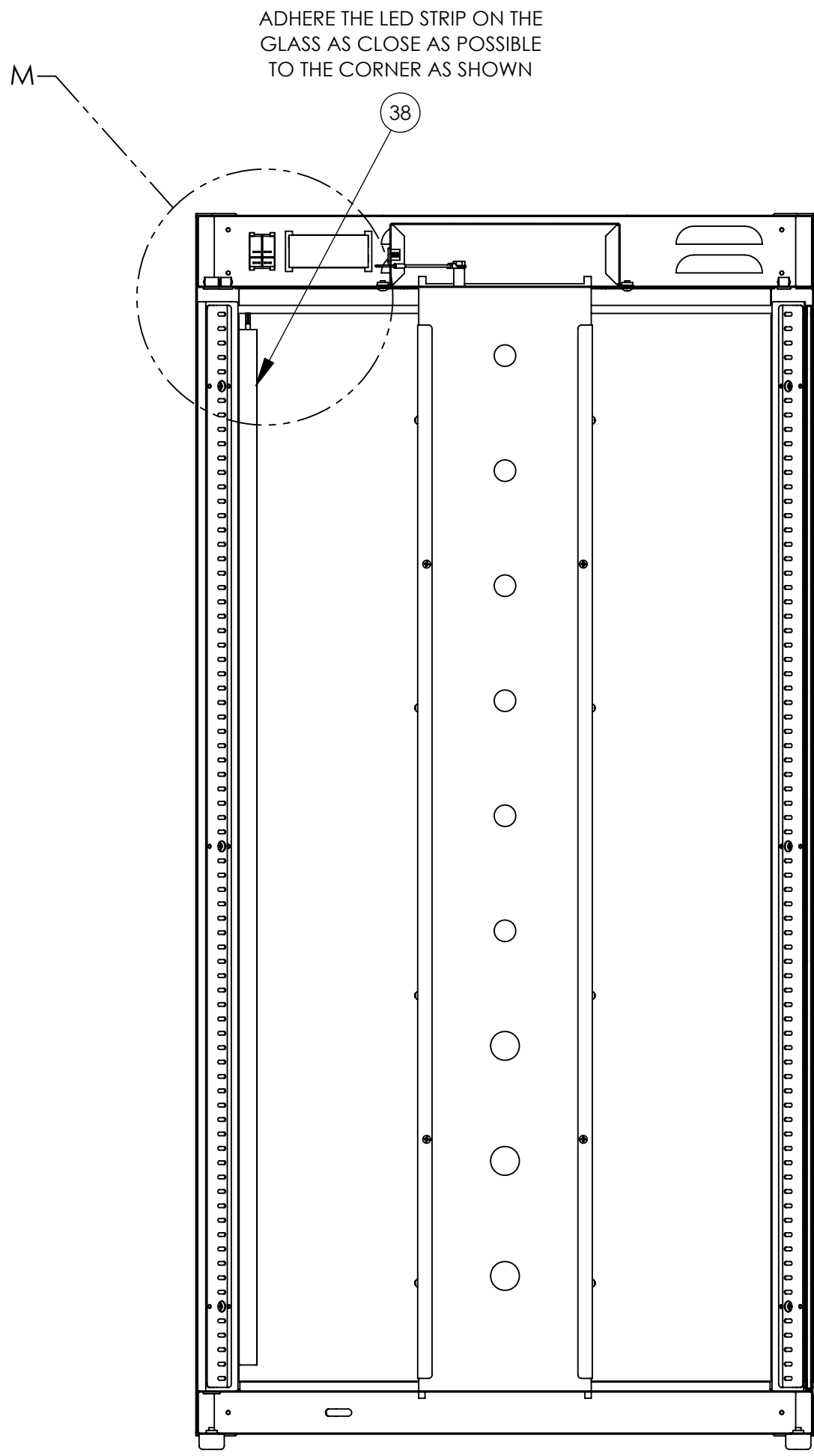

SECTION L-L  
SCALE 1 : 5

- STANDARD NOTES:**
1. REMOVE SHARP EDGES AND BURRS.
  2. UNLESS SPECIFIED ALL DIMENSIONS ARE IN INCHES.
  3. REFERENCE DIMENSIONS ARE INDICATED IN PARENTHESIS.
  4. CRITICAL DIMENSIONS THAT NEED INSPECTION ARE INDICATED IN OBOUND BOX.
  5. T.S.C. STAND FOR THEORITICAL SHARP CORNER & INS STAND FOR INSIDE.
  6. FOR SHEET METAL, UNLESS SPECIFIED ALL DIMENSIONS ARE OUTSIDE.
  7. FOR SHEET METAL, FLAT PATTERNS ARE FOR REFERENCE ONLY.
  8. MINOR SCRATCHES ARE ALLOWED ON OPPOSITE SIDE OF MILL FINISH & #4 FINISH.

THIRD ANGLE PROJECTION		176 MITTEL DRIVE, WOOD DALE, IL 60191 www.cretors.com   www.ilo-thru.com	
<b>TOLERANCES</b> x.xx = ± 0.02 x.xxx = ± 0.01 ANGLES = ± 1° HOLES = +0.005 / -0 FINISH = 125Ra		<b>DESCRIPTION</b> DISPLAY WARMER, 120V/1/60Hz	
<b>C SIZE DRAWING</b>		<b>MATERIAL</b> REFER INDIVIDUAL SUB-PARTS	
<b>DRAWN BY</b> ndarji	<b>DRAWN DATE</b> 03/19/2019	<b>APPROX. WEIGHT</b> 99.6 LBS	
<b>APPROVED BY</b>	<b>APPROVED DATE</b>	<b>DRAWING NUMBER</b> DWAXX-X	
THIS DRAWING CONTAINS INFORMATION PROPRIETARY TO C. CRETORS & CO. AND IS FURNISHED IN CONFIDENCE FOR SOLE PURPOSE OF SUPPLYING THE RECIPIENT WITH NEEDED ENGINEERING DATA. THE CONTENTS SHOULD NOT BE DISCLOSED OR REPRODUCED IN ANY MANNER WITHOUT WRITTEN CONSENT OF C. CRETORS & CO. ALL RIGHTS RESERVED.			<b>SHEET</b> 7 OF 10



**STEP # 11**

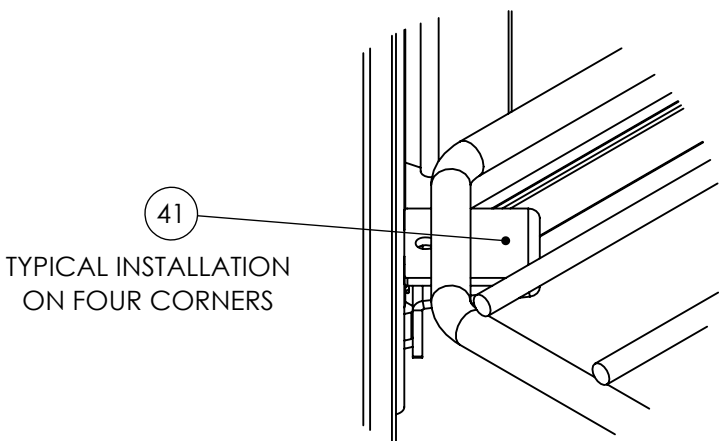
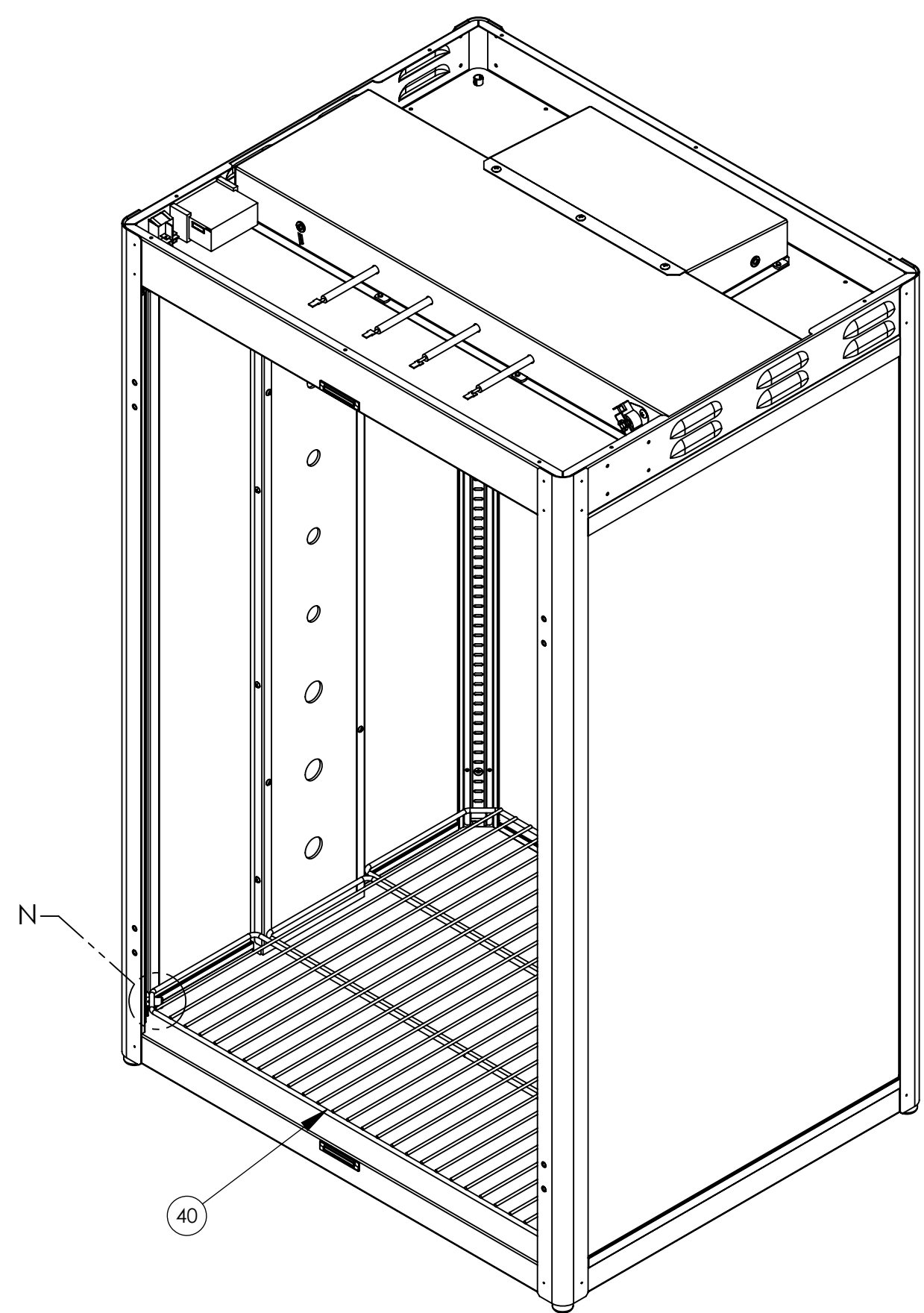

DETAIL N  
SCALE 1 : 1

1. INSERT ALL WIRE RACKS INSIDE THE WARMER FIRST.
2. MOVE ONE RACK UP AT A TIME AND INSTALL THEM STARTING FROM THE TOP RACK.
3. USE CLIPS ON FOUR CORNER TRACKS TO HOLD THE RACK IN PLACE.

**STEP # 12**

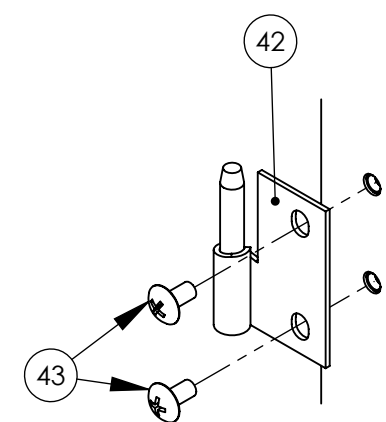
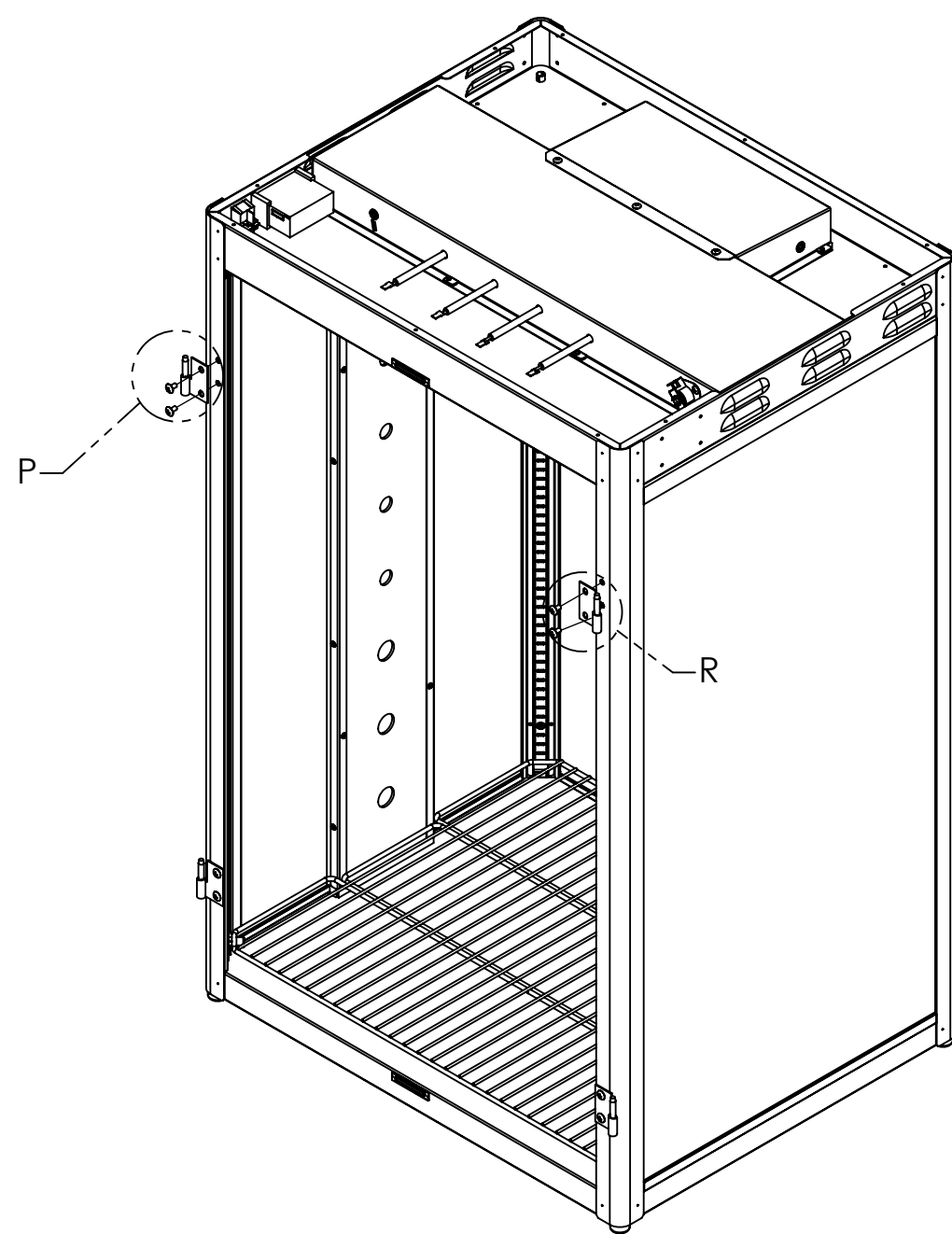

DETAIL P  
SCALE 1 : 2

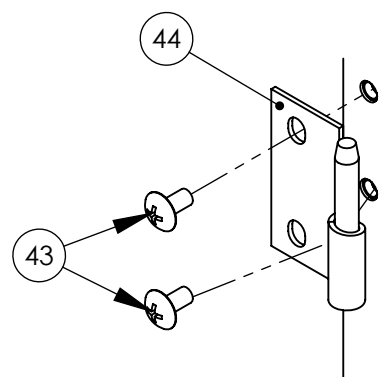

DETAIL R  
SCALE 1 : 2

**STEP # 13**

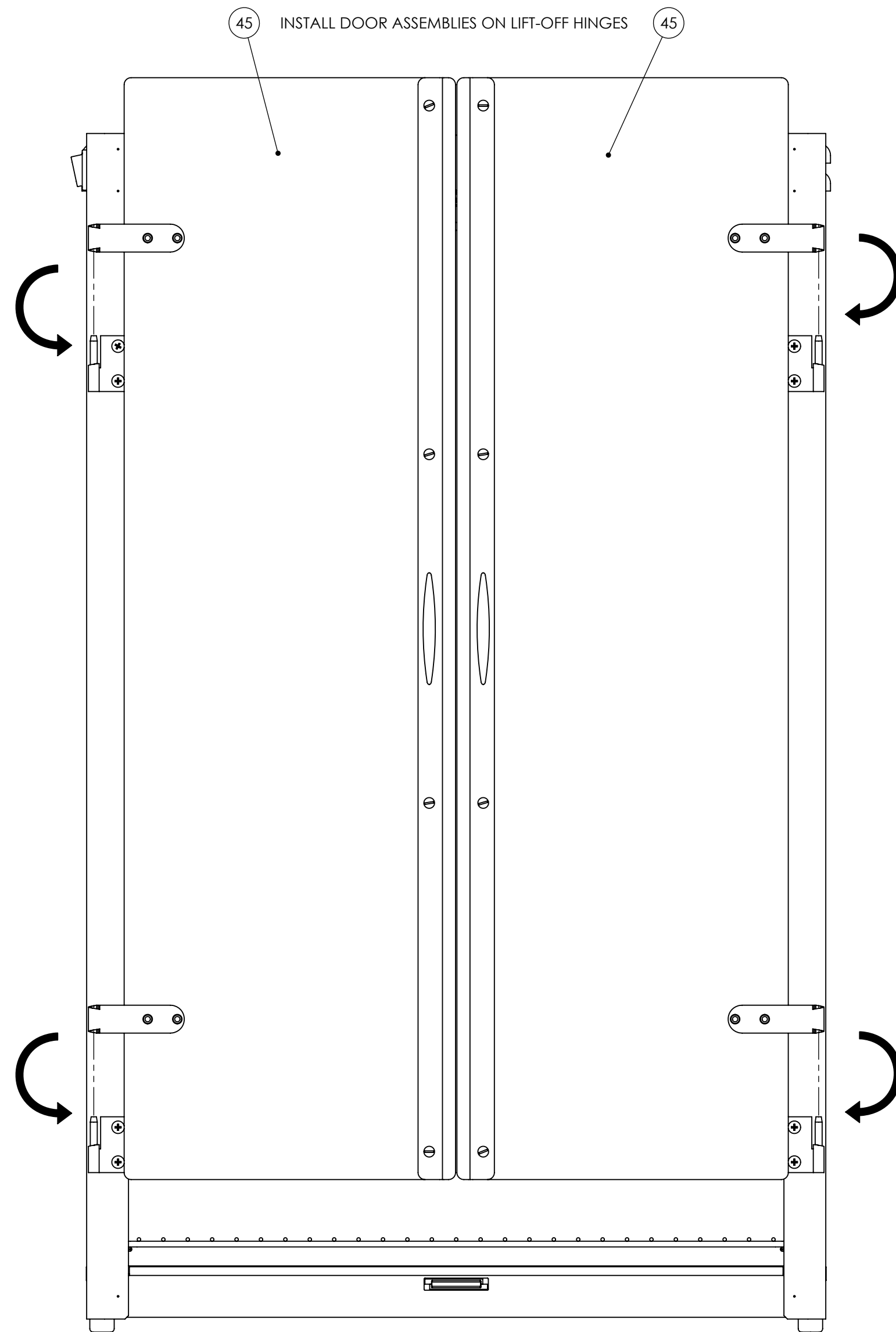

- STANDARD NOTES:**
1. REMOVE SHARP EDGES AND BURRS.
  2. UNLESS SPECIFIED ALL DIMENSIONS ARE IN INCHES.
  3. REFERENCE DIMENSIONS ARE INDICATED IN PARENTHESIS.
  4. CRITICAL DIMENSIONS THAT NEED INSPECTION ARE INDICATED IN OBOUND BOX.
  5. T.S.C. STAND FOR THEORITICAL SHARP CORNER & INS STAND FOR INSIDE.
  6. FOR SHEET METAL, UNLESS SPECIFIED ALL DIMENSIONS ARE OUTSIDE.
  7. FOR SHEET METAL, FLAT PATTERNS ARE FOR REFERENCE ONLY.
  8. MINOR SCRATCHES ARE ALLOWED ON OPPOSITE SIDE OF MILL FINISH & #4 FINISH.

THIRD ANGLE PROJECTION		176 MITTEL DRIVE, WOOD DALE, IL 60191 www.cretors.com   www.ilo-llnu.com	
TOLERANCES x.xx = ± 0.02 x.xxx = ± 0.01 ANGLES = ± 1° HOLES = +0.005 / -0 FINISH = 125Ra		DESCRIPTION <b>DISPLAY WARMER, 120V/1/60Hz</b>	
C SIZE DRAWING		MATERIAL REFER INDIVIDUAL SUB-PARTS	
DRAWN BY ndarji	DRAWN DATE 03/19/2019	DRAWING NUMBER DWAXX-X	APPROX. WEIGHT 99.6 LBS
APPROVED BY	APPROVED DATE	REVISION	SHEET 8 OF 10
THIS DRAWING CONTAINS INFORMATION PROPRIETARY TO C. CRETORS & CO. AND IS FURNISHED IN CONFIDENCE FOR SOLE PURPOSE OF SUPPLYING THE RECIPIENT WITH NEEDED ENGINEERING DATA. THE CONTENTS SHOULD NOT BE DISCLOSED OR REPRODUCED IN ANY MANNER WITHOUT WRITTEN CONSENT OF C. CRETORS & CO. ALL RIGHTS RESERVED.			

**STEP # 14**

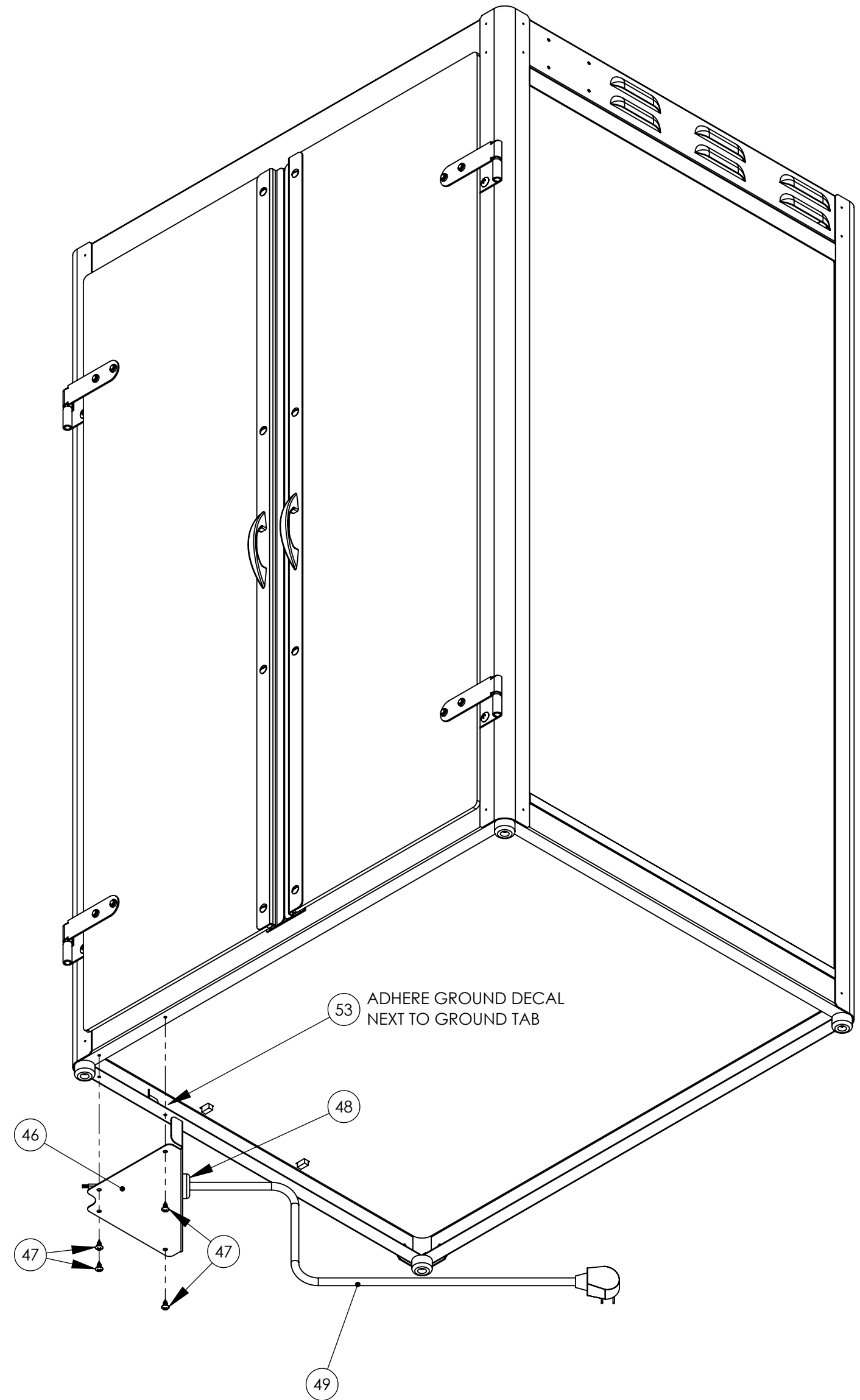

**STEP # 15**

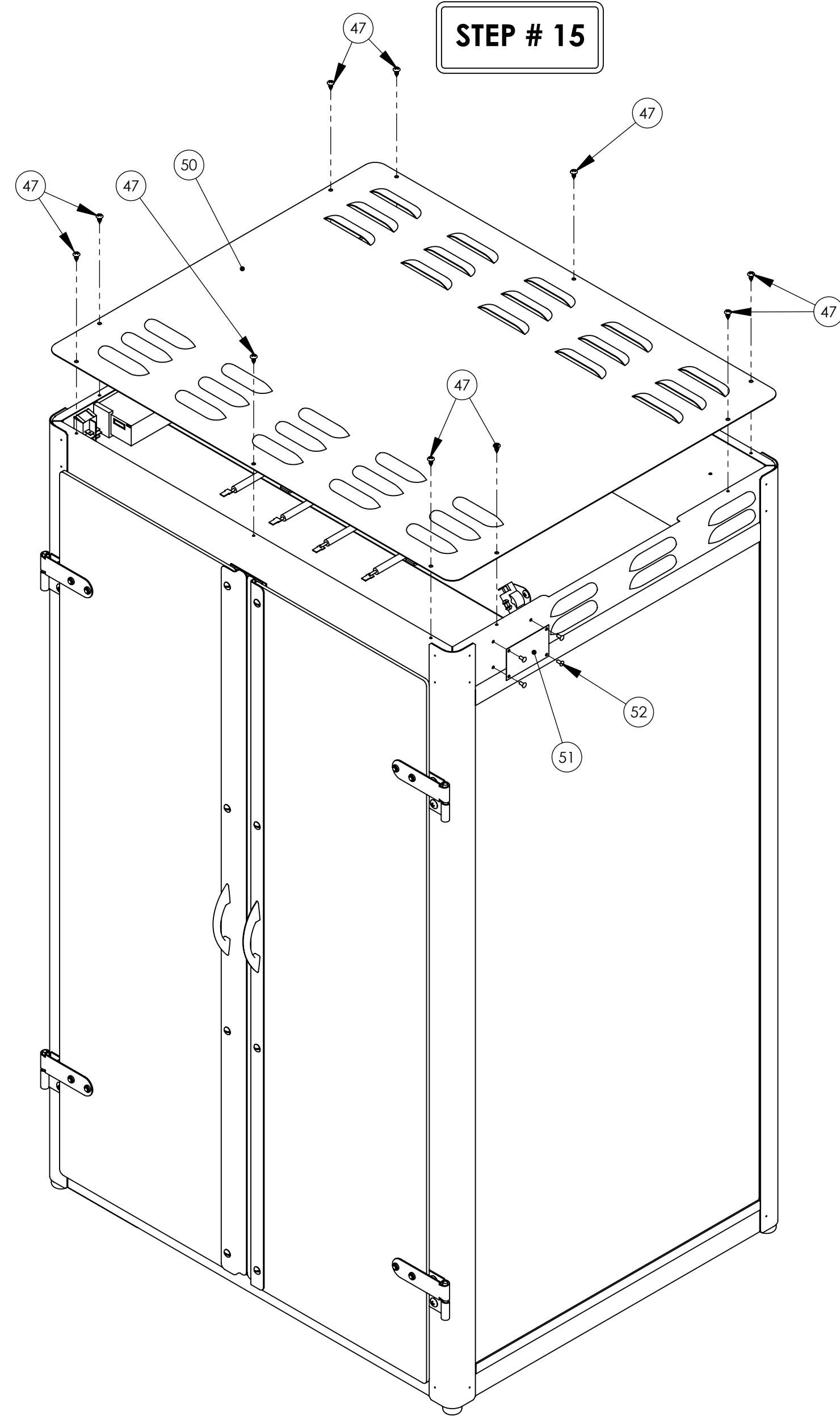

- STANDARD NOTES:**
1. REMOVE SHARP EDGES AND BURRS.
  2. UNLESS SPECIFIED ALL DIMENSIONS ARE IN INCHES.
  3. REFERENCE DIMENSIONS ARE INDICATED IN PARENTHESIS.
  4. CRITICAL DIMENSIONS THAT NEED INSPECTION ARE INDICATED IN OBOUND BOX.
  5. T.S.C. STAND FOR THEORITICAL SHARP CORNER & INS STAND FOR INSIDE.
  6. FOR SHEET METAL, UNLESS SPECIFIED ALL DIMENSIONS ARE OUTSIDE.
  7. FOR SHEET METAL, FLAT PATTERNS ARE FOR REFERENCE ONLY.
  8. MINOR SCRATCHES ARE ALLOWED ON OPPOSITE SIDE OF MILL FINISH & #4 FINISH.

<p>THIRD ANGLE PROJECTION</p>		<p>176 MITTEL DRIVE, WOOD DALE, IL 60191 www.cretors.com   www.ilo-thru.com</p>	
<p>TOLERANCES</p> <p>x.xx = ± 0.02 x.xxx = ± 0.01 ANGLES = ± 1° HOLES = +0.005 / -0 FINISH = 125Ra</p>		<p>DESCRIPTION</p> <p><b>DISPLAY WARMER, 120V/1/60Hz</b></p>	
<p>C SIZE DRAWING</p>		MATERIAL	APPROX. WEIGHT
<p>DRAWN BY: <b>ndarji</b></p>		REFER INDIVIDUAL SUB-PARTS	99.6 LBS
<p>DRAWN DATE: <b>03/19/2019</b></p>		DRAWING NUMBER	REVISION
<p>APPROVED BY:</p>		<b>DWAXX-X</b>	-
<p>APPROVED DATE:</p>		<p>THIS DRAWING CONTAINS INFORMATION PROPRIETARY TO C. CRETORS &amp; CO. AND IS FURNISHED IN CONFIDENCE FOR SOLE PURPOSE OF SUPPLYING THE RECIPIENT WITH NEEDED ENGINEERING DATA. THE CONTENTS SHOULD NOT BE DISCLOSED OR REPRODUCED IN ANY MANNER WITHOUT WRITTEN CONSENT OF C. CRETORS &amp; CO. ALL RIGHTS RESERVED.</p>	
		<p>SHEET 9 OF 10</p>	

8 7 6 5 4 3 2 1

H  
G  
F  
E  
D  
C  
B  
A

H  
G  
F  
E  
D  
C  
B  
A

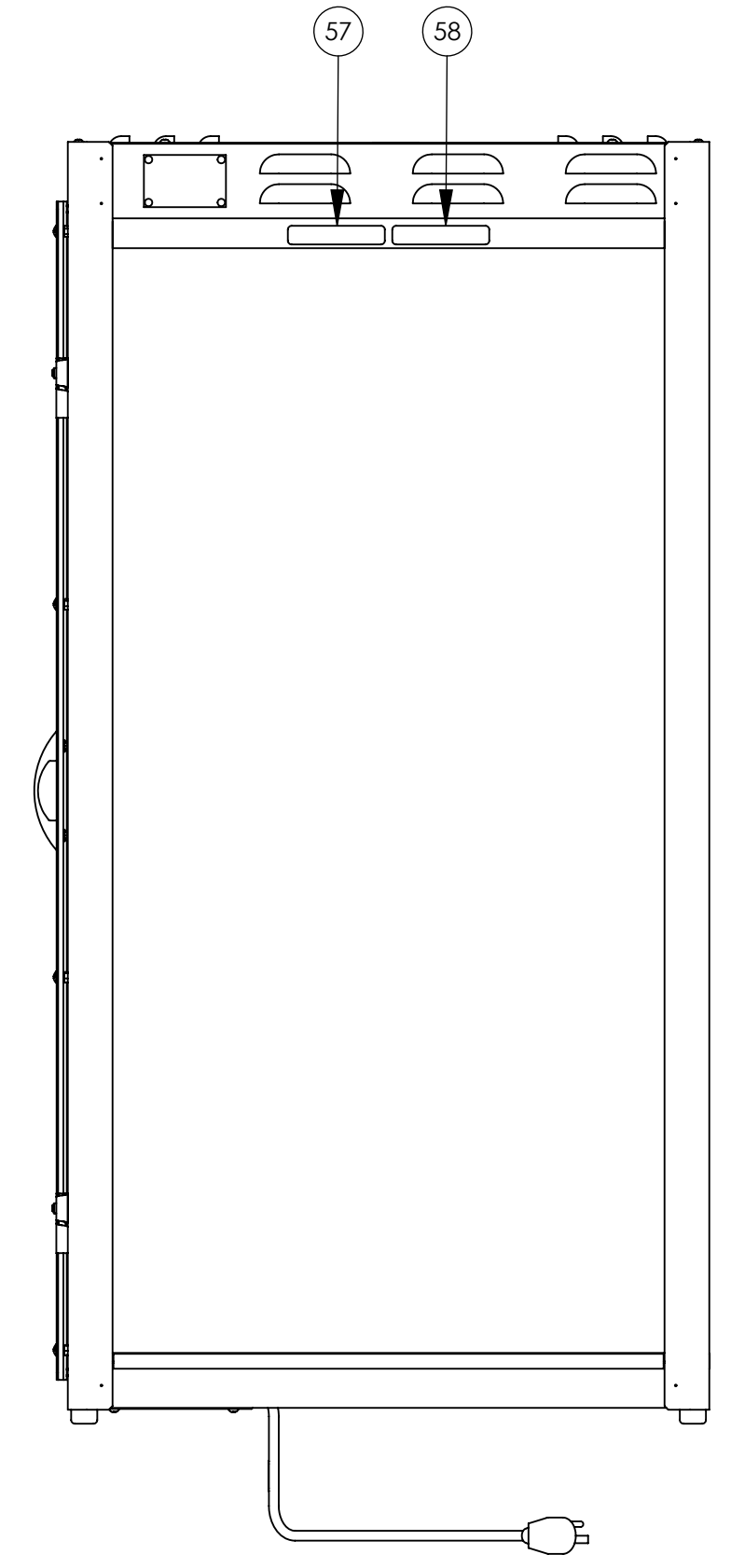
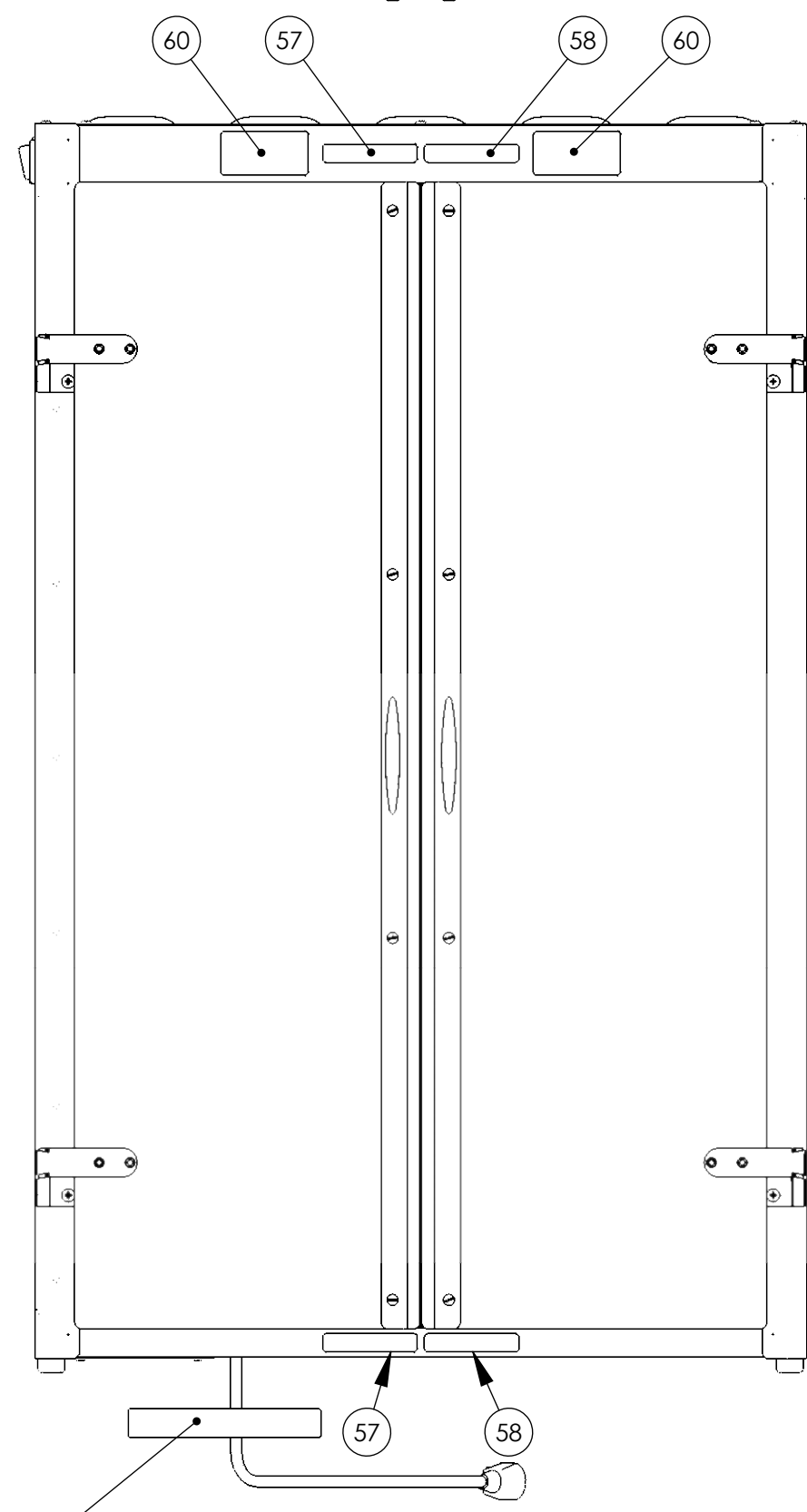
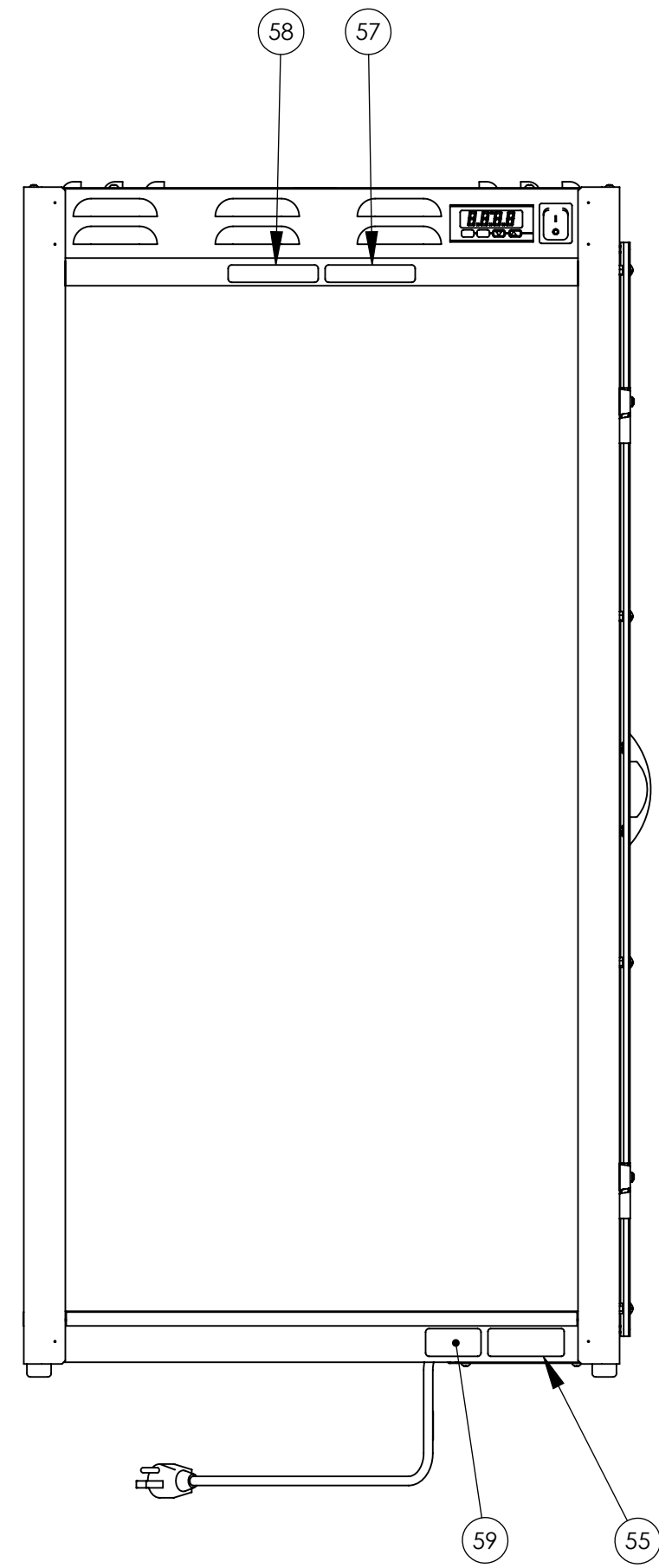
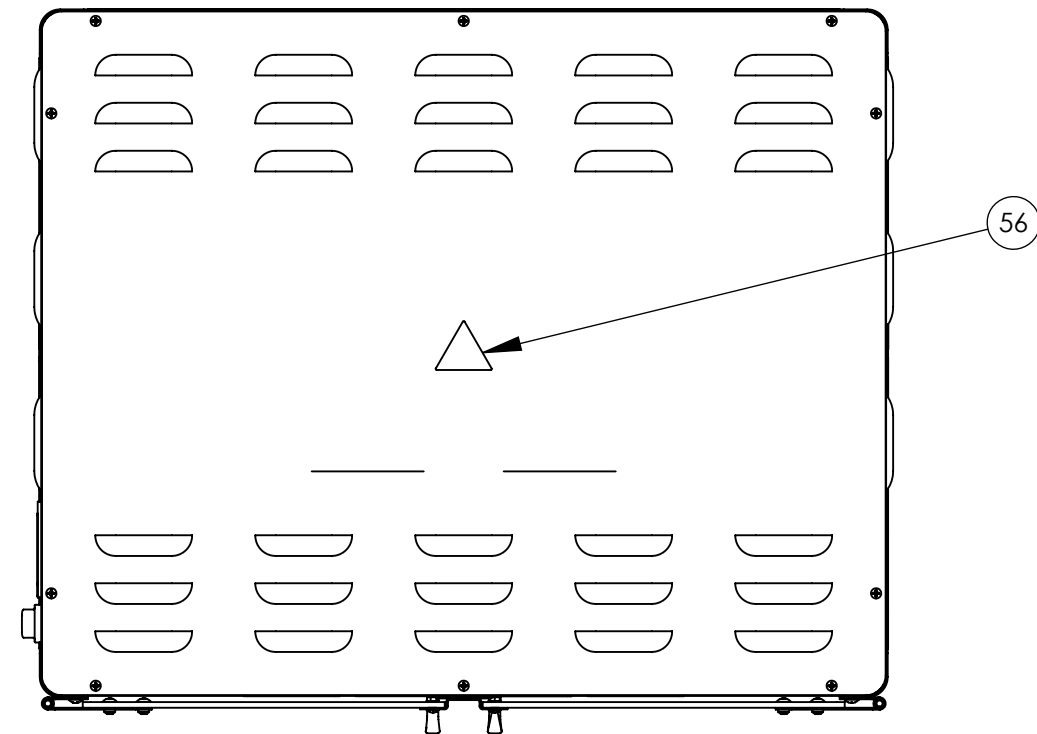

WRAP AROUND THE CORD  
SUCH THAT TEXT IS VISIBLE ON  
BOTH SIDES

**STEP # 16**

- STANDARD NOTES:**
1. REMOVE SHARP EDGES AND BURRS.
  2. UNLESS SPECIFIED ALL DIMENSIONS ARE IN INCHES.
  3. REFERENCE DIMENSIONS ARE INDICATED IN PARENTHESIS.
  4. CRITICAL DIMENSIONS THAT NEED INSPECTION ARE INDICATED IN OBOUND BOX.
  5. T.S.C. STAND FOR THEORITICAL SHARP CORNER & INS STAND FOR INSIDE.
  6. FOR SHEET METAL, UNLESS SPECIFIED ALL DIMENSIONS ARE OUTSIDE.
  7. FOR SHEET METAL, FLAT PATTERNS ARE FOR REFERENCE ONLY.
  8. MINOR SCRATCHES ARE ALLOWED ON OPPOSITE SIDE OF MILL FINISH & #4 FINISH.

		176 MITTEL DRIVE, WOOD DALE, IL 60191 www.cretors.com   www.ilo-ifu.com	
TOLERANCES x.xx = ± 0.02 x.xxx = ± 0.01 ANGLES = ± 1° HOLES = +0.005 / -0 FINISH = 125Ra		DESCRIPTION <b>DISPLAY WARMER, 120V/1/60Hz</b>	
C SIZE DRAWING		MATERIAL REFER INDIVIDUAL SUB-PARTS	
DRAWN BY ndarji	DRAWN DATE 03/19/2019	DRAWING NUMBER DWAXX-X	APPROX. WEIGHT 99.6 LBS
APPROVED BY		APPROVED DATE	
APPROVED DATE		SHEET 10 OF 10	

8 7 6 5 4 3 2 1