

1033	DISCHARGE TUBE LOCKNUT	4267	RETAINING RING
1034	DISCHARGE TUBE SUPPORT COLLAR	4268	RETAINER
1069	HOSE CLAMP	4269	RETAINER BRACKET
1100	DUMP LEVER KNOB	4271	STIRRER SHAFT
1114	HEX CONNECTOR SET SCREW	4273	ADJUSTING BLOCK
1127	NSF PAN CENTER	4280	TOP STIFFENER
1144	PAN CENTER WASHER	4282-A	COMPLETE KETTLE ASSY
1223	PLASTIC HOSE-SOLD PER FOOT	4283	SHAFT CONNECTOR BOLT W/ WING NUTS
1236	THERMOSTAT HOLDING CLIP	4298	COVER LIFT GUIDE BOLT
1255	3/8" CONNECTOR	4299	COVER LIFT GUIDE NUT
1472	STIRRER BLADE RETAINING SPRING	4773	KETTLE COVER - NSF
1697	WIRE LAMP GUARD	4784	COVER LIFT HOOK
1714	KNOB	4861	FAN BLADE
1734	LAMP-250 WATT, 120V	7581	STIRRER BLADE
1769	ELEMENT CLAMP	7621	1/4" INTERNAL TOOTH LOCKWASHER
1808-A	1250 WATT, 120 VOLT ELEMENT	7623	10-32 HEX NUT
1809-A	750 WATT, 120 VOLT ELEMENT	7630	1/4-20 x 1/2 HEX BOLT
1834	THERMOSTAT	7639	1/4-20 CAP NUT
1991	SPRING	7646	1/4 x 28 HEX NUT
2058	POPPER PAN	7681	12-24 STOP NUT
*2067-1	KETTLE WIRE KIT COMPLETE - MR TUV	7762	12-24 x 3/4 FILLISTER HEAD
2109	DUMP HANDLE	7809	5/16 STAR WASHER
2110	KETTLE RETURN SPRING	7887	5/16-18 HEX NUT
2110-1	RETAINER SPRING CLIP	10474	RETAINER GASKET
2118	RETURN SPRING BALL SUPPORT		
2409	SNAP IN PORCELAIN SOCKET		
2718	KETTLE SUPPORT HANGER		
2723	KETTLE HINGE PIN		
2733	DISCHARGE TUBE		
2736	NICKEL STRAPS - SET OF TWO		
2772	RECEPTACLE ASSY, 20 AMP		
2773	PLUG ASSY, 230V		
4063	MICA PLATE ASSY.		
4263	MOTOR SHAFT CONNECTOR		
4264-A	AGITATOR MOTOR-120 VOLT		
4266	COVER LIFT ROD		

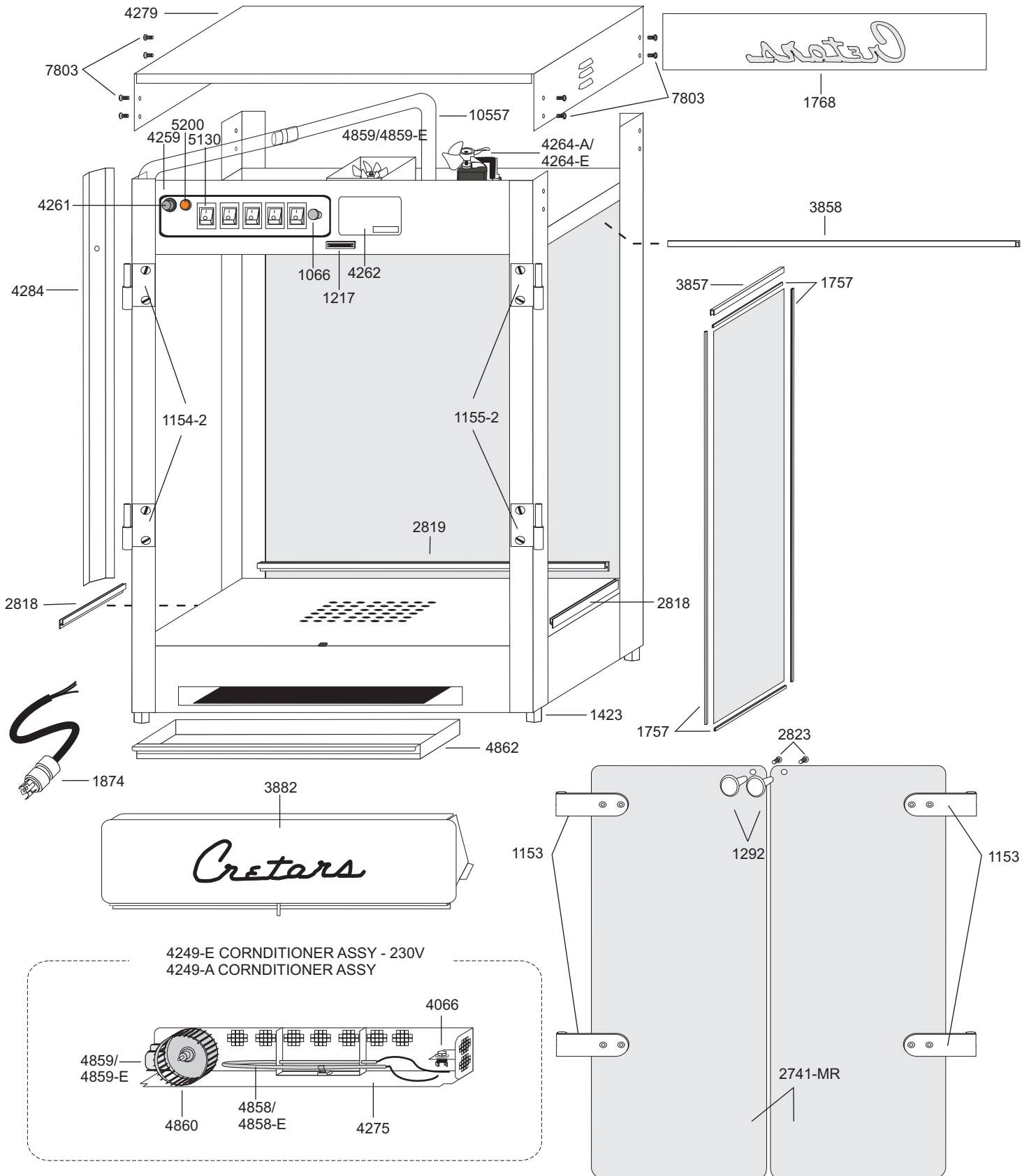

ECONO-MERCHANT CABINET

BEGINNING SERIAL No. 98010566/98063461

DOC: EMR30001

EMR16-A-3.0-A

04/00

1066	SWITCH PUSH BUTTON	5130	SWITCH - LIGHTED
1153	DOOR STRAP ONLY	5200	INDICATOR LIGHT
1154	DOOR HINGE & STRAP - LEFT	5959	DISCHARGE TUBE
1154-2	DOOR HINGE-ONLY - LEFT	7803	6-32 X 3/8 PHIL. PAN HEAD
1155	DOOR HINGE & STRAP - RIGHT		CORNDITIONERASSEMBLY
1155-2	DOOR HINGE-ONLY - RIGHT	4066	THERMOSTAT
1217	RECTANGULAR MAGNETIC CATCH	4249-E	CORNDITIONER ASSY.
1254	POWER SUPPLY CORD	4249-A	CORNDITIONER ASSY.
1292	CONCAVE (KNOB) W/ SCREW	4275	CORNDITIONER COVER
1296	ROUND MAGNETIC CATCH	4858	ELEMENT CORN. 400W
1423	RUBBER FOOT W/ HARDWARE	4858-E	ELEMENT CORN. 400W - 230V
1757	GLASS CHANNEL (SOLD PER FOOT)	4859	MOTOR
1768	SIGN - CRETORS-SCRIPT	4859-E	MOTOR - 230V
2165	CORD STRAIN RELIEF	4860	BLOWER MOTOR WHEEL
2414	"POPCORN" DECAL (NOT SHOWN)		
2741-MR	PLEXIGLASS DOOR (9-7/16 x 18-9/16 ACRYLIC .187)		
2818	EXTRUSION GLASS CHANNEL-SS - 18-3/4		
2823	DOOR KNOB SCREW		
3857	SS CHANNEL - 20-3/8		
3882	DROP SHELF		
4259	SWITCHPLATE DECAL		
4262	DECAL - INSTRUCTIONS		
4264-A	MOTOR AGITATOR - ECONO MR - 120V		
4264-E	MOTOR AGITATOR - ECONO MR - 230V		
4284	FRONT INSIDE CORNER		
4621	PUSH BUTTON CIRCUIT BREAKER 120V 15A (DOMESTIC MACHINES ONLY)		
4859	MOTOR - BLOWER - 120V		
4859-E	MOTOR - BLOWER - 230V		
4861	FAN BLADE		
4862	CLEAN OUT DRAWER		

C. CRETORS AND COMPANY

176 MITTEL DRIVE

WOOD DALE, IL 60191

PHONE: (847)616-6900, (800)228-1885, FAX: (847)616-6970

WEB SITE: <http://www.cretors.com>