

14845-A; 14845-A-SS
 14866-A; 14866-A-SS
 SEE TECH TALK #27
 NOTE:
 14581 RELAY WAS ADDED
 AFTER 07/06

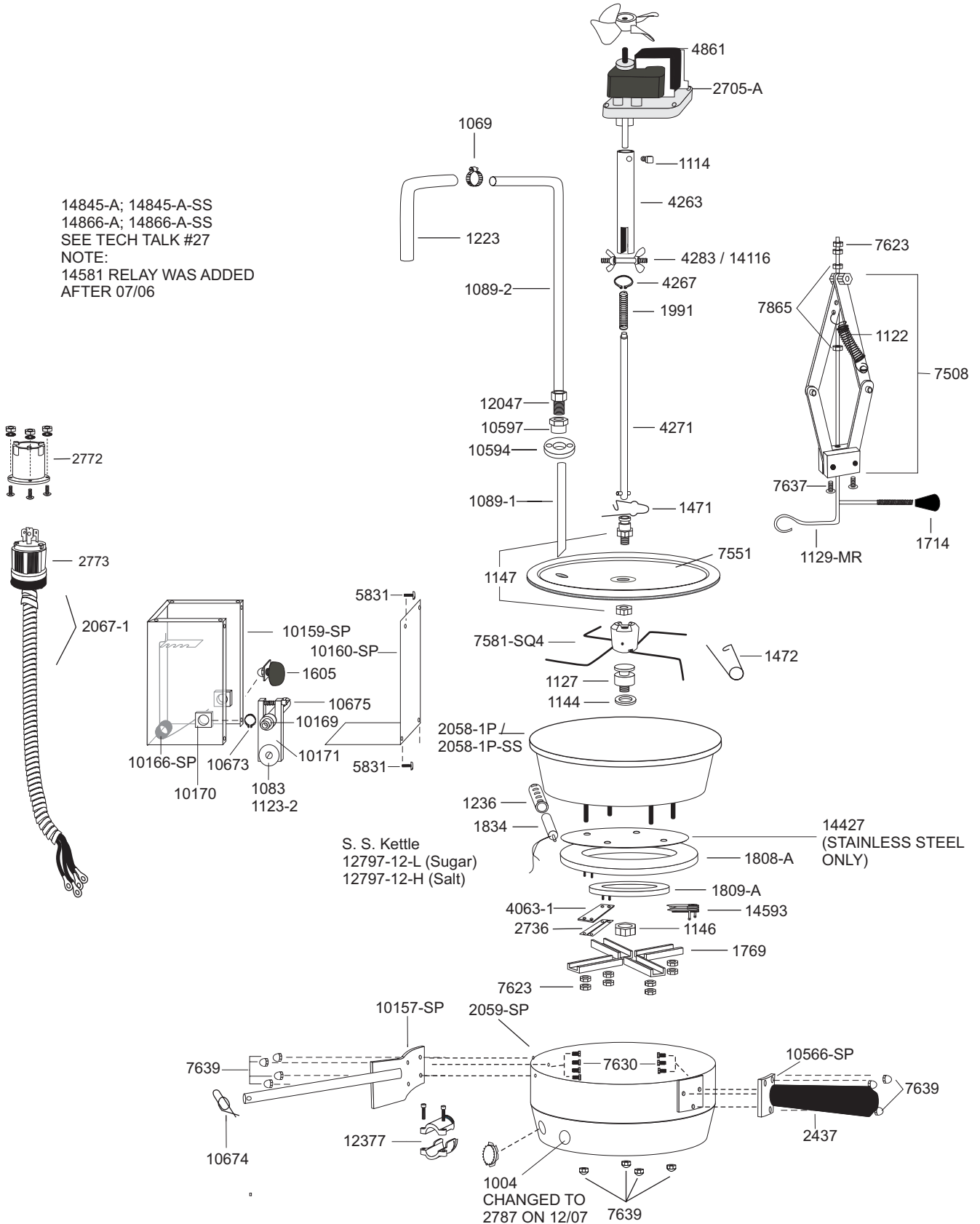

MERCHANT KETTLE - 120V/ 60HZ
BEGINNING SERIAL NO. 08010000

DOC: MR200010

MR16-A-2.0-C
01/2008

1004	THERMOSTAT HOLE COVER	7551	KETTLE COVER - NSF
1083	SPRING ROLLER	7581-SQ4	STIRRER BLADE
1089-1	DISCHARGE TUBE BOTTOM	7623	10-32 HEX NUT
1089-2	DISCHARGE TUBE TOP	7630	1/4-20 x 1/2 HEX BOLT
1069	HOSE CLAMP	7637	8-32 x 1/2 S.S. TRUSS HEAD
1122	TRIP ARM SPRING	7639	1/4-20 CAP NUT
1123-2	PIVOT STUD WASHER T-3000	7672	1/4-20 x 3/4 O.H. SCREW
1127	NSF PAN CENTER	7865	10-32 ELASTIC STOP NUT
1129-MR	COVER LIFT ROD	10157-SP	KETTLE BRACKET ASSEMBLY
1131	NSF STIRRER SHAFT	10159-SP	SUPPORT COLUMN
1114	HEX CONNECTOR SET SCREW	10160-SP	SUPPORT COLUMN COVER
1144	PAN CENTER WASHER	10166-SP	KETTLE DUMP SPRING
1146	PAN CENTER NUT	10169	DUMP SHAFT
1147	NSF COVER CENTER & NUT	10170	BEARING DUMP SHAFT
1223	PLASTIC HOSE-SOLD PER FOOT	10171	LEVELING ARM
1236	THERMOSTAT HOLDING CLIP	10566-SP	DUMP HANDLE ASSEMBLY
1471	COVER RETAINING SPRING	10594	OIL TUBE NUT W/ SCREW
1472	STIRRER BLADE RETAINING SPRING	10597	OIL TUBE SPACER
1605	RUBBER FOOT W/ HARDWARE	10673	RETAINING RING
1714	KNOB	10674	KETTLE SHAFT CLIP
1769	ELEMENT CLAMP	10675	¼ X 20X1 SOCKET HEAD CAP SCREW
1808-A	1250 WATT, 120 VOLT ELEMENT	12047	BULK HEAD UNION
1809-A	750 WATT, 120 VOLT ELEMENT	12377	CONNECTOR 3/8 BX NON ROTATIN
1834	THERMOSTAT	12797-12-L	THERMOSTAT (SUGAR)
1991	SPRING	12797-12-H	THERMOSTAT (SALT)
2058-1P	POPPER PAN-1 PIECE	14116	KETTLE SHAFT PIN
2058-1P-SS	STAINLESS PAN-1 PIECE	14427	DIFFUSER PLATE
2059-SP	RETAINER MERCHANT - SPRING DUMP	14581	RELAY-120V SINGLE POLE
2067-1	KETTLE WIRE SET	14593	HIGH LIMIT
2437	DUMP LEVER KNOB	14845-A	KETTLE ASSY-MERCH-120 (RELAY)
2705-A	AGITATOR MOTOR-120 VOLT	14866-A	KETTLE ASSY-MR (RELAY)-ONE POP
2736	NICKEL STRAPS - SET OF TWO		
2772	RECEPTACLE 20A		
2773	PLUG		
4063-1	MICA TERMINAL PLATE		
4263	MOTOR SHAFT CONNECTOR		
4283	SHAFT CONNECTOR BOLT / WING NUTS		
4267	RETAINING RING		
4271	STIRRER SHAFT		
4861	FAN BLADE		
5831	8-32 X ¼ SS TRUSS HEAD W / NYL		
7508	AUTOMATIC COVER LIFT.		

C. CRETORS AND COMPANY
176 MITTEL DRIVE
WOOD DALE, IL 60191
PHONE: (847)616-6900, (800)228-1885, FAX: (847)616-6970
WEB SITE: <http://www.cretors.com>

MERCHANT S.S. CABINET 100/120V
 BEGINNING SERIAL 010910959
 TOP VIEW

DOC: MR300011

MR16-A-3.0-C
 03/08

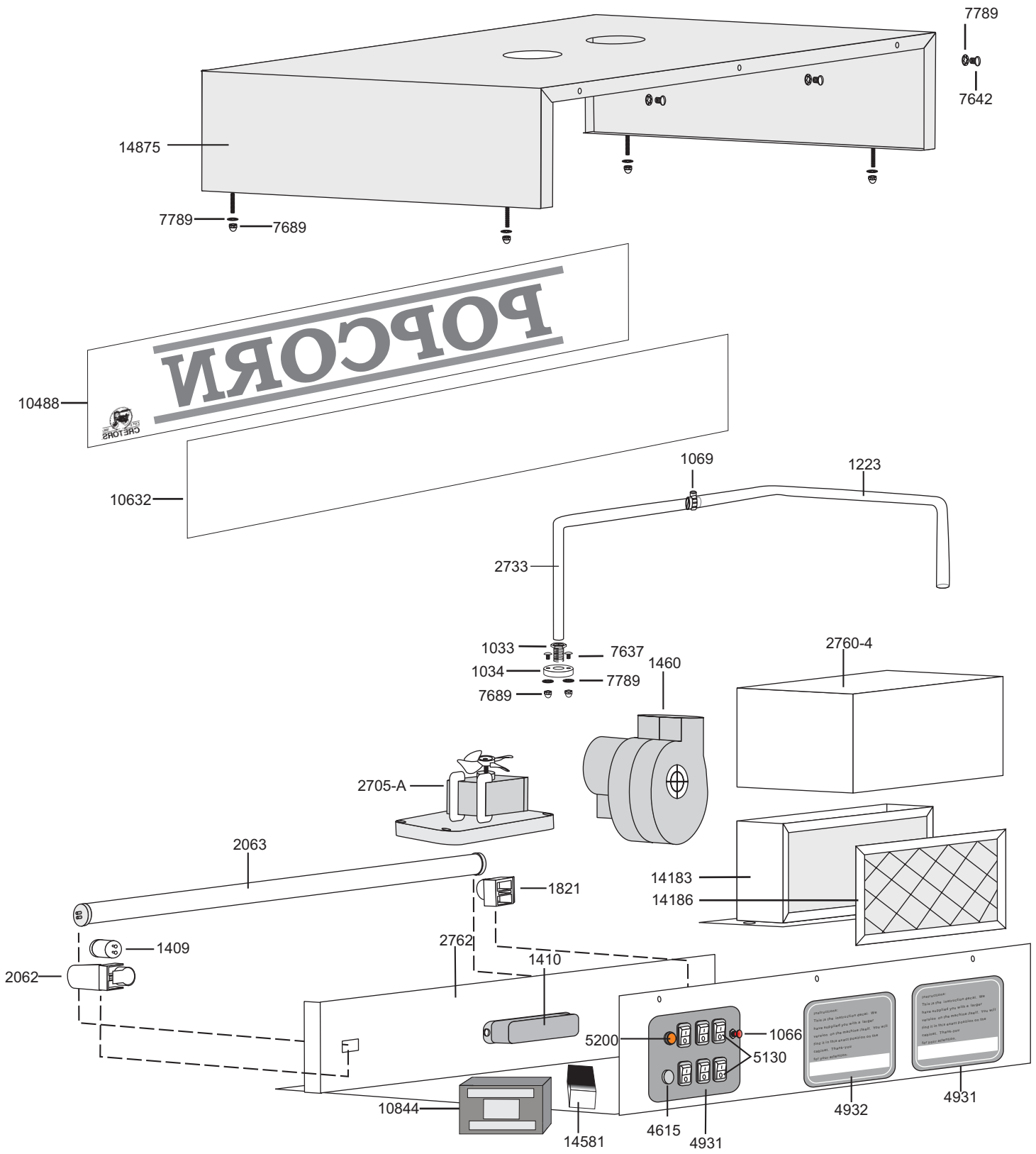

C. CRETORS AND COMPANY
 176 MITTEL DRIVE
 WOOD DALE, IL 60191
 PHONE: (847)616-6900, (800)228-1885, FAX: (847)616-6970
 WEB SITE: <http://www.cretors.com>

MERCHANT S.S. CABINET 100/120V

BEGINNING SERIAL 010910959

TOP VIEW

DOC: MR300011

MR16-A-3.0-C

03/08

1033 SPLIT BUSHING
1034 DISCHARGE TUBE SUPPORT COLLAR
1066 PUSH BUTTON SWITCH
1069 CLAMP - HOSE
1223 TUBING - NALGENE - SOLD PER FOOT
1409 FLOURESCENT STARTER (FS-2)
1410 BALLAST
1460 EXHAUST BLOWER
1821 FLOURESCENT SOCKET
2062 COMBINATION LAMPHOLDER
2063 FLOURESCENT LAMP-F20T12CW
2705-A MOTOR - 120V
2733 DISCHARGE TUBE - MERCHANT
2760-4 FILTER BOX
2762 FLOURESCENT LIGHT PANEL
4615 HOLE COVER 3/8"
4931 SWITCH PLATE DECAL
4932 INSTRUCTION DECAL
5130 SWITCH -LIGHTED
5200 INDICATOR LIGHT
7637 8-32 x 1/2 SS TRUSS HEAD
7642 8-32 x 3/8 SS TRUSS HEAD
7689 8-32 CAP NUT
7789 #8 STAR LOCKWASHER
7803-R 6-32 x 3/8 PHL PAN-RED
10488 SIGN - POPCORN RED & YELLOW
10632 SIGN BACKING
10844 TRANSFORMER
14183 FILTER HOUSING FOR 6 X 12 FILTERS
14186 FILTER-REPLACEABLE-6"x12"
14581 RELAY-120V-SINGLE POLE
14875 STAINLESS STEEL TOP

C. CRETORS AND COMPANY

176 MITTEL DRIVE

WOOD DALE, IL 60191

PHONE: (847)616-6900, (800)228-1885, FAX: (847)616-6970

WEB SITE: <http://www.cretors.com>