

ASSEMBLY HARDWARE

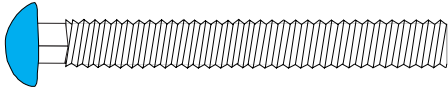

12341-PLATED
 1/4-20 x 2 BLUE CARRIAGE BOLT (4)

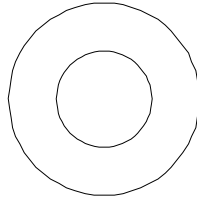

7781
 1/2" FLAT WASHER (6)

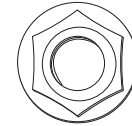

12343
 1/4-20 SPECIAL NUT (21)

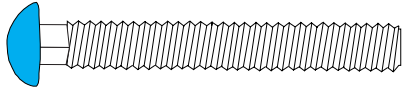

12340-PLATED
 1/4-20 x 1-3/4 BLUE CARRIAGE BOLT (8)

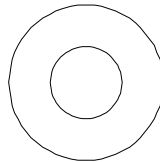

7622
 3/8" FLAT WASHER (8)

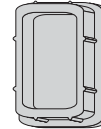

12350
 PLUG (2)



12340-PLATED
 1/4-20 x 3/4 BLUE CARRIAGE BOLT (9)

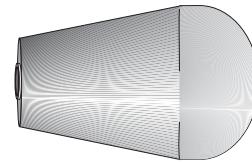

1100
 KNOB (2)

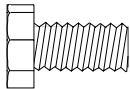

7630
 1/4-20 x 1/2 HEX BOLT (2)

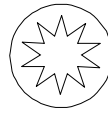

7621
 1/4" LOCKWASHER (2)

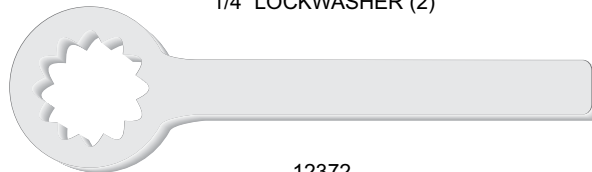

12372
 7/16 BOX WRENCH S.S. (1)

PARTS DESCRIPTION

10081-KD1	WAGON SIDE - PLATED
10081-KD2	WAGON FRONT - PLATED
10081-KD3	WAGON BACK - PLATED
10081-KD4	WAGON BOTTOM - PLATED
10083	SHELF RINGMASTER WAGON
2602-HD	ANTIQUÉ WAGON AXLE-CHROME
2600-HD	HANDLE BAR - CHROME
2604-HD	WAGON WHEEL - CHROME/ BLACK
12410	WAGON LEG-CHROME - KNOCK DOWN

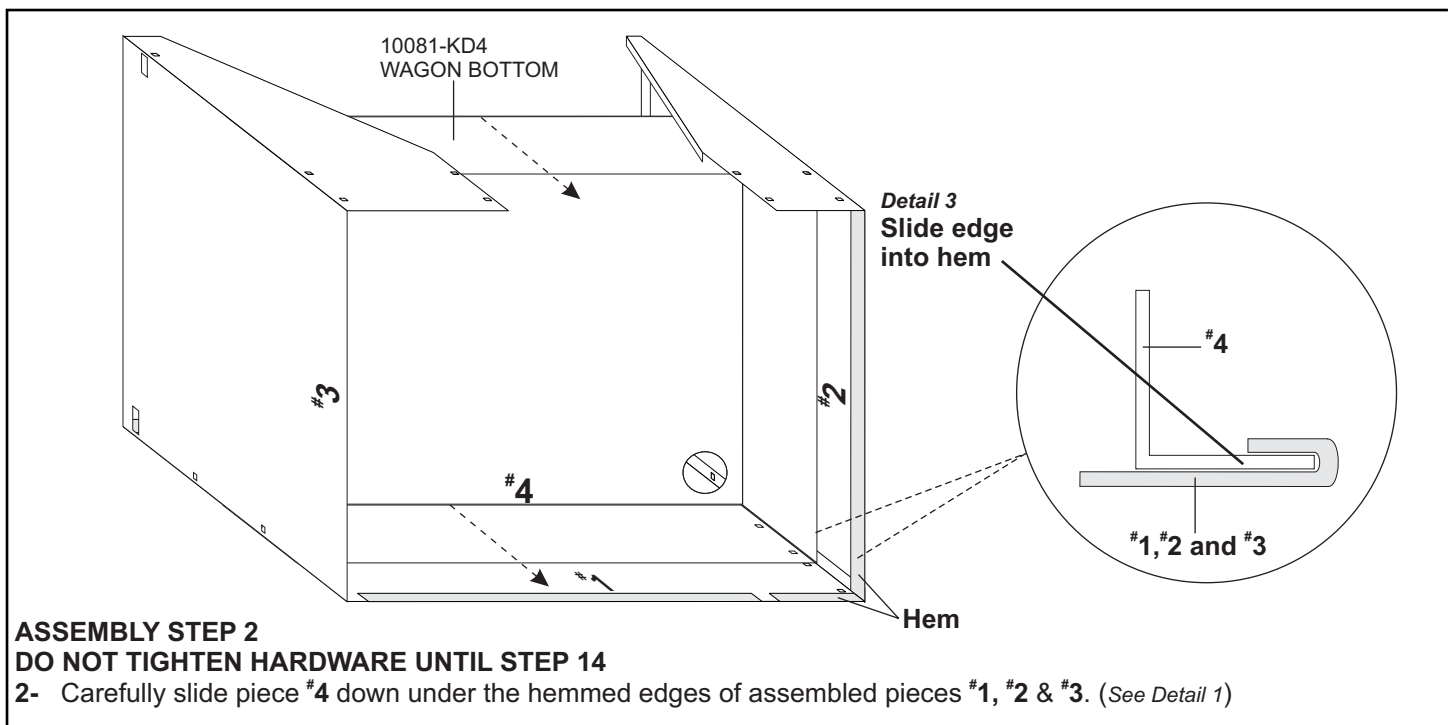
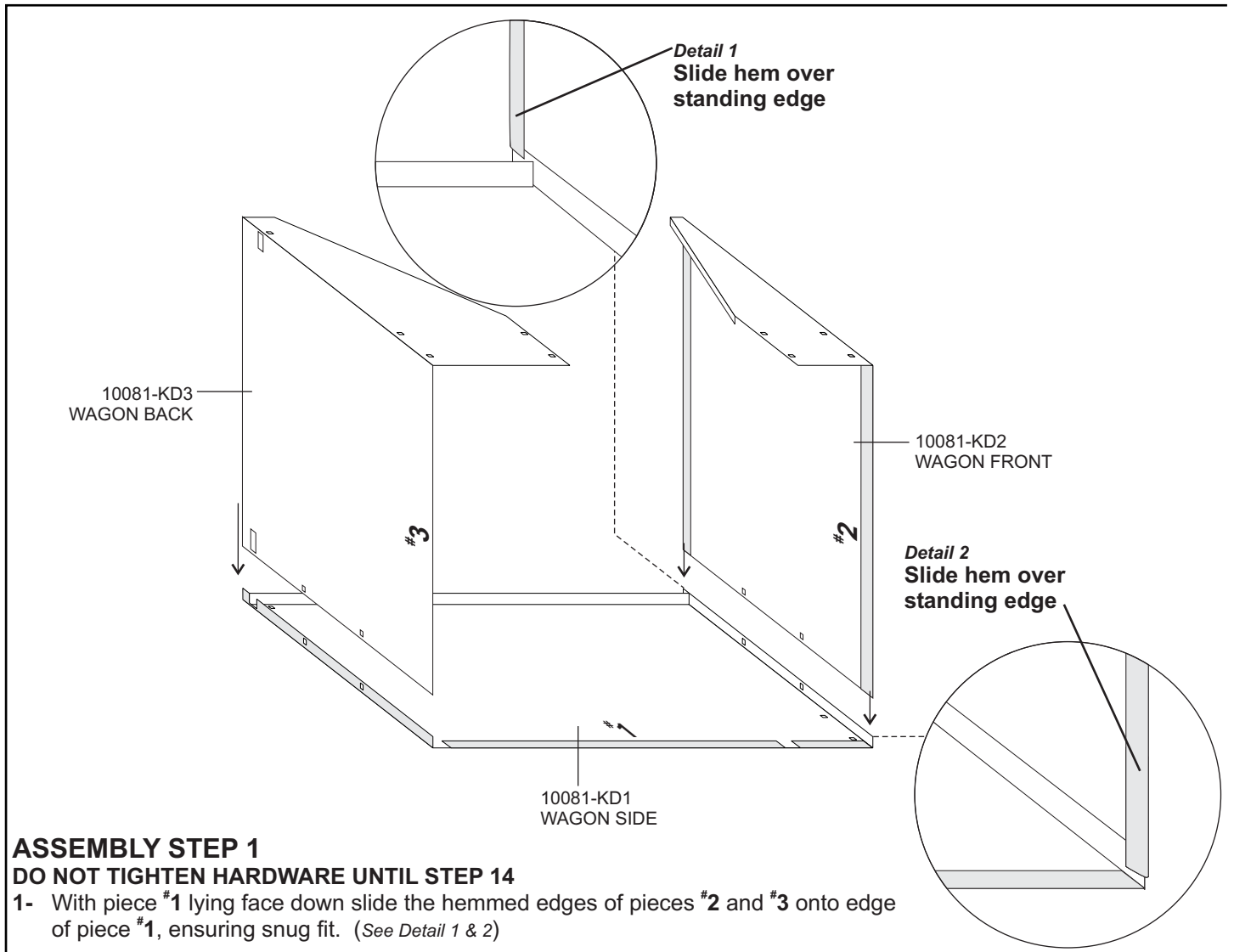

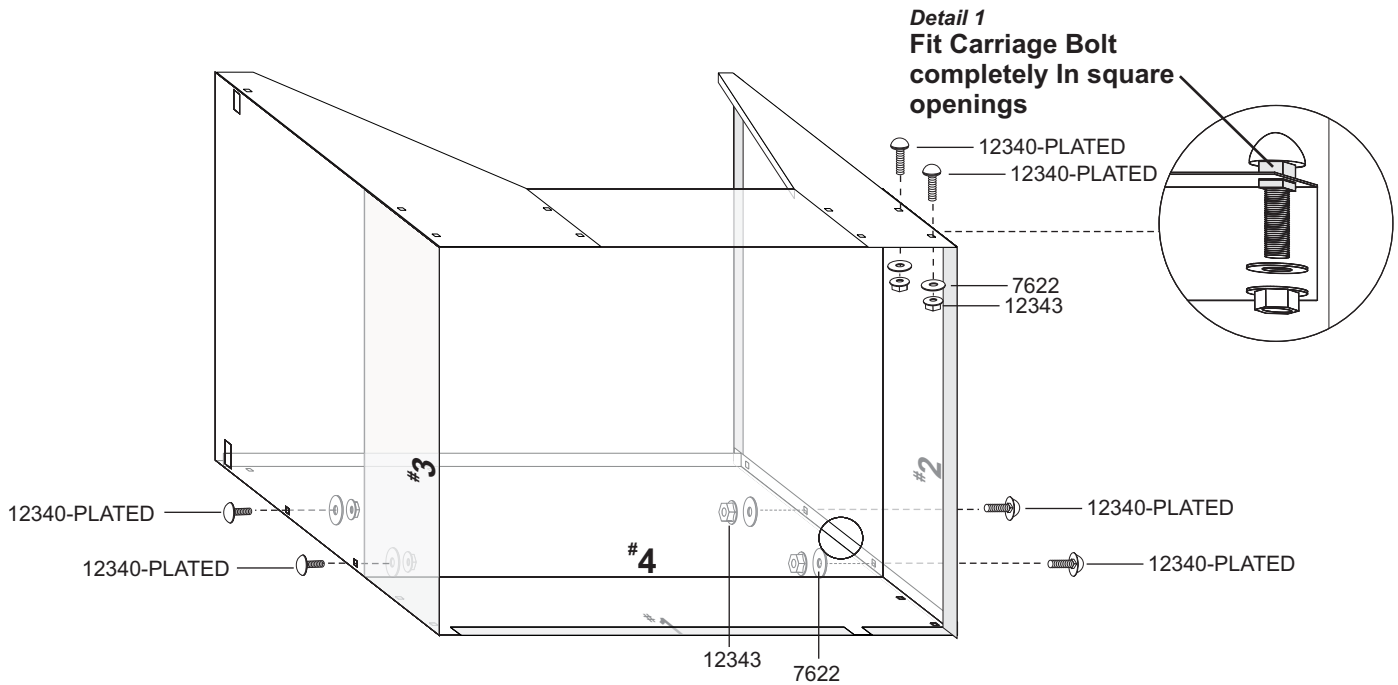

ASSEMBLY STEP 3

DO NOT TIGHTEN HARDWARE UNTIL STEP 14

- 3- Using hardware and wrench shown on page one fasten side pieces #2 & #3 to piece #1 and pieces #2 to #4 aligning all holes and fasten. Making sure Carriage Bolts fit snugly into square holes on base. (See Detail1)
 This completes the Base portion of The Wagon.

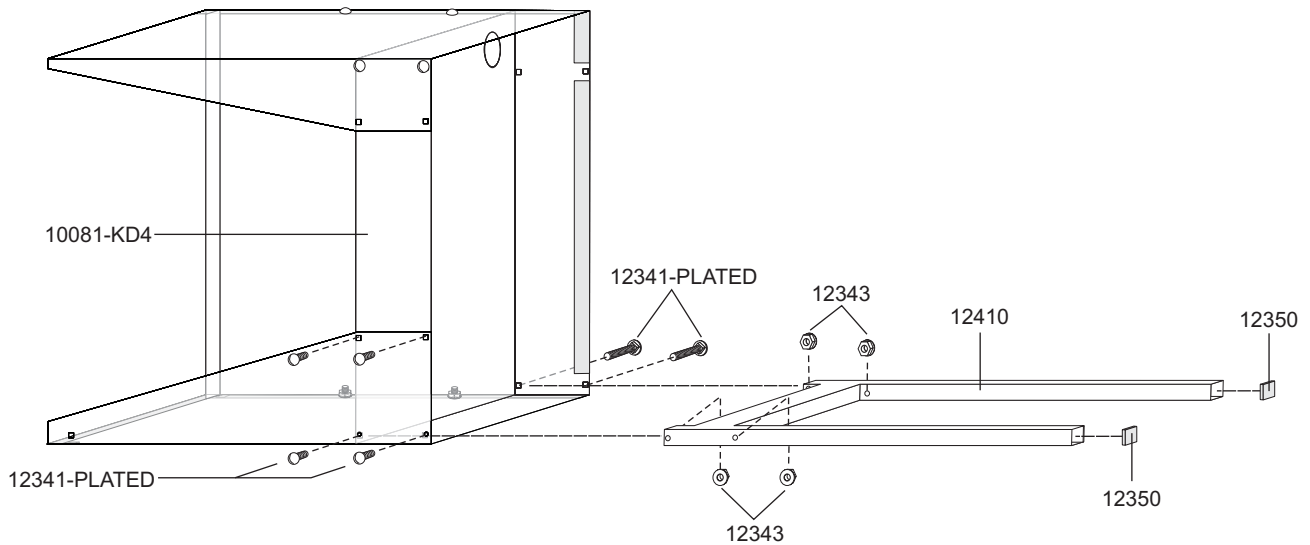

ASSEMBLY STEPS 4 through 6

DO NOT TIGHTEN HARDWARE UNTIL STEP 14

- 4- Turn Wagon Base on to side.
 5- Place Wagon Legs inside bottom of Wagon Base aligning Wagon Legs with hole openings on pieces #1, #3 and #4, fasten legs to Wagon Base using Special Wrench provided or a 7/16 wrench.
 6- Push Plugs into open ends of the Wagon Legs.

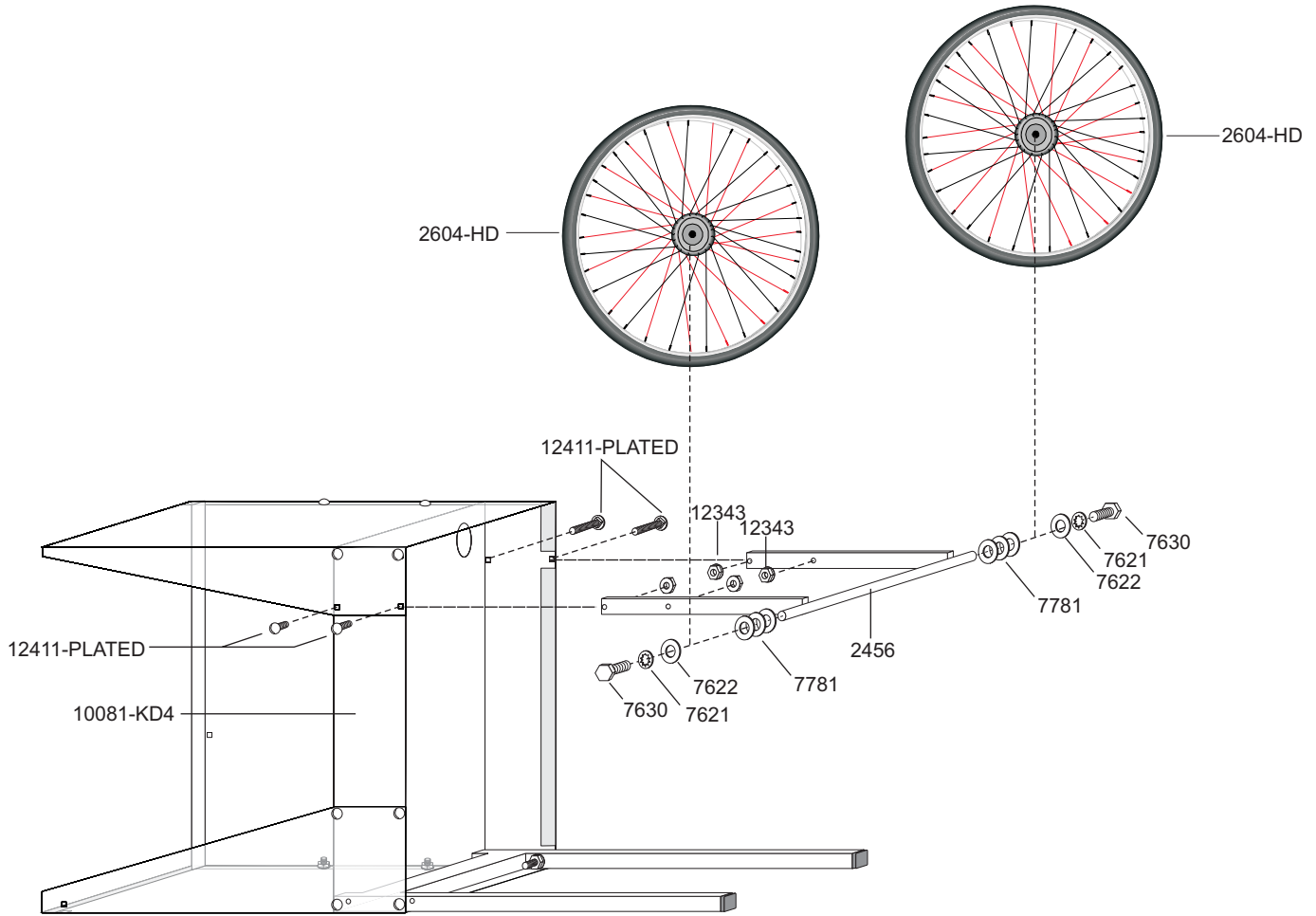

ASSEMBLY STEPS 7 through 9
DO NOT TIGHTEN HARDWARE UNTIL STEP 14

- 7- Place Pre-Assembled Wagon Axle inside bottom of Wagon Base aligning with holes on pieces #1 and #4 and fasten. Making sure Carriage Bolts fit snugly into square holes on base.
- 8- Slide 2 to 3 larger washers (may vary to fit) per side onto Axle of Pre-Assembled Wagon Axle.
- 9- Slide both Wagon Wheels on to Axle, followed with a smaller washer, a starwasher and then hex bolt. If wheel does not turn freely remove one of the larger washers.
Do not over tighten bolts.

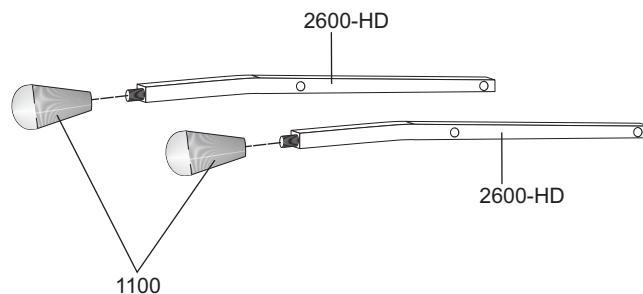

ASSEMBLY STEP 10

- 10- Fasten Knobs on to threaded end of Handle Bar, tighten securely.

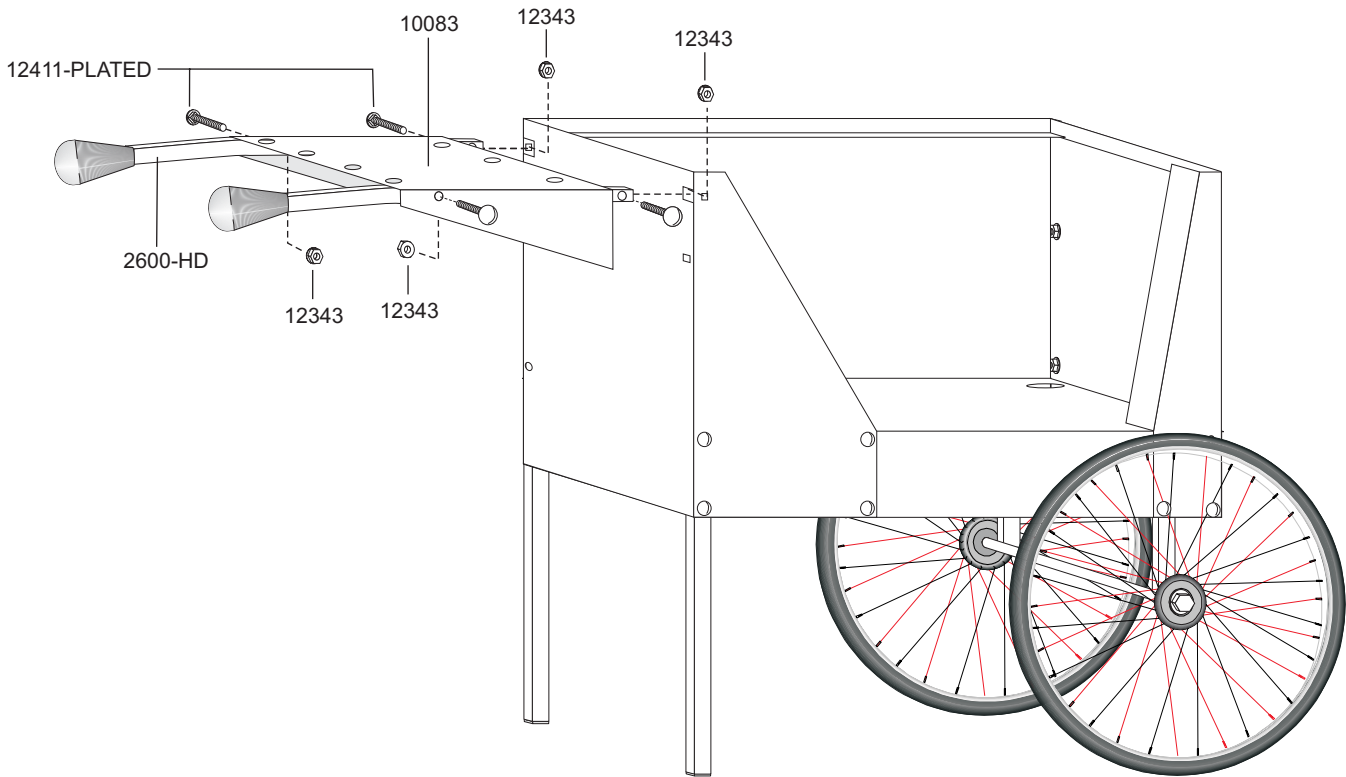

ASSEMBLY STEPS 11 through 14

11- Turn Wagon Base upright.

12- Slide one Wagon Handle into square opening on piece #3 and align with holes found on piece #1 and fasten making sure square head on Bolts fit snugly into square holes on base.

13- Slide remaining Wagon Handle into piece #3, aligning with holes found on piece #5 and edge of piece #3, fastening Wagon Handle and piece #5 at same time. Making sure Carriage Bolts fit snugly into square holes on base

14- COMPLETE BY TIGHTENING ALL HARDWARE AT THIS POINT.



COTTON CANDY WAGON BASE - BLUE

BEGINNING SERIAL NO. 01017167

DOC: CC400002

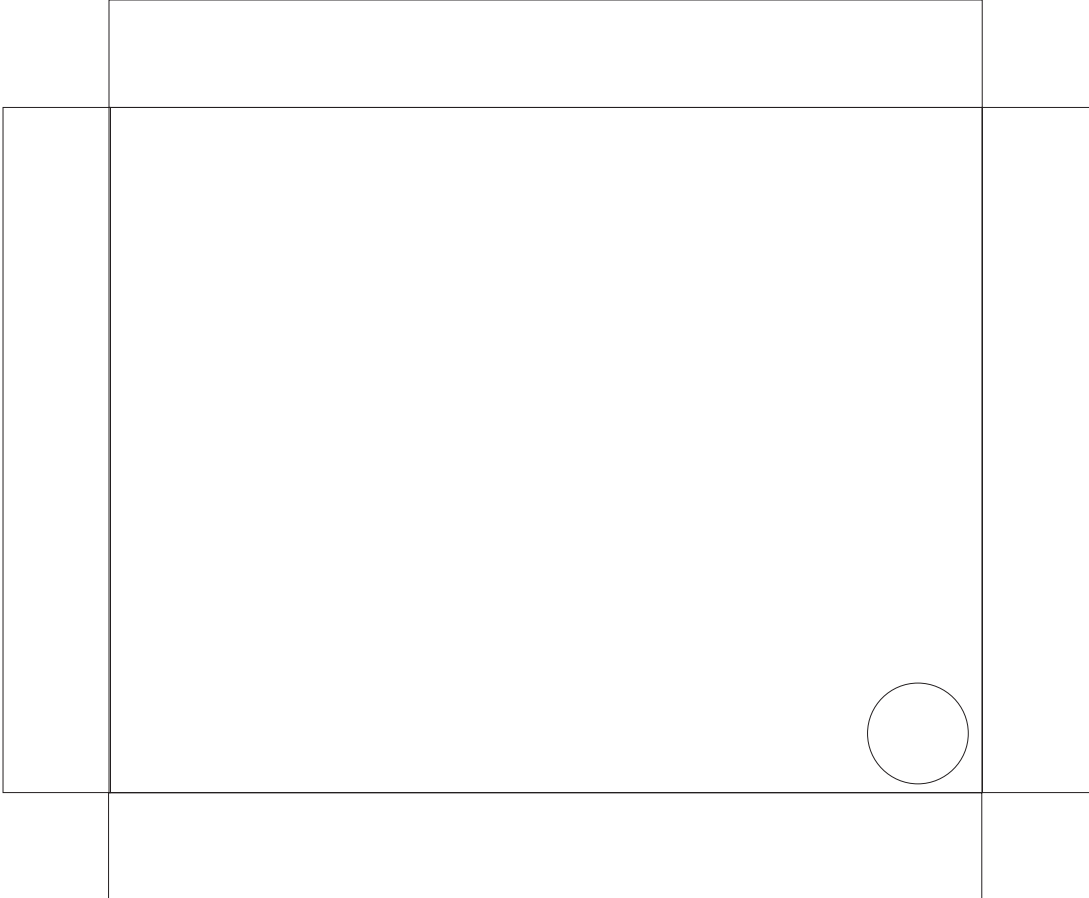

COTTON CANDY WAGON BASE - BLUE
BEGINNING SERIAL NO. 01017167

DOC: CC400002

COTTON CANDY WAGON BASE - BLUE
BEGINNING SERIAL NO. 01017167

DOC: CC400002