



We invented the popcorn machine  
THEN JUST KEPT GOING!

---

176 MITTEL DRIVE, WOOD DALE, IL 60191

---

## COUNTER SHOWCASE ELEVATOR WARMER

120 Volt,  
Single Phase, 60 Cycle

100 Volt,  
Single Phase, 50/60 Cycle



**READ** and **UNDERSTAND** these operating, servicing, and safety instructions before operating or servicing this machine

---

## SAFETY FIRST



The information in this manual is essential for the safe installation and maintenance of your Cretors warmer. The manual must be read and understood before installing, operating or maintaining this equipment, or equivalent training must be provided.



"The employer shall instruct each employee in the recognition and avoidance of unsafe conditions and the regulations applicable to his work environment to control or eliminate any hazards or other exposure to illness or injury".  
Ref.: 29 CFR 1926.20 (b)(4)(a)(2)



It is understood that safety rules within individual companies vary. If a conflict exists between the safety procedures contained in this manual and the rules of a using company, the more stringent rule should take precedence.

---

## I INTRODUCTION

This manual is filled with time-saving and money-saving information regarding your Cretors warmer. There is nothing, however, more important than the safety aids and warnings that are found throughout this document. The Safety Alert Symbol is used to identify topics of primary safety concern wherever they appear. Furthermore, a separate section has been included which deals exclusively with operation and accident prevention.

If, after reviewing this manual, anything is unclear or technical problems are encountered, contact the dealer from whom you purchased your machine for assistance and if there are any additional questions, feel free to contact our Customer Service Department at the address and/or phone number listed on the back cover of this manual. Always have the model and serial number of your machine available to assist in obtaining the correct information.

---

## II SAFETY ALERT SYMBOL

The symbol shown below is used to call your attention to instructions concerning your personal safety and the safety of others. Watch this symbol. It points out important safety precautions. It means "ATTENTION! Become Alert! Your personal safety is involved!" Read the message that follows and be alert to the risk of personal injury or death.

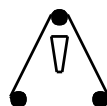

### III PURPOSE OF MANUAL



This instruction manual is intended to familiarize owners with the operation, servicing and safety procedures associated with your Cretors warmer.



This manual should be kept available to operating and maintenance personnel.



A person who has not read and understood all operating and safety instructions is not qualified to operate the machine.

---

## IV PRODUCT IDENTIFICATION

### CRETORS COUNTER SHOWCASE WARMERS

ELECTRICAL SPECIFICATIONS: Counter Showcase Warmers are available in any of the following electrical configurations:

- 100/120 Volt, Single Phase, 60 Cycle

### SPECIFICATIONS:

---

<b>MODEL</b>	<b>COUNTER SHOWCASE ELEVATOR WARMER - 100/120V 50/60HZ</b>
Electrical:	1250 Watts
Dimensions:	24"D x 30"W x 50" H - - - - 61.0 cm D x 76.2 cm W x 127.0 cm H

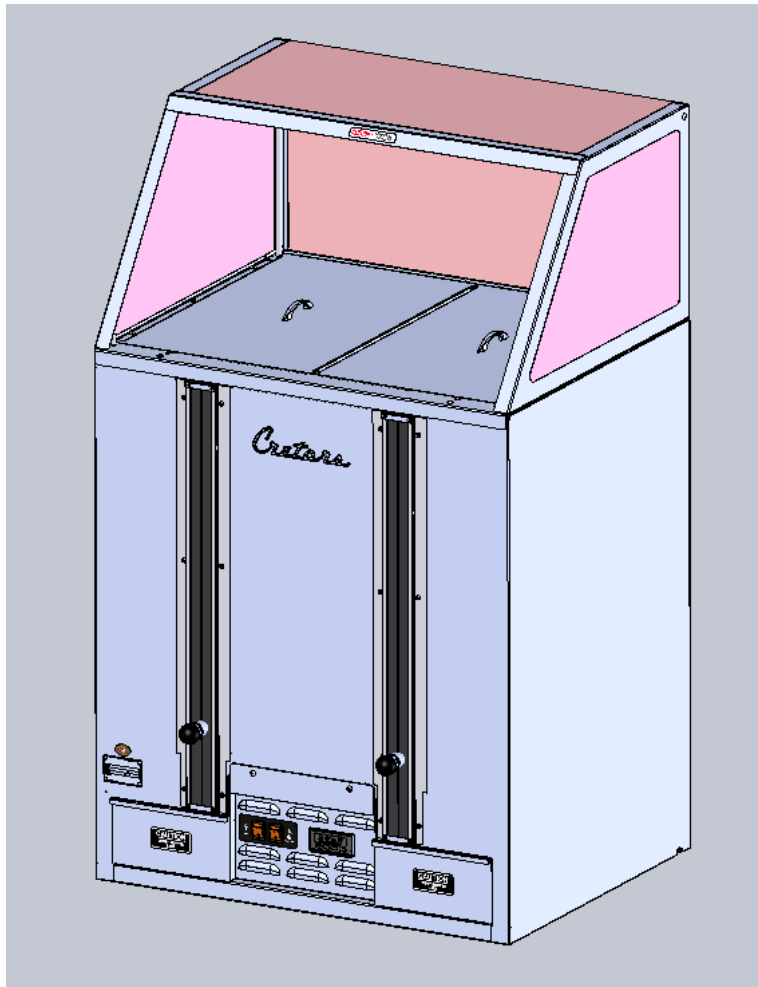

---

## V THEORY AND OBSERVATIONS OF WARMER OPERATION

The Counter Showcase Elevator Warmer is designed to warm and display popped corn. The warmer has two chambers with individual manual elevators allowing for the operator to drop both shelves and fill warmer to maximum capacity. When corn is used from the top, simply pull and lift handle up to raise the elevator to the next level tier (approximately mid-level) for better access to the popcorn. The unit is designed with a heating element and blower to circulate warmed air throughout the cabinet. Top LED lighting illuminates the storage cabinet.

---

## VI CONTROL SWITCHES

ROCKER SWITCH	-Turns lights ON/OFF
ROCKER SWITCH	-Turns Cornditioner ON/OFF
DIGITAL TEMPERATURE CONTROLLER	-Sets temperature of forced air going through the cabinet

---

## VII INSTALLATION INSTRUCTIONS

### 1. Location

Choose a location for your Cretors machine to maximize the ease of operation and maintenance procedures. Check your local building and fire codes for location restrictions. The cabinet needs to be siliconed to the floor or to the counter to conform to NSF/ANSI 4 standard.

### 2. Power Supply

Check the nameplate to determine the required power supply.



Connect your warmer only to the correct power source. Failure to do so may result in personal injury or death and may damage your warmer.



Make certain the Rocker Switches on the warmer are in the 'OFF' position when plugging into power source. Failure to do so may result in personal injury or death and may damage your warmer.

### 3. After Connecting Warmer to Power Supply

The unit's operation can be controlled by the backlit rocker switches located in the bottom lower center position.

---

## VIII OPERATING INSTRUCTIONS



Do not attempt to operate your Cretors warmer until you have read and understood this manual. Failure to do so may result in serious injury or death.



Do not attempt to operate your Cretors warmer unless the installation instructions have been strictly adhered to. Failure to do so may result in serious injury or death.



Operate your warmer only if it is in sanitary condition (SANITATION INSTRUCTIONS). Failure to do so may result in illness to your customers.

1. Turn Rocker Switches "ON" to light cabinet and turn on the Cornditioner heating system.

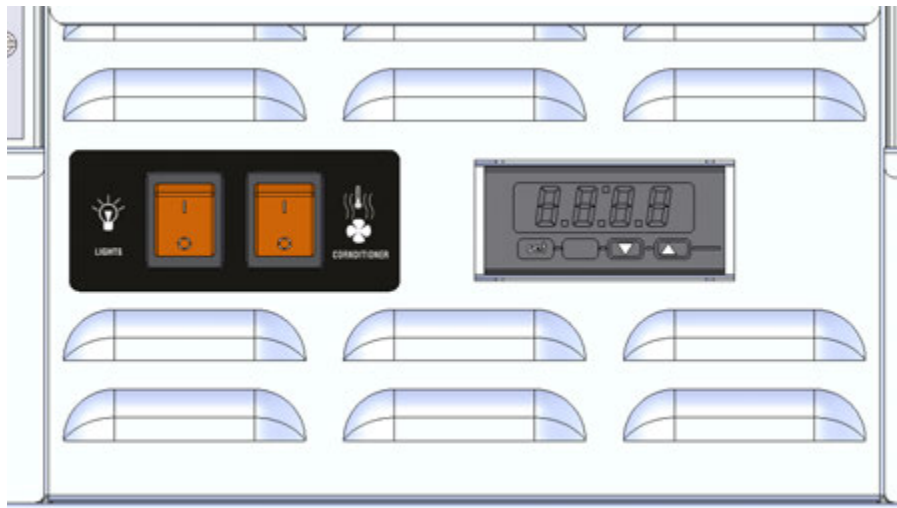

2. Set the temperature control to the desired temperature setpoint by pressing the set button on the controller. Use the up or down arrows to raise and lower the temperature setpoint. Once the desired setpoint is entered, press the set button one more time to save the setting.

---

## IX SERVICE INSTRUCTIONS



In the case of improper operation, qualified personnel only should perform the following diagnostic checks, and, if necessary, corresponding adjustments and repairs. Many of the following procedures present an electrical shock hazard and can cause serious injury or death.

### Parts

When ordering parts, refer to the attached parts diagram. Always supply the serial number, model number, and voltage of your warmer.

---

## X TROUBLE SHOOTING

### Problem - Cabinet Will Not Heat

QUESTION: Do any of the other components work - blower, light, etc?

NO! Check power supply:

- A. Is it plugged in?
- B. Is the receptacle live?
- C. Is machine plugged into the proper voltage? Measure with voltmeter and compare to specification on nameplate of machine.



Do not attempt electrical repairs on the power supply circuit unless you are qualified to do so. The electrical shock associated with line voltages can cause serious injury or death.

YES!

If the temperature controller is on, but the blower is not running and there is no heat, check the high limit by performing the following operation;

- a) Unplug machine.
- b) Remove Heat Box (see Sanitation Instruction section for removal)
- c) Locate High Limit Switch.
  - a. Press the red button in the center of the high limit thermostat to reset.
  - b. Using a multimeter, check the continuity between the two terminals on the high limit, but first remove the wires from the terminals. If the reading is  $0 \Omega$  the high limit is good. If it does not measure  $0 \Omega$  try pressing the red reset button one more time and repeat test. If the reading is still not  $0 \Omega$  replace the high limit.
- d) Using multimeter, check continuity of the heat element. Remove the wire from one terminal. The meter should read  $13 \Omega$  for 120-volt machine. If reading does not match, replace the heat element.

If the blower is running but there is no heating, perform the following operation;

- a) With the heat box removed using a multimeter check the resistance  $\Omega$  reading on the heating element. First remove the wires on the terminals.
- b) Reading should be  $13 \Omega$  for a 120 volt machine. If the reading is  $13 \Omega$  the element is good and the temperature control will need to be checked and replaced. If the reading is not  $13 \Omega$  the heating element will need replacement.



---

## XI SANITATION INSTRUCTIONS



Be certain the machine is turned 'OFF' and power is unplugged before sanitizing this machine. Failure to do so could result in injury or death.



Do not clean heated surfaces until they have been given sufficient time to cool. Failure to do so may result in serious burns.

1. Remove and empty the clean out drawers daily. Heavy or continuous operation of the machine will require more frequent cleaning.



Failure to empty the clean out drawer regularly may result in a fire hazard do to restricted air flow or if debris is allowed to overflow into heating area.

2. With clean out drawers removed, take out the heat box weekly by removing the two screws located in the center of the bottom of the cabinet. Next, remove the heat box by pulling out on the handle located just above the switches and temperature controller. Make sure no chaff or debris has been able to accumulate in the heating chamber. Also make sure that the bottom of the cabinet itself does not have an accumulation of debris. If it does, clean out as required.
3. Perforated warmer bottom (both sides) should be removed daily to clean and remove excess broken corn and debris.
4. The cabinet should be cleaned with any good grade glass or household cleaner suitable for stainless steel surfaces. A cleaning agent that is acceptable for food contact surfaces is recommended. Do this as required.
5. The glass can be cleaned with any good grade glass cleaner suitable for glass surfaces.

---

## SAFETY FIRST

This manual is filled with time-saving and money-saving information regarding your Cretors machine. There is nothing, however, more important than the safety aids and warnings found throughout this document.

If you have any questions, contact your local dealer and if there are any additional questions, feel free to contact the Customer Service Department at C. Cretors and Company.

Additional copies of this manual can be obtained from C. Cretors and Company at the address listed below. Please provide model and serial number when requesting additional copies of this manual. There will be a nominal charge for additional copies.

Cretors guarantees this machine to be free of defects in parts, materials and workmanship for two years. Please take this time to fill out the factory registration card and return it to the factory to activate your warranty. If you have any questions concerning the Cretors' warranty, please contact your local dealer or the Customer Service department at C. Cretors and Company.



**C. CRETORS AND COMPANY**

176 MITTEL DRIVE

WOOD DALE, IL 60191

PHONE (847) 616-6900, (800) 228-1885, FAX (847) 616-6970

WEB SITE: <http://www.cretors.com> Email: [marketing@cretors.com](mailto:marketing@cretors.com)

Cretors joins the information age! Check out our links <http://www.twitter.com>

<http://www.facebook.com/pages/Chicago-IL/C-Cretors-Co/90143449620>

BILL OF MATERIALS			
ITEM #	QTY.	P/N	DESCRIPTION
1	1	20139	FRAME WELDMENT, OUTER WRAP, CSW-ELV
2	2	20153	WHEEL, ROUND, CSW-ELV
3	4	20155	PIN, CLEVIS W/ COTTER PIN, ZINC PLATED
4	2	20154	WHEEL, HEX, CSW-ELV
5	1	20575	INNER WRAP ASSY, CSW-ELV
6	28	7789	#8, INTERNAL TOOTH LOCKWASHER, STEEL NICKEL
7	30	7642	#8-32 X 3/8" LG FULLY THD, PHIL TRUSS HEAD MACHINE SCREW, 18-8 S.S.
8	1	20486	RECEPTACLE ENCLOSURE, CSW-ELV
9	1	5505	#8-32, SERRATED HEX FLANGE NUT, STEEL ZINC
10	1	5713	RECEPTACLE, 15AMP, 5 CONTACT
11	1	2165	BUSHING, HEYCO, #1247, 7/8"
12	1	1254	CORD, 15AMP, 14-3, NEMA 5-15P
13	1	20484	WALL ASSEMBLY, ELEVATOR FRONT, CSW-ELV
14	2	20149	ELEVATOR SLIDE, POPPER CASE, CSW-ELV
15	2	20147	SHAFT, POSITIONING, POPPER CASE, CSW-ELV
16	2	20148	PIN, POSITIONING SHAFT, CSW-ELV
17	2	20611	POPPER CASE ASSEMBLY, CSW-ELV
18	2	20151	DIVIDER, CSW-ELV
19	2	20366-L	BRUSH HOLDER, LEFT, CSW-ELV
20	12	7891	#8-32 X 3/16" LG FULLY THD, SLOT PAN HEAD MACHINE SCREW W/NYLOCK PATCH, 18-8 S.S.
21	2	20366-R	BRUSH HOLDER, RIGHT, CSW-ELV
22	4	20340	CAP, CSW-ELV BRUSH
23	8	7775	#6-32 X 3/16" LG, SLOT BINDER HEAD MACHINE SCREW, STEEL NICKEL
24	4	20502	BRUSH STRIP, CSW-ELV
25	1	20140	FRAME WELDMENT, TOP, CSW-ELV
26	2	20141	GLASS, SIDE, CSW-ELV
27	4	20406	CHANNEL, GLASS, 13.75"
28	2	20407	CHANNEL, GLASS, 12.5"
29	2	20343	CHANNEL, GLASS, 21.75"
30	1	20476	RETAINER, SIDE GLASS, BOTTOM, LEFT
31	1	20439	RETAINER, SIDE GLASS, BOTTOM, RIGHT
32	2	20144	CLIP, SIDE GLASS, CSW-ELV
33	2	20438	BREATHER TUBE, CSW-ELV
34	2	16929	#10-32 X 1" LG FULLY THD, PHIL TRUSS HEAD MACHINE SCREW, 18-8 S.S.
35	1	15705	CHANNEL, FRONT GLASS BOTTOM, CSW-ELV
36	1	20143	GLASS, FRONT, CSW-ELV
37	1	20142	GLASS, TOP, CSW-ELV
38	2	20161	GLASS TAB
39	1	20550	LED STRIP, 26" LG, W/LEADS & POWER SUPPLY
40	1	20490	CONDUIT, CSW-ELV
41	1	2130	ROUTING CLAMP, PIPE, 3/8"
42	1	20602	COVER, LED TERMINALS, CSW-ELV
43	1	7865	#10-32, NM NYLON INSERT LOCKNUT, STEEL ZINC
44	1	20450	CORNDITIONER ASSY, CSW-ELV-A
45	2	20435	COVER, POPPER CASE, CSW-ELV
46	2	20150	DRAWER, CLEAN OUT, CSW-ELV
47	1	6018	DECAL-CAUTION:CONS ALL SURFCS HO
48	2	6012	DECAL, CAUTION, EMPTY DRAWER DAILY
49	1	2446	DECAL-CAUTION 120V/60HZ
50	1	1517	NAMEPLATE, SERIAL NO, BLANK
51	4	16066	#44, 1/8" RIVET, DOME HEAD, 0.188-0.250 GR, SS/SS
52	1	19489	POPCORN SCOOP, PLASTIC

REVISIONS			
REV	DC #	APPROVED BY	APPROVED ON
-	-	-	-
-	-	-	-
A	-	nvidojevic	08/11/2017

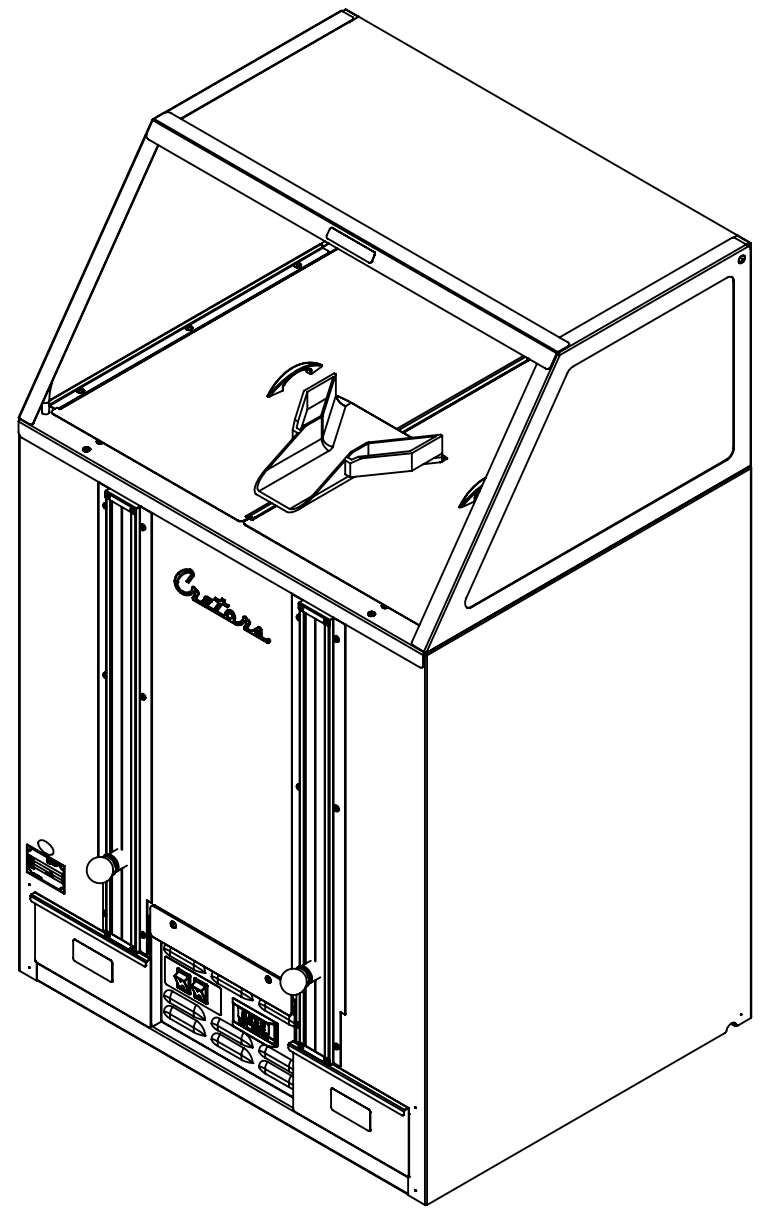
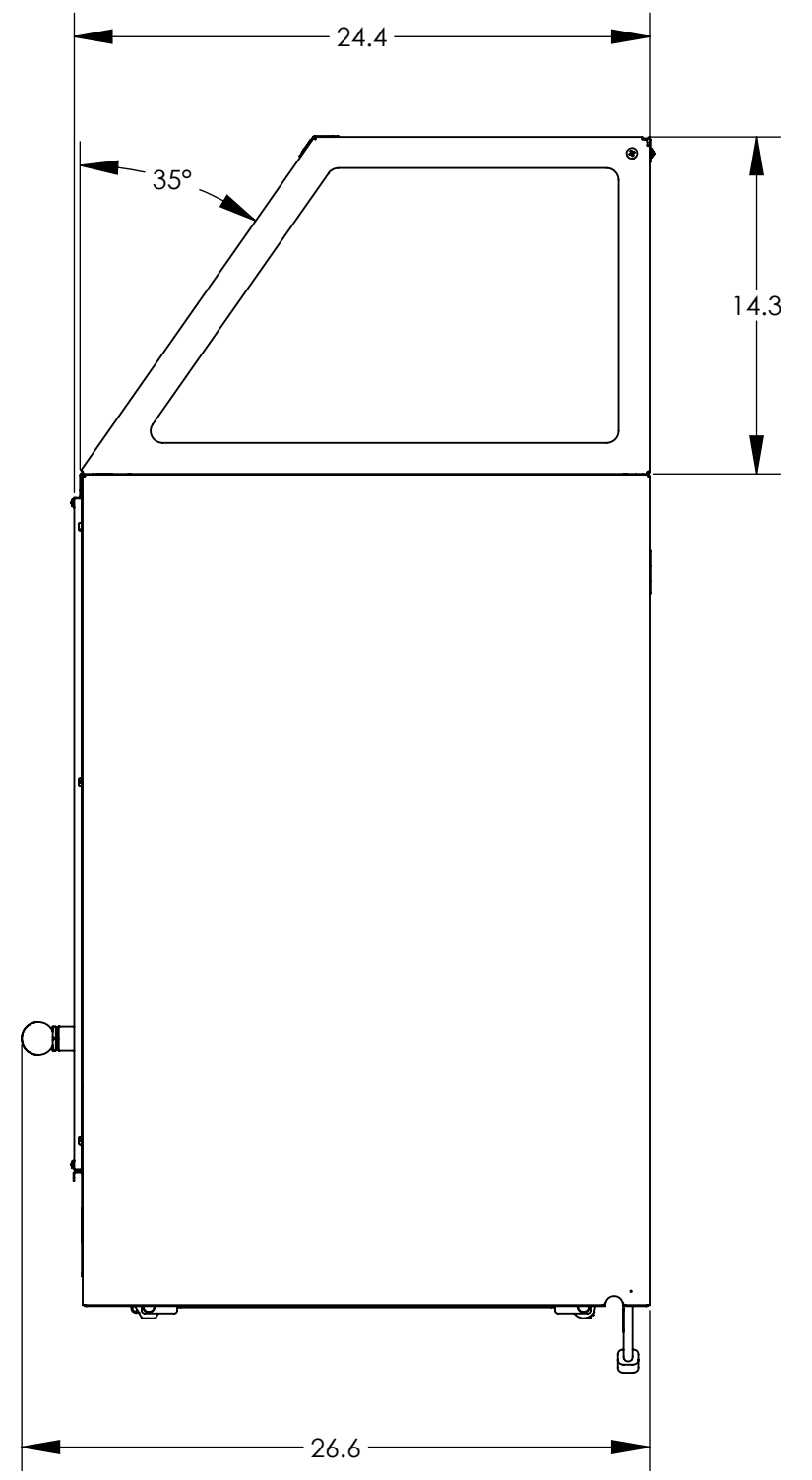
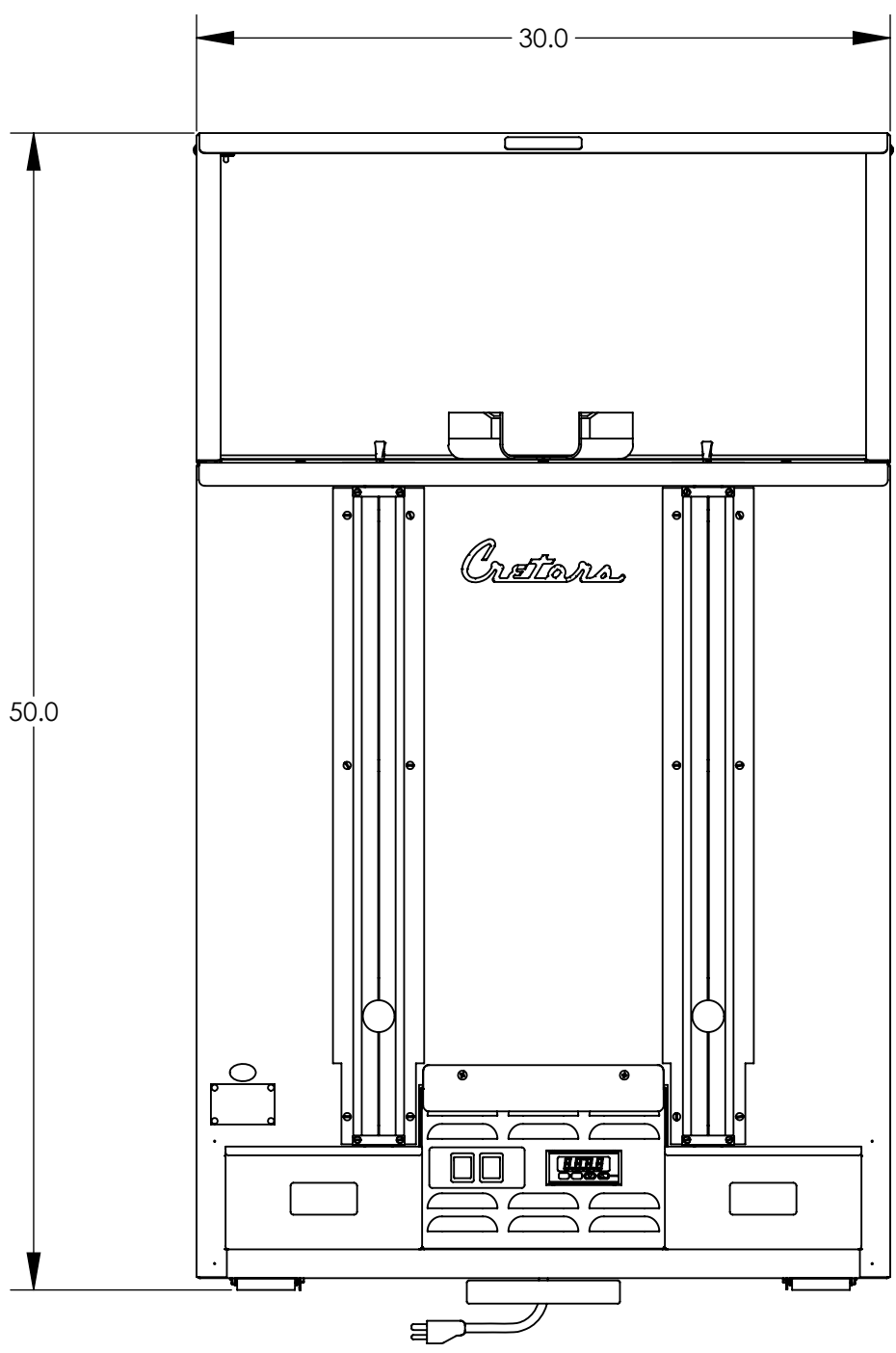
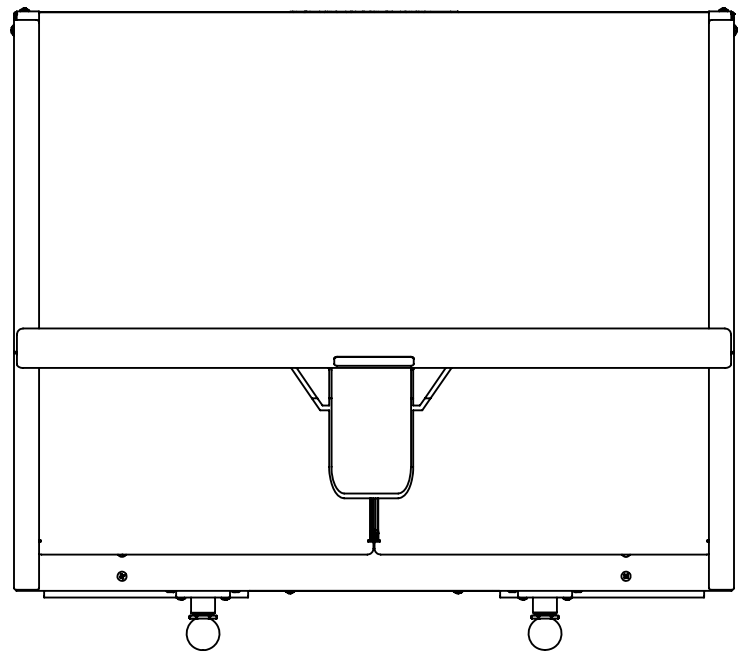

**NOTES:**  
1. XXX.

- STANDARD NOTES:**
1. REMOVE SHARP EDGES AND BURRS.
  2. UNLESS SPECIFIED ALL DIMENSIONS ARE IN INCHES.
  3. REFERENCE DIMENSIONS ARE INDICATED IN PARENTHESIS.
  4. CRITICAL DIMENSIONS THAT NEED INSPECTION ARE INDICATED IN OBOUND BOX.
  5. T.S.C. STAND FOR THEORITICAL SHARP CORNER & INS STAND FOR INSIDE.
  6. FOR SHEET METAL, UNLESS SPECIFIED ALL DIMENSIONS ARE OUTSIDE.
  7. FOR SHEET METAL, FLAT PATTERNS ARE FOR REFERENCE ONLY.

		<b>THIRD ANGLE PROJECTION</b>				176 MITTEL DRIVE, WOOD DALE, IL 60191 www.cretors.com   www.flo-llu.com	
<b>TOLERANCES</b> x.xx = ± 0.02 x.xxx = ± 0.01 ANGLES = ± 1° HOLES = +0.005 / -0 FINISH = 125Ra				<b>DESCRIPTION</b> COUNTER SHOWCASE WARMER, ELEVATOR			
<b>C SIZE DRAWING</b>				<b>MATERIAL</b> REFER INDIVIDUAL SUB-PARTS		<b>APPROX. WEIGHT</b> 189.11 LBS	
<b>DRAWN BY</b> ndarji		<b>DRAWN DATE</b> 08/11/2017		<b>DRAWING NUMBER</b> CSW-ELV-A		<b>REVISION</b> A	
<b>APPROVED BY</b> nvidojevic		<b>APPROVED DATE</b> 08/11/2017		<small>THIS DRAWING CONTAINS INFORMATION PROPRIETARY TO C. CRETORS &amp; CO. AND IS FURNISHED IN CONFIDENCE FOR SOLE PURPOSE OF SUPPLYING THE RECIPIENT WITH NEEDED ENGINEERING DATA. THE CONTENTS SHOULD NOT BE DISCLOSED OR REPRODUCED IN ANY MANNER WITHOUT WRITTEN CONSENT OF C. CRETORS &amp; CO. ALL RIGHTS RESERVED.</small>			
8		7		6		5	

**STEP # 1**

BEFORE INSERTING THE INNER WRAP, COMPLETE THE WIRING BEHIND THE INNER WRAP BY THE POWER CORD LOCATION, AS PER WIRING DIAGRAM AND EXTRACT THE GROUP OF WIRES THROUGH THIS LOCATION. LATER THESE WIRES WILL BE USED FOR WIRING THE LED LIGHT UNDER THE TOP GLASS FRAME.

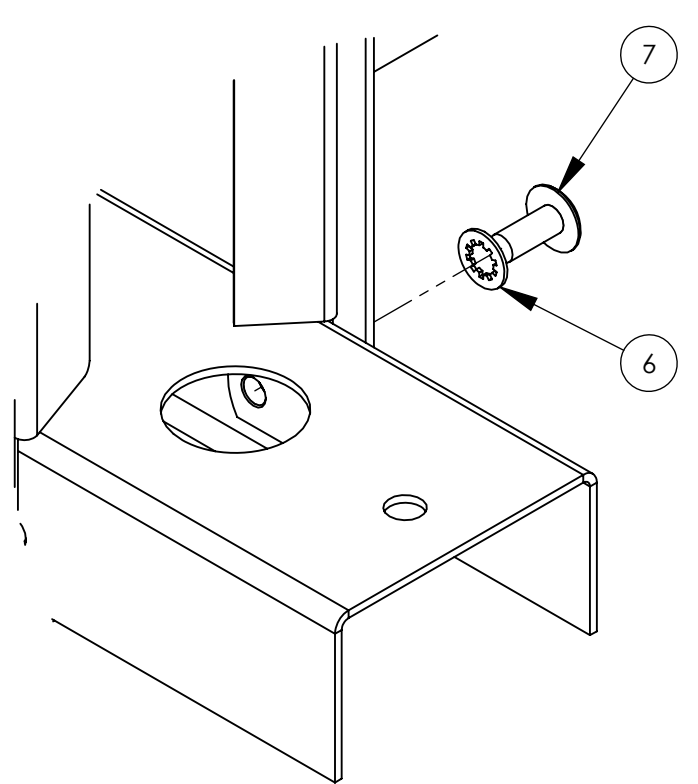
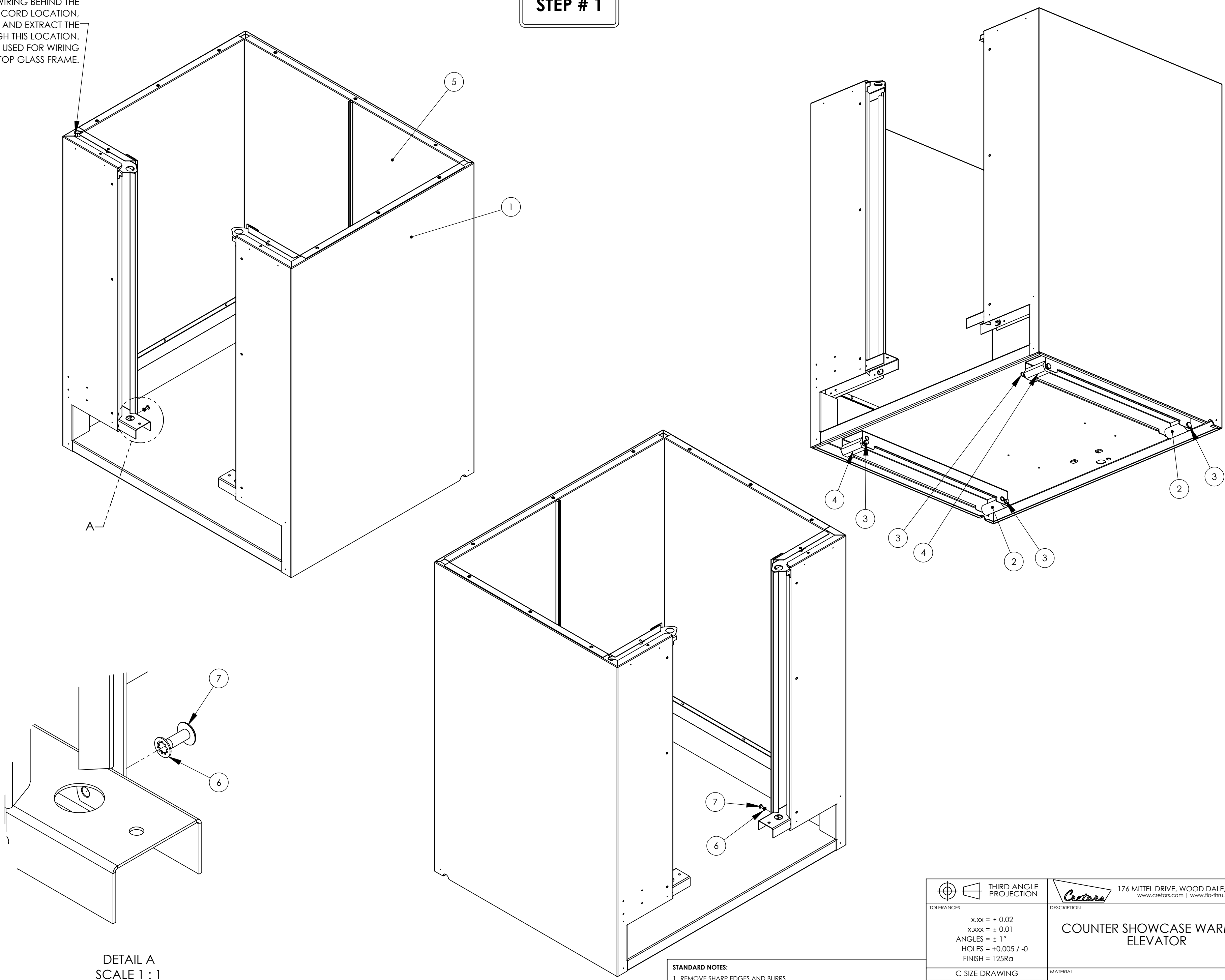

DETAIL A  
SCALE 1:1

- STANDARD NOTES:**
1. REMOVE SHARP EDGES AND BURRS.
  2. UNLESS SPECIFIED ALL DIMENSIONS ARE IN INCHES.
  3. REFERENCE DIMENSIONS ARE INDICATED IN PARENTHESIS.
  4. CRITICAL DIMENSIONS THAT NEED INSPECTION ARE INDICATED IN OBOUND BOX.
  5. T.S.C. STAND FOR THEORITICAL SHARP CORNER & INS STAND FOR INSIDE.
  6. FOR SHEET METAL, UNLESS SPECIFIED ALL DIMENSIONS ARE OUTSIDE.
  7. FOR SHEET METAL, FLAT PATTERNS ARE FOR REFERENCE ONLY.

THIRD ANGLE PROJECTION		176 MITTEL DRIVE, WOOD DALE, IL 60191 www.cretors.com   www.ilo-thru.com	
TOLERANCES x.xx = ± 0.02 x.xxx = ± 0.01 ANGLES = ± 1° HOLES = +0.005 / -0 FINISH = 125Ra		DESCRIPTION <b>COUNTER SHOWCASE WARMER, ELEVATOR</b>	
C SIZE DRAWING		MATERIAL	APPROX. WEIGHT
DRAWN BY: ndarji		REFER INDIVIDUAL SUB-PARTS	189.11 LBS
DRAWN DATE: 08/11/2017		DRAWING NUMBER	REVISION
APPROVED BY: nvidojevic		CSW-ELV-A	A
APPROVED DATE: 08/11/2017		THIS DRAWING CONTAINS INFORMATION PROPRIETARY TO C. CRETORS & CO. AND IS FURNISHED IN CONFIDENCE FOR SOLE PURPOSE OF SUPPLYING THE RECIPIENT WITH NEEDED ENGINEERING DATA. THE CONTENTS SHOULD NOT BE DISCLOSED OR REPRODUCED IN ANY MANNER WITHOUT WRITTEN CONSENT OF C. CRETORS & CO. ALL RIGHTS RESERVED.	

**STEP # 2**

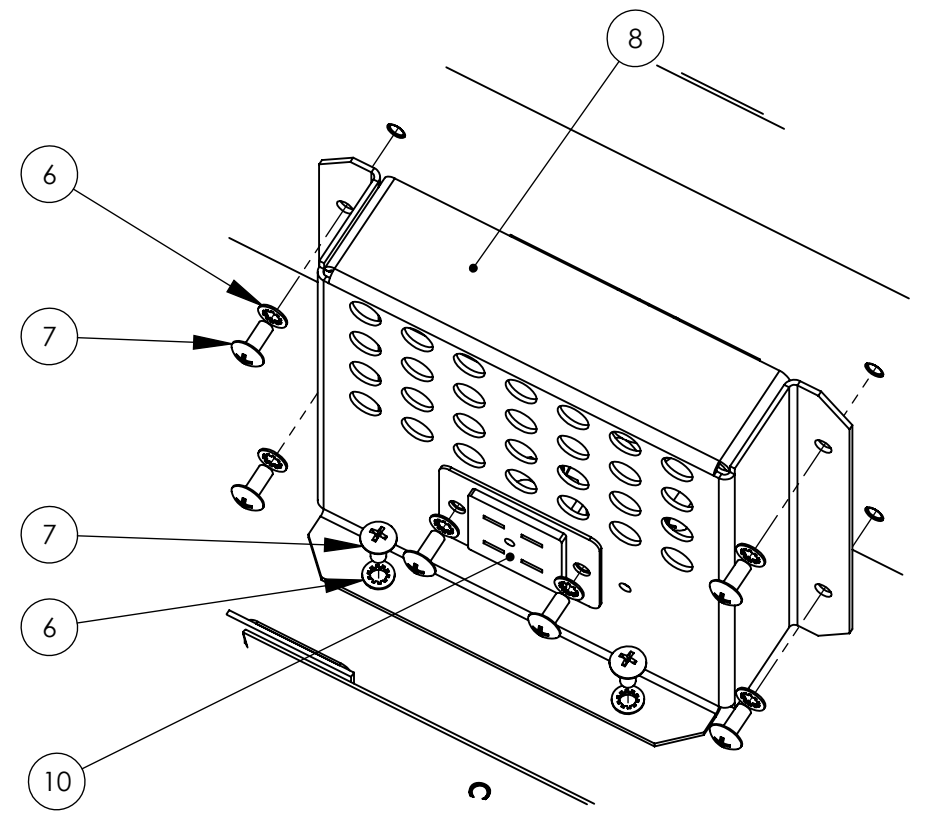
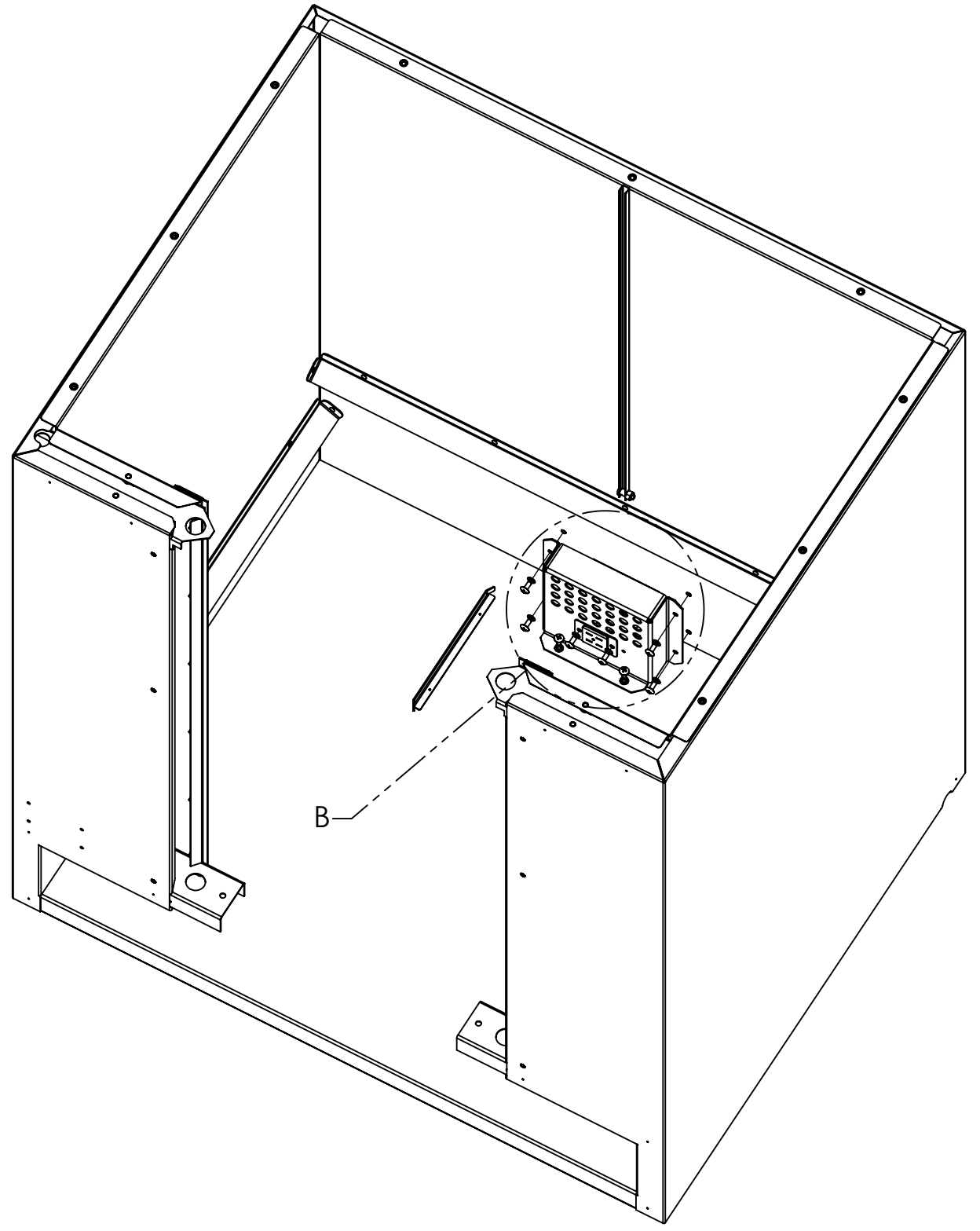

DETAIL B  
SCALE 1 : 2

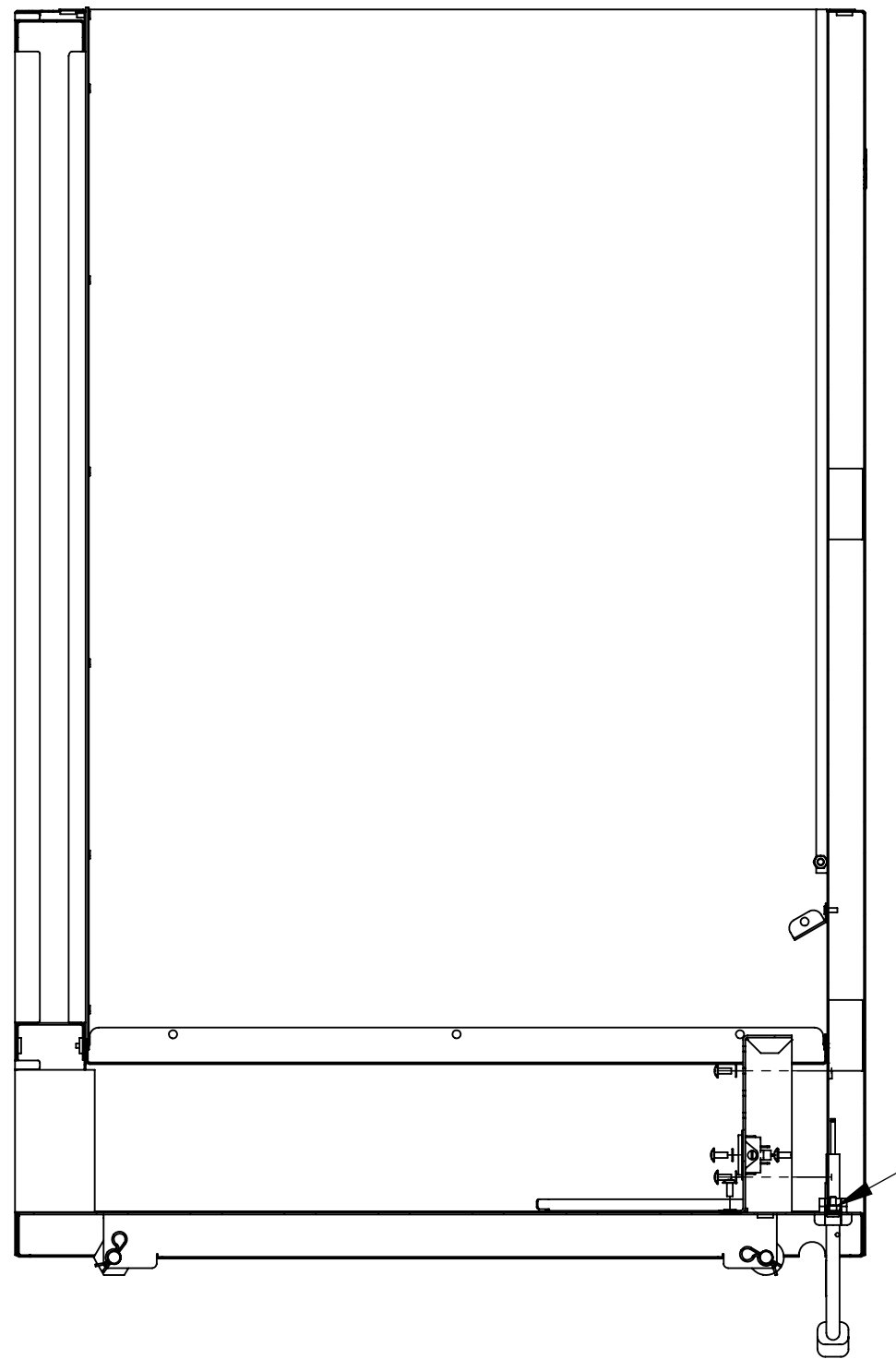
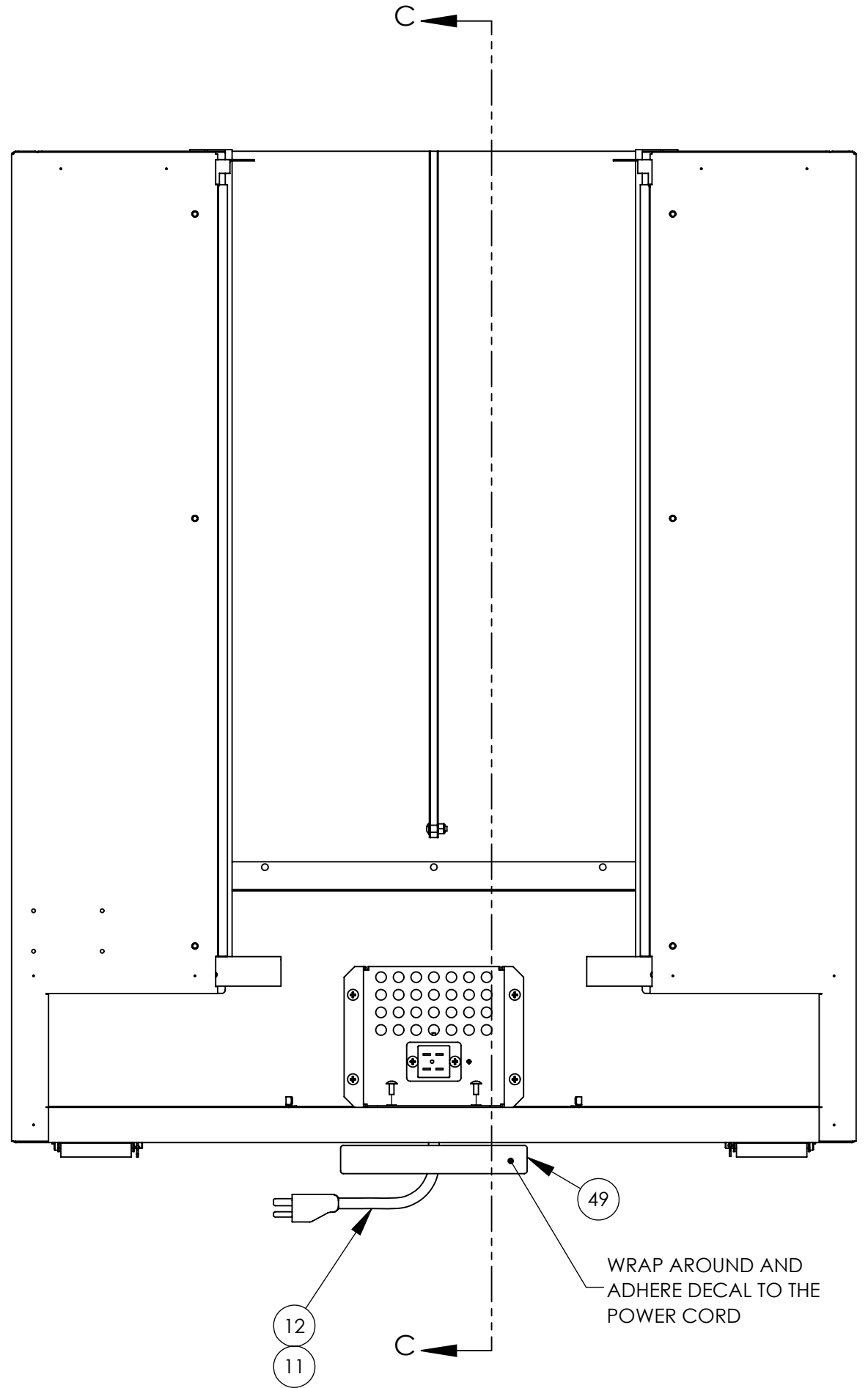

SECTION C-C  
SCALE 1 : 5

9  
USED TO MOUNT  
GROUND CABLE

- STANDARD NOTES:**
1. REMOVE SHARP EDGES AND BURRS.
  2. UNLESS SPECIFIED ALL DIMENSIONS ARE IN INCHES.
  3. REFERENCE DIMENSIONS ARE INDICATED IN PARENTHESIS.
  4. CRITICAL DIMENSIONS THAT NEED INSPECTION ARE INDICATED IN OBOUND BOX.
  5. T.S.C. STAND FOR THEORITICAL SHARP CORNER & INS STAND FOR INSIDE.
  6. FOR SHEET METAL, UNLESS SPECIFIED ALL DIMENSIONS ARE OUTSIDE.
  7. FOR SHEET METAL, FLAT PATTERNS ARE FOR REFERENCE ONLY.

THIRD ANGLE PROJECTION		176 MITTEL DRIVE, WOOD DALE, IL 60191 www.cretors.com   www.flo-thru.com	
TOLERANCES x.xx = ± 0.02 x.xxx = ± 0.01 ANGLES = ± 1° HOLES = +0.005 / -0 FINISH = 125Ra		DESCRIPTION <b>COUNTER SHOWCASE WARMER, ELEVATOR</b>	
C SIZE DRAWING		MATERIAL	
DRAWN BY: ndarji		REFER INDIVIDUAL SUB-PARTS	
DRAWN DATE: 08/11/2017		APPROX. WEIGHT: 189.11 LBS	
APPROVED BY: nvidojevic		DRAWING NUMBER: CSW-ELV-A	
APPROVED DATE: 08/11/2017		REVISION: A	
THIS DRAWING CONTAINS INFORMATION PROPRIETARY TO C. CRETORS & CO. AND IS FURNISHED IN CONFIDENCE FOR SOLE PURPOSE OF SUPPLYING THE RECIPIENT WITH NEEDED ENGINEERING DATA. THE CONTENTS SHOULD NOT BE DISCLOSED OR REPRODUCED IN ANY MANNER WITHOUT WRITTEN CONSENT OF C. CRETORS & CO. ALL RIGHTS RESERVED.			
		SHEET 3 OF 8	

**STEP # 3**

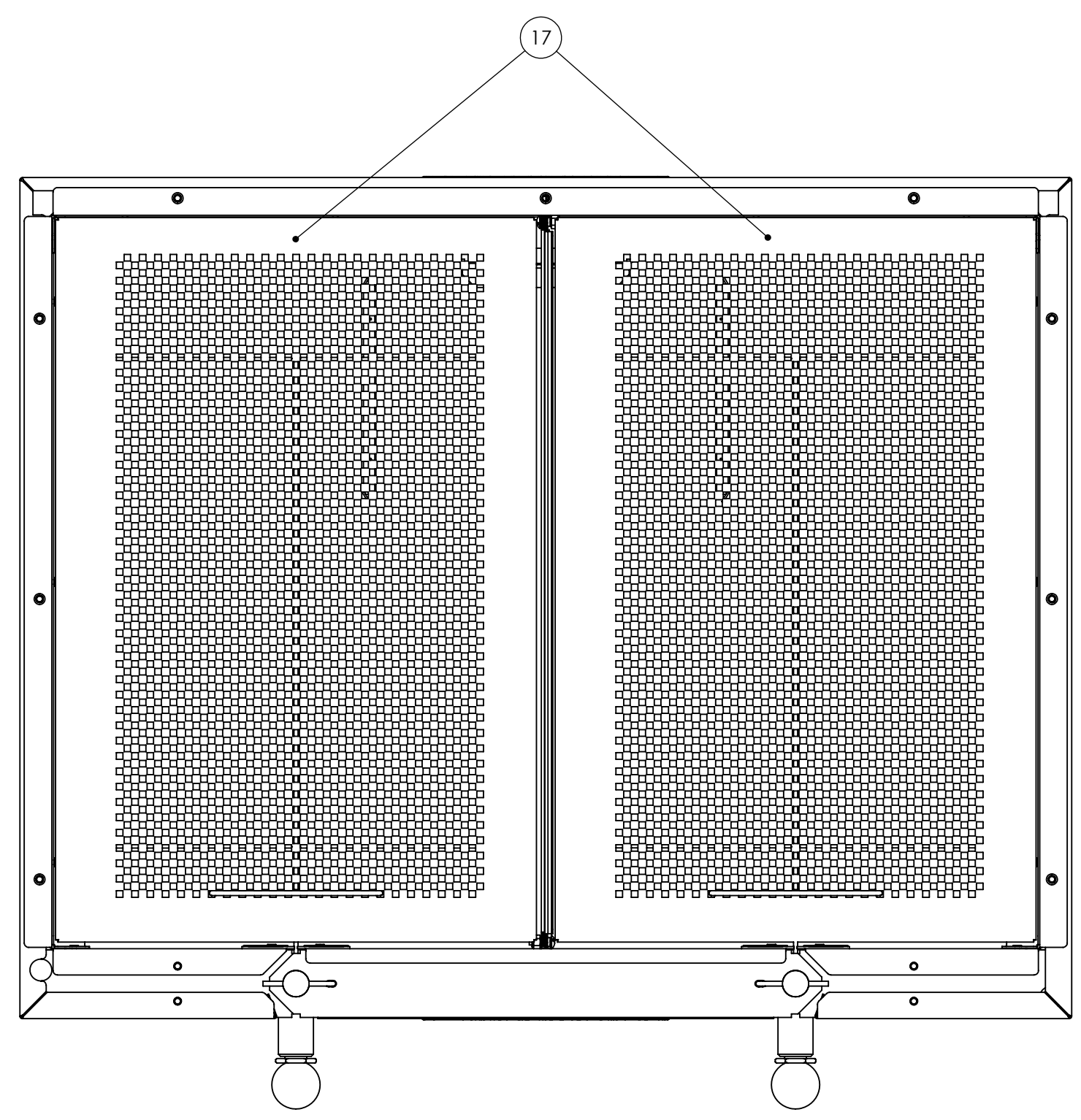
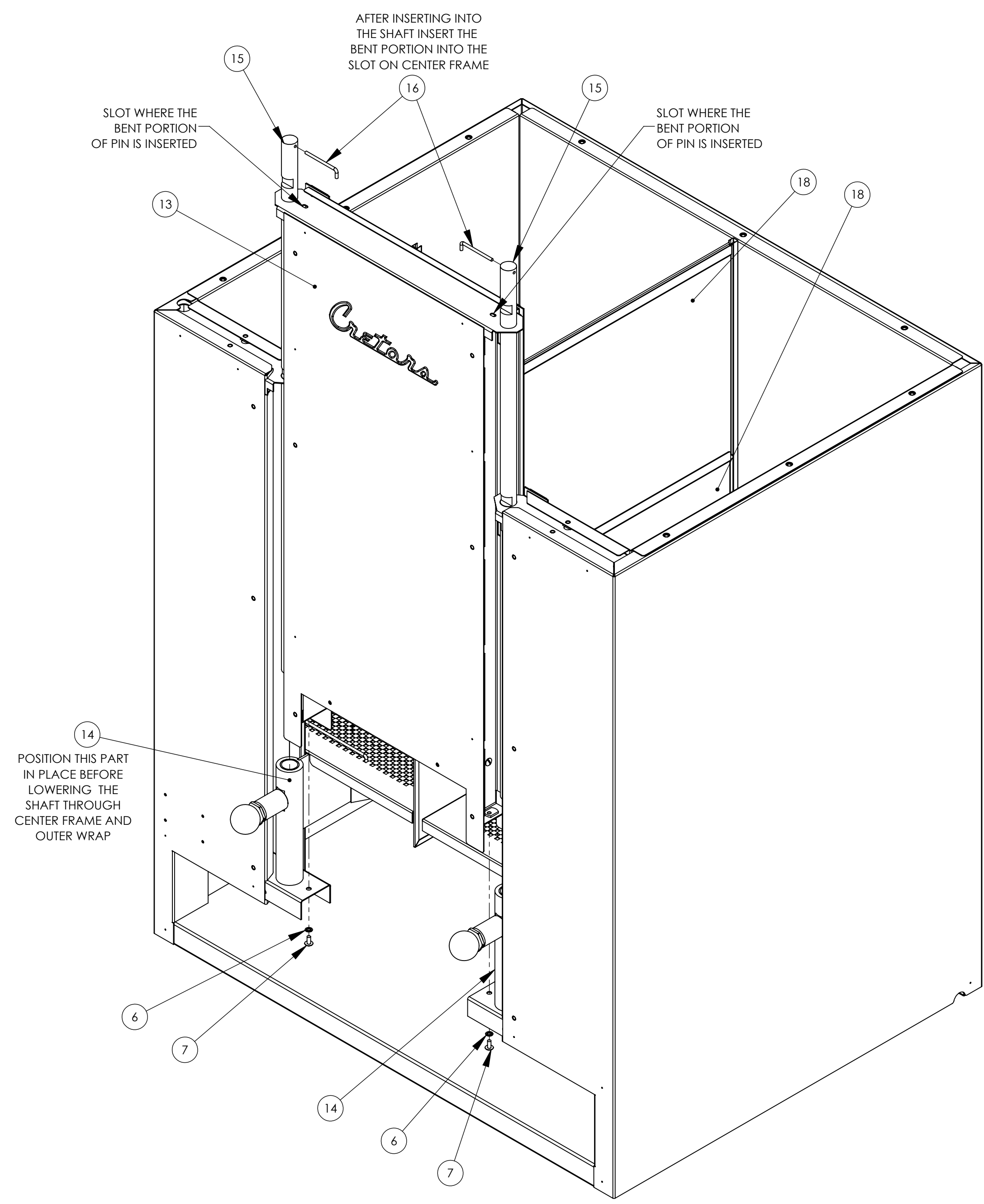

- STANDARD NOTES:**
1. REMOVE SHARP EDGES AND BURRS.
  2. UNLESS SPECIFIED ALL DIMENSIONS ARE IN INCHES.
  3. REFERENCE DIMENSIONS ARE INDICATED IN PARENTHESIS.
  4. CRITICAL DIMENSIONS THAT NEED INSPECTION ARE INDICATED IN OBROUND BOX.
  5. T.S.C. STAND FOR THEORITICAL SHARP CORNER & INS STAND FOR INSIDE.
  6. FOR SHEET METAL, UNLESS SPECIFIED ALL DIMENSIONS ARE OUTSIDE.
  7. FOR SHEET METAL, FLAT PATTERNS ARE FOR REFERENCE ONLY.

THIRD ANGLE PROJECTION		176 MITTEL DRIVE, WOOD DALE, IL 60191 www.cretors.com   www.flo-llu.com	
TOLERANCES x.xx = ± 0.02 x.xxx = ± 0.01 ANGLES = ± 1° HOLES = +0.005 / -0 FINISH = 125Ra		DESCRIPTION <b>COUNTER SHOWCASE WARMER, ELEVATOR</b>	
C SIZE DRAWING		MATERIAL	APPROX. WEIGHT
DRAWN BY: ndarji		REFER INDIVIDUAL SUB-PARTS	189.11 LBS
DRAWN DATE: 08/11/2017		DRAWING NUMBER	REVISION
APPROVED BY: nvidojevic		CSW-ELV-A	A
APPROVED DATE: 08/11/2017		THIS DRAWING CONTAINS INFORMATION PROPRIETARY TO C. CRETORS & CO. AND IS FURNISHED IN CONFIDENCE FOR SOLE PURPOSE OF SUPPLYING THE RECIPIENT WITH NEEDED ENGINEERING DATA. THE CONTENTS SHOULD NOT BE DISCLOSED OR REPRODUCED IN ANY MANNER WITHOUT WRITTEN CONSENT OF C. CRETORS & CO. ALL RIGHTS RESERVED.	
		SHEET 4 OF 8	

**STEP # 4**

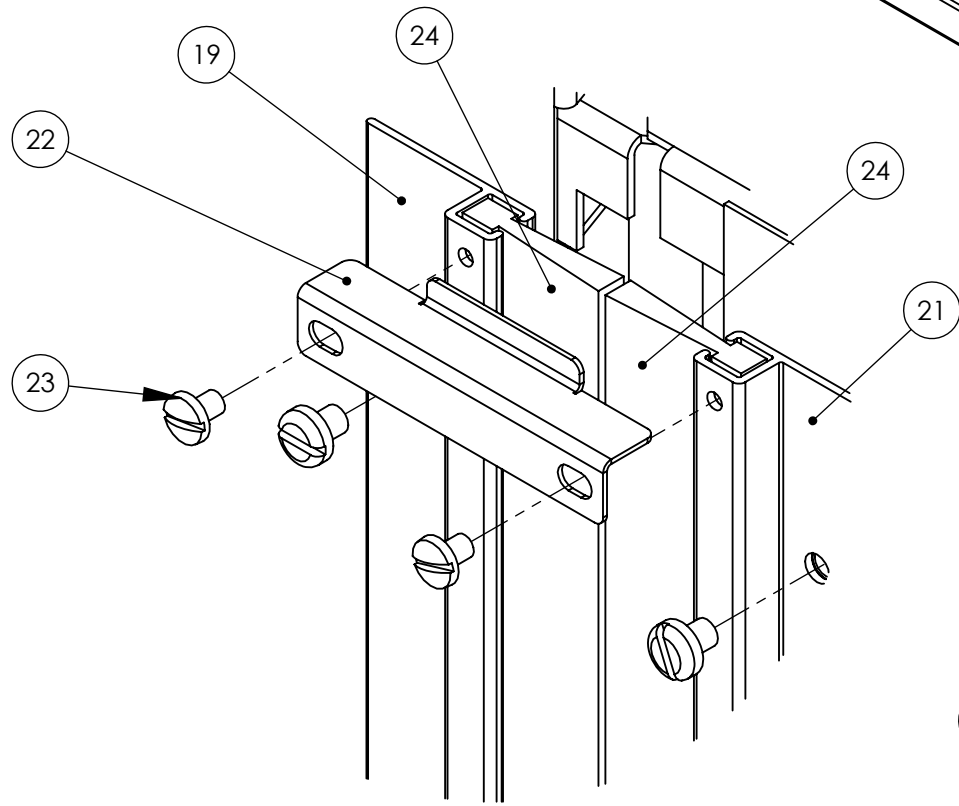
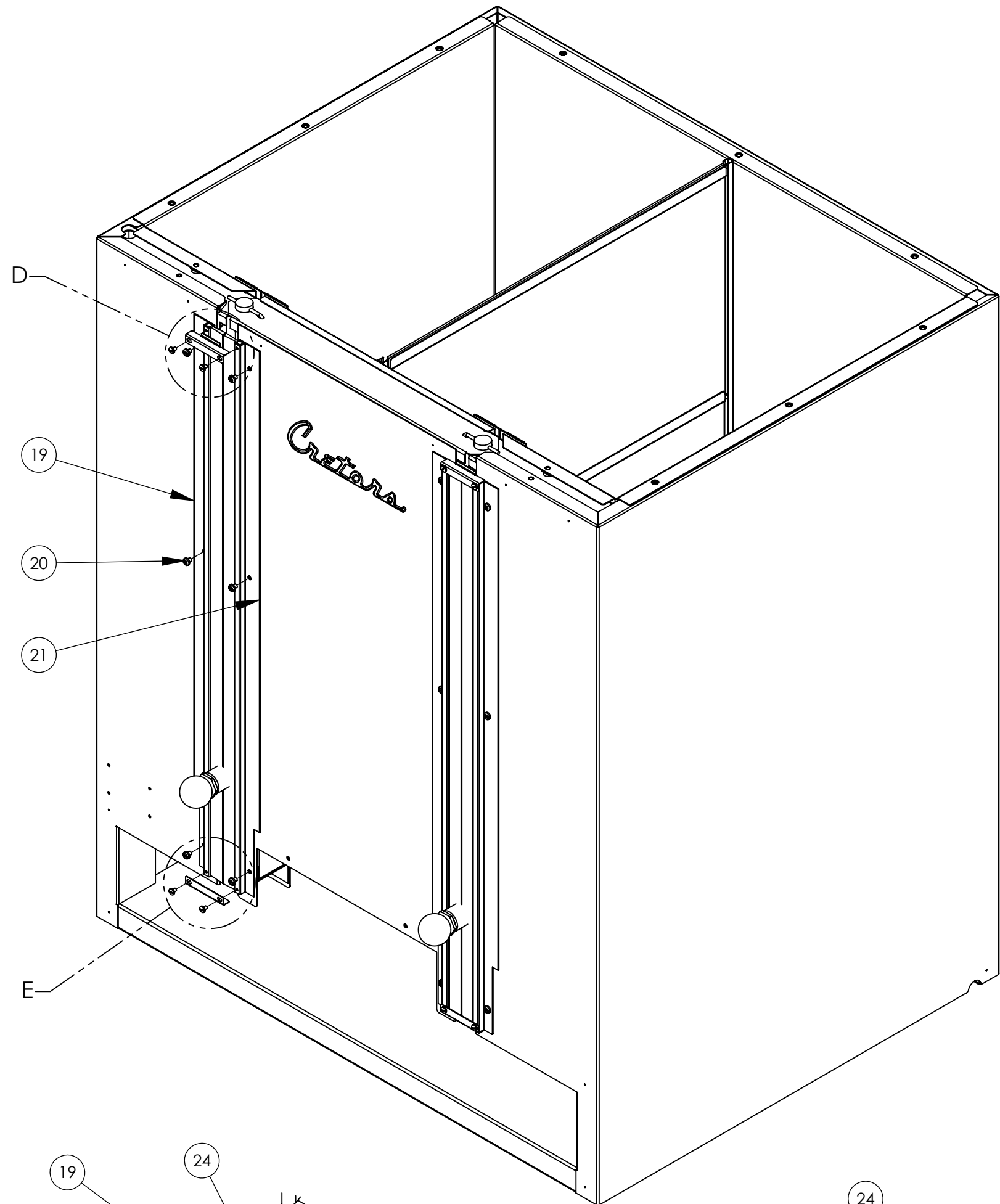

DETAIL D  
SCALE 1 : 1

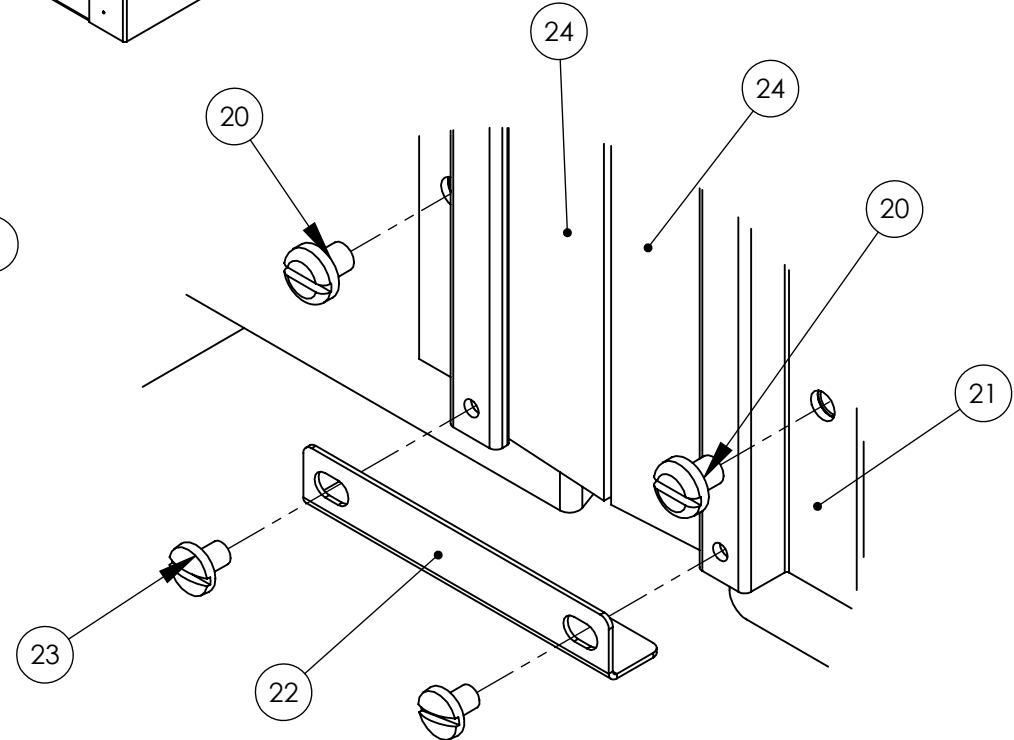

DETAIL E  
SCALE 1 : 1

**STEP # 5**

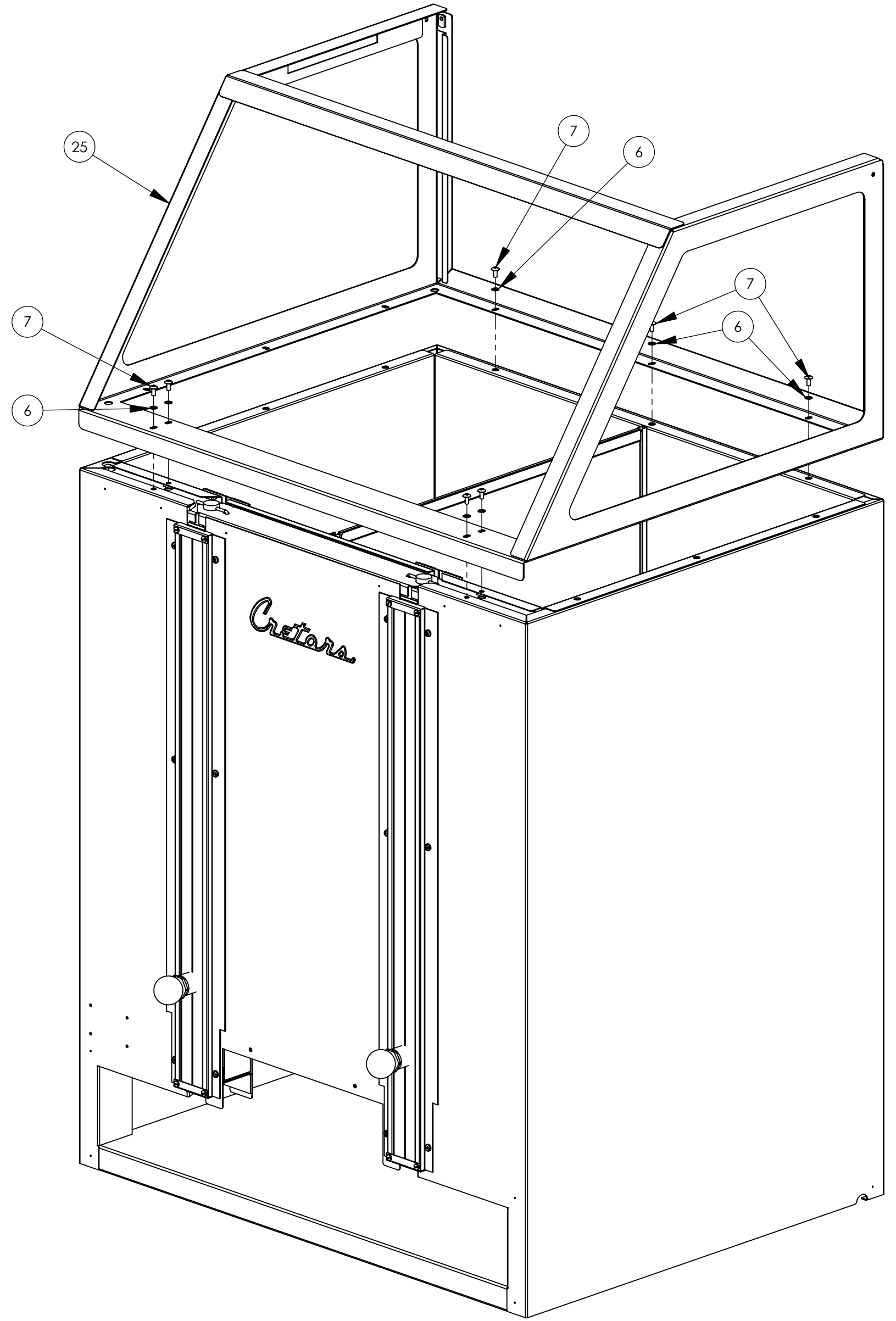

- STANDARD NOTES:**
1. REMOVE SHARP EDGES AND BURRS.
  2. UNLESS SPECIFIED ALL DIMENSIONS ARE IN INCHES.
  3. REFERENCE DIMENSIONS THAT NEED INSPECTION ARE INDICATED IN PARENTHESIS.
  4. CRITICAL DIMENSIONS THAT NEED INSPECTION ARE INDICATED IN OBOUND BOX.
  5. T.S.C. STAND FOR THEORITICAL SHARP CORNER & INS STAND FOR INSIDE.
  6. FOR SHEET METAL, UNLESS SPECIFIED ALL DIMENSIONS ARE OUTSIDE.
  7. FOR SHEET METAL, FLAT PATTERNS ARE FOR REFERENCE ONLY.

THIRD ANGLE PROJECTION		176 MITTEL DRIVE, WOOD DALE, IL 60191 www.cretors.com   www.ilo-llnu.com	
TOLERANCES x.xx = ± 0.02 x.xxx = ± 0.01 ANGLES = ± 1° HOLES = +0.005 / -0 FINISH = 125Ra		DESCRIPTION <b>COUNTER SHOWCASE WARMER, ELEVATOR</b>	
C SIZE DRAWING		MATERIAL	
DRAWN BY: ndarji		REFER INDIVIDUAL SUB-PARTS	
APPROVED BY: nvidojevic		DRAWING NUMBER: CSW-ELV-A	
DRAWN DATE: 08/11/2017		APPROX. WEIGHT: 189.11 LBS	
APPROVED DATE: 08/11/2017		REVISION: A	
THIS DRAWING CONTAINS INFORMATION PROPRIETARY TO C. CRETORS & CO. AND IS FURNISHED IN CONFIDENCE FOR SOLE PURPOSE OF SUPPLYING THE RECIPIENT WITH NEEDED ENGINEERING DATA. THE CONTENTS SHOULD NOT BE DISCLOSED OR REPRODUCED IN ANY MANNER WITHOUT WRITTEN CONSENT OF C. CRETORS & CO. ALL RIGHTS RESERVED.			
		SHEET 5 OF 8	

**STEP # 6**

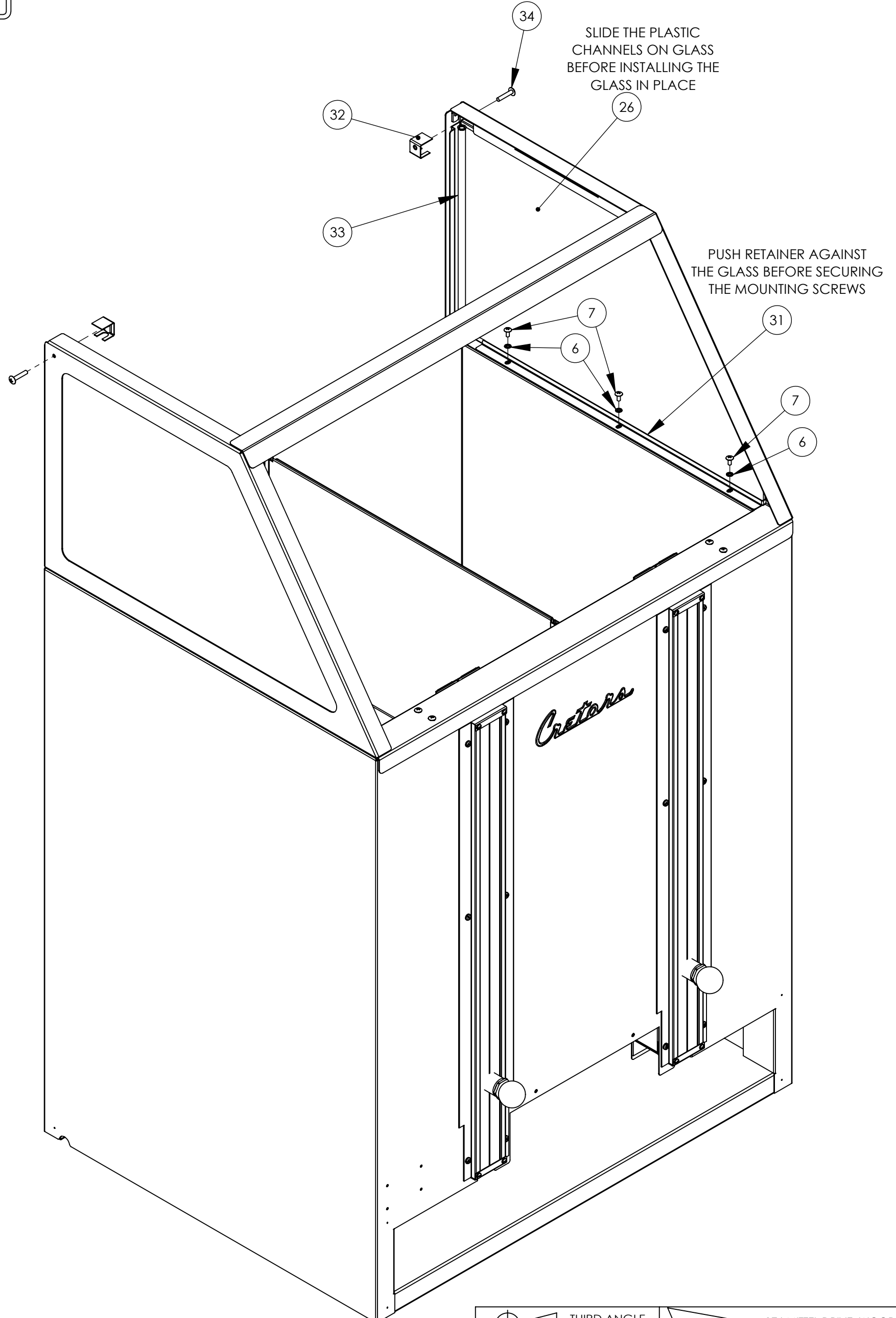
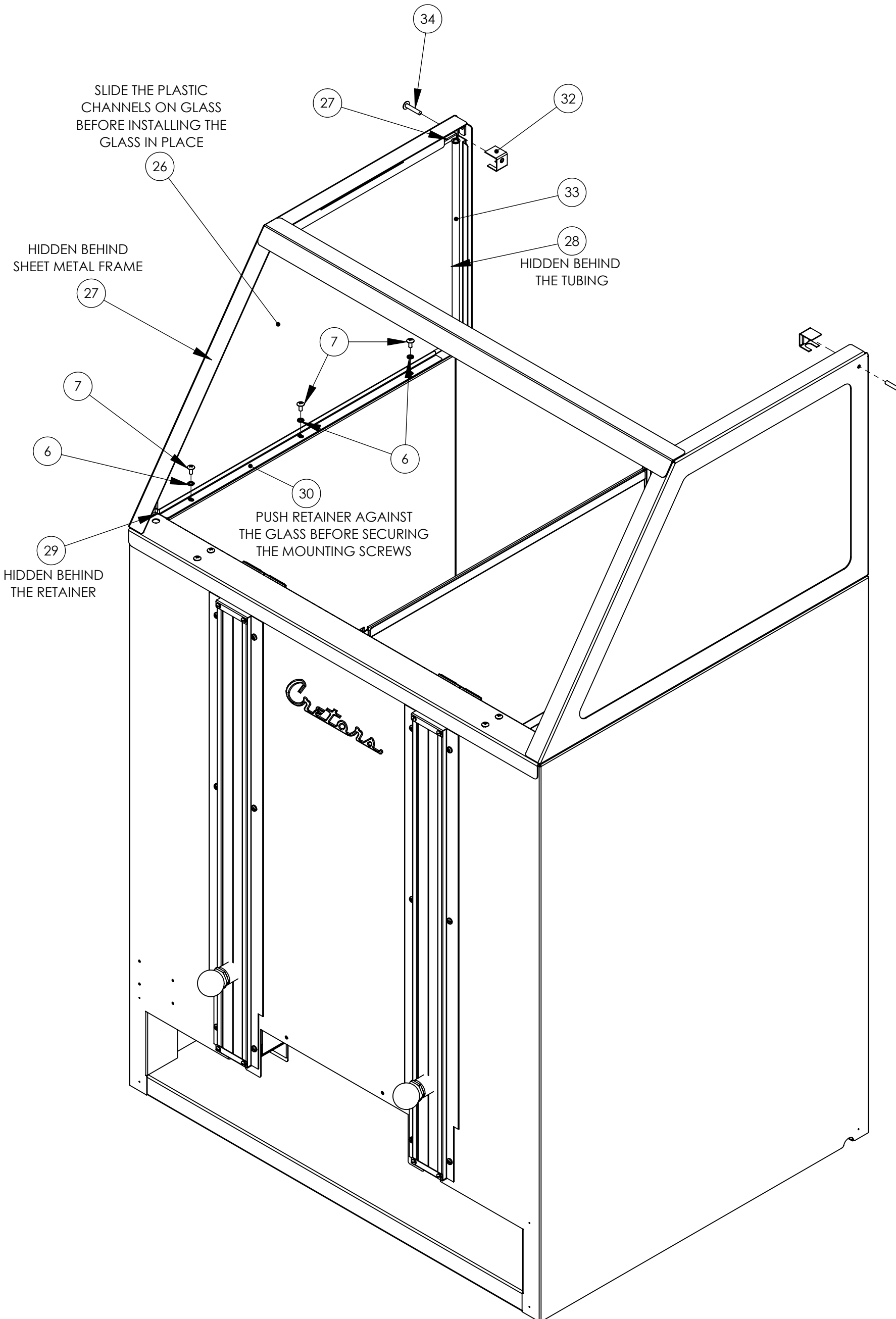

- STANDARD NOTES:**
1. REMOVE SHARP EDGES AND BURRS.
  2. UNLESS SPECIFIED ALL DIMENSIONS ARE IN INCHES.
  3. REFERENCE DIMENSIONS ARE INDICATED IN PARENTHESIS.
  4. CRITICAL DIMENSIONS THAT NEED INSPECTION ARE INDICATED IN OBOUND BOX.
  5. T.S.C. STAND FOR THEORITICAL SHARP CORNER & INS STAND FOR INSIDE.
  6. FOR SHEET METAL, UNLESS SPECIFIED ALL DIMENSIONS ARE OUTSIDE.
  7. FOR SHEET METAL, FLAT PATTERNS ARE FOR REFERENCE ONLY.

<p>THIRD ANGLE PROJECTION</p>		<p>176 MITTEL DRIVE, WOOD DALE, IL 60191 www.cretors.com   www.ilo-lltu.com</p>	
<p>TOLERANCES</p> <p>x.xx = ± 0.02 x.xxx = ± 0.01 ANGLES = ± 1° HOLES = +0.005 / -0 FINISH = 125Ra</p>		<p>DESCRIPTION</p> <p><b>COUNTER SHOWCASE WARMER, ELEVATOR</b></p>	
<p>C SIZE DRAWING</p>		<p>MATERIAL</p> <p>REFER INDIVIDUAL SUB-PARTS</p>	
<p>DRAWN BY</p> <p>ndarji</p>	<p>DRAWN DATE</p> <p>08/11/2017</p>	<p>DRAWING NUMBER</p> <p>CSW-ELV-A</p>	<p>APPROX. WEIGHT</p> <p>189.11 LBS</p>
<p>APPROVED BY</p> <p>nvidojevic</p>	<p>APPROVED DATE</p> <p>08/11/2017</p>	<p>REVISION</p> <p>A</p>	<p>SHEET</p> <p>6 OF 8</p>
<p><small>THIS DRAWING CONTAINS INFORMATION PROPRIETARY TO C. CRETORS &amp; CO. AND IS FURNISHED IN CONFIDENCE FOR SOLE PURPOSE OF SUPPLYING THE RECIPIENT WITH NEEDED ENGINEERING DATA. THE CONTENTS SHOULD NOT BE DISCLOSED OR REPRODUCED IN ANY MANNER WITHOUT WRITTEN CONSENT OF C. CRETORS &amp; CO. ALL RIGHTS RESERVED.</small></p>			



**STEP # 7**

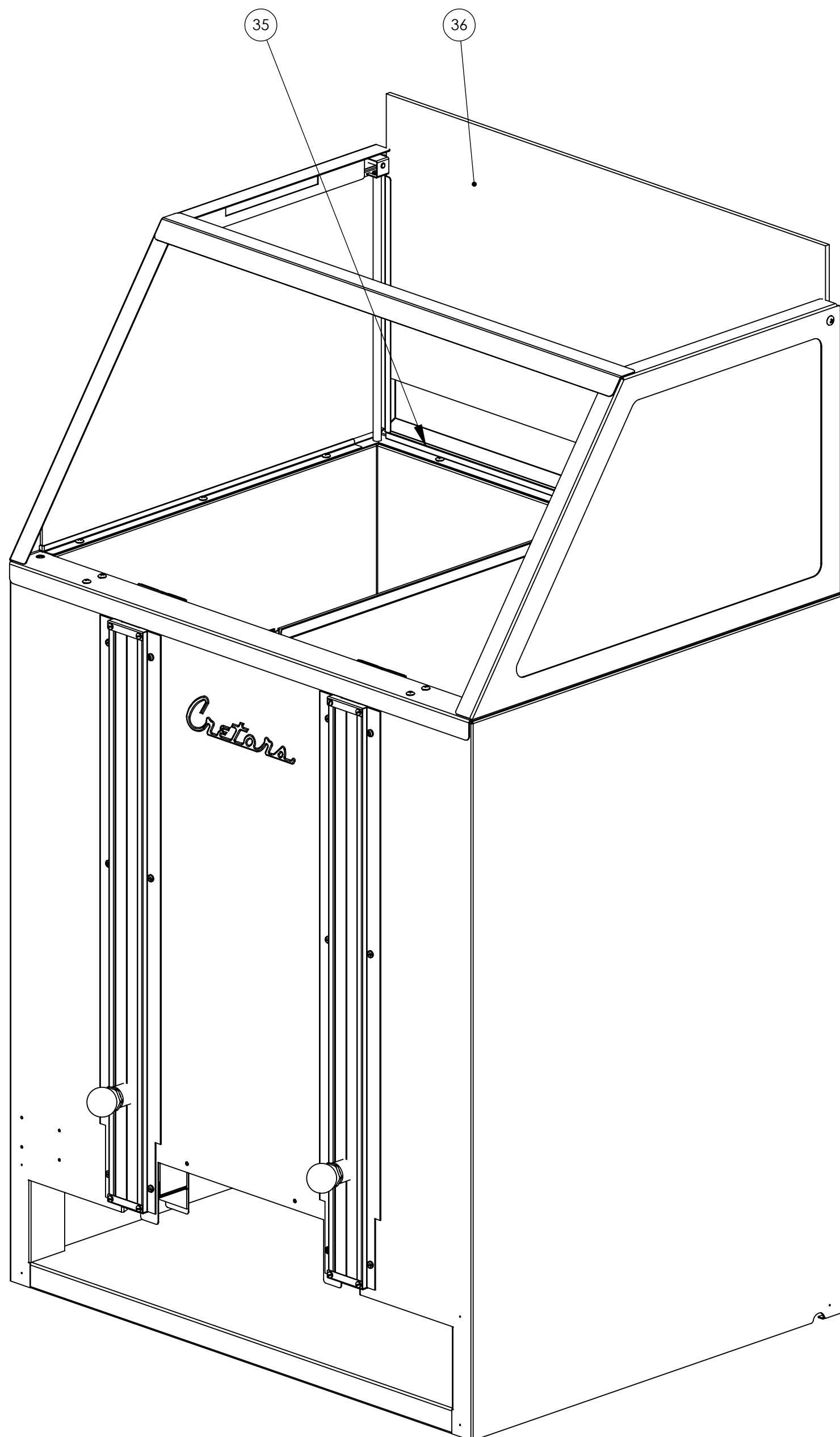

**STEP # 8**

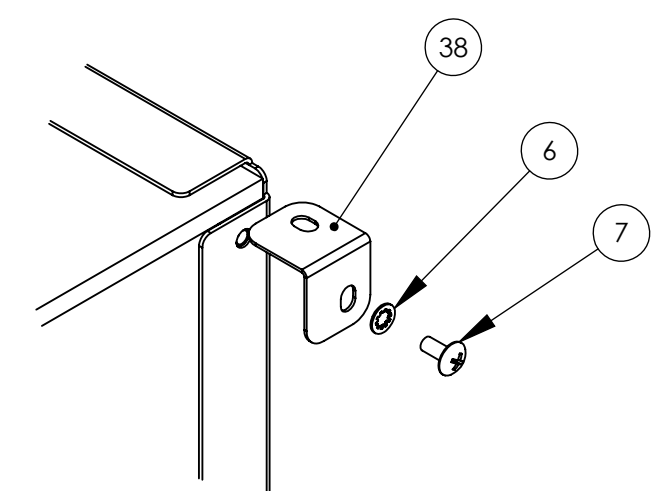
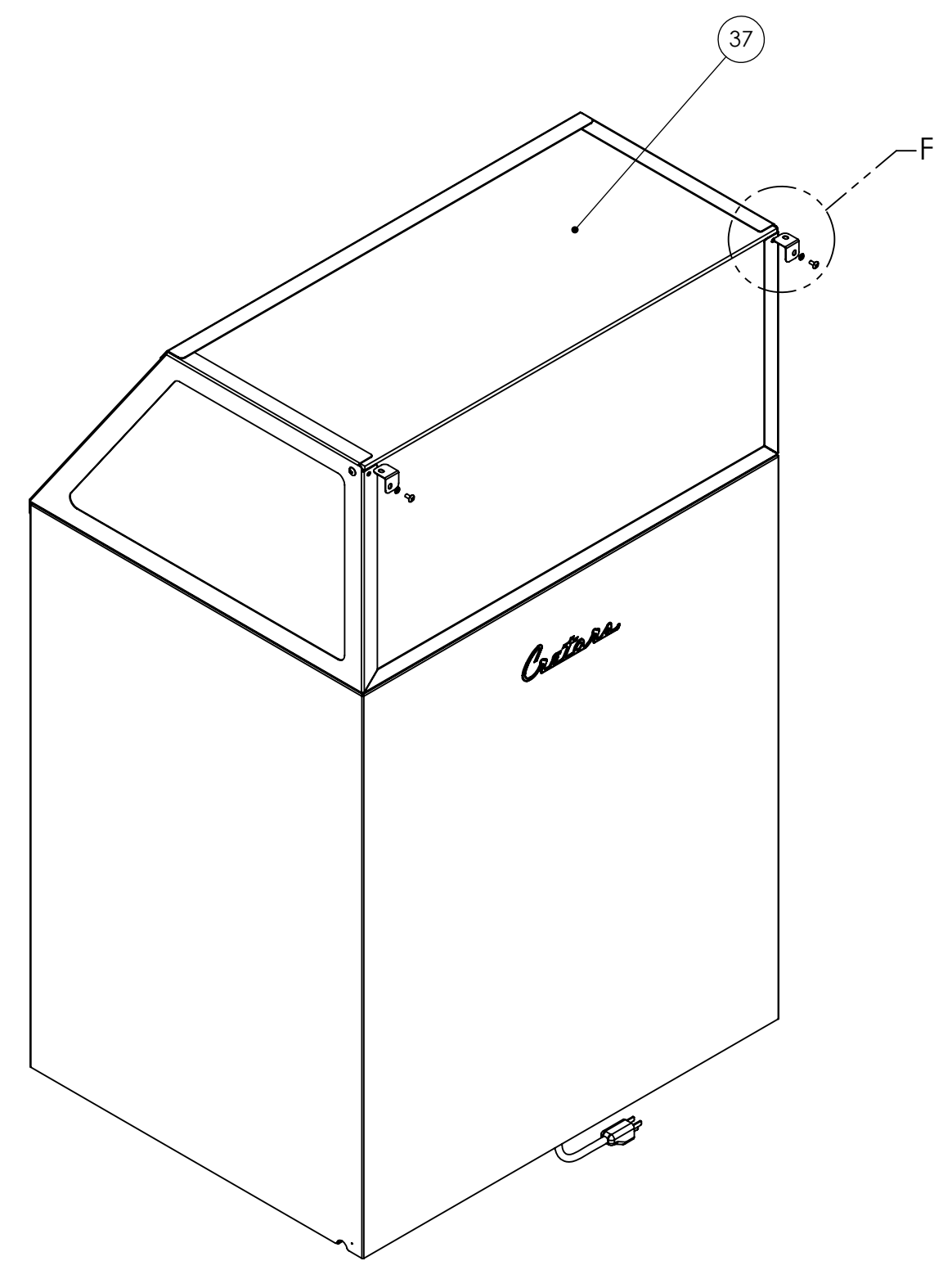

DETAIL F  
SCALE 1 : 2

- STANDARD NOTES:**
1. REMOVE SHARP EDGES AND BURRS.
  2. UNLESS SPECIFIED ALL DIMENSIONS ARE IN INCHES.
  3. REFERENCE DIMENSIONS ARE INDICATED IN PARENTHESIS.
  4. CRITICAL DIMENSIONS THAT NEED INSPECTION ARE INDICATED IN OBOUND BOX.
  5. T.S.C. STAND FOR THEORITICAL SHARP CORNER & INS STAND FOR INSIDE.
  6. FOR SHEET METAL, UNLESS SPECIFIED ALL DIMENSIONS ARE OUTSIDE.
  7. FOR SHEET METAL, FLAT PATTERNS ARE FOR REFERENCE ONLY.

<p>THIRD ANGLE PROJECTION</p>		<p>176 MITTEL DRIVE, WOOD DALE, IL 60191 www.cretors.com   www.flo-thru.com</p>	
<p>TOLERANCES</p> <p>x.xx = ± 0.02 x.xxx = ± 0.01 ANGLES = ± 1° HOLES = +0.005 / -0 FINISH = 125Ra</p>		<p>DESCRIPTION</p> <p><b>COUNTER SHOWCASE WARMER, ELEVATOR</b></p>	
<p>C SIZE DRAWING</p>		<p>MATERIAL</p> <p>REFER INDIVIDUAL SUB-PARTS</p>	
<p>DRAWN BY</p> <p>ndarji</p>	<p>DRAWN DATE</p> <p>08/11/2017</p>	<p>DRAWING NUMBER</p> <p>CSW-ELV-A</p>	<p>APPROX. WEIGHT</p> <p>189.11 LBS</p>
<p>APPROVED BY</p> <p>nvidojevic</p>	<p>APPROVED DATE</p> <p>08/11/2017</p>	<p>REVISION</p> <p>A</p>	<p>SHEET</p> <p>7 OF 8</p>
<p><small>THIS DRAWING CONTAINS INFORMATION PROPRIETARY TO C. CRETORS &amp; CO. AND IS FURNISHED IN CONFIDENCE FOR SOLE PURPOSE OF SUPPLYING THE RECIPIENT WITH NEEDED ENGINEERING DATA. THE CONTENTS SHOULD NOT BE DISCLOSED OR REPRODUCED IN ANY MANNER WITHOUT WRITTEN CONSENT OF C. CRETORS &amp; CO. ALL RIGHTS RESERVED.</small></p>			

**STEP # 9**

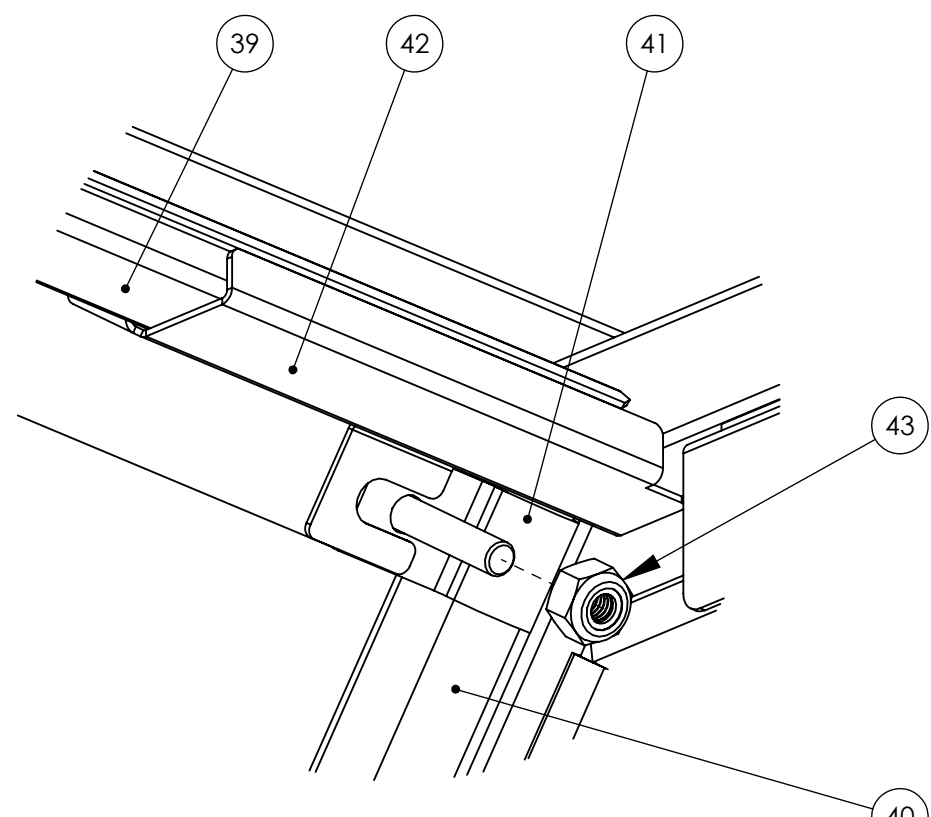
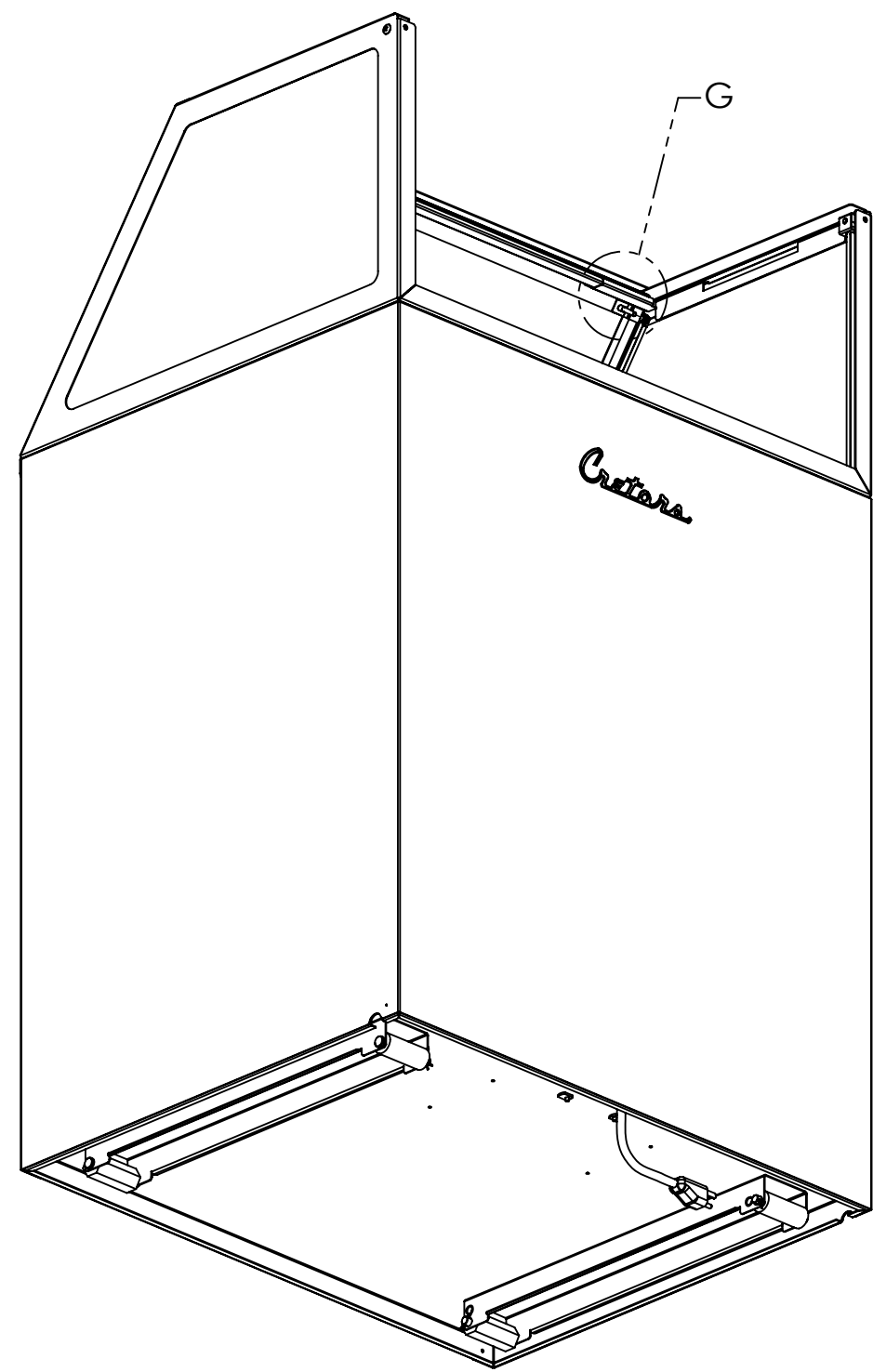

DETAIL G  
SCALE 1 : 1

**STEP # 10**

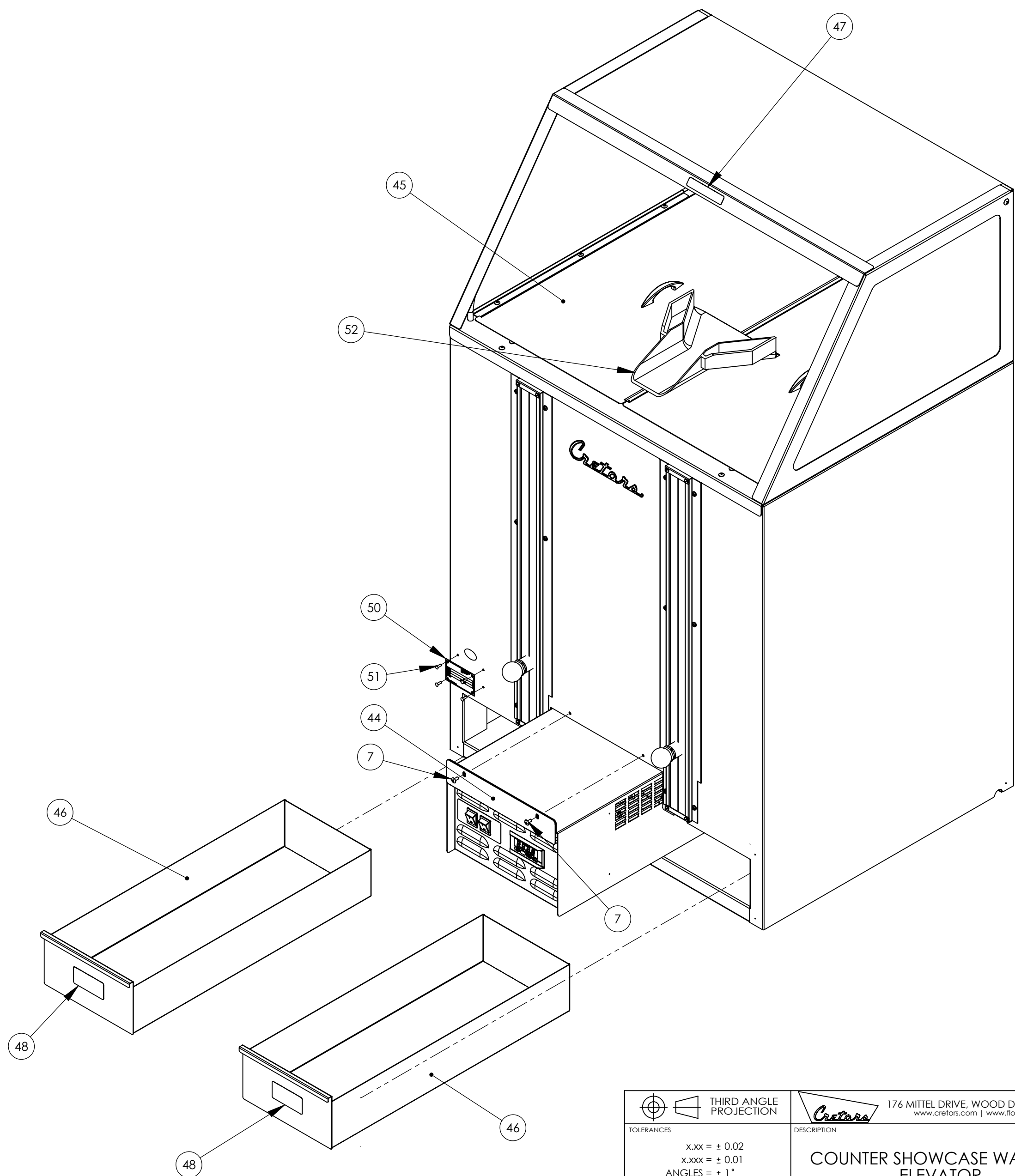

- STANDARD NOTES:**
1. REMOVE SHARP EDGES AND BURRS.
  2. UNLESS SPECIFIED ALL DIMENSIONS ARE IN INCHES.
  3. REFERENCE DIMENSIONS ARE INDICATED IN PARENTHESIS.
  4. CRITICAL DIMENSIONS THAT NEED INSPECTION ARE INDICATED IN OBOUND BOX.
  5. T.S.C. STAND FOR THEORITICAL SHARP CORNER & INS STAND FOR INSIDE.
  6. FOR SHEET METAL, UNLESS SPECIFIED ALL DIMENSIONS ARE OUTSIDE.
  7. FOR SHEET METAL, FLAT PATTERNS ARE FOR REFERENCE ONLY.

THIRD ANGLE PROJECTION		176 MITTEL DRIVE, WOOD DALE, IL 60191 www.crestara.com   www.ilo-llnu.com	
TOLERANCES x.xx = ± 0.02 x.xxx = ± 0.01 ANGLES = ± 1° HOLES = +0.005 / -0 FINISH = 125Ra		DESCRIPTION <b>COUNTER SHOWCASE WARMER, ELEVATOR</b>	
C SIZE DRAWING		MATERIAL REFER INDIVIDUAL SUB-PARTS	
DRAWN BY ndarji	DRAWN DATE 08/11/2017	DRAWING NUMBER CSW-ELV-A	APPROX. WEIGHT 189.11 LBS
APPROVED BY nvidojevic	APPROVED DATE 08/11/2017	SHEET A	REVISION 8 OF 8
THIS DRAWING CONTAINS INFORMATION PROPRIETARY TO C. CRETORS & CO. AND IS FURNISHED IN CONFIDENCE FOR SOLE PURPOSE OF SUPPLYING THE RECIPIENT WITH NEEDED ENGINEERING DATA. THE CONTENTS SHOULD NOT BE DISCLOSED OR REPRODUCED IN ANY MANNER WITHOUT WRITTEN CONSENT OF C. CRETORS & CO. ALL RIGHTS RESERVED.			

**BEGINNING SERIAL NO: 17072871**

REVISIONS			
REV	DC #	APPROVED BY	APPROVED ON
-	-	-	-
-	-	-	-
A	-	nvidojevic	08/04/2017

**BILL OF MATERIALS**

ITEM #	QTY.	P/N	DESCRIPTION
1	1	20442	ENCLOSURE, CSW-ELV, CORNDITIONER
2	1	20601	DECAL, CORNDITIONER, CSW-ELV
3	2	5130	SWITCH, LIGHTED, 230V
4	1	14585-CG	GUARD, CONTROL, HOT DOG GRILL
5	1	14585	TEMPERATURE CONTROLLER, DIGITAL, 120V
6	1	5601	HIGH LIMIT, 200 DEG
7	2	7727	#8-32 X 3/8"LG FULLY THD, SLOT ROUND HEAD MACHINE SCREW, STEEL ZINC
8	2	7789	#8, INTERNAL TOOTH LOCKWASHER, STEEL NICKEL
9	1	1727-A	HEAT ELEMENT, 1100W, 120V, 13.1 OHMS
10	1	7264	ELEMENT CLAMP, 1-5/8"
11	6	5505	#8-32, SERRATED HEX FLANGE NUT, STEEL ZINC
12	1	2123	BUSHING, HEYCO #2030, 1/4"
13	1	4709	SPACER, 0.21"ID X 0.3"OD X 5/8"LG, STEEL
14	1	7683	#10, SAE FLAT WASHER, 18-8 S.S.
15	1	16086	THERMOCOUPLE, RING TYPE, HOT DOG
16	1	5634	BLOWER, 115/230V, 50/60 Hz, 1/40 HP
17	8	5742	1/4", SAE FLAT WASHER, 18-8 S.S.
18	8	5743	1/4", MEDIUM SPLIT LOCKWASHER, 18-8 S.S.
19	8	10121	1/4-20 X 1/2"LG FULLY THD, HEX HEAD CAP SCREW, 18-8 S.S.
20	1	5712	PLUG, 15AMP, 5 CONTACT
21	2	7642	#8-32 X 3/8"LG FULLY THD, PHIL TRUSS HEAD MACHINE SCREW, 18-8 S.S.
22	2	14646	#8-32, KEPS NUT, STEEL NICKEL
23	1	20463	COVER, CSW-ELV CORNDITIONER

FOR WIRING:  
REFER TO CURRENT REVISION OF WIRING DIAGRAM: **CSWELVA**

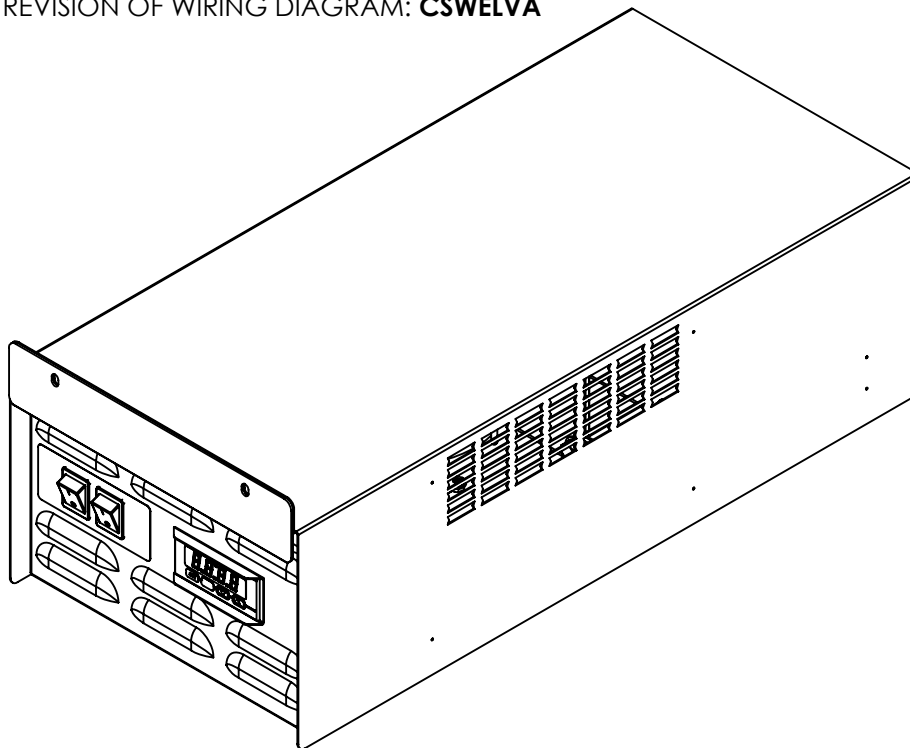

 176 MITTEL DRIVE, WOOD DALE, IL 60191 Ph: (847) 616-6900, (800) 228-1885, Fax: (847) 616-6970 www.cretors.com, postmaster@cretors.com		DESCRIPTION	CORNDITIONER ASSY, CSW-ELV-A	
DRAWN BY	DRAWN DATE	MATERIAL	APP. WEIGHT	SHEET
ndarji	08/04/2017	REFER INDIVIDUAL SUB-PARTS	12.51 LBS	1 OF 5
APPROVED BY	APPROVED DATE	DRAWING NUMBER	REVISION	
nvidojevic	08/04/2017	20450	A	

# STEP # 1

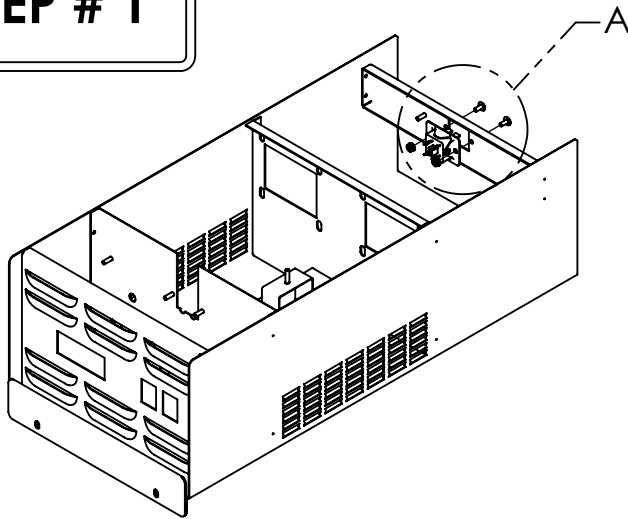

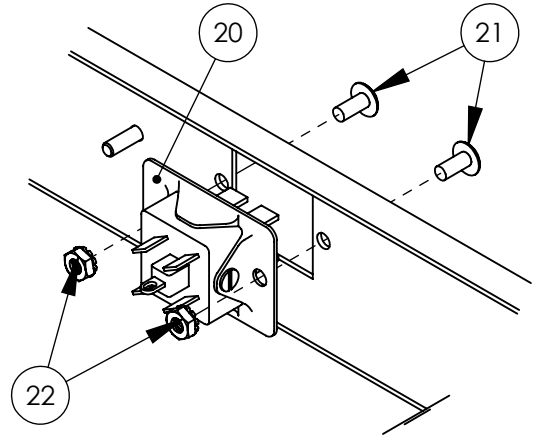

ENSURE ORIENTATION  
PRIOR TO ASSEMBLY

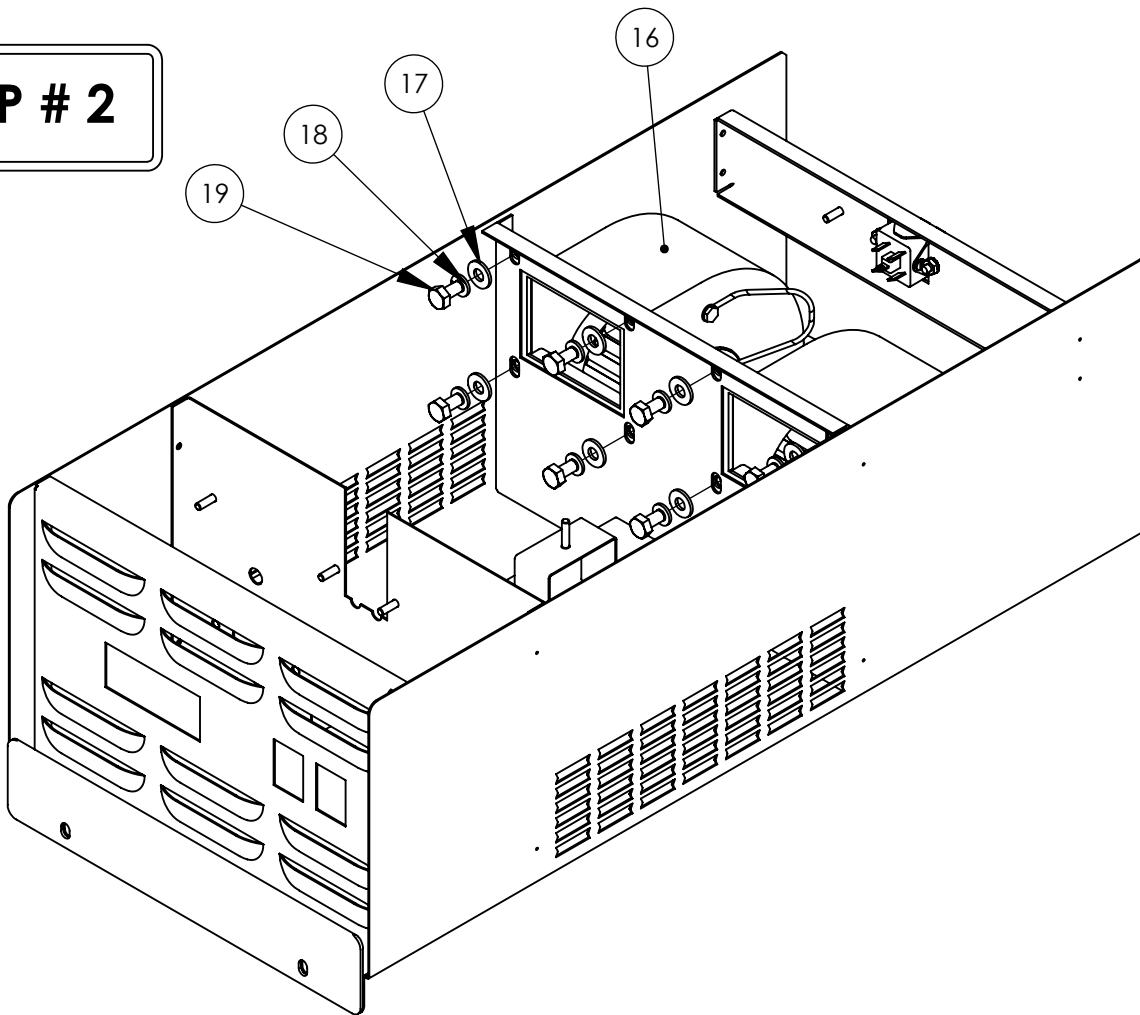

DETAIL A  
SCALE 1 : 2

# STEP # 2



 176 MITTEL DRIVE, WOOD DALE, IL 60191 Ph: (847) 616-6900, (800) 228-1885, Fax: (847) 616-6970 www.cretors.com, postmaster@cretors.com		DESCRIPTION	
		CORNDITIONER ASSY, CSW-ELV-A	
DRAWN BY	DRAWN DATE	MATERIAL	APPROX. WEIGHT LBS
ndarji	08/04/2017	REFER INDIVIDUAL SUB-PARTS	SHEET 2 OF 5
APPROVED BY	APPROVED DATE	DRAWING NUMBER	REVISION
nvidojevic	08/04/2017	20450	A

# STEP # 3

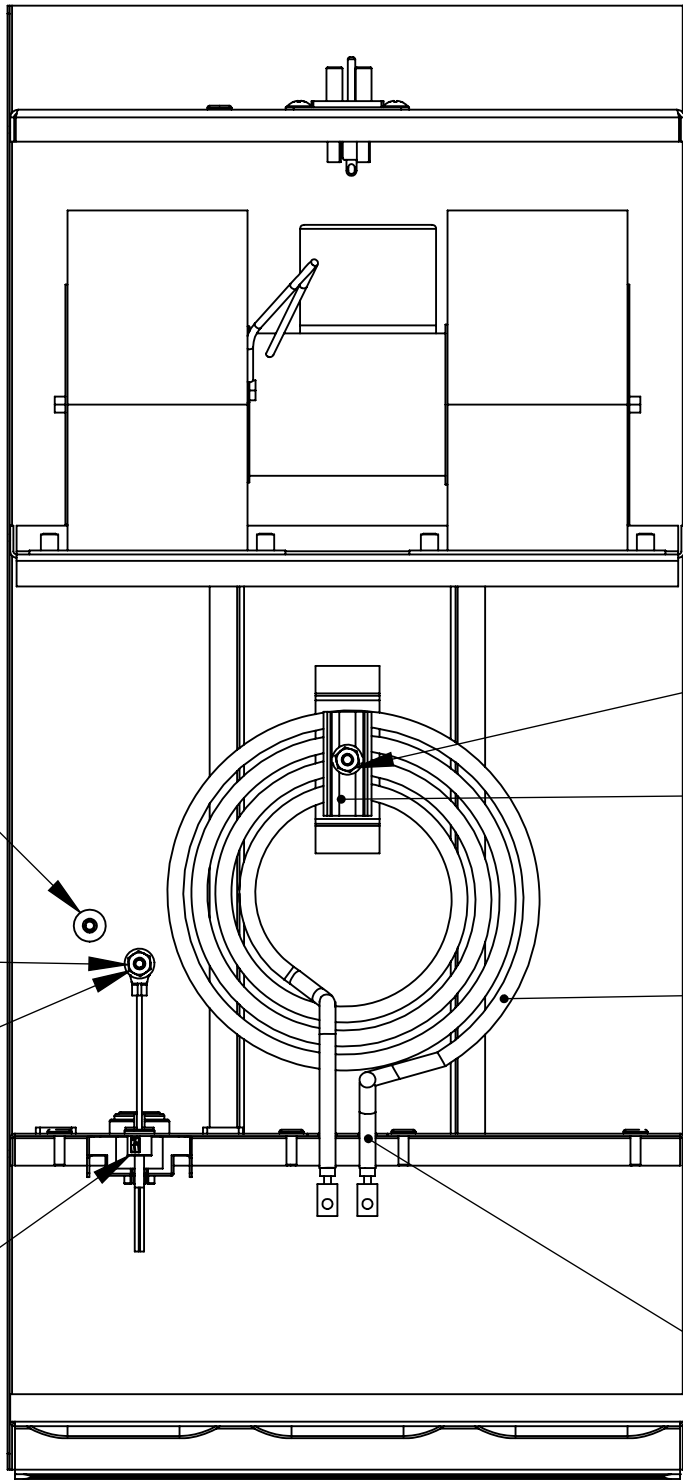

SLIDE THE SPACER OVER THE STUD FIRST

14

SLIDE THE #8 TERMINAL END THRU THE STUD ON THE SPACER NEXT

15

11 FASTEN THERMOCOUPLE USING THIS SERRATED NUT

12

INSTALL GROMMET FROM INSIDE THE HEAT ELEMENT CHAMBER. INSERT THE THERMOCOUPLE THRU THE GROMMET AND INSTALL TO THE TEMP. CONTROLLER AS PER WIRING DIAGRAM

11 INSTALL WITH ORIENTATION AS SHOWN

10

9

ENSURE HEAT ELEMENT REST ON THE NOTCH ON SHEET METAL

 176 MITTEL DRIVE, WOOD DALE, IL 60191 Ph: (847) 616-6900, (800) 228-1885, Fax: (847) 616-6970 www.cretors.com, postmaster@cretors.com		DESCRIPTION <b>CORNDITIONER ASSY, CSW-ELV-A</b>	
DRAWN BY <b>ndarji</b>	DRAWN DATE <b>08/04/2017</b>	MATERIAL REFER INDIVIDUAL SUB-PARTS	APPROX. WEIGHT LBS SHEET 3 OF 5
APPROVED BY <b>nvidojevic</b>	APPROVED DATE <b>08/04/2017</b>	DRAWING NUMBER <b>20450</b>	REVISION <b>A</b>

# STEP # 4

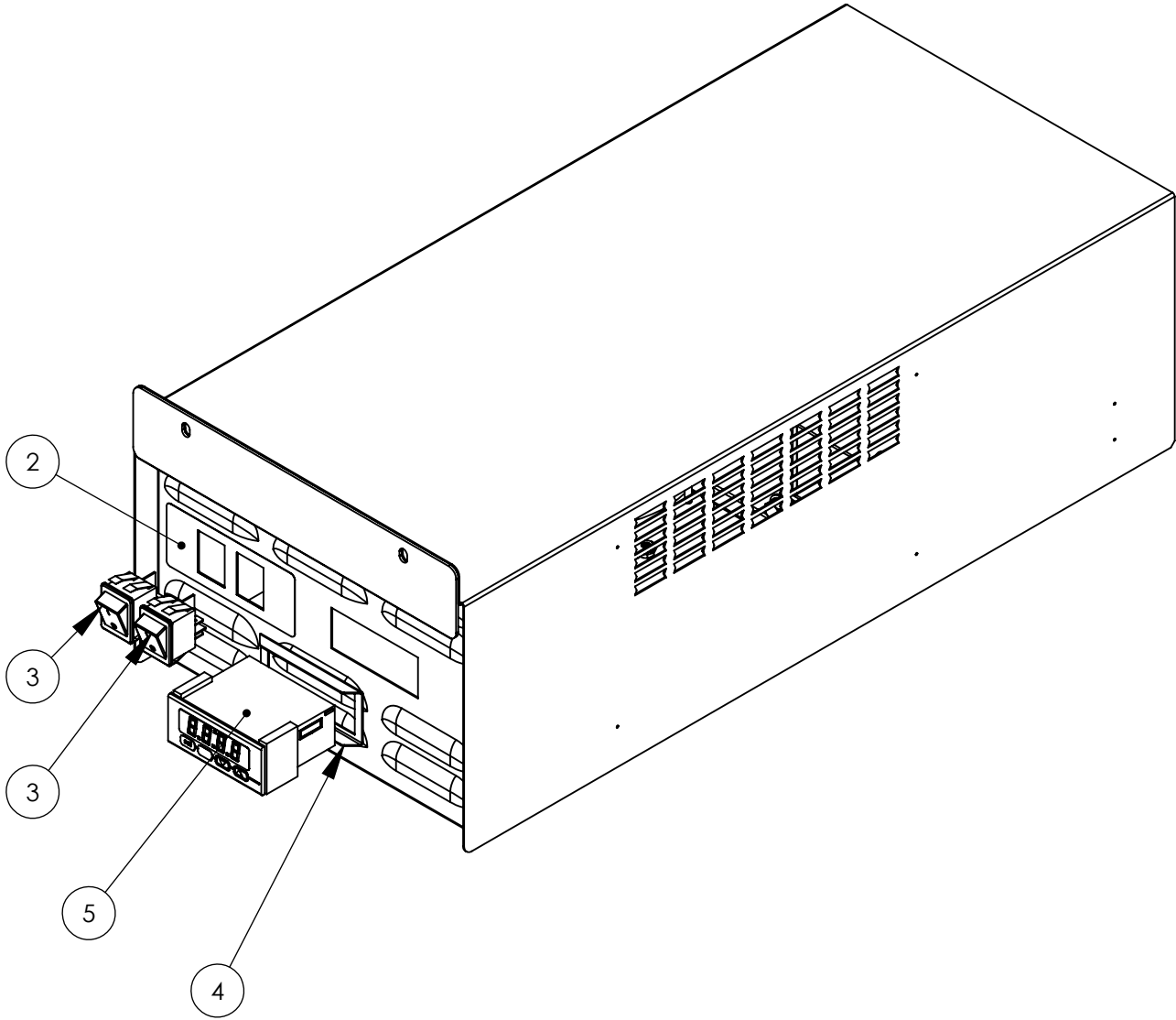

 176 MITTEL DRIVE, WOOD DALE, IL 60191 Ph: (847) 616-6900, (800) 228-1885, Fax: (847) 616-6970 www.cretors.com, postmaster@cretors.com		DESCRIPTION	
		CORNDITIONER ASSY, CSW-ELV-A	
DRAWN BY	DRAWN DATE	MATERIAL	APPROX. WEIGHT LBS
ndarji	08/04/2017	REFER INDIVIDUAL SUB-PARTS	4 OF 5
APPROVED BY	APPROVED DATE	DRAWING NUMBER	REVISION
nvidojevic	08/04/2017	20450	A

# STEP # 5

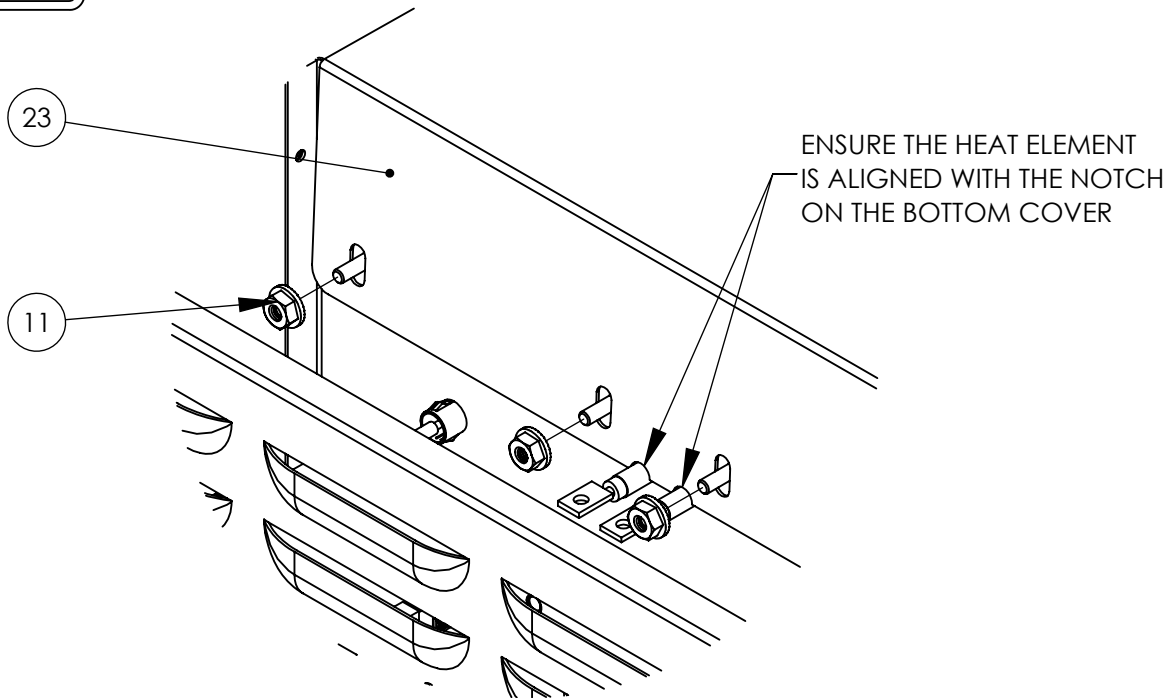

DETAIL B  
SCALE 1 : 2

THE BOTTOM COVER  
TO GO UNDER THE FLANGE  
BEFORE ASSEMBLING THE NUTS

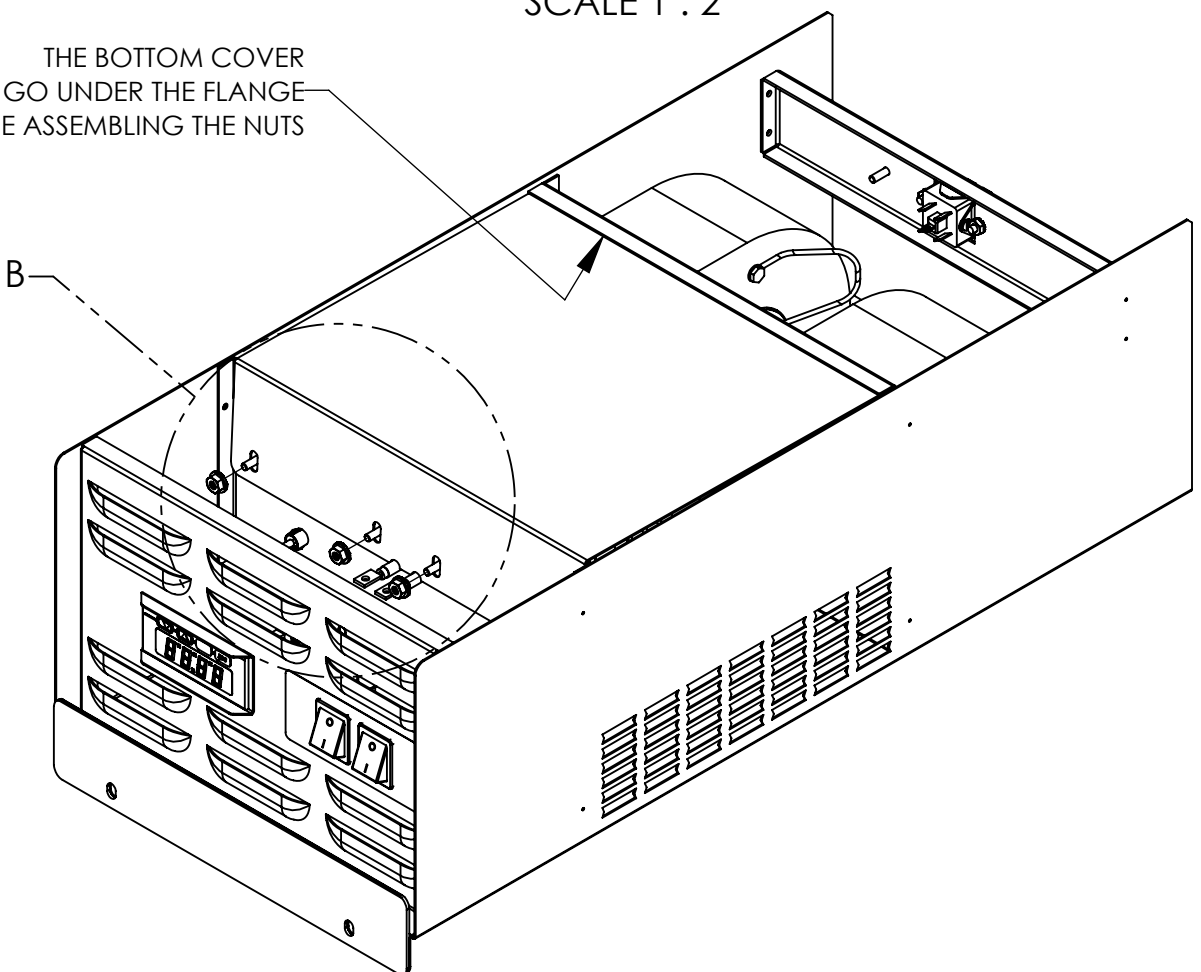

 176 MITTEL DRIVE, WOOD DALE, IL 60191 Ph: (847) 616-6900, (800) 228-1885, Fax: (847) 616-6970 www.cretors.com, postmaster@cretors.com		DESCRIPTION	
DRAWN BY		CORNDITIONER ASSY, CSW-ELV-A	
ndarji	DRAWN DATE	MATERIAL	APPROX. WEIGHT
	08/04/2017	REFER INDIVIDUAL SUB-PARTS	LBS
APPROVED BY	APPROVED DATE	DRAWING NUMBER	SHEET
nvidojevic	08/04/2017	20450	5 OF 5
			REVISION
			A

