

**ASSEMBLY HARDWARE**

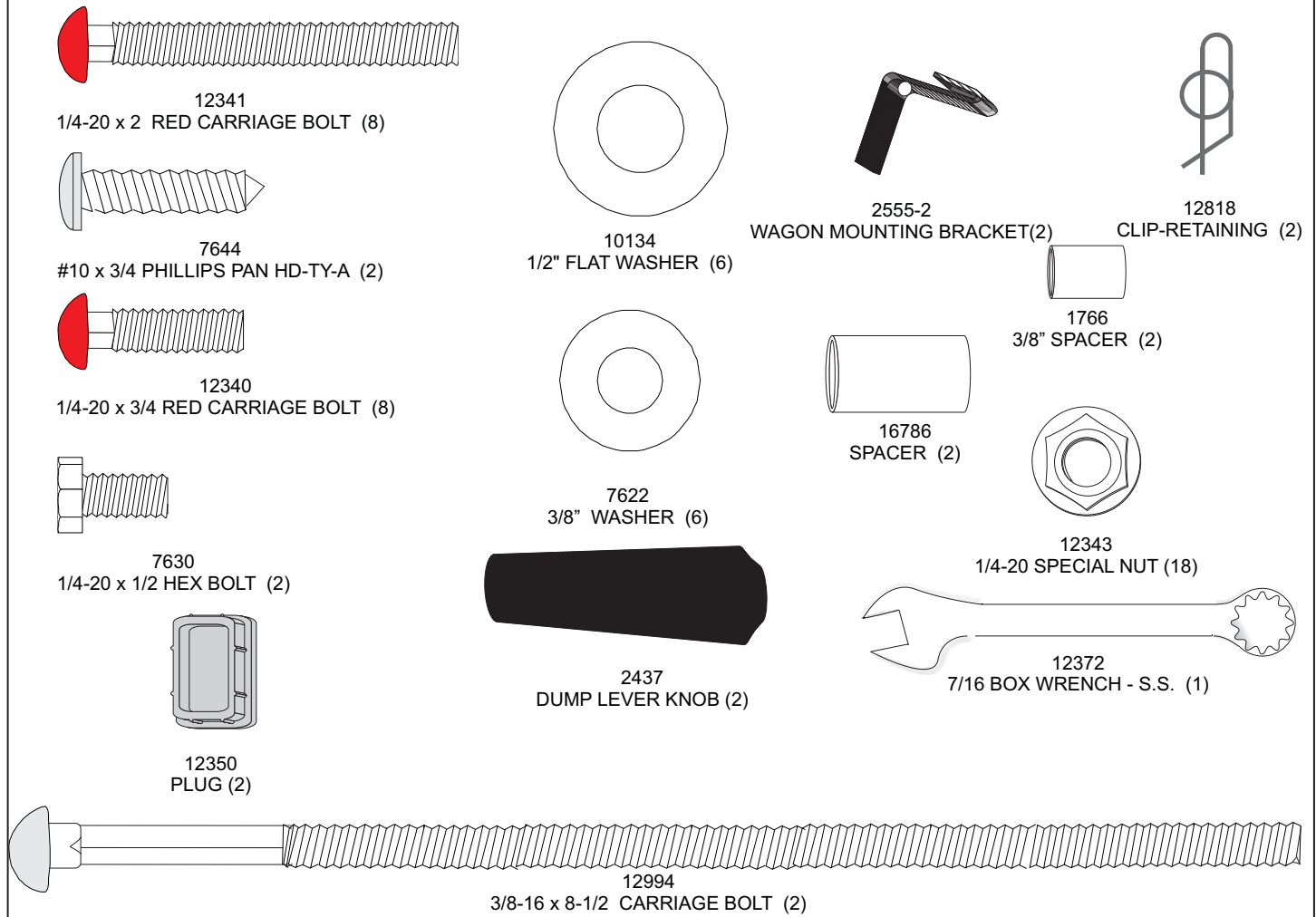

**PARTS DESCRIPTION**

2455-KD1 WAGON SIDE		<u>HARDWARE TO MOUNT POPPER</u>
2455-KD2 WAGON FRONT	2555-2	WAGON MOUNTING BRACKET
2455-KD3 WAGON BACK	7644	#10 x 3/4 SHEETMETAL SCREW
2455-KD4 WAGON BOTTOM		
2455-KD5 WAGON CROSS BAR		
12894	WAGON AXLE SUPPORT TUBE	
16787	AXLE ROD-ONLY SMALL	
2604	ANTIQUE WAGON WHEEL-YELLOW	
2606	DECAL-GR/T-2000-ANTIQUE WAGON	
12338	WAGON LEG - YELLOW-KNOCK DOWN	
12938	WAGON SHELF- GOLDRUSH	

C. CRETORS AND COMPANY  
 176 MITTEL DRIVE  
 WOOD DALE, IL 60191  
 PHONE: (773)588-1690, (800)228-1885, FAX: (847) 616-6970  
 WEB SITE: <http://www.cretors.com> Email: [postmaster@cretors.com](mailto:postmaster@cretors.com)

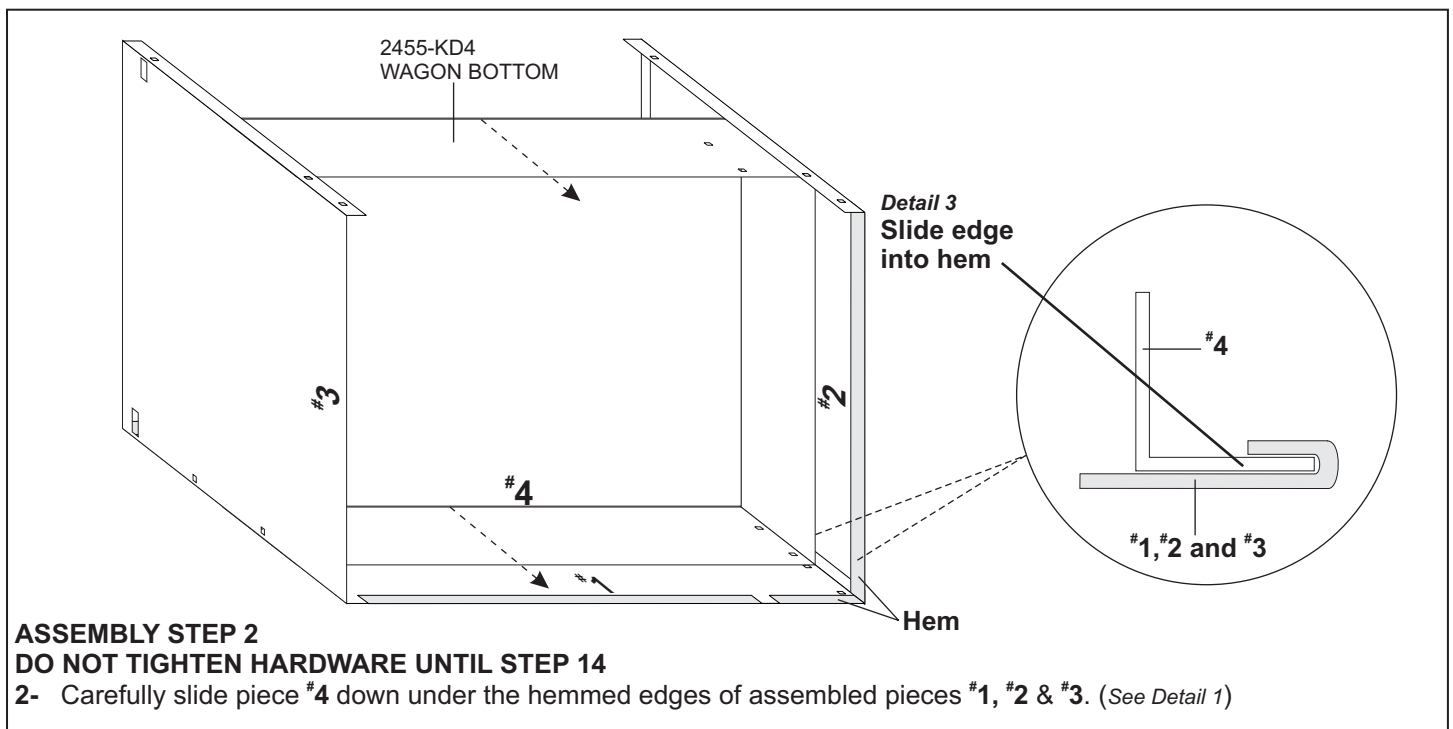
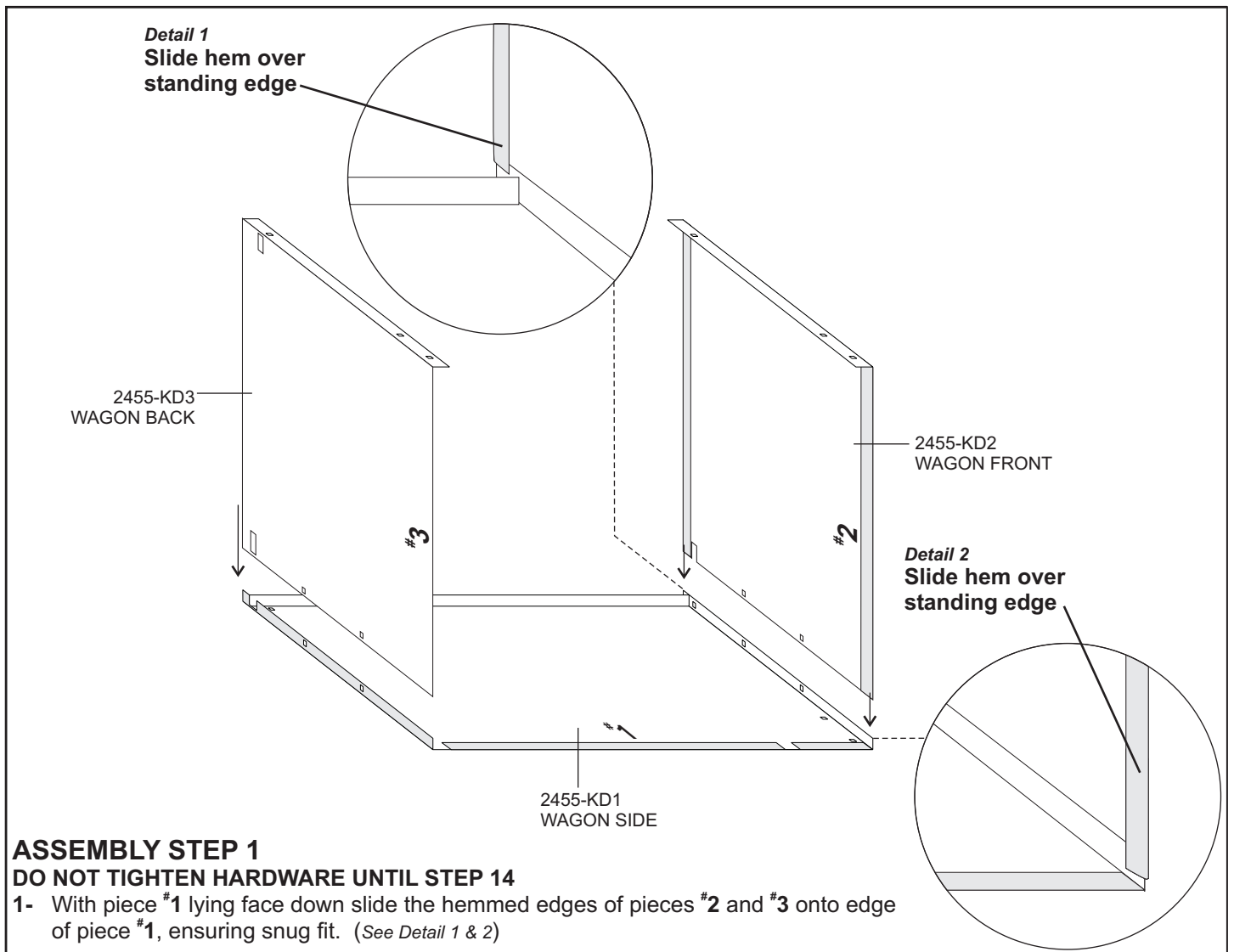

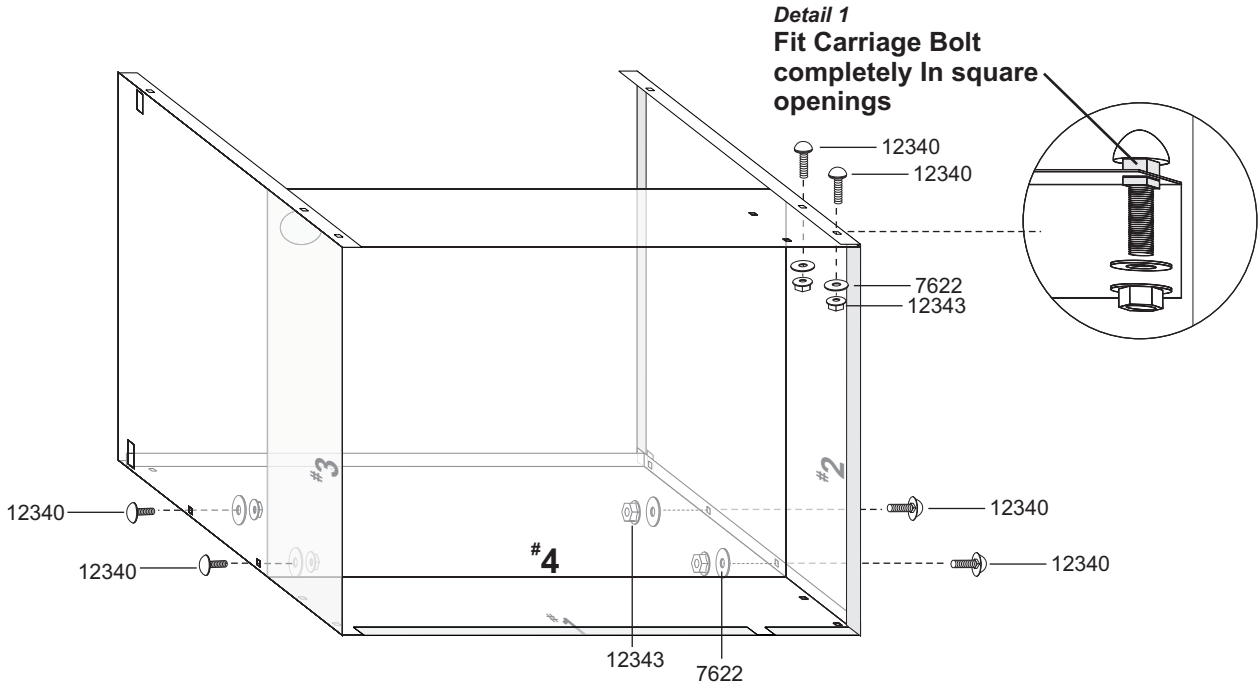

**ASSEMBLY STEP 3**

**DO NOT TIGHTEN HARDWARE UNTIL STEP 14**

- 3- Using hardware and wrench shown on page one fasten side pieces #2 & #3 to piece #1 and pieces #2 to #4 aligning all holes and fasten. Making sure Carriage Bolts fit snugly into square holes on base. (See Detail1)  
This completes the Base portion of The Wagon.

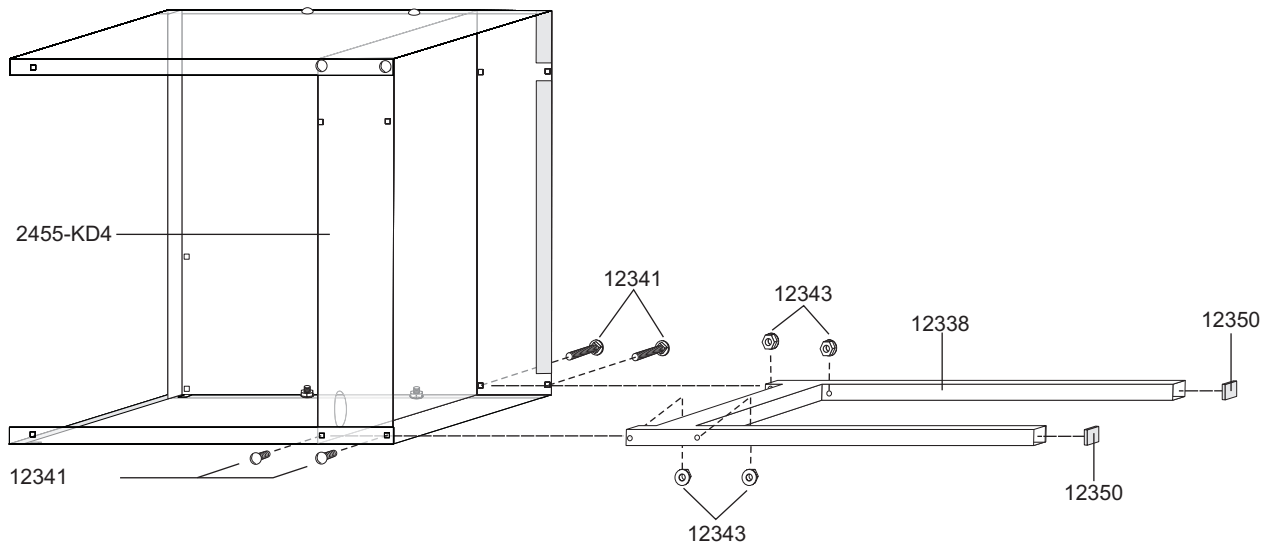

**ASSEMBLY STEPS 4 through 6**

**DO NOT TIGHTEN HARDWARE UNTIL STEP 14**

- 4- Turn Wagon Base on to side.  
5- Place Wagon Legs inside bottom of Wagon Base aligning Wagon Legs with hole openings on pieces #1, #3 and #4, fasten legs to Wagon Base using Special Wrench provided or a 7/16 wrench.  
6- Push Plugs into open ends of the Wagon Legs.

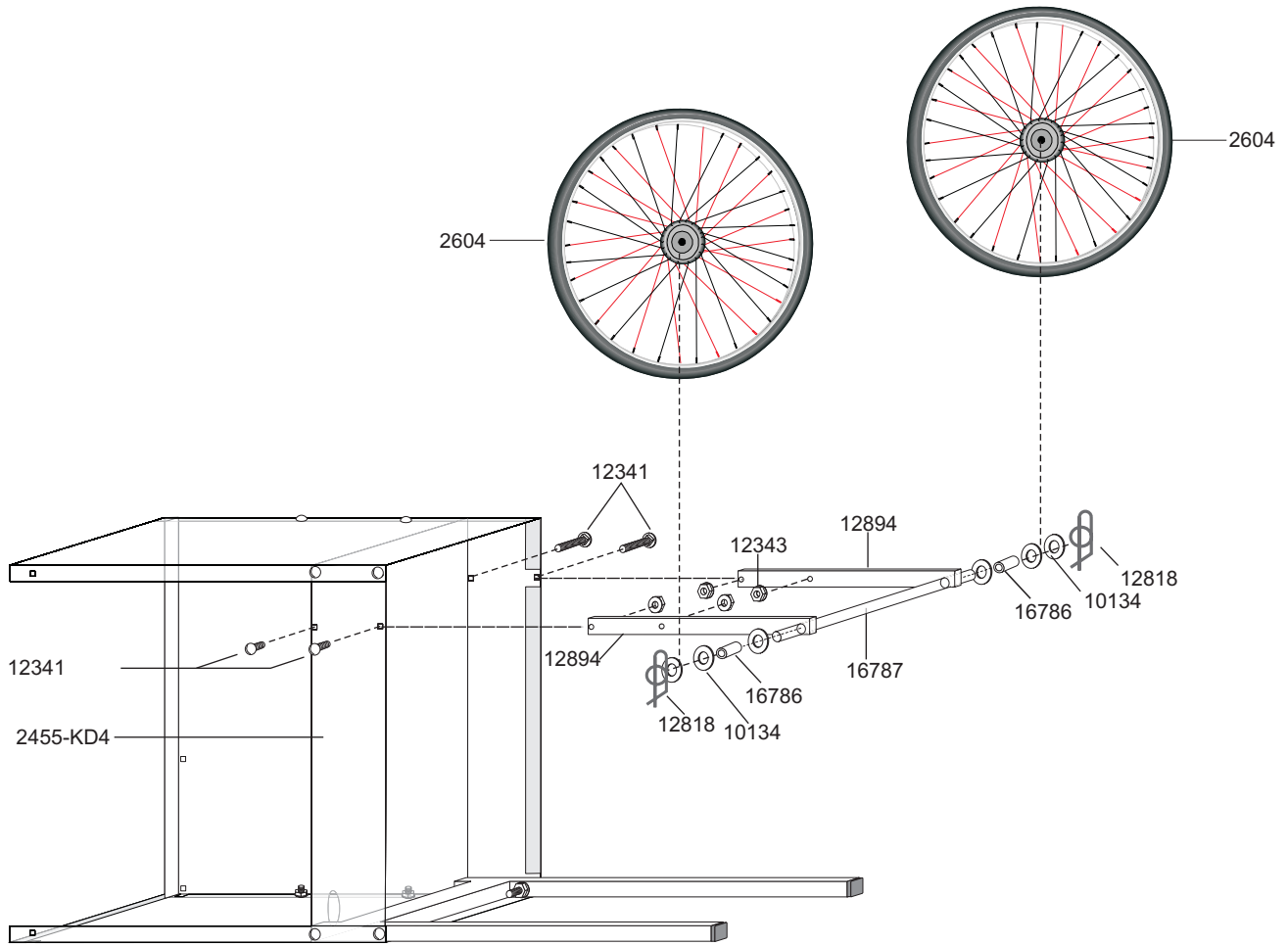

**ASSEMBLY STEPS 7 through 9**  
**DO NOT TIGHTEN HARDWARE UNTIL STEP 14**

- 7- Place both Wagon Axle Tubes inside bottom of Wagon Base aligning with holes on pieces #1 and #4 and fasten. Make sure Carriage Bolts fit snugly into square holes on base. Slide Axle Rod through Tubes until centered.
- 8- Slide on a larger washer, then the spacer, then another washer on each side of the Axel.
- 9- Slide both Wagon Wheels on to Axle. Then slide on one washer then push one 12818 clip into each small hole in shaft to hold wheels in place. If wheel does not turn freely remove one of the larger washers.

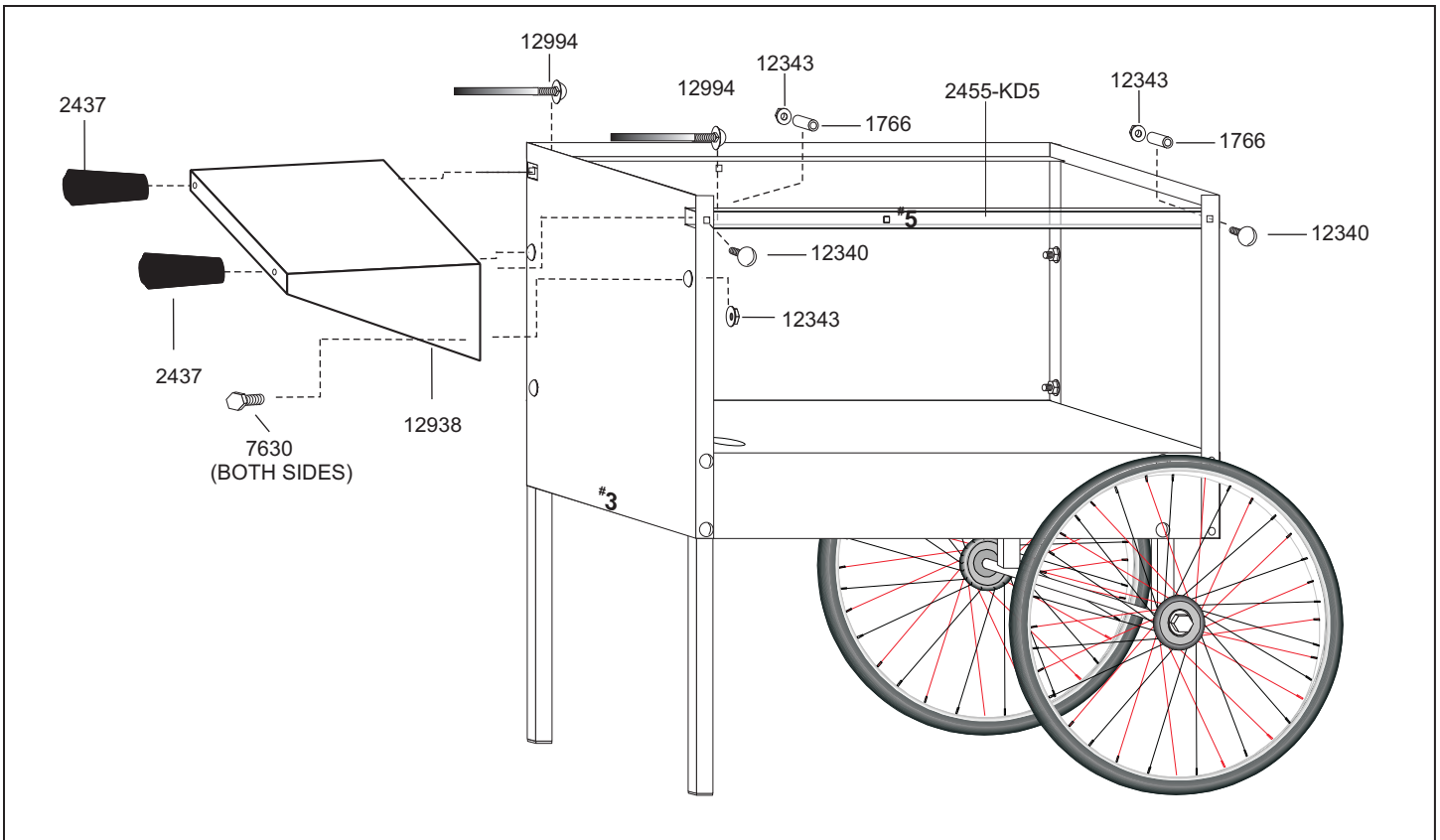

**ASSEMBLY STEPS 10 through 14**

**10-** Turn Wagon Base upright.

**11-** Slide two 3/8-16x 8 1/2" carriage bolts into square openings on piece #3, piece #1, and both set of holes found on self. Fasten together using the 2437 knobs, making sure square head on bolts fit snugly into square holes on base. Secure bottom of shelf to cart with two 7630 bolts and 12343 nuts.

**12-** Place piece #5 inside opening of Wagon Base aligning with hole opening on edge of piece #2. Insert screw through hole openings then place spacer on screw before fastening, making sure Carriage Bolts fit snugly into square holes on base.

**13-** Repeat step 12 on the other side of piece #5, aligning with holes found on piece #5 and edge of piece #3, making sure Carriage Bolts fit snugly into square holes on base.

**14- COMPLETE BY TIGHTENING ALL HARDWARE AT THIS POINT.**

