

ASSEMBLY HARDWARE

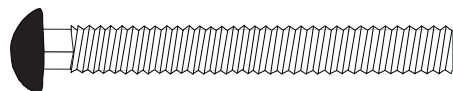

12341-BLK
1/4-20 x 2 BLK CARRIAGE BOLT (8)

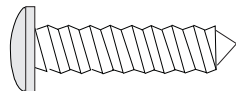

7644
#10 x 3/4 PHILLIPS PAN HD-TY-A (2)



12340-BLK
1/4-20 x 3/4 BLK CARRIAGE BOLT (8)

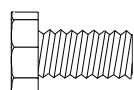

7630
1/4-20 x 1/2 HEX BOLT (2)

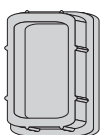

12350
PLUG (2)

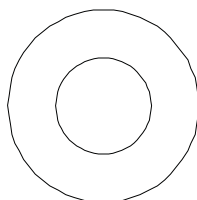

10134
1/2" FLAT WASHER (6)

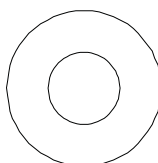

7622
3/8" FLAT WASHER (6)



2437
DUMP LEVER KNOB (2)



2555-2
WAGON MOUNTING BRACKET(2)



12818
CLIP-RETAINING (2)



16786
SPACER (2)



1766
3/8" SPACER (2)



12343
1/4-20 SPECIAL NUT (18)



12372
7/16 BOX WRENCH -S.S. (1)

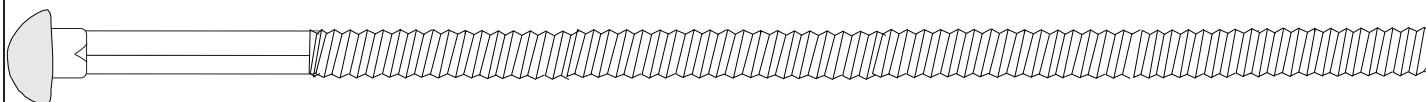

12994
3/8-16 x 8-1/2 CARRIAGE BOLT (2)

PARTS DESCRIPTION

2455-KD1-BLK WAGON SIDE

2455-KD2-BLK WAGON FRONT

2455-KD3-BLK WAGON BACK

2455-KD4-BLK WAGON BOTTOM

2455-KD5-BLK CROSS BAR

12894-CP WAGON AXLE SUPPORT TUBE-CHROME

16787 AXLE ROD ONLY SMALL (2010)

2604-HD WAGON WHEEL -SILVER

12338-HD WAGON LEG-CHROME - KD

12938 WAGON SHELF-GOLDRUSH

HARDWARE TO MOUNT POPPER

2555-2 WAGON MOUNTING BRACKET

7644 #10 x 3/4 SHEETMETAL SCREW

C. CRETORS AND COMPANY

176 MITTEL DRIVE

WOOD DALE, IL 60191

PHONE: (773)588-1690, (800)228-1885, FAX: (847) 616-6970

WEB SITE: <http://www.cretors.com> Email: postmaster@cretors.com

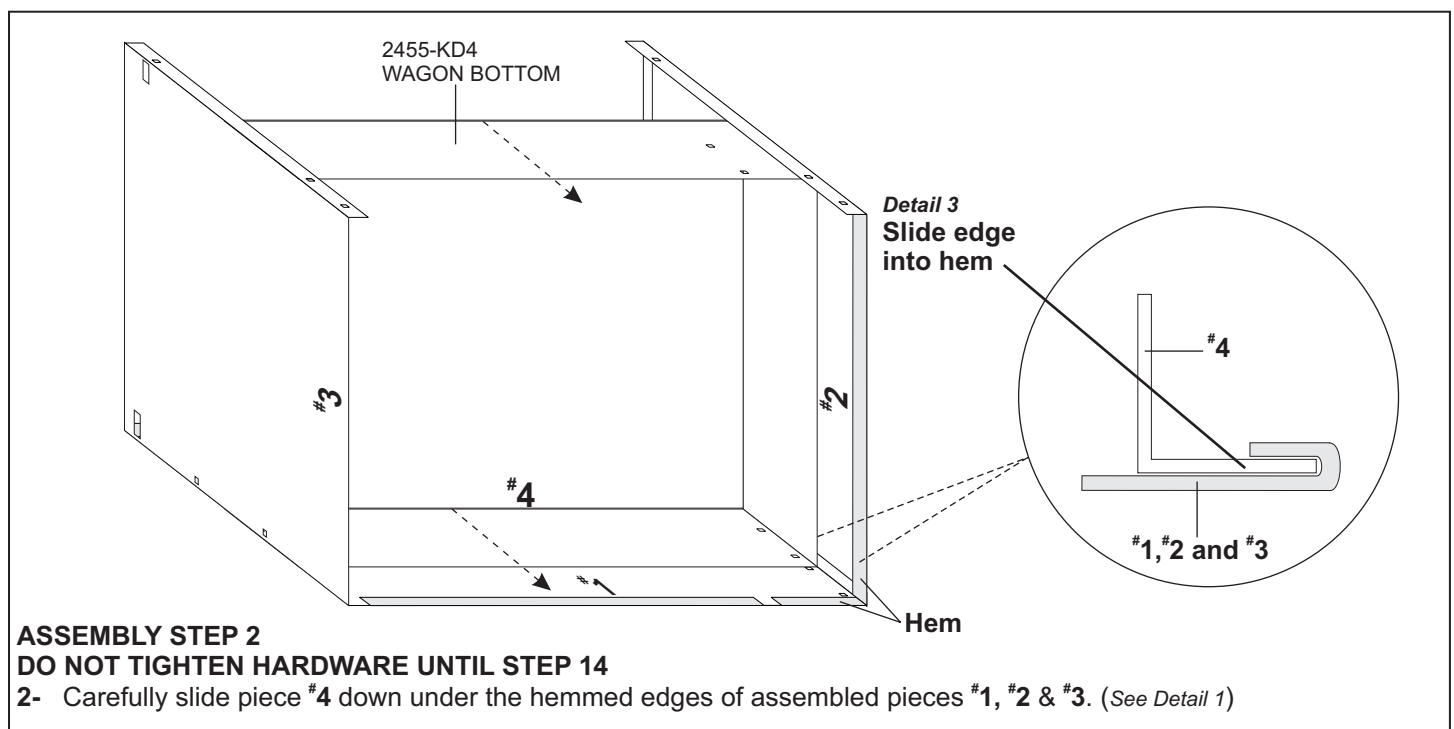
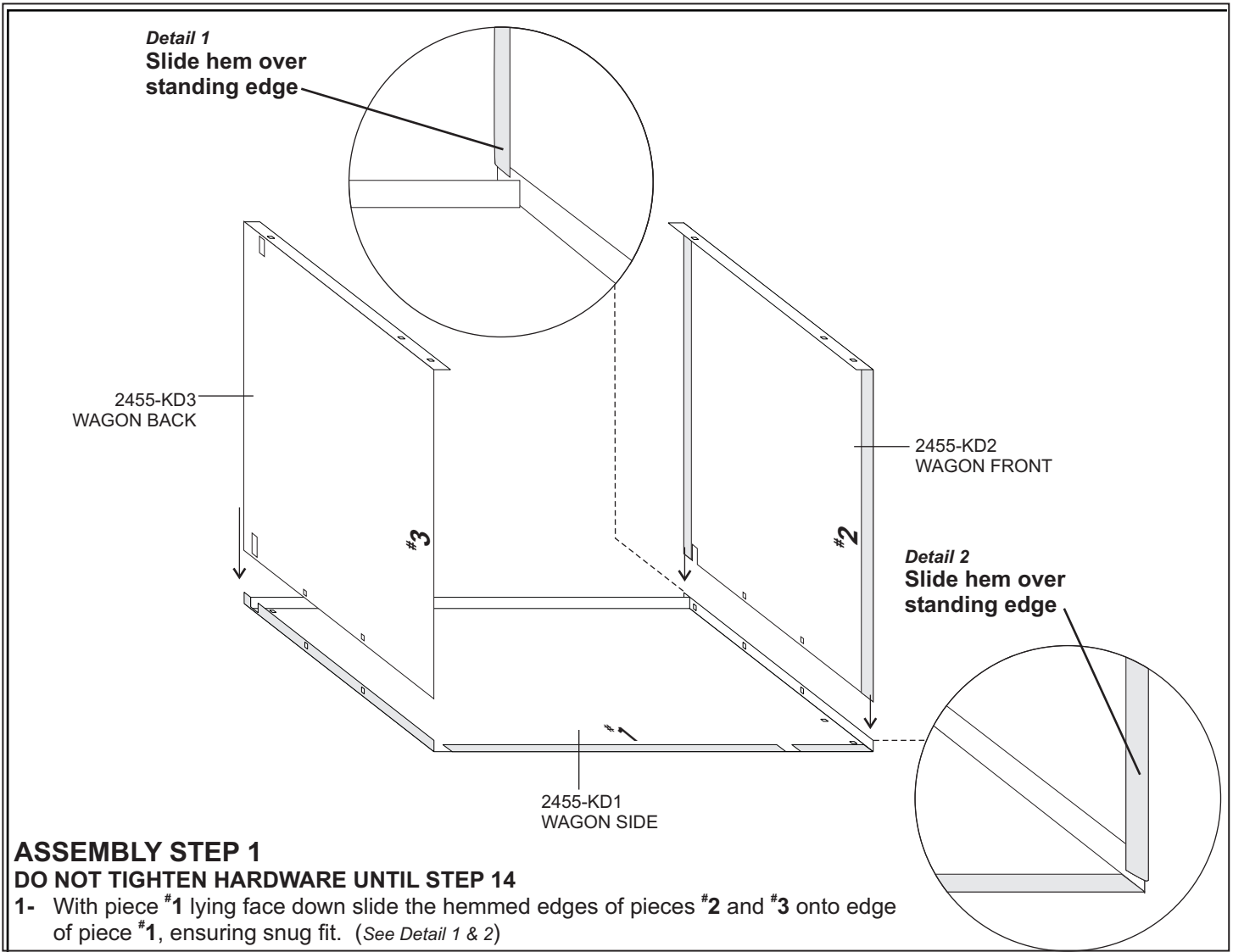

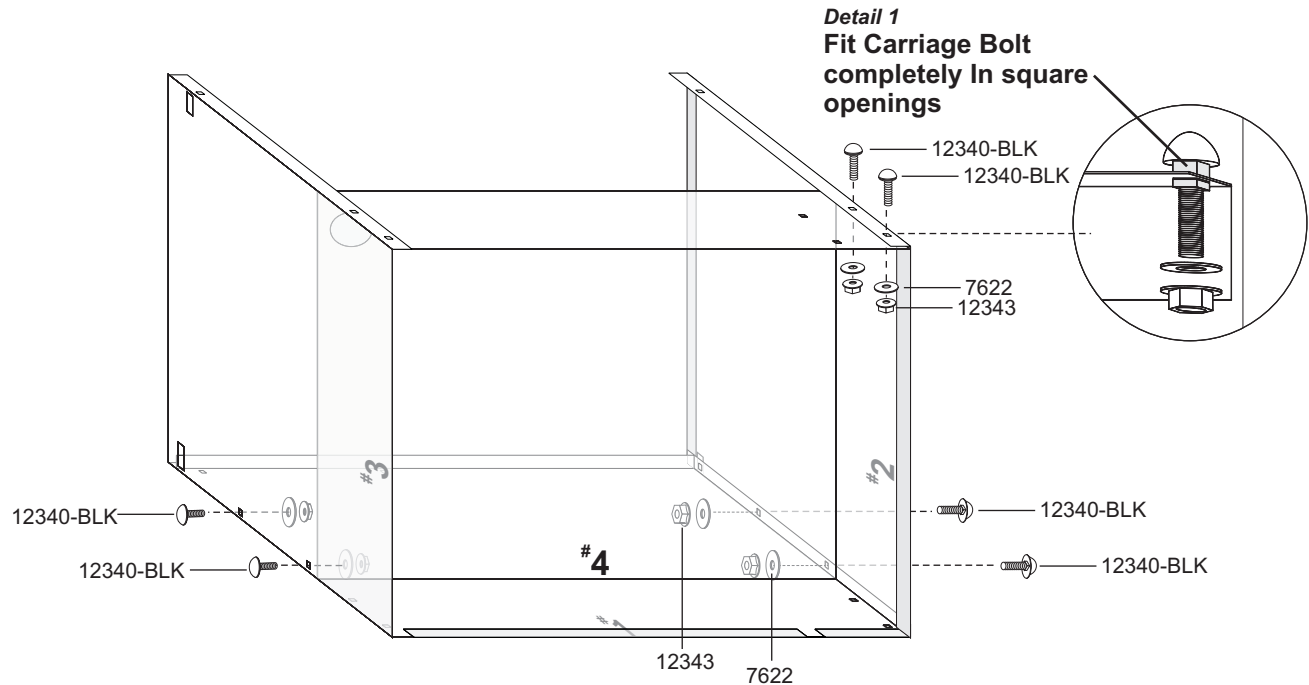

ASSEMBLY STEP 3

DO NOT TIGHTEN HARDWARE UNTIL STEP 14

- 3- Using hardware and wrench shown on page one fasten side pieces #2 & #3 to piece #1 and pieces #2 to #4 aligning all holes and fasten. Making sure Carriage Bolts fit snugly into square holes on base. (See Detail1)
This completes the Base portion of The Wagon.

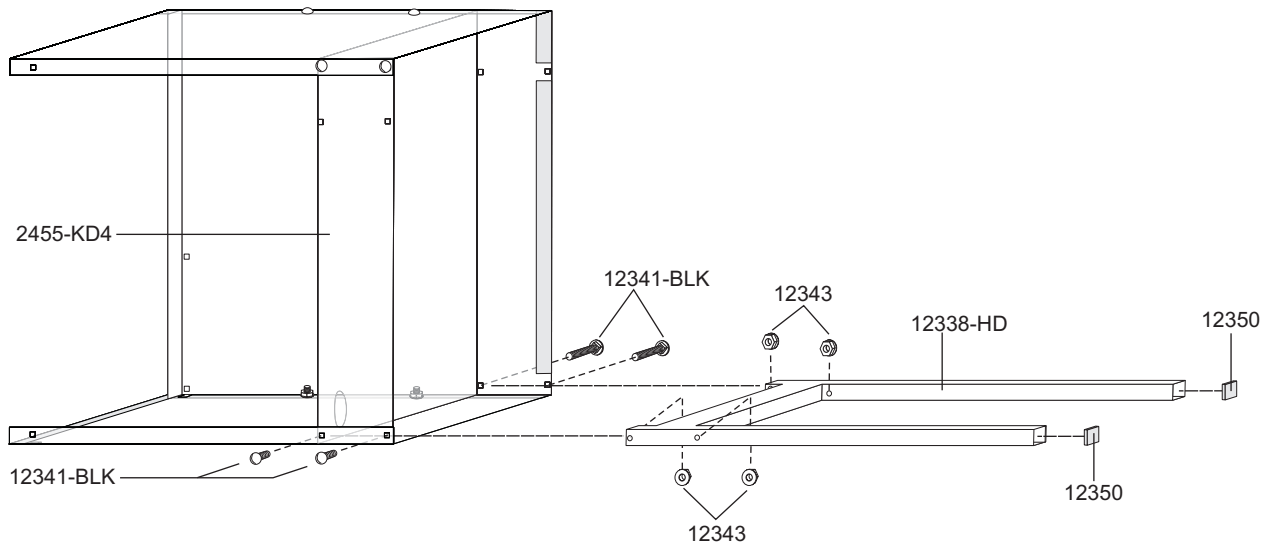

ASSEMBLY STEPS 4 through 6

DO NOT TIGHTEN HARDWARE UNTIL STEP 14

- 4- Turn Wagon Base on to side.
5- Place Wagon Legs inside bottom of Wagon Base aligning Wagon Legs with hole openings on pieces #1, #3 and #4, fasten legs to Wagon Base using Special Wrench provided or a 7/16 wrench.
6- Push Plugs into open ends of the Wagon Legs.

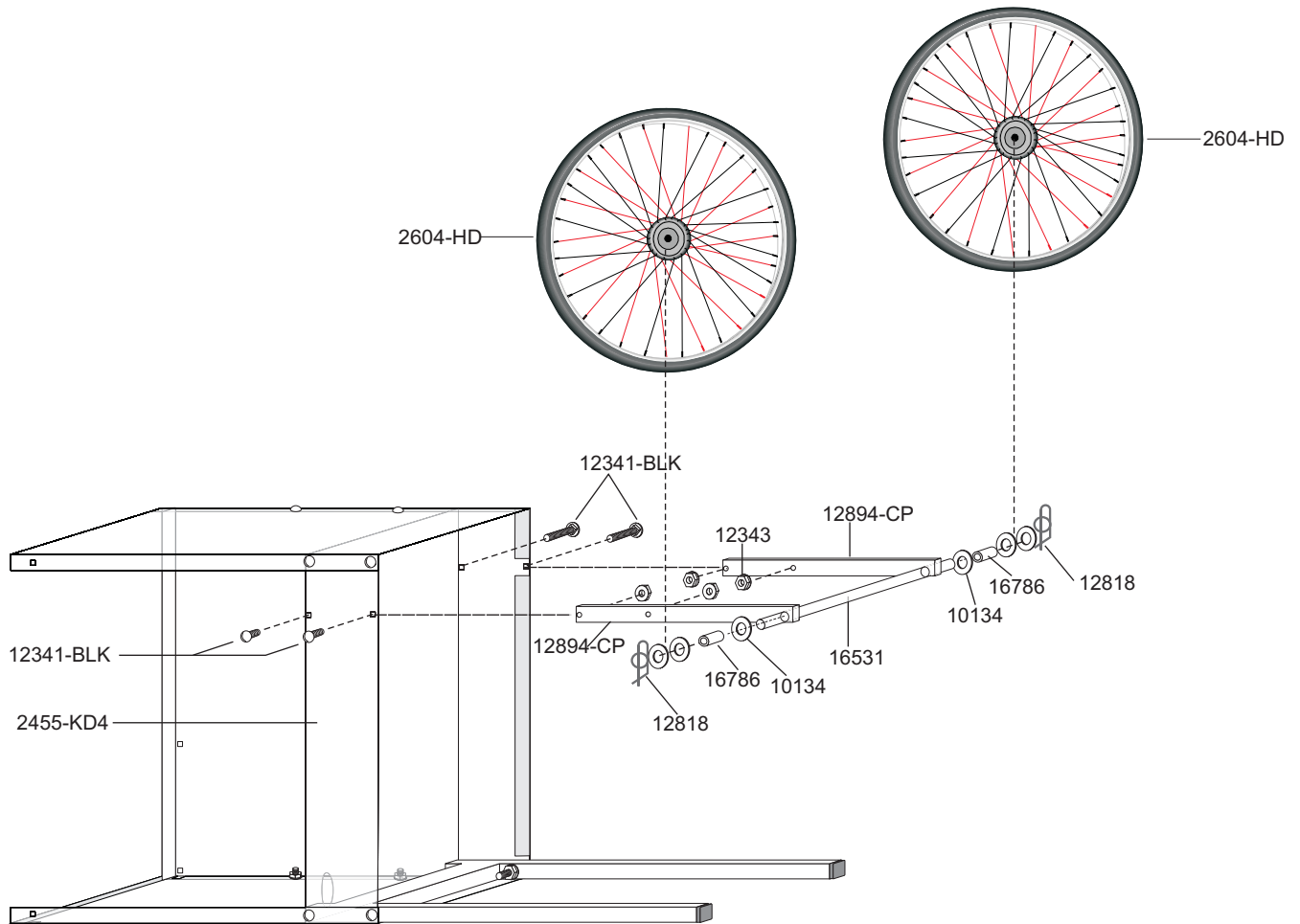

ASSEMBLY STEPS 7 through 9
DO NOT TIGHTEN HARDWARE UNTIL STEP 14

- 7- Place both Wagon Axle Tubes inside bottom of Wagon Base aligning with holes on pieces **#1** and **#4** and fasten. Make sure Carriage Bolts fit snugly into square holes on base. Slide Axle Rod through Tubes until centered.
- 8- Slide on a larger washer, then the spacer, then another washer on each side of the axle.
- 9- Slide both Wagon Wheels on to Axle. Then slide on one washer then push one 12818 clip into each small hole in shaft to hold wheels in place. If wheel does not turn freely remove one of the larger washers.

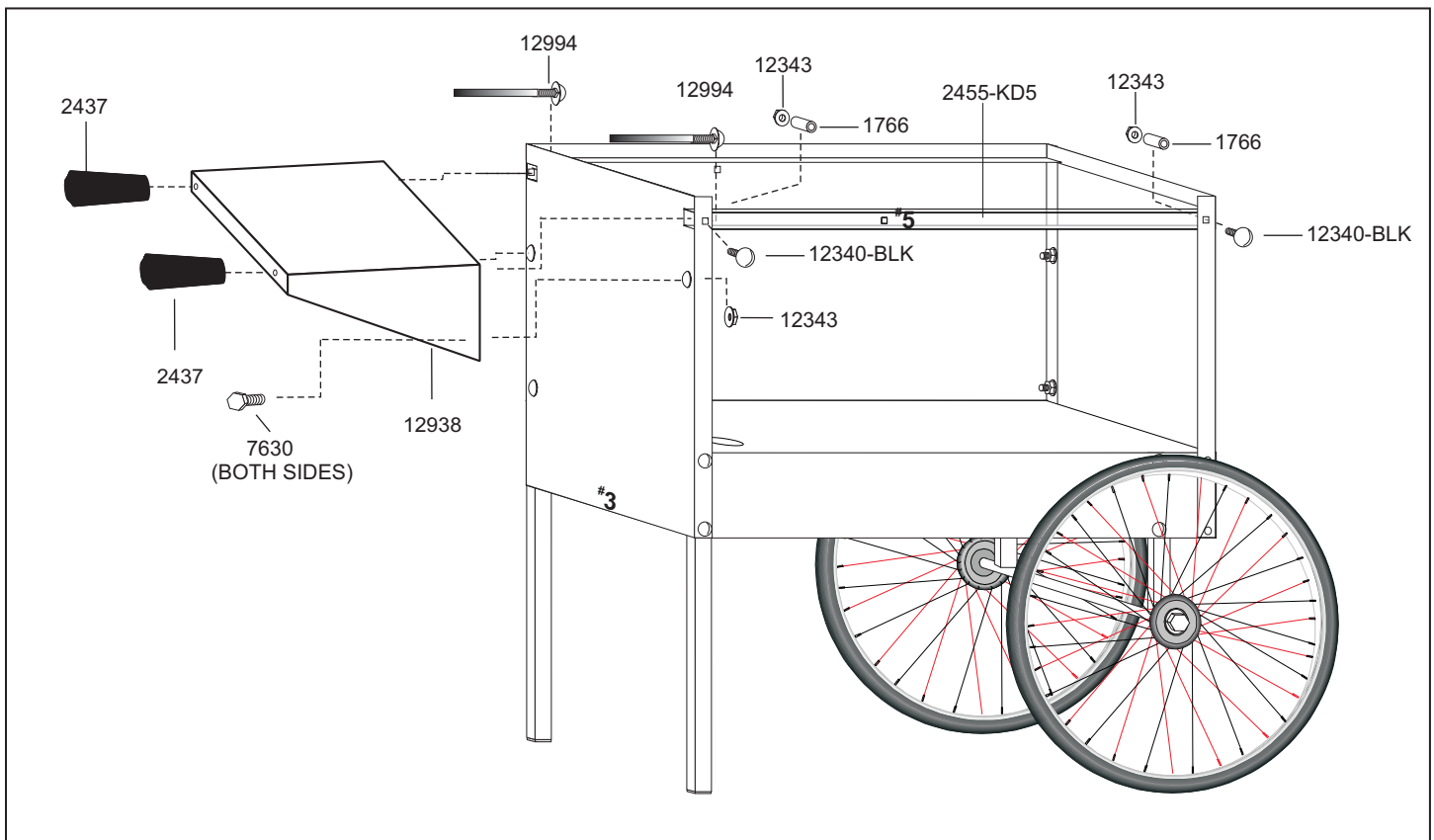

ASSEMBLY STEPS 10 through 14

10- Turn Wagon Base upright.

11- Slide two 3/8-16x 8 1/2" carriage bolts into square openings on piece #3, piece #1, and both set of holes found on self. Fasten together using the 2437 knobs, making sure square head on bolts fit snugly into square holes on base. Secure bottom of shelf to cart with two 7630 bolts and 12343 nuts.

12- Place piece #5 inside opening of Wagon Base aligning with hole opening on edge of piece #2. Insert screw through hole openings then place spacer on screw before fastening, making sure Carriage Bolts fit snugly into square holes on base.

13- Repeat step 12 on the other side of piece #5, aligning with holes found on piece #5 and edge of piece #3, making sure Carriage Bolts fit snugly into square holes on base.

14- COMPLETE BY TIGHTENING ALL HARDWARE AT THIS POINT.

